

SCANNED

SEP 14 2017

Name: CB

Louisville Metro Council City Agency Request
Neighborhood Development Fund (NDF)
■ **Capital Infrastructure Fund (CIF)**
Municipal Aid Program (MAP)
Paving Fund (PAV)

Primary Sponsor: Councilwoman Cindi Fowler

Amount: \$13,700.00 **Date:** September 14, 2017

Description of program/project including public purpose, additional funding sources, location of project/program and any external grantee(s):
This is a transfer of District 14 CIF (Capital Infrastructure Funds) of \$13,700.00 for the installation of four (4) speed humps and two (2) speed hump signs on Stephan Drive, and two (2) speed humps and two (2) speed hump signs on Vicki Lane. These are to slow down speeding traffic and increase public safety.

City Agency: Louisville Metro Public Works
Contact Person: Jeff Brown
Agency Phone: (502) 773-6054

I have reviewed this request for an expenditure of city tax dollars, and have determined the funds will be used for a public purpose and have the attached documentation from the receiving department concerning the project/expenditure.

14 Cindi Fowler \$13,700.00 9/14/2017
District # Council Member Signature Amount Date

Approved by: _____
Appropriations Committee Chairman Date
Clerk's Office & OMB Use Only:
Request Amount: _____ Amended Amount: _____
Reference #: _____ To OMB: _____
Budget Revision #: _____
Account #: _____
To Project Manager: _____ Completion Date: _____
Actual Cost: _____ Funds Returned: _____

Department/Project:
Louisville Metro Public Works / Speed Humps and Signage on Stephan Drive and Vicki Lane

Additional Signatures

I have reviewed this request for an expenditure of city tax dollars, and have determined the funds will be used for a public purpose.

Council Member Signature and Amount

District 1	_____	\$ _____
District 2	_____	\$ _____
District 3	_____	\$ _____
District 4	_____	\$ _____
District 5	_____	\$ _____
District 6	_____	\$ _____
District 7	_____	\$ _____
District 8	_____	\$ _____
District 9	_____	\$ _____
District 10	_____	\$ _____
District 11	_____	\$ _____
District 12	_____	\$ _____
District 13	_____	\$ _____
District 14	<i>Candi Fowler</i>	\$13,700.00
District 15	_____	\$ _____
District 16	_____	\$ _____
District 17	_____	\$ _____
District 18	_____	\$ _____
District 19	_____	\$ _____
District 20	_____	\$ _____
District 21	_____	\$ _____
District 22	_____	\$ _____
District 23	_____	\$ _____
District 24	_____	\$ _____
District 25	_____	\$ _____
District 26	_____	\$ _____

NDF, CIF, MAP OR PAV INTERAGENCY CHECKLIST

Interagency Name: Louisville Metro Public Works

Program/Project Name: Speed Humps and Signage for Stephan Drive and Vicki Lane

	Yes/No/NA
Request Form: Is the Request Signed by all Council Member(s) Appropriating Funding?	Yes <input type="checkbox"/>
Request Form: If matching funds are to be used, are they disclosed with account numbers in the request form description?	NA <input type="checkbox"/>
Request Form: If matching funds are to be used, does the amount of the request exclude the matching fund amount?	NA <input type="checkbox"/>
Request Form: If other funds are to be used for this project, are they disclosed with account numbers in the request form description?	NA <input type="checkbox"/>
Funding Source: If CIF is being requested, does Metro Louisville own/will own the real estate, building or equipment? If not, the funding source is probably NDF.	Yes <input type="checkbox"/>
Funding Source: If CIF is being requested, does the project have a useful life of more than one year? If not, the funding source is probably NDF.	Yes <input type="checkbox"/>
Ordinance Required: Is the NDF request to a Metro Agency greater than \$5,000? If so, an ordinance is required.	NA <input type="checkbox"/>
Ordinance Required: Is the request a transfer from NDF to cost center? If so, is the amount given for the fiscal year \$25,000 or less?	NA <input type="checkbox"/>
Supporting Documentation: Does the attachment include a valid estimate and description of cost?	Yes <input type="checkbox"/>

Submitted by:



Date: 9-14-17

Brothers, Cameron

From: Fowler, Cindi
Sent: Wednesday, September 13, 2017 6:15 PM
To: Brown, Jeffrey E
Cc: Brothers, Cameron; Thieneman, Cindy L; Dow, Greg
Subject: Re: Speed Humps for Stephan and Vicki Lanes

Thanks Jeff!

Sent from my iPad

On Sep 13, 2017, at 6:12 PM, Brown, Jeffrey E <Jeffrey.Brown@louisvilleky.gov> wrote:

We will accept funding for speed humps at these locations

Sent from my Verizon, Samsung Galaxy smartphone

----- Original message -----

From: "Fowler, Cindi" <Cindi.Fowler@louisvilleky.gov>
Date: 9/13/17 5:10 PM (GMT-05:00)
To: "Brown, Jeffrey E" <Jeffrey.Brown@louisvilleky.gov>
Cc: "Brothers, Cameron" <Cameron.Brothers@louisvilleky.gov>, "Thieneman, Cindy L" <Cindy.Thieneman@louisvilleky.gov>
Subject: Speed Humps for Stephan and Vicki Lanes

Jeff,

Will you accept funding in the amount of \$13,700 for the installation of speed humps on Stephen Drive and Vicki Lane? I appreciate your consideration. Cindi

Sent from my iPad



DEPARTMENT OF PUBLIC WORKS AND ASSETS

LOUISVILLE, KENTUCKY

GREG FISCHER

MAYOR

VANESSA D. BURNS

Director

TO: Councilwoman Cindi Fowler
District 14

FROM: Gregory A. Dow
Traffic Engineering

DATE: September 13, 2017

RE: **Cost of Speed Humps for Stephan Drive**
SR # 4366122
Four (4) Speed Humps x \$2,150.00 = \$8,600.00
Two (2) Speed Hump signs x \$200.00 = \$400.00
Total = \$9,000.00

Please consider this letter as our official Statement of Cost for all speed hump related work. Each speed hump, including markings is \$2,150.00 and each sign is \$200.00. Based on our Engineering Studies, a total of four (4) speed humps and two (2) speed hump signs have been proposed for Stephan Drive between Dixie Highway and Vicki Lane. The total "not to exceed" cost is \$9,000.00 and as I understand it, you have offered to fund the entire amount.

Upon funding approval, the speed humps will be installed as schedule and weather permits.

Please let me know if you have any questions. You may contact me at 574-3882.

Sincerely,

Gregory A. Dow
Traffic Engineering

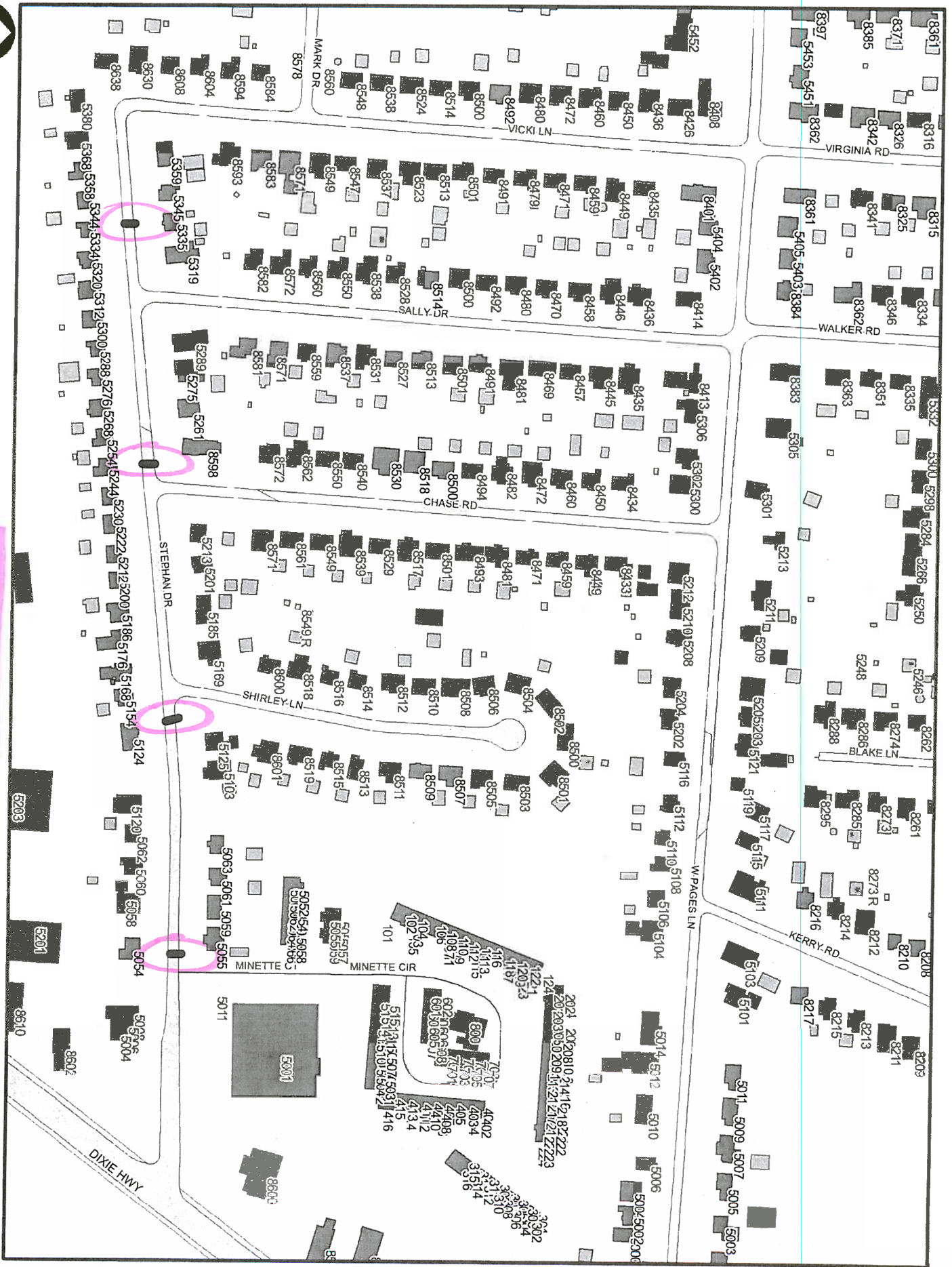

Stephan Drive
4-Speed Humps

July 1, 2015



DEPARTMENT OF PUBLIC WORKS AND ASSETS

LOUISVILLE, KENTUCKY

GREG FISCHER
MAYOR

VANESSA D. BURNS
Director

TO: Councilwoman Cindi Fowler
District 14

FROM: Gregory A. Dow
Traffic Engineering

DATE: September 13, 2017

RE: **Cost of Speed Humps for Vicki Lane**
SR # 4482346
Two (2) Speed Humps x \$2,150.00 = \$4,300.00
Two (2) Speed Hump signs x \$200.00 = \$400.00
Total = \$4,700.00

Please consider this letter as our official Statement of Cost for all speed hump related work. Each speed hump, including markings is \$2,150.00 and each sign is \$200.00. Based on our Engineering Studies, a total of two (2) speed humps and two (2) speed hump signs have been proposed for Vicki Lane, between Stephan Drive and W. Pages Lane. The total "not to exceed" cost is \$4,700.00, and as I understand it, you have offered to fund the entire amount.

Upon funding approval, the speed humps will be installed as schedule and weather permits.

Please let me know if you have any questions. You may contact me at 574-3882.

Sincerely,

A handwritten signature in black ink, appearing to read "Gregory A. Dow", with a large, stylized flourish extending to the left.

Gregory A. Dow
Traffic Engineering



NOT TO SCALE

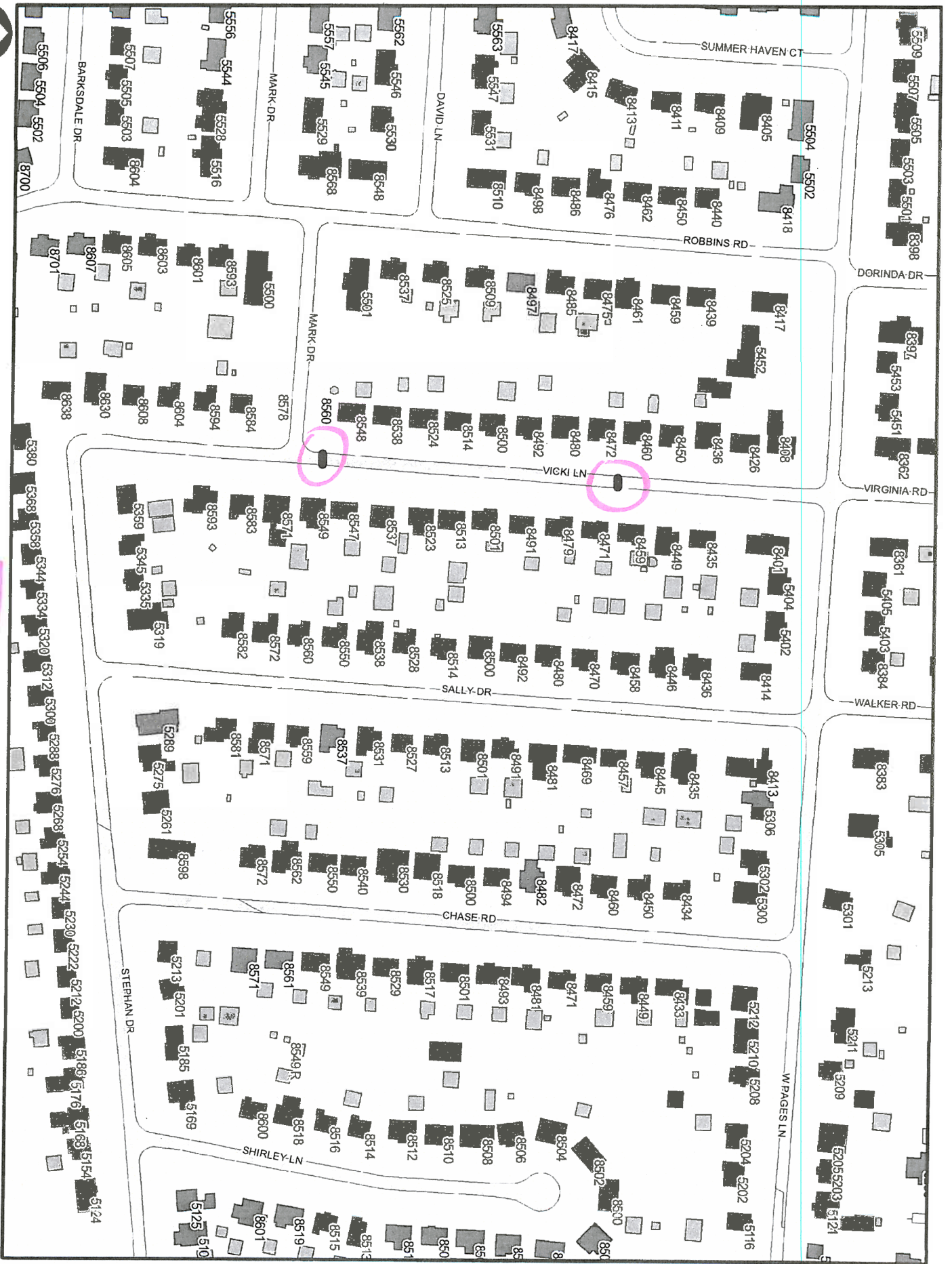

Vicki Lane

2 Speed Humps

July 1, 2015

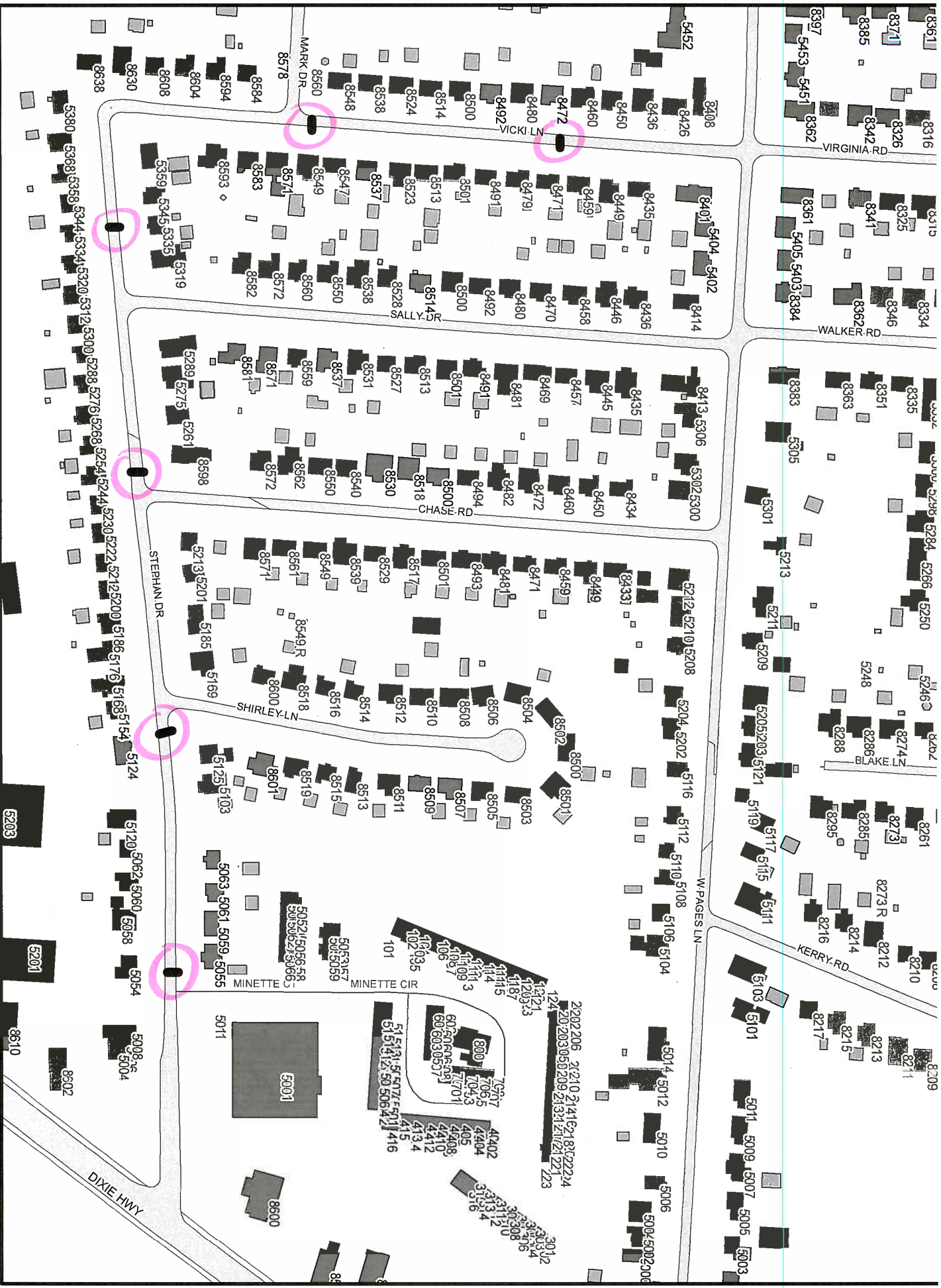

NOT TO SCALE

Stephan Drive and Vicki Lane

6 Speed Humps

July 1, 2015