

Tree Canopy

Tree Canopy class: B
 Land Area: 0.1757 acres / 7,653 Sqft
 Existing Tree Canopy: 142sf / 2%
 Required Tree Canopy: 918sf / 12%
 Additional Tree Canopy Required: 776sf / 1 type A Tree
 1 3/4" to 3" Caliper

Detailed District Development Plan
 For 535 Camden Ave.
 Louisville, KY 40215

Plan Date: 05/12/2017
 Owner: Zhong Liu
 6216 Breeze Hill Rd.
 Crestwood, KY 40014

Waiver Request

Waiver from LDC Sec 10.2.10 to not provide a VUA LBA along the North and West Property Lines.

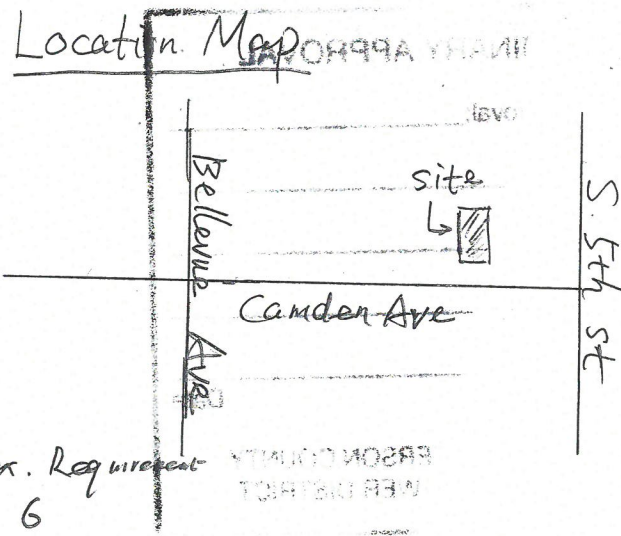

Parking Calculations:

Duplex	Min. Required	Max. Required
	2	6

Spaces provided:
 On street credit = 3 spaces
 off street parking (garage) = 1 space
 Total = 4 spaces

MSD Note:

MSD single-lot residential permit required prior to any site construction activity

UNNAMED ALLEY

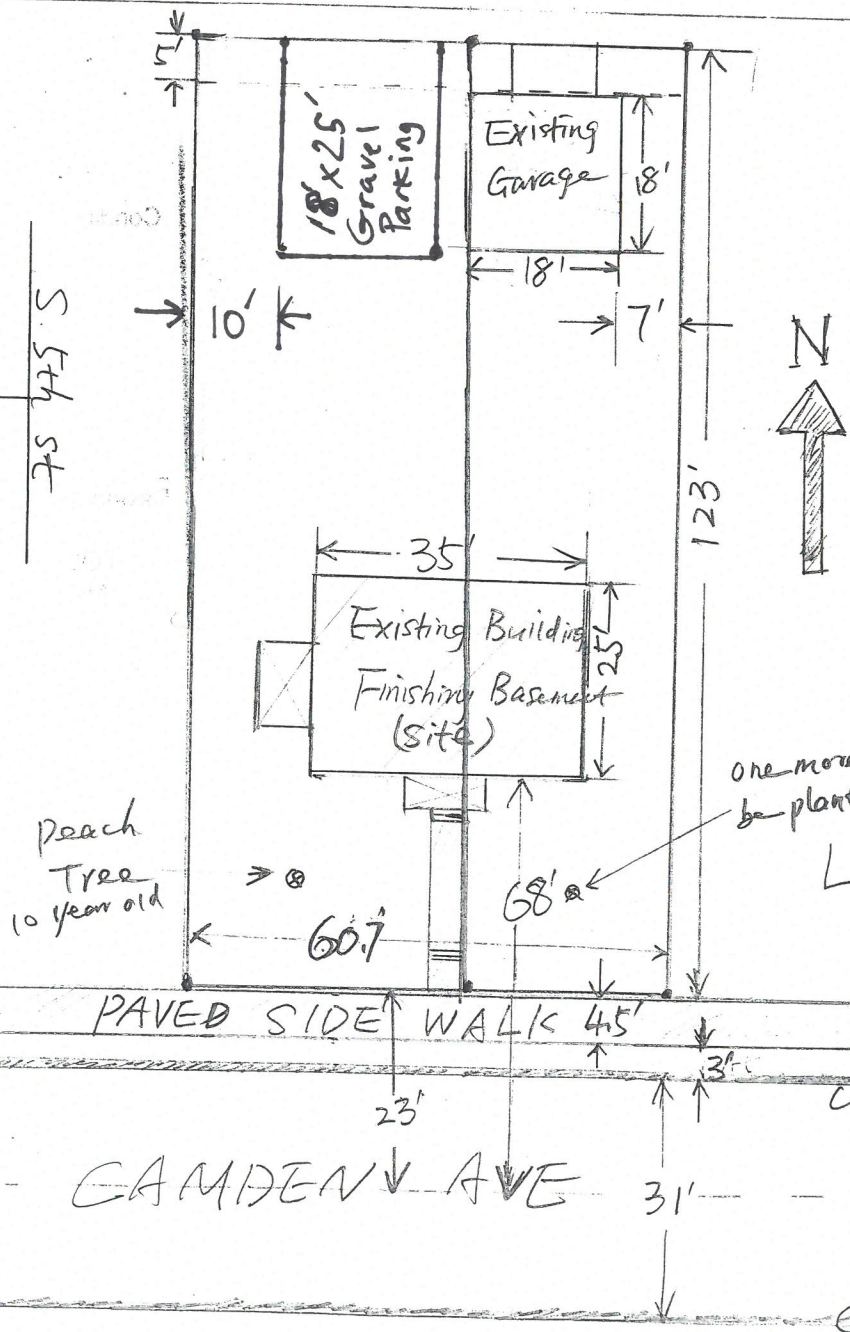

Tax Block: 052J

Lot #: 0282

Existing ZONE: R5

Requested ZONE: R5-B

Form: TN

proposed Apartment: 650 SF

Existing Residence: 1000 SF

Note: - Compatible utilities shall be placed in a common trench unless otherwise required by appropriate agencies.
 - Residential Parking (gravel) shall meet code Regulations policy.

one more tree will be planted here

Legend:

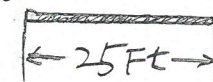

~~RECEIVED~~

~~MAY 15 2017~~

~~DESIGN SERVICES~~

~~revision~~

RECEIVED

JUN 28 2017

PLANNING & DESIGN SERVICES

Revision

~~RECEIVED~~

~~MAY 25 2017~~

~~PLANNING & DESIGN SERVICES~~

~~Revision~~

**PRELIMINARY APPROVAL
DEVELOPMENT PLAN**

CONDITIONS: _____

BY: Tommy Markert

DATE: 6-7-17

LOUISVILLE/ JEFFERSON COUNTY
METRO PUBLIC WORKS

PRELIMINARY APPROVAL

Conditions Approval: _____

Tommy Kelly 6-7-17

Development _____ Date _____

LOUISVILLE/ JEFFERSON COUNTY
METROPOLITAN SEWER DISTRICT