

1. The applicant shall be responsible for obtaining all necessary permits from the appropriate agencies and departments, including but not limited to, the Department of Public Works, the Department of Health, the Department of Fire, the Department of Planning and Zoning, and the Department of Transportation. The applicant shall also be responsible for obtaining all necessary utility easements and rights-of-way from the appropriate utility companies and the Department of Transportation.

2. The applicant shall be responsible for providing all necessary information and documents to the appropriate agencies and departments, including but not limited to, site plans, engineering drawings, and environmental impact statements. The applicant shall also be responsible for providing all necessary information and documents to the public, including but not limited to, a public hearing and a public comment period.

3. The applicant shall be responsible for providing all necessary information and documents to the appropriate agencies and departments, including but not limited to, a detailed site plan, a detailed engineering plan, and a detailed environmental impact statement. The applicant shall also be responsible for providing all necessary information and documents to the public, including but not limited to, a public hearing and a public comment period.

4. The applicant shall be responsible for providing all necessary information and documents to the appropriate agencies and departments, including but not limited to, a detailed site plan, a detailed engineering plan, and a detailed environmental impact statement. The applicant shall also be responsible for providing all necessary information and documents to the public, including but not limited to, a public hearing and a public comment period.

5. The applicant shall be responsible for providing all necessary information and documents to the appropriate agencies and departments, including but not limited to, a detailed site plan, a detailed engineering plan, and a detailed environmental impact statement. The applicant shall also be responsible for providing all necessary information and documents to the public, including but not limited to, a public hearing and a public comment period.

NOTICE
 PERMITS SHALL BE ISSUED
 ONLY IN CONFORMANCE WITH THE
 BINDING ELEMENTS OF THIS DISTRICT
 DEVELOPMENT PLAN

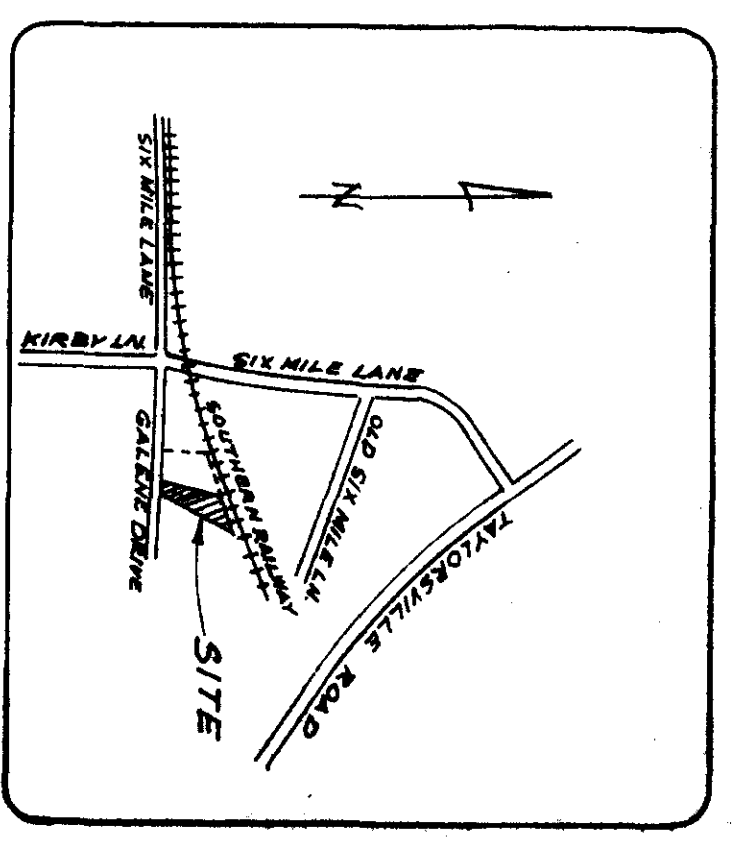

APPROVED DISTRICT DEVELOPMENT PLAN
 DOCUMENT NO. 513176
 APPROVAL DATE: 5/8/86
 EXPIRATION DATE: 7/7/87
 APPROVED BY: [Signature]
 [Signature]
 [Signature]

PRELIMINARY APPROVAL DEVELOPMENT PLAN
 CONDITIONS:
 BY: Miss. Adams (Cald)
 DATE: 3-27-86
 JEFFERSON COUNTY DEPT. OF PUBLIC WORKS

PRELIMINARY REVIEW DEVELOPMENT PLAN
 SHALL COMPLETE
 DATE: 3-27-86
 DISTRICT DEVELOPMENT PLAN FOR

JEFFERSONTOWN VILLAGE CENTER EXPANSION
 OWNER COMMERCIAL PROPERTY ASSOCIATES
 SCALE: 1" = 50'
 DATE: 10-30-1985
 REVISION: 3-28-86
 RILEY PARK, HAYDEN & ASSOC., INC.
 SITE PLANNING ARCHITECTS
 1000 W. MAIN STREET
 LOUISVILLE, KY 40202
 FILE NO. L-85-1381

All buildings to be 1 story

RECEIVED
 JAN 27 1986
 JEFFERSON COUNTY PLANNING COMMISSION

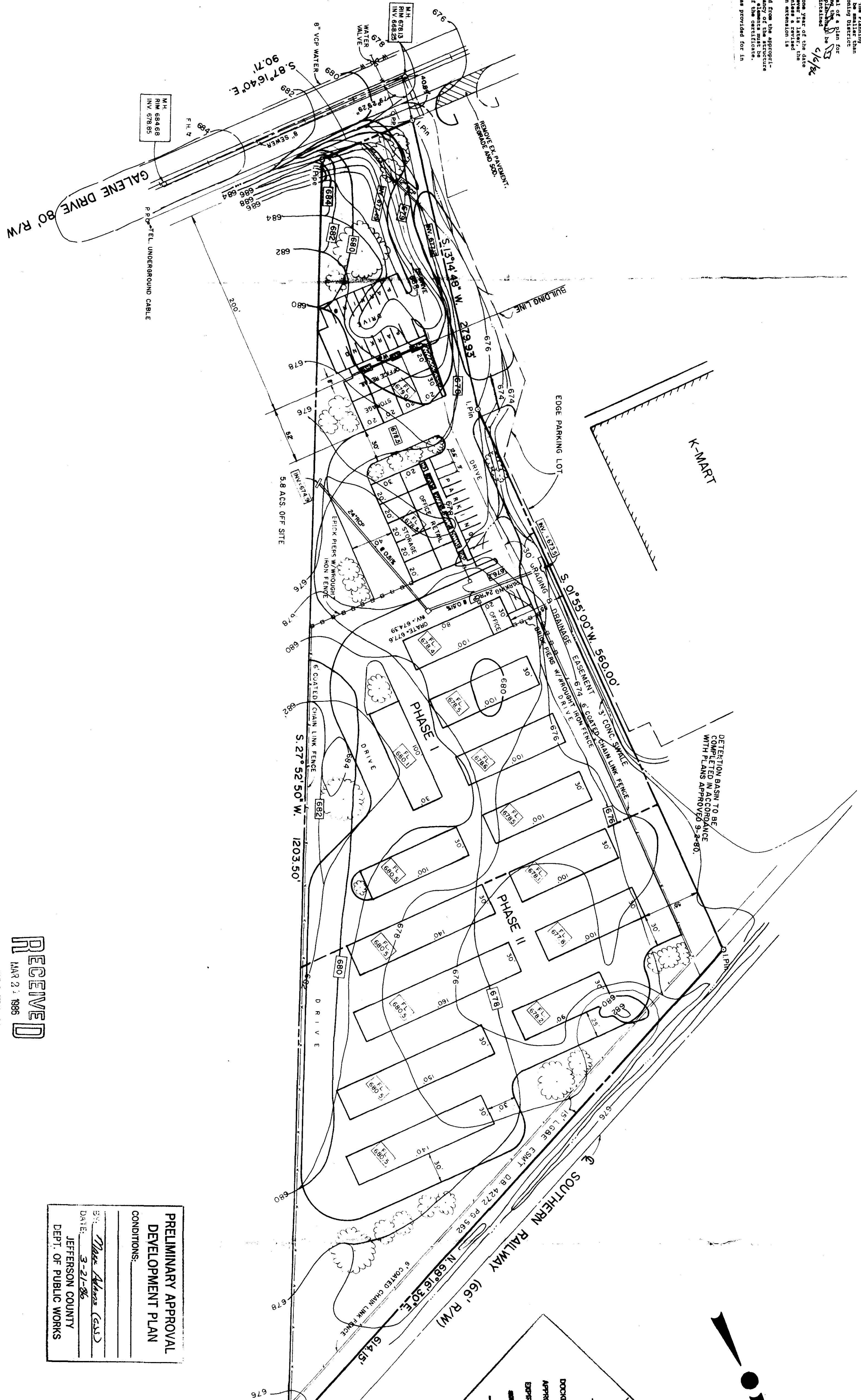

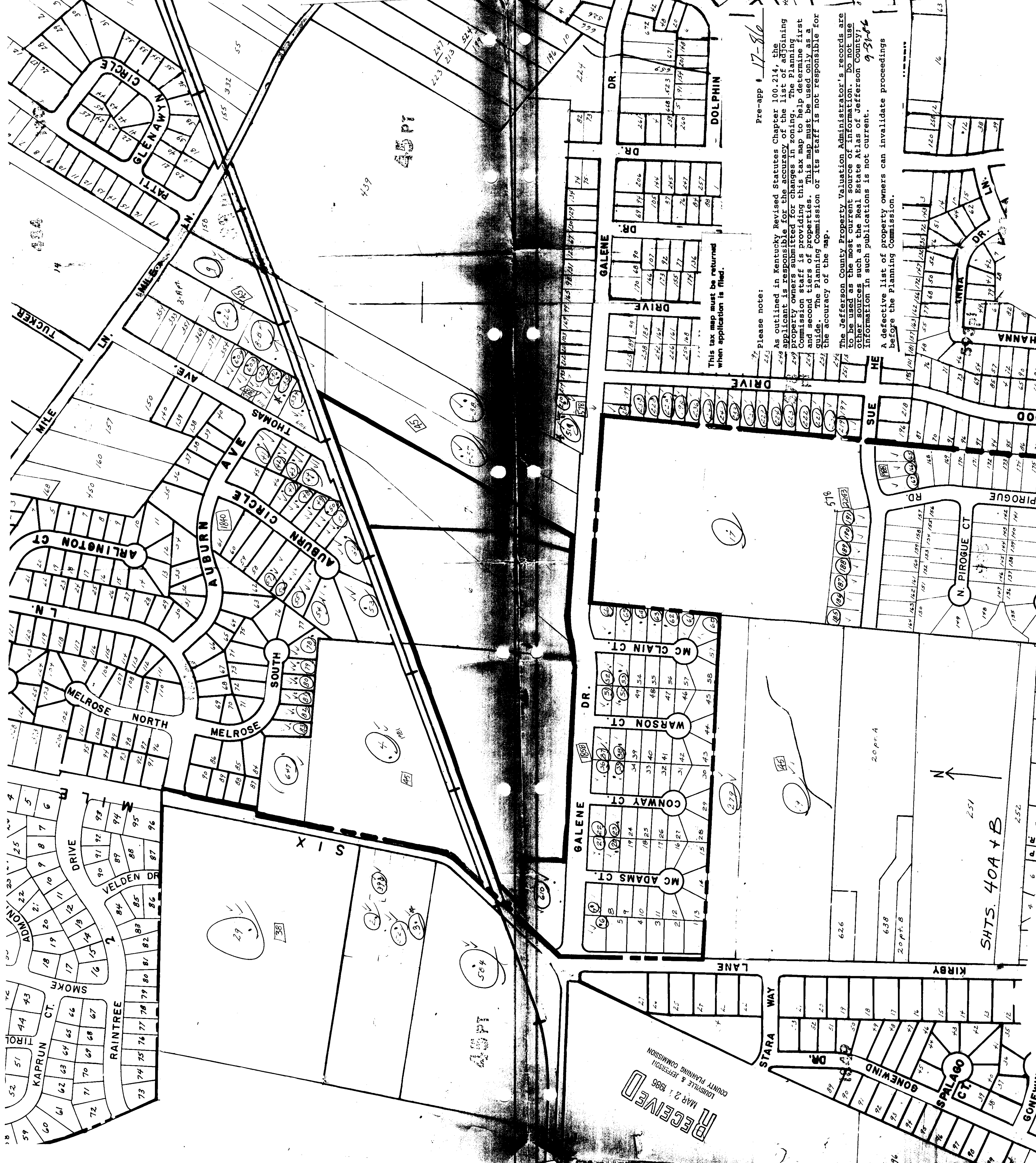

Pre-app # 17-86

Please note:
 As outlined in Kentucky Revised Statutes Chapter 100.214, the applicant is responsible for the accuracy of the list of adjoining property owners submitted for changes in zoning. The Planning Commission staff is providing this tax map to help determine first and second tiers of properties. This map must be used only as a guide. The Planning Commission or its staff is not responsible for the accuracy of the map.

The Jefferson County Property Valuation Administrator's records are to be used as the most current source of information. Do not use other sources such as the Real Estate Atlas of Jefferson County. Information in such publications is not current. 9-51-86

A defective list of property owners can invalidate proceedings before the Planning Commission.

This tax map must be returned when application is filed.

RECEIVED
 MAR 2 1995
 KENTUCKY & JEFFERSON
 COUNTY PLANNING COMMISSION

SHTS. 40A + B