

EXISTING ZONING: C-3 & OR-3  
 FORM DISTRICT: DOWNTOWN  
 EXISTING USE: HOSPITAL/PARKING GARAGE  
 PROPOSED USE: HOSPITAL/PARKING GARAGE/HELISTOP  
 GROSS SITE AREA: 3.63 ACS

SITE DATA

C-3 & OR-3  
 DOWNTOWN  
 HOSPITAL/PARKING GARAGE  
 HOSPITAL/PARKING GARAGE/HELISTOP  
 3.63 ACS

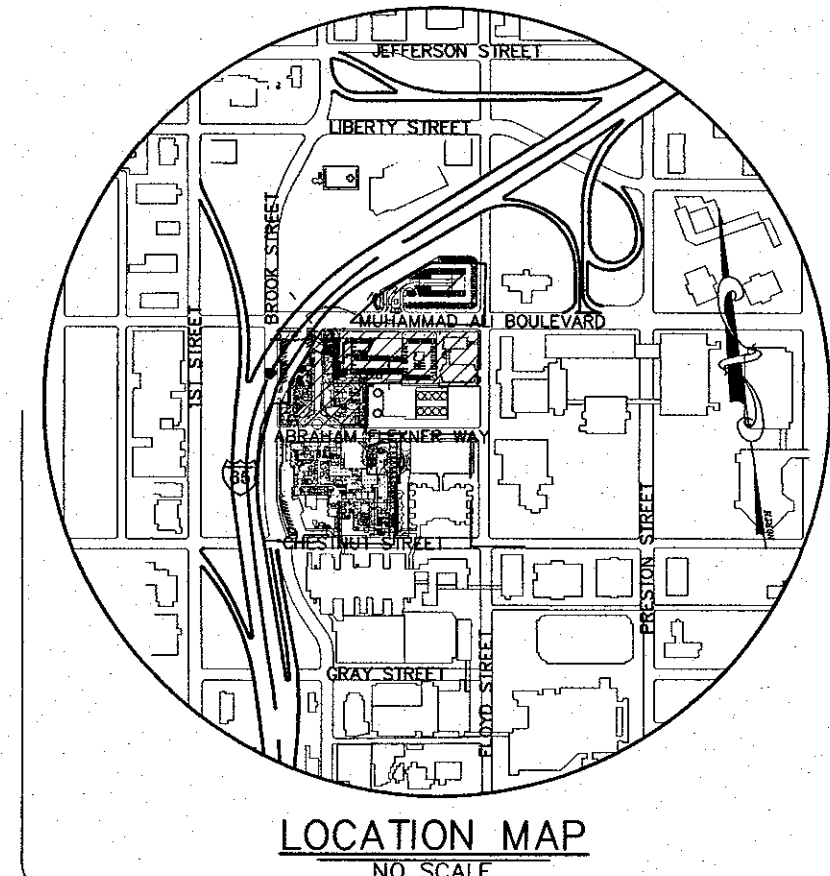

SABAK, WILSON & LINGO, INC.  
 ENGINEERS, LANDSCAPE ARCHITECTS & PLANNERS  
 608 S. THIRD STREET, LOUISVILLE, KENTUCKY 40202  
 (502) 584-6271

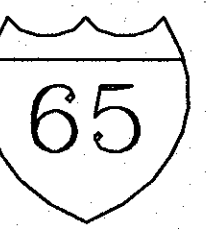
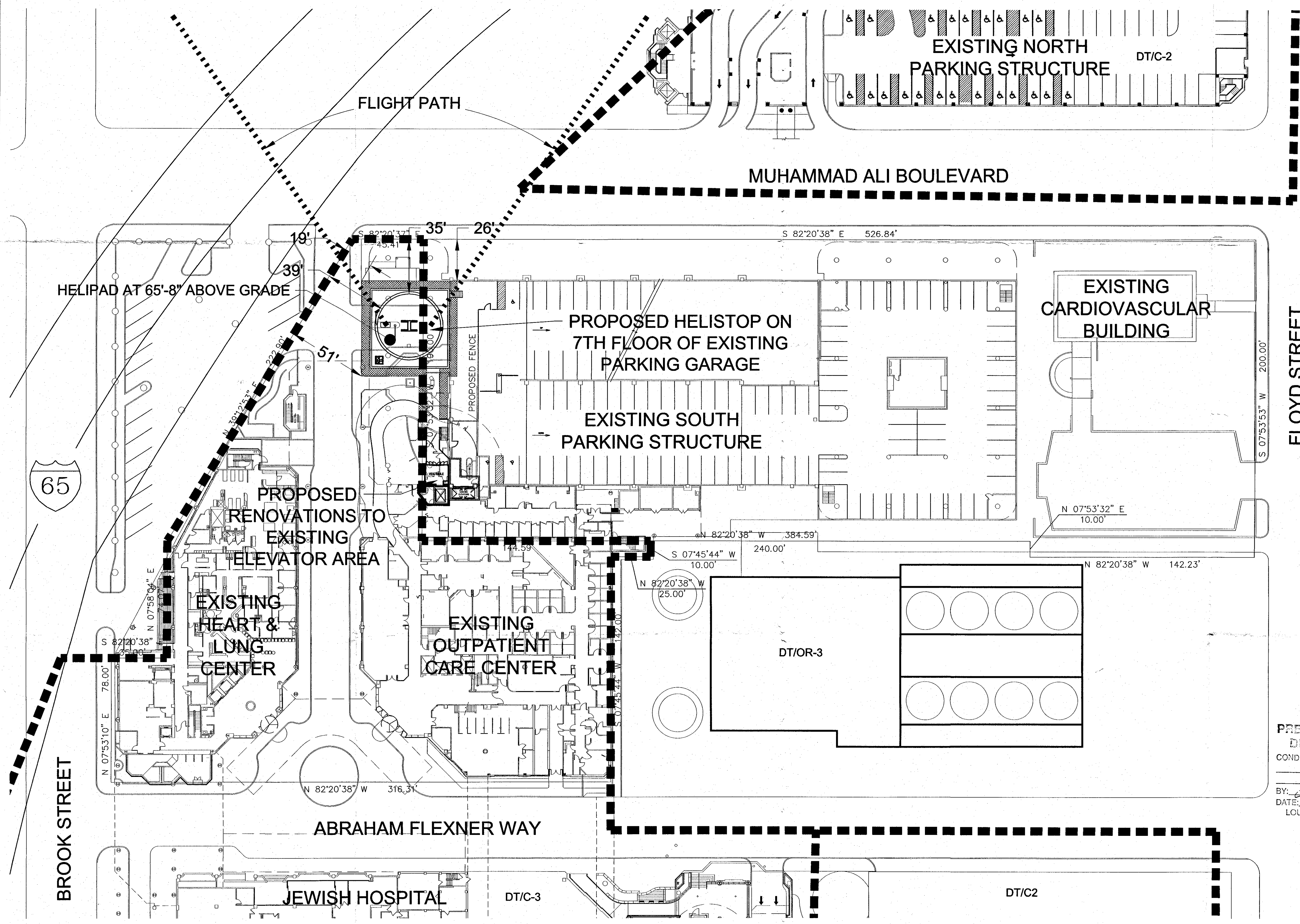

FLOYD STREET

PRELIMINARY APPROVAL  
 DEVELOPMENT PLAN

CONDITIONS: \_\_\_\_\_  
 BY: *Erin M. West*  
 DATE: 3-5-15  
 LOUISVILLE/JEFFERSON COUNTY  
 METRO PUBLIC WORKS

RECEIVED  
 FEB 23 2015  
 PLANNING &  
 DESIGN SERVICES

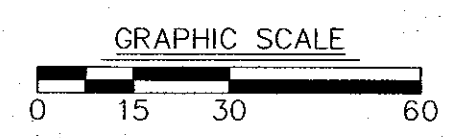

CASE # 15CUP1003  
 WM # 7378  
 RELATED CASE #: 09-013-92

OWNER/DEVELOPER  
 JEWISH HOSPITAL & ST.  
 MARY'S HEALTHCARE  
 250 ABRAHAM FLEXNER WAY  
 LOUISVILLE, KY 40202

NO.	REVISION	DATE
1	PRE-APP COMMENTS	02/23/15

REVISED DETAILED DISTRICT DEVELOPMENT PLAN  
 & CONDITIONAL USE PERMIT  
 KENTUCKYONE HEALTH JEWISH HELISTOP  
 250 ABRAHAM FLEXNER WAY & 236 E. MUHAMMAD ALI BLVD.  
 LOUISVILLE, KY 40202  
 TAX BLOCK 16M, LOT K1 & TAX BLOCK 16B, LOT 111  
 D.B. 9527, P.G. 385 & D.B. 7486, P.G. 695

JOB NO. 2013-93.01  
 SCALE: 1"=30'  
 DATE: 02/19/15

DRAWING NO:  
 CUP  
 COPYRIGHT 2015 - JRA, INC.

15CUP1003