

THE BEARING DATUM FOR THIS SURVEY IS BASED ON GRID NORTH AS IT RELATES TO THE KENTUCKY STATE PLANE COORDINATE SYSTEM, NORTH ZONE (NAD83).

- INDICATES PROPERTY CORNER (DEED)
- ⊠ INDICATES PROPOSED ROAD CLOSURE

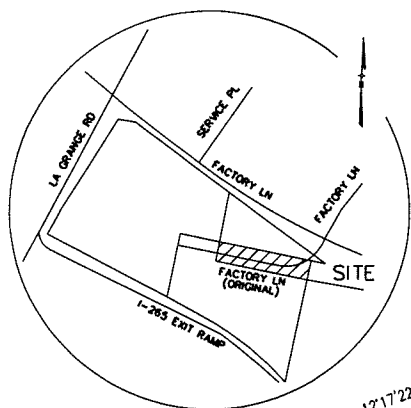
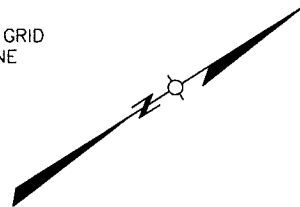

LOCATION MAP  
NO SCALE

Chasem Properties Inc.  
12903 Factory Lane  
D.B. 11321, PG. 969  
PO Box 43299,  
Louisville, KY 40253  
Z: C1 FD: SW

Atlantic Development Group, LLC  
12920 Factory Lane  
D.B. 11321, PG. 253  
PO Box 43299,  
Louisville, KY 40253  
1.358 Acres  
1.461 Acres (Net)  
Z: C1 FD: SW

Atlantic Development Group, LLC  
12908 Factory Lane  
D.B. 11410, PG. 680  
PO Box 43299,  
Louisville, KY 40253  
0.307 Acres  
0.121 Acres (Net)  
Z:R4 FD:SW

Factory Lane - 100' R/W  
D.B. 9266, PG. 835

Daugherty, Management LLC  
13000 Factory Lane  
D.B. 11368, PG. 640  
13010 Factory Lane  
Louisville, KY, 40245  
Z: OR FD: SW

LAND SURVEYOR'S CERTIFICATE

I, RICHARD C WILLIAMSON, JR, HEREBY CERTIFY THAT THE SURVEY DEPICTED BY THIS PLAT WERE MADE UNDER MY DIRECT SUPERVISION, AND THAT THE DIRECTIONAL AND LINEAR MEASUREMENTS SHOWN HEREON ARE TRUE AND CORRECT TO THE BEST OF MY KNOWLEDGE.

*Richard C. Williamson Jr*  
RICHARD C. WILLIAMSON JR  
LICENSED PROFESSIONAL LAND SURVEYOR # 4050  
DATE 8/19/2019

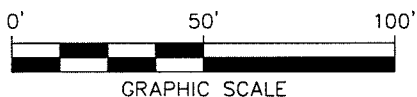

STATE OF KENTUCKY  
RICHARD C  
WILLIAMSON JR  
4050  
LICENSED  
PROFESSIONAL  
LAND SURVEYOR

Milestone



design group

108 Daventry Lane, Suite 300  
Louisville, KY 40223  
502.327.7073  
www.milestonedesign.org

FACTORY LANE CLOSURE PLAT

THE PURPOSE OF THIS PLAT IS TO SHOW THE LOCATION OF THE PROPOSED STREET CLOSURE

12920 & 12908 FACTORY LANE

ATLANTIC DEVELOPMENT GROUP, LLC  
PO BOX 43299  
LOUISVILLE, KY 40253  
D.B. 11321 PG. 253 D.B. 11410 PG. 680  
TAX BLOCK 0015, LOT 0151 TAX BLOCK 0015, LOT 0019,  
SUB-LOT 0002

JOB # 18017	DRAWN BY B.M.	CHECKED BY R.C.W.	DATE 6/3/2019	SCALE 1" = 50'
----------------	------------------	----------------------	------------------	-------------------