

**Planning Commission  
Staff Report**

January 16, 2014



<b>Case No:</b>	13zone1020
<b>Project Name:</b>	Germantown Mill Lofts
<b>Location:</b>	900, 910, & 946 Goss Avenue and 1318 McHenry Street
<b>Owner(s):</b>	Fincastle Investment Co.
<b>Applicant:</b>	Underhill Associates/ JTJ LLC.
<b>Representative(s):</b>	Underhill Associates/ JTJ LLC/Pimsler Hoss Architects
<b>Project Area/Size:</b>	7.7 acres
<b>Existing Zoning District:</b>	M-2
<b>Existing Form District:</b>	Traditional Workplace
<b>Jurisdiction:</b>	Louisville Metro
<b>Council District:</b>	4-David Tandy
<b>Case Manager:</b>	Julia Williams, Planner II

**REQUEST**

- Change in form district from Traditional Workplace to Traditional Neighborhood
- Change in zoning from M-2 to CR
- Variance to exceed the minimum height requirement for signage
- Waiver from Chapter 10 to permit an existing building to encroach into a landscape buffer area along the north property line and to not provide the 6' screen.
- Permit exceptional signage on the existing buildings smokestack/tower
- District Development plan

**CASE SUMMARY/BACKGROUND/SITE CONTEXT**

A combination of contractors' shops, retail or wholesale stores and offices have been in his location since 1971. The property was known originally as the Louisville Cotton Mills, but is now known as the Goss Avenue Antique Mall. The 7.7 acre site contains several buildings. Some structures are proposed to be demolished but most are to remain to be re-purposed as a mixed use development that includes commercial and residential. The property is bounded by Goss Avenue on the north, Ash Street to the south, McHenry Street to the east and a railroad line to the west.

**LAND USE/ZONING DISTRICT/FORM DISTRICT TABLE**

	<b>Land Use</b>	<b>Zoning</b>	<b>Form District</b>
<b>Subject Property</b>			
<b>Existing</b>	Commercial	M-2	Traditional Workplace
<b>Proposed</b>	Commercial/Residential	C-R	Traditional Neighborhood
<b>Surrounding Properties</b>			
<b>North</b>	Residential/Industrial	R-6/M-2	Traditional Neighborhood/ Traditional Workplace
<b>South</b>	Residential	R-6	Traditional Neighborhood
<b>East</b>	Residential	R-6	Traditional Neighborhood
<b>West</b>	Commercial	C-1	Traditional Workplace

## PREVIOUS CASES ON SITE

14670- Appeal of a Refusal Letter. Non-conforming rights were being claimed for the daycare and the request was to change from one non-conforming use, (commercial/industrial use) to another non-conforming use, (day care facility).

## INTERESTED PARTY COMMENTS

None received.

## APPLICABLE PLANS AND POLICIES

- Cornerstone 2020
- Land Development Code

Criteria for granting the proposed form district change/rezoning: KRS Chapter 100.213

1. The proposed form district/rezoning change complies with the applicable guidelines and policies Cornerstone 2020; OR
2. The existing form district/zoning classification is inappropriate and the proposed classification is appropriate; OR
3. There have been major changes of an economic, physical, or social nature within the area involved which were not anticipated in Cornerstone 2020 which have substantially altered the basic character of the area.

Following is staff's analysis of the proposed rezoning against the Guidelines and Policies of Cornerstone 2020.

### The site is located in the Traditional Workplace Form District

A Traditional Workplace is a form characterized by predominantly small to medium scale industrial and employment uses. The streets are typically narrow, in a grid pattern and often have alleys. Buildings have little or no setback from the street. Traditional workplaces are often closely integrated with residential areas and allow a mixture of industrial, commercial and office uses. New housing opportunities should be allowed as well as civic and community uses.

Traditional workplaces should be served by public transportation. Because of the close proximity to residential areas, parking should be encouraged to be located mostly off street and behind buildings. There should be adequate buffering of nearby neighbors from noise, odors, lighting and similar conditions. In order to encourage reinvestment, rehabilitation and redevelopment in these areas, flexible and creative site design should be encouraged along with a respect for the traditional pattern of development in the surrounding area.

### The site is proposed to be located in the Traditional Neighborhood Form District

The Traditional Neighborhood Form District is characterized by predominantly residential uses, by a grid pattern of streets with sidewalks and often including alleys. Residential lots are predominantly narrow and often deep, but the neighborhood may contain sections of larger estate lots, and also sections of lots on which appropriately integrated higher density residential uses may be located. The higher density uses are encouraged to be located in centers or near parks and open spaces having sufficient carrying capacity. There is usually a significant range of housing opportunities, including multi-family dwellings.

Traditional neighborhoods often have and are encouraged to have a significant proportion of public open space such as parks or greenways, and may contain civic uses as well as appropriately located and integrated neighborhood centers with a mixture of mostly neighborhood-serving land uses such as offices, shops, restaurants and services. Although many existing traditional neighborhoods are fifty to one hundred twenty years old, it is hoped that the Traditional Neighborhood Form will be revitalized under the new Comprehensive Plan. Revitalization and reinforcement of the Traditional Neighborhood Form will require particular emphasis on (a) preservation and renovation of existing buildings in stable neighborhoods (if the building design is consistent with the predominant building design in those neighborhoods), (b) the preservation of the existing grid pattern of streets and alleys, (c) preservation of public open spaces.

The proposal meets the guidelines of Cornerstone 2020 as the site is preserving a historic structure for the repurposing from industrial to apartments. The form district change compliments the proposed zoning district and repurpose of the structure as the zoning is to permit residential and neighborhood oriented commercial uses. Open space is being provided to contribute to the development and neighborhood. The signage proposed on the smokestack identifies the proposed development while also identifying the history and location of the development.

All other agency comments should be addressed to demonstrate compliance with the remaining Guidelines and Policies of Cornerstone 2020.

A checklist is attached to the end of this staff report with a more detailed analysis. The Louisville Metro Planning Commission is charged with making a recommendation to the Louisville Metro Council regarding the appropriateness of this zoning map amendment. The Louisville Metro Council has zoning authority over the property in question.

#### **STANDARD OF REVIEW AND STAFF ANALYSIS FOR VARIANCE**

(a) The requested variance will not adversely affect the public health, safety or welfare.

STAFF: The variance is to permit a sign to be located on an existing smokestack associated with the historic structure. The sign will be located where it will not interfere with the public.

(b) The requested variance will not alter the essential character of the general vicinity.

STAFF: Having a sign located on the existing smokestack will not alter the character of the area because the smokestack is existing and already part of the character of the area. Adding a sign to the smokestack will identify the historic use of the site as well as the neighborhood.

(c) The requested variance will not cause a hazard or nuisance to the public.

STAFF: The smokestack sign is not located where it will affect the public as it is located on an existing structure interior to the site.

(d) The requested variance will not allow an unreasonable circumvention of the zoning regulations.

The following design guidelines further clarify this criterion:

1. Proposals for sign area and height modifications in excess of 25% of what is permitted by chapter 8 should be carefully scrutinized to ensure compatibility with surrounding development.
2. The proposed sign is in compliance with the underlying form district as described within Cornerstone 2020, typically the type of neighborhood, character of the area and traffic speeds should be considered in the design of a sign.
3. The proposed sign should be visually consistent with the architecture, materials, colors and overall design of the building(s) which it identifies.

4. Generally, all colors, except fluorescent, may be allowable depending on their relationships to architecture, the business, and the surrounding neighborhood.
5. Signs should have an individual character and should not be designed to mimic signs on adjacent properties.
6. Signs should be clearly readable, information should be limited.
7. For attached signage the architectural design of the building may influence the location of the sign on the structure.
8. Light backgrounds are discouraged on internally illuminated signs because visibility is lowered by a "wrap around" effect.
9. Signs located within overlay districts and/or local landmarks district should be reviewed in accordance with guidelines of the applicable district.
10. Lighted signs should be designed so that they are not unnecessarily bright.
11. The scale of signs should be appropriate for the building on which they are placed and the area in which they are located. The size and shape of a sign should be proportionate with the scale of the structure.
12. Because residential and commercial uses generally exist in close proximity, signs should be designed and located so that they have little or no impact on adjacent residential neighborhoods.
13. Place wall signs to establish facade rhythm, scale and proportion where facade rhythm doesn't exist. On buildings that have a monolithic or plain facade, signs can establish or continue appropriate design rhythm, scale, and proportion.
14. Pedestrian-oriented signs are encouraged. It is desirable and encouraged to include a pedestrian-oriented sign as one of the permitted signs for a business. Pedestrian-oriented signs are signs that are designed for and directed toward pedestrians so that they can easily and comfortably read the sign as they stand adjacent to the business.
15. Select colors carefully. Color is one of the most important aspects of visual communication -- it can be used to catch the eye or to communicate ideas or feelings. Colors should be selected to contribute to legibility and design integrity. Even the most carefully thought out sign may be unattractive and a poor communicator because of poor color selection. Too many colors used thoughtlessly can confuse and negate the message of a sign.
16. Use contrasting colors. Contrast is an important influence on the legibility of signs. A substantial contrast should be provided between the color and material of the background and the letters or symbols to make the sign easier to read in both day and night. Light letters on a dark background or dark letters on a light background are most legible.
17. Limit the number of letter styles. The number of lettering styles should be limited in order to increase legibility. A general rule to follow is to limit the number of different letter types to no more than two for small signs and three for larger signs. Intricate typefaces and symbols that are difficult to read reduce the sign's ability to communicate.
18. Significant signage. The preservation of designated signature signs may be used to justify increases in overall sign area limits as long as the integrity of the signature sign is maintained and any new signage is deemed to be compatible to the signature sign.

STAFF: The proposed sign is to be located on an existing smokestack where the letters will both identify the historic nature of the site and the neighborhood which it is located. The sign is not a type of advertising sign that motorists would be familiar or where the sign would be a distraction to motorists. The type of letters proposed compliment the architecture and identify the site for its historic nature within the neighborhood. Information on the sign is limited as the sign will just be letters.

#### ADDITIONAL CONSIDERATIONS:

1. The requested variance arises from special circumstances which do not generally apply to land in the general vicinity or the same zone.

The following design guidelines further clarify this criterion:

1. Elevation changes between properties and adjacent streets should be reviewed to ensure that signage is appropriately visible to the street;

2. The transportation department responsible for the adjacent public streets must review the plans for freestanding signs to ensure conformance with safety standards prior to approval by the board

STAFF: The circumstance of the variance is that the smokestack and associated buildings are historic which is unique for the neighborhood to have a large previously industrial building so close to residential. The signage will be visible further down the street but would not likely be visible to a pedestrian on the street. The proposal is for attached signage that will not affect transportation and sight distance.

2. The strict application of the provisions of the regulation would deprive the applicant of the reasonable use of the land or create an unnecessary hardship on the applicant.

The following design guidelines further clarify this criterion:

1. The transportation department responsible for the adjacent public streets must review the plans for freestanding signs to ensure conformance with safety standards prior to approval by the board.
2. The SRB should review the layout of the land and surrounding property to determine whether relief is warranted.

STAFF: Not granting the variance would not be a hardship on the applicant but the purpose of the sign is to identify the historic nature of the site in the neighborhood and to identify the neighborhood.

3. The circumstances are the result of actions of the applicant taken subsequent to the adoption of the zoning regulation from which relief is sought.

STAFF: The exceptional signage and its location is an action taken by the applicant after the adoption of the regulation. The circumstance of the signage is to identify the historic nature of the site and neighborhood.

#### STANDARD OF REVIEW AND STAFF ANALYSIS FOR WAIVER

(a) The waiver will not adversely affect adjacent property owners; and

STAFF: The waiver will not affect adjacent property owners because the adjacent property is a railroad and commercial property.

(b) The waiver will not violate specific guidelines of Cornerstone 2020.

STAFF: The site will still be providing the planting materials required for the buffer with the exception of the 6' screen.

(c) The extent of the waiver of the regulation is the minimum necessary to afford relief to the applicant

STAFF: The existing building encroaches into the buffer. The relief associated here is so that the applicant does not have to demolish a portion of the historic structure to accommodate the full buffer.

(d) Either:

(i) The applicant has incorporated other design measures that exceed the minimums of the district and compensate for non-compliance with the requirements to be waived (net beneficial effect); OR

(ii) The strict application of the provisions of the regulation would deprive the applicant of the reasonable use of the land or would create an unnecessary hardship on the applicant.

STAFF: Demolishing part of a historic structure to provide the buffer would be an unnecessary hardship.

## STANDARD OF REVIEW FOR DEVELOPMENT PLAN

- a. The conservation of natural resources on the property proposed for development, including: trees and other living vegetation, steep slopes, water courses, flood plains, soils, air quality, scenic views, and historic sites;

STAFF: The proposal preserves a historic site and structures for residential and commercial repurposing.

- b. The provisions for safe and efficient vehicular and pedestrian transportation both within the development and the community;

STAFF: Pedestrian and vehicular connectivity is found throughout the proposal.

- c. The provision of sufficient open space (scenic and recreational) to meet the needs of the proposed development;

STAFF: Open space is provided on the site to meet the needs of the development and neighborhood.

- d. The provision of adequate drainage facilities on the subject site in order to prevent drainage problems from occurring on the subject site or within the community;

STAFF: MSD has preliminarily approved the proposal.

- e. The compatibility of the overall site design (location of buildings, parking lots, screening, landscaping) and land use or uses with the existing and projected future development of the area;

STAFF: The sites only change is the addition of parking in the rear of the site. That parking will be buffered from the adjacent residential located across the roadways where there is currently parking and no buffering.

- f. Conformance of the development plan with the Comprehensive Plan and Land Development Code.

STAFF: The proposal meets the guidelines of the Comprehensive Plan and requirements of the Land Development Code.

## TECHNICAL REVIEW

Too many signs along McHenry, either the daycare sign or the proposed sign at the McHenry entrance needs to be removed.

## STAFF CONCLUSIONS

The proposal meets the guidelines of the Comprehensive Plan and requirements of the Land Development Code.

Based upon the information in the staff report, the testimony and evidence provided at the public hearing, the Planning Commission must determine if the proposal is in conformance with the Comprehensive Plan; OR the existing form district/zoning classification is inappropriate and the proposed classification is appropriate; OR if there have been major changes of an economic, physical, or social nature within the area involved which were not anticipated in Cornerstone 2020 which have substantially altered the basic character of the area.

## NOTIFICATION

Date	Purpose of Notice	Recipients
11/27/13	Hearing before LD&T on 12/12/13	1 <sup>st</sup> and 2 <sup>nd</sup> tier adjoining property owners Subscribers of Council District 4 Notification of Development Proposals
12/24/13	Hearing before PC	1 <sup>st</sup> and 2 <sup>nd</sup> tier adjoining property owners Subscribers of Council District 4 Notification of Development Proposals
12/18/13	Hearing before PC	Sign Posting on property
1/3/14	Hearing before PC	Legal Advertisement in the Courier-Journal

## ATTACHMENTS

1. Zoning Map
2. Aerial Photograph
3. Cornerstone 2020 Staff Checklist
4. Proposed Binding Elements
5. Applicant's Variance Justification

Attachment 1: Zoning Map

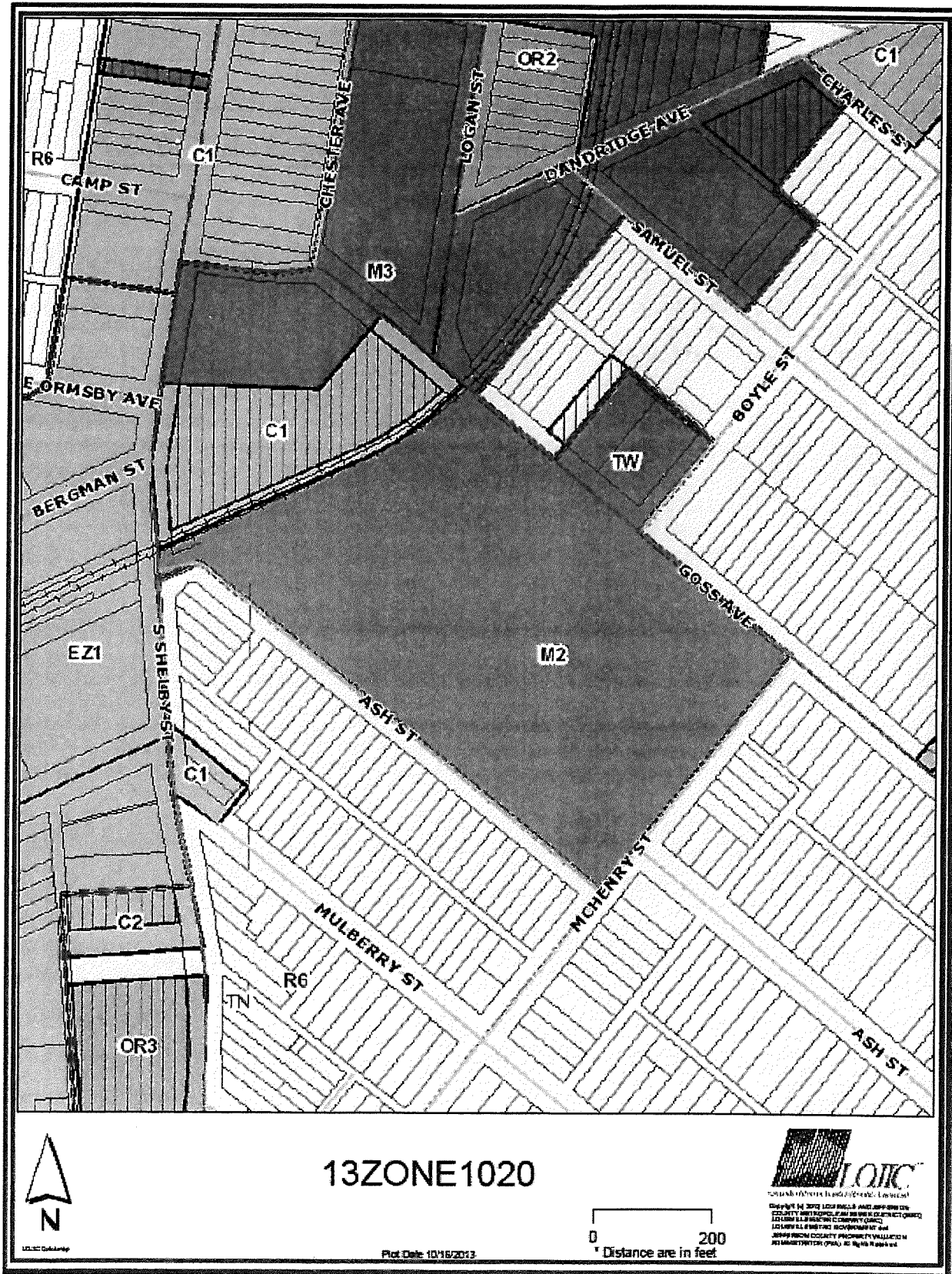



Attachment 2: Aerial Photograph



### Attachment 3: Cornerstone 2020 Staff Checklist

- + Exceeds Guideline
- √ Meets Guideline
- +/- More Information Needed
- NA Not Applicable

#	Cornerstone 2020 Guidelines & Policies	Cornerstone 2020 Plan Element	Plan Element or Portion of Plan Element	Staff Finding	Staff Comments
1	Form Districts Goals C1-C4, Objectives C1.1-1.2, C2.1-2.7, C3.1-3.7, C4.1.-4.7	Community Form/Land Use Guideline 1: Community Form	B.2: The proposal preserves the existing grid pattern of streets, sidewalks and alleys.	√	The proposal does not affect the existing street pattern. Sidewalks are provided within all rights of way.
2	Form Districts Goals C1-C4, Objectives C1.1-1.2, C2.1-2.7, C3.1-3.7, C4.1.-4.7	Community Form/Land Use Guideline 1: Community Form	B.2: The proposal introduces an appropriately-located neighborhood center including a mix of neighborhood-serving uses such as offices, shops and restaurants.	√	The proposal is for a zoning district that permits neighborhood serving uses.
3	Form Districts Goals C1-C4, Objectives C1.1-1.2, C2.1-2.7, C3.1-3.7, C4.1.-4.7	Community Form/Land Use Guideline 1: Community Form	B.2: The proposal preserves public open spaces, and if the proposal is a higher density use, is located in close proximity to such open space, a center or other public areas.	√	The proposal preserves public open spaces and the public realm of the right of way. New open spaces are created with the proposal.
4	Form Districts Goals C1-C4, Objectives C1.1-1.2, C2.1-2.7, C3.1-3.7, C4.1.-4.7	Community Form/Land Use Guideline 1: Community Form	B.2: The proposal preserves and renovates existing buildings if the building design of these structures is consistent with the predominate neighborhood building design.	√	The proposal is for the preservation and renovation of existing buildings for commercial or residential purposes. The existing structure is historic and represents the industrial past of the neighborhood.
5	Form Districts Goals C1-C4, Objectives C1.1-1.2, C2.1-2.7, C3.1-3.7, C4.1.-4.7	Community Form/Land Use Guideline 2: Centers	A.1/7: The proposal, which will create a new center, is located in the Traditional Neighborhood Form District, and includes new construction or the reuse of existing buildings to provide commercial, office and/or residential use.	√	The proposal will not create a new center but is considered a repurposing of an existing center. The proposal is located in the TWFD with a proposed change to TNFD to keep with the surrounding form district and to be more in keeping with the proposed residential and commercial uses.
6	Form Districts Goals C1-C4, Objectives C1.1-1.2, C2.1-2.7, C3.1-3.7, C4.1.-4.7	Community Form/Land Use Guideline 2: Centers	A.3: The proposed retail commercial development is located in an area that has a sufficient population to support it.	√	The proposal is located in a higher density single family residential neighborhood.
7	Form Districts Goals C1-C4, Objectives C1.1-1.2, C2.1-2.7, C3.1-3.7, C4.1.-4.7	Community Form/Land Use Guideline 2: Centers	A.4: The proposed development is compact and results in an efficient land use pattern and cost-effective infrastructure investment.	√	The proposal is compact and results in an effective land use pattern with its down zone from M_2 to C-R and change in form from TW to TN. The areas infrastructure is already set up to serve an industrial which indicates it will be able to serve residential as well, which is cost effective.
8	Form Districts Goals C1-C4, Objectives C1.1-1.2, C2.1-2.7, C3.1-3.7, C4.1.-4.7	Community Form/Land Use Guideline 2: Centers	A.5: The proposed center includes a mix of compatible land uses that will reduce trips, support the use of alternative forms of transportation and encourage vitality and sense of place.	√	The proposal is for mixed use which will reduce trips and will support alternate transportation with sidewalks around the site. Transit is located nearby along Shelby Street which will serve the site as well.
9	Form Districts Goals C1-C4, Objectives C1.1-1.2, C2.1-2.7, C3.1-3.7, C4.1.-4.7	Community Form/Land Use Guideline 2: Centers	A.6: The proposal incorporates residential and office uses above retail and/or includes other mixed-use, multi-story retail buildings.	√	The proposal is for mixed use, residential and commercial.

#	Cornerstone 2020 Guidelines & Policies	Cornerstone 2020 Plan Element	Plan Element or Portion of Plan Element	Staff Finding	Staff Comments
10	Form Districts Goals C1-C4, Objectives C1.1-1.2, C2.1-2.7, C3.1-3.7, C4.1-4.7	Community Form/Land Use Guideline 2: Centers	A.12: If the proposal is a large development in a center, it is designed to be compact and multi-purpose, and is oriented around a central feature such as a public square or plaza or landscape element.	√	The proposal is an existing large development that is mixed use. The proposal is utilizing existing historic structures on the site as its central features.
11	Form Districts Goals C1-C4, Objectives C1.1-1.2, C2.1-2.7, C3.1-3.7, C4.1-4.7	Community Form/Land Use Guideline 2: Centers	A.13/15: The proposal shares entrance and parking facilities with adjacent uses to reduce curb cuts and surface parking, and locates parking to balance safety, traffic, transit, pedestrian, environmental and aesthetic concerns.	√	The proposal is located on a city block with no opportunities for shared entrances. The proposal has 2 entrances/exits to the site and the site is for mixed use.
12	Form Districts Goals C1-C4, Objectives C1.1-1.2, C2.1-2.7, C3.1-3.7, C4.1-4.7	Community Form/Land Use Guideline 2: Centers	A.14: The proposal is designed to share utility hookups and service entrances with adjacent developments, and utility lines are placed underground in common easements.	√	Utilities for the site are existing and will be shared with the other uses on the site.
13	Form Districts Goals C1-C4, Objectives C1.1-1.2, C2.1-2.7, C3.1-3.7, C4.1-4.7	Community Form/Land Use Guideline 2: Centers	A.16: The proposal is designed to support easy access by bicycle, car and transit and by pedestrians and persons with disabilities.	√	The proposal has two entrances/exits, sidewalks, and transit located nearby along Shelby Street. Bicycles will use the same facilities as other vehicles. Access to the facilities exists throughout the site.
14	Form Districts Goals C1-C4, Objectives C1.1-1.2, C2.1-2.7, C3.1-3.7, C4.1-4.7	Community Form/Land Use Guideline 3: Compatibility	A.2: The proposed building materials increase the new development's compatibility.	NA	No new construction is proposed.
15	Form Districts Goals C1-C4, Objectives C1.1-1.2, C2.1-2.7, C3.1-3.7, C4.1-4.7	Community Form/Land Use Guideline 3: Compatibility	A.4/5/6/7: The proposal does not constitute a non-residential expansion into an existing residential area, or demonstrates that despite such an expansion, impacts on existing residences (including traffic, parking, signs, lighting, noise, odor and stormwater) are appropriately mitigated.	√	The proposal is not a non-residential expansion into a residential area because the site is already zoned non-residentially. The proposal for mixed use brings the site more into compliance with the surrounding residential as it proposes both residential and commercial.
16	Form Districts Goals C1-C4, Objectives C1.1-1.2, C2.1-2.7, C3.1-3.7, C4.1-4.7	Community Form/Land Use Guideline 3: Compatibility	A.5: The proposal mitigates any potential odor or emissions associated with the development.	√	APCD has no issues with the proposal.
17	Form Districts Goals C1-C4, Objectives C1.1-1.2, C2.1-2.7, C3.1-3.7, C4.1-4.7	Community Form/Land Use Guideline 3: Compatibility	A.6: The proposal mitigates any adverse impacts of its associated traffic on nearby existing communities.	√	Transportation Planning has not indicated any adverse impacts to traffic.
18	Form Districts Goals C1-C4, Objectives C1.1-1.2, C2.1-2.7, C3.1-3.7, C4.1-4.7	Community Form/Land Use Guideline 3: Compatibility	A.8: The proposal mitigates adverse impacts of its lighting on nearby properties, and on the night sky.	√	Lighting will meet LDC requirements.
19	Form Districts Goals C1-C4, Objectives C1.1-1.2, C2.1-2.7, C3.1-3.7, C4.1-4.7	Community Form/Land Use Guideline 3: Compatibility	A.11: If the proposal is a higher density or intensity use, it is located along a transit corridor AND in or near an activity center.	√	The proposal is an existing activity center and is located near a transit route along Shelby Street.

#	Cornerstone 2020 Guidelines & Policies	Cornerstone 2020 Plan Element	Plan Element or Portion of Plan Element	Staff Finding	Staff Comments
20	Form Districts Goals C1-C4, Objectives C1.1-1.2, C2.1-2.7, C3.1-3.7, C4.1-4.7	Community Form/Land Use Guideline 3: Compatibility	A.21: The proposal provides appropriate transitions between uses that are substantially different in scale and intensity or density of development such as landscaped buffer yards, vegetative berms, compatible building design and materials, height restrictions, or setback requirements.	√	Buffers are being provided between the property and the adjacent railroad and between the roadways and the parking lot.
21	Form Districts Goals C1-C4, Objectives C1.1-1.2, C2.1-2.7, C3.1-3.7, C4.1-4.7	Community Form/Land Use Guideline 3: Compatibility	A.22: The proposal mitigates the impacts caused when incompatible developments unavoidably occur adjacent to one another by using buffers that are of varying designs such as landscaping, vegetative berms and/or walls, and that address those aspects of the development that have the potential to adversely impact existing area developments.	√	Buffers are being provided between the property and the adjacent railroad and between the roadways and the parking lot.
22	Form Districts Goals C1-C4, Objectives C1.1-1.2, C2.1-2.7, C3.1-3.7, C4.1-4.7	Community Form/Land Use Guideline 3: Compatibility	A.23: Setbacks, lot dimensions and building heights are compatible with those of nearby developments that meet form district standards.	√	The buildings are existing with no new construction proposed.
23	Form Districts Goals C1-C4, Objectives C1.1-1.2, C2.1-2.7, C3.1-3.7, C4.1-4.7	Community Form/Land Use Guideline 3: Compatibility	A.24: Parking, loading and delivery areas located adjacent to residential areas are designed to minimize adverse impacts of lighting, noise and other potential impacts, and that these areas are located to avoid negatively impacting motorists, residents and pedestrians.	√	Buffers are being provided between the roadways and the parking lot.
24	Form Districts Goals C1-C4, Objectives C1.1-1.2, C2.1-2.7, C3.1-3.7, C4.1-4.7	Community Form/Land Use Guideline 3: Compatibility	A.24: The proposal includes screening and buffering of parking and circulation areas adjacent to the street, and uses design features or landscaping to fill gaps created by surface parking lots. Parking areas and garage doors are oriented to the side or back of buildings rather than to the street.	√	Buffers are being provided between the roadways and the parking lot.
25	Form Districts Goals C1-C4, Objectives C1.1-1.2, C2.1-2.7, C3.1-3.7, C4.1-4.7	Community Form/Land Use Guideline 3: Compatibility	A.25: Parking garages are integrated into their surroundings and provide an active, inviting street-level appearance.	NA	A parking garage is not proposed.
26	Form Districts Goals C1-C4, Objectives C1.1-1.2, C2.1-2.7, C3.1-3.7, C4.1-4.7	Community Form/Land Use Guideline 3: Compatibility	A.28: Signs are compatible with the form district pattern and contribute to the visual quality of their surroundings.	√	Signs are compatible with the area and add to the history and visual quality of the neighborhood.
27	Livability Goals H3 and H5, all related objectives	Community Form/Land Use Guideline 4: Open Space	A.2/3/7: The proposal provides open space that helps meet the needs of the community as a component of the development and provides for the continued maintenance of that open space.	√	Open space requirements on the site are being met to meet the needs of the community.
28	Livability Goals H3 and H5, all related objectives	Community Form/Land Use Guideline 4: Open Space	A.4: Open space design is consistent with the pattern of development in the Neighborhood Form District.	√	The proposal is in the TW form district but would contribute to the neighborhood by providing additional green space.

#	Cornerstone 2020 Guidelines & Policies	Cornerstone 2020 Plan Element	Plan Element or Portion of Plan Element	Staff Finding	Staff Comments
29	Livability Goals H3 and H5, all related objectives	Community Form/Land Use Guideline 4: Open Space	A.5: The proposal integrates natural features into the pattern of development.	√	Some existing trees are being preserved but the site is otherwise deficient on natural features.
30	Livability Goals H3 and H5, all related objectives	Community Form/Land Use Guideline 5: Natural Areas and Scenic and Historic Resources	A.1: The proposal respects the natural features of the site through sensitive site design, avoids substantial changes to the topography and minimizes property damage and environmental degradation resulting from disturbance of natural systems.	√	Some existing trees are being preserved but the site is otherwise deficient on natural features.
31	Livability Goals H3 and H5, all related objectives	Community Form/Land Use Guideline 5: Natural Areas and Scenic and Historic Resources	A.2/4: The proposal includes the preservation, use or adaptive reuse of buildings, sites, districts and landscapes that are recognized as having historical or architectural value, and, if located within the impact area of these resources, is compatible in height, bulk, scale, architecture and placement.	√	The proposal is for the adaptive reuse of existing historic structures.
31	Livability Goals H3 and H5, all related objectives	Community Form/Land Use Guideline 5: Natural Areas and Scenic and Historic Resources	A.6: Encourage development to avoid wet or highly permeable soils, severe, steep or unstable slopes with the potential for severe erosion.	√	Soils are not an issue for the site.
32	Land Use and Transportation Connection Goal E1, Objectives E1.1 and E1.3	Marketplace Guideline 6: Economic Growth and Sustainability	A.2: Ensure adequate access between employment centers and population centers.	√	The proposal is both a population center and employment center because the proposal is for mixed use.
33	People, Jobs and Housing Goal K4, Objective K4.1	Marketplace Guideline 6: Economic Growth and Sustainability	A.3: Encourage redevelopment, reinvestment and rehabilitation in the downtown where it is consistent with the form district pattern.	NA	The proposal is not located in a downtown.
34	Marketplace Strategy Goal A1, Objectives A1.3, A1.4, A1.5	Marketplace Guideline 6: Economic Growth and Sustainability	A.4: Encourage industries to locate in industrial subdivisions or adjacent to existing industry to take advantage of special infrastructure needs.	NA	The proposal is not for industrial.
35	Land Use and Transportation Connection Goal E1, Objectives E1.1 and E1.3	Marketplace Guideline 6: Economic Growth and Sustainability	A.6: Locate retail commercial development in activity centers. Locate uses generating large amounts of traffic on a major arterial, at the intersection of two minor arterials or at locations with good access to a major arterial and where the proposed use will not adversely affect adjacent areas.	√	The proposal is for mixed use located in an existing activity center located along a minor arterial. C-R zoning will have less impact on the adjacent residential than the current M-2 which permits non-neighborhood serving uses.
36	Land Use and Transportation Connection Goal E1, Objectives E1.1 and E1.3	Marketplace Guideline 6: Economic Growth and Sustainability	A.8: Require industrial development with more than 100 employees to locate on or near an arterial street, preferably in close proximity to an expressway interchange. Require industrial development with less than 100 employees to locate on or near an arterial street.	NA	The proposal is not for industrial.

#	Cornerstone 2020 Guidelines & Policies	Cornerstone 2020 Plan Element	Plan Element or Portion of Plan Element	Staff Finding	Staff Comments
37	Mobility Goals A1-A6, B1, C1, D1, E1, E2, F1, G1, H1-H4, I1-I7, all related Objectives	Mobility/Transportation Guideline 7: Circulation	A.1/2: The proposal will contribute its proportional share of the cost of roadway improvements and other services and public facilities made necessary by the development through physical improvements to these facilities, contribution of money, or other means.	√	Roadways improvements are not necessary with the proposal.
38	Mobility Goals A1-A6, B1, C1, D1, E1, E2, F1, G1, H1-H4, I1-I7, all related Objectives	Mobility/Transportation Guideline 7: Circulation	A.3/4: The proposal promotes mass transit, bicycle and pedestrian use and provides amenities to support these modes of transportation.	√	The proposal promotes all forms of transportation by providing sidewalks and parking around the uses.
39	Mobility Goals A1-A6, B1, C1, D1, E1, E2, F1, G1, H1-H4, I1-I7, all related Objectives	Mobility/Transportation Guideline 7: Circulation	A.6: The proposal's transportation facilities are compatible with and support access to surrounding land uses, and contribute to the appropriate development of adjacent lands. The proposal includes at least one continuous roadway through the development, adequate street stubs, and relies on cul-de-sacs only as short side streets or where natural features limit development of "through" roads.	√	The proposal does not have the ability to provide access to adjacent land uses because the lot takes up a city block and is constrained by a railroad as well.
40	Mobility Goals A1-A6, B1, C1, D1, E1, E2, F1, G1, H1-H4, I1-I7, all related Objectives	Mobility/Transportation Guideline 7: Circulation	A.9: The proposal includes the dedication of rights-of-way for street, transit corridors, bikeway and walkway facilities within or abutting the development.	√	Right of way is not required to be dedicated.
41	Mobility Goals A1-A6, B1, C1, D1, E1, E2, F1, G1, H1-H4, I1-I7, all related Objectives	Mobility/Transportation Guideline 7: Circulation	A.10: The proposal includes adequate parking spaces to support the use.	√	Adequate parking is being provided.
42	Mobility Goals A1-A6, B1, C1, D1, E1, E2, F1, G1, H1-H4, I1-I7, all related Objectives	Mobility/Transportation Guideline 7: Circulation	A.13/16: The proposal provides for joint and cross access through the development and to connect to adjacent development sites.	√	Joint and cross access is not necessary because the site is constrained by roadways and a railroad.
43	Mobility Goals A1-A6, B1, C1, D1, E1, E2, F1, G1, H1-H4, I1-I7, all related Objectives	Mobility/Transportation Guideline 8: Transportation Facility Design	A.8: Adequate stub streets are provided for future roadway connections that support and contribute to appropriate development of adjacent land.	√	A stub street is not necessary because the site is constrained by roadways and a railroad.
44	Mobility Goals A1-A6, B1, C1, D1, E1, E2, F1, G1, H1-H4, I1-I7, all related Objectives	Mobility/Transportation Guideline 8: Transportation Facility Design	A.9: Avoid access to development through areas of significantly lower intensity or density if such access would create a significant nuisance.	√	Access to the development is through public rights of way.
45	Mobility Goals A1-A6, B1, C1, D1, E1, E2, F1, G1, H1-H4, I1-I7, all related Objectives	Mobility/Transportation Guideline 8: Transportation Facility Design	A.11: The development provides for an appropriate functional hierarchy of streets and appropriate linkages between activity areas in and adjacent to the development site.	√	The existing roadways provide the appropriate linkages to other development.

#	Cornerstone 2020 Guidelines & Policies	Cornerstone 2020 Plan Element	Plan Element or Portion of Plan Element	Staff Finding	Staff Comments
43	Mobility Goals A1-A6, B1, C1, D1, E1, E2, F1, G1, H1-H4, I1-I7, all related Objectives	Mobility/Transportation Guideline 9: Bicycle, Pedestrian and Transit	A.1/2: The proposal provides, where appropriate, for the movement of pedestrians, bicyclists and transit users around and through the development, provides bicycle and pedestrian connections to adjacent developments and to transit stops, and is appropriately located for its density and intensity.	√	Sidewalks are provided for transit users and pedestrians. Sidewalks are located throughout the site.
44	Livability, Goals B1, B2, B3, B4, Objectives B1.1-1.8, B2.1-2.7, B3.1-3.4, B4.1-4.3	Livability/Environment Guideline 10: Flooding and Stormwater	The proposal's drainage plans have been approved by MSD, and the proposal mitigates negative impacts to the floodplain and minimizes impervious area. Solid blue-line streams are protected through a vegetative buffer, and drainage designs are capable of accommodating upstream runoff assuming a fully-developed watershed. If streambank restoration or preservation is necessary, the proposal uses best management practices.	√	MSD has preliminarily approved the proposal.
45	Livability Goals C1, C2, C3, C4, all related Objectives	Livability/Environment Guideline 12: Air Quality	The proposal has been reviewed by APCD and found to not have a negative impact on air quality.	√	APCD has no issues with the proposal.
44	Livability, Goals F1 and F2, all related objectives	Livability/Environment Guideline 13: Landscape Character	A.3: The proposal includes additions and connections to a system of natural corridors that can provide habitat areas and allow for migration.	√	Natural corridors are not evident in or around the proposal.
46	Quality of Life Goal J1, Objectives J1.1-1.2	Community Facilities Guideline 14: Infrastructure	A.2: The proposal is located in an area served by existing utilities or planned for utilities.	√	Existing utilities serve the site.
47	Quality of Life Goal J1, Objectives J1.1-1.2	Community Facilities Guideline 14: Infrastructure	A.3: The proposal has access to an adequate supply of potable water and water for fire-fighting purposes.	√	Water is available to the site.
48	Livability Goal B1, Objective B1.3	Community Facilities Guideline 14: Infrastructure	A.4: The proposal has adequate means of sewage treatment and disposal to protect public health and to protect water quality in lakes and streams.	√	MSD has preliminarily approved the proposal.

#### Attachment 4: Proposed Binding Elements

1. The development shall be in accordance with the approved district development plan, all applicable sections of the Land Development Code (LDC) and agreed upon binding elements unless amended pursuant to the Land Development Code. Any changes/additions/alterations of any binding element(s) shall be submitted to the Planning Commission or the Planning Commission's designee for review and approval; any changes/additions/alterations not so referred shall not be valid.
2. The development shall not exceed 246,643 square feet of gross floor area.
3. No outdoor advertising signs, small freestanding signs, pennants, balloons, or banners shall be permitted on the site.
4. Construction fencing shall be erected when off-site trees or tree canopy exists within 3' of a common property line. Fencing shall be in place prior to any grading or construction to protect the existing root systems from compaction. The fencing shall enclose the entire area beneath the tree canopy and shall remain in place until all construction is completed. No parking, material storage or construction activities are permitted within the protected area.
5. Before any permit (including but not limited to building, parking lot, change of use, site disturbance, alteration permit or demolition permit) is requested:
  - a. The development plan must receive full construction approval from Louisville Metro Department of Inspections, Permits and Licenses, Louisville Metro Public Works and the Metropolitan Sewer District.
  - b. Encroachment permits must be obtained from the Kentucky Department of Transportation, Bureau of Highways.
  - c. The property owner/developer must obtain approval of a detailed plan for screening (buffering/landscaping) as described in Chapter 10 prior to receiving a building permit. Such plan shall be implemented prior to occupancy of the site and shall be maintained thereafter.
6. A certificate of occupancy must be received from the appropriate code enforcement department prior to occupancy of the structure or land for the proposed use. All binding elements requiring action and approval must be implemented prior to requesting issuance of the certificate of occupancy, unless specifically waived by the Planning Commission.
7. There shall be no outdoor music (live, piped, radio or amplified) or outdoor entertainment or outdoor PA system audible beyond the property line.
8. The applicant, developer, or property owner shall provide copies of these binding elements to tenants, purchasers, contractors, subcontractors and other parties engaged in development of this site and shall advise them of the content of these binding elements. These binding elements shall run with the land and the owner of the property and occupant of the property shall at all times be responsible for compliance with these binding elements. At all times during development of the site, the applicant and developer, their heirs, successors; and assignees, contractors, subcontractors, and other parties engaged in development of the site, shall be responsible for compliance with these binding elements.



## Attachment 5: Applicant's Variance Justification

This is a variance from Section Table 8.3.2 of the Land Development Code, to allow the combined sign areas attached to each side of the smokestack to exceed 60 square feet per side and to allow the signs attached to the smokestack be located above the roofline.

### **Variance Justification:**

In order to justify approval of any variance, the Board of Zoning Adjustment considers the following criteria. Please answer all of the following items. Use additional sheets if needed. A response of yes, no, or N/A is not acceptable.

1. Explain how the variance will not adversely affect the public health, safety or welfare.

The signage will not impact health, safety nor welfare – signage is proposed to be higher and more extensive than that allowed by ordinance and will be visually pleasing, securely fastened to the smokestack and help identify the neighborhood and the project.

2. Explain how the variance will not alter the essential character of the general vicinity.

Once the redevelopment project is implemented, identification signage will be helpful in reinforcing the character of the project. The residential neighborhood will not be impacted negatively and will not alter the character of the surrounding district.

3. Explain how the variance will not cause a hazard or a nuisance to the public.

There is no hardship to the public and with the signs being tastefully designed and implemented, there should be no perceived nuisance to the public.

4. Explain how the variance will not allow an unreasonable circumvention of the requirements of the zoning regulations.

This is an exceptional site with unusual characteristics and the development team is attempting to clarify the goals for project signage and identification and not attempting to circumvent the zoning regulations but rather make what appears to be a reasonable request for additional signage.

### *Additional consideration:*

1. Explain how the variance arises from special circumstances, which do not generally apply to land in the general vicinity (please specify/identify).

The existing smokestack is quite unusual and is a focal point for the development. There is likely not another element such as this in the entire community.

2. Explain how the strict application of the provisions of the regulation would deprive the applicant of the reasonable use of the land or would create unnecessary hardship.

The request for additional signage on the smokestack only denies the opportunity for creating an identifiable and recognizable icon for the property and the community at large. The hardship creates signage that is very small for the size of the existing smokestack and likely unrecognizable.

3. Are the circumstances the result of actions of the applicant taken subsequent to the adoption of the regulation which relief is sought?

No, the request for variation from the sign regulations is not the result of actions taken subsequent to the adoption of the current regulations.

# Land Development and Transportation Staff Report

December 12, 2013



*all bldgs on site  
will be  
on National  
Register*

<b>Case No:</b>	13zone1020
<b>Project Name:</b>	Germantown Mill Lofts
<b>Location:</b>	900, 910, & 946 Goss Avenue and 1318 McHenry Street
<b>Owner(s):</b>	Fincastle Investment Co.
<b>Applicant:</b>	Underhill Associates/ JTJ LLC.
<b>Representative(s):</b>	Underhill Associates/ JTJ LLC/Pimsler Hoss Architects
<b>Project Area/Size:</b>	7.7 acres
<b>Existing Zoning District:</b>	M-2
<b>Existing Form District:</b>	Traditional Workplace
<b>Jurisdiction:</b>	Louisville Metro
<b>Council District:</b>	4-David Tandy
<b>Case Manager:</b>	Julia Williams, Planner II

### REQUEST

- Change in form district from Traditional Workplace to Traditional Neighborhood
- Change in zoning from M-2 to CR
- Variance to exceed the minimum height requirement for signage
- Waiver from Chapter 10 to permit an existing building to encroach into a landscape buffer area along the north property line
- Permit exceptional signage on the existing buildings smokestack/tower
- District Development plan

### CASE SUMMARY/BACKGROUND/SITE CONTEXT

A combination of contractors' shops, retail or wholesale stores and offices have been in his location since 1971. The property was known originally as the Louisville Cotton Mills, but is now known as the Goss Avenue Antique Mall. The 7.7 acre site contains several buildings. Some structures are proposed to be demolished but most are to remain to be re-purposed as a mixed use development that includes commercial and residential. The property is bounded by Goss Avenue on the north, Ash Street to the south, McHenry Street to the east and a railroad line to the west.

### LAND USE/ZONING DISTRICT/FORM DISTRICT TABLE

	Land Use	Zoning	Form District
<b>Subject Property</b>			
<b>Existing</b>	Commercial	M-2	Traditional Workplace
<b>Proposed</b>	Commercial/Residential	C-R	Traditional Neighborhood
<b>Surrounding Properties</b>			
<b>North</b>	Residential/Industrial	R-6/M-2	Traditional Neighborhood/ Traditional Workplace
<b>South</b>	Residential	R-6	Traditional Neighborhood
<b>East</b>	Residential	R-6	Traditional Neighborhood
<b>West</b>	Commercial	C-1	Traditional Workplace

## PREVIOUS CASES ON SITE

14670- Appeal of a Refusal Letter. Non-conforming rights were being claimed for the daycare and the request was to change from one non-conforming use, (commercial/industrial use) to another non-conforming use, (day care facility).

## INTERESTED PARTY COMMENTS

None received.

## APPLICABLE PLANS AND POLICIES

- Cornerstone 2020
- Land Development Code

Criteria for granting the proposed form district change/rezoning: KRS Chapter 100.213

1. The proposed form district/rezoning change complies with the applicable guidelines and policies Cornerstone 2020; OR
2. The existing form district/zoning classification is inappropriate and the proposed classification is appropriate; OR
3. There have been major changes of an economic, physical, or social nature within the area involved which were not anticipated in Cornerstone 2020 which have substantially altered the basic character of the area.

## STAFF ANALYSIS FOR REZONING AND FORM DISTRICT CHANGES

Following is staff's analysis of the proposed rezoning against the Guidelines and Policies of Cornerstone 2020.

Following is staff's analysis of the proposed rezoning against the Guidelines and Policies of Cornerstone 2020.

The site is located in the Traditional Workplace Form District

A Traditional Workplace is a form characterized by predominantly small to medium scale industrial and employment uses. The streets are typically narrow, in a grid pattern and often have alleys. Buildings have little or no setback from the street. Traditional workplaces are often closely integrated with residential areas and allow a mixture of industrial, commercial and office uses. New housing opportunities should be allowed as well as civic and community uses.

Traditional workplaces should be served by public transportation. Because of the close proximity to residential areas, parking should be encouraged to be located mostly off street and behind buildings. There should be adequate buffering of nearby neighbors from noise, odors, lighting and similar conditions. In order to encourage reinvestment, rehabilitation and redevelopment in these areas, flexible and creative site design should be encouraged along with a respect for the traditional pattern of development in the surrounding area.

The site is proposed to be located in the Traditional Neighborhood Form District

The Traditional Neighborhood Form District is characterized by predominantly residential uses, by a grid pattern of streets with sidewalks and often including alleys. Residential lots are predominantly narrow and often deep, but the neighborhood may contain sections of larger estate lots, and also sections of lots on which appropriately integrated higher density residential uses may be located. The higher density uses are encouraged to be located in centers or near parks and open spaces having

sufficient carrying capacity. There is usually a significant range of housing opportunities, including multi-family dwellings.

Traditional neighborhoods often have and are encouraged to have a significant proportion of public open space such as parks or greenways, and may contain civic uses as well as appropriately located and integrated neighborhood centers with a mixture of mostly neighborhood-serving land uses such as offices, shops, restaurants and services. Although many existing traditional neighborhoods are fifty to one hundred twenty years old, it is hoped that the Traditional Neighborhood Form will be revitalized under the new Comprehensive Plan. Revitalization and reinforcement of the Traditional Neighborhood Form will require particular emphasis on (a) preservation and renovation of existing buildings in stable neighborhoods (if the building design is consistent with the predominant building design in those neighborhoods), (b) the preservation of the existing grid pattern of streets and alleys, (c) preservation of public open spaces.

**TECHNICAL REVIEW**

All technical review comments have been addressed.

**STAFF CONCLUSIONS**

A public hearing date is ready to be set for the proposal.

**NOTIFICATION**

Date	Purpose of Notice	Recipients
11/27/13	Hearing before LD&T on 12/12/13	1 <sup>st</sup> and 2 <sup>nd</sup> tier adjoining property owners Speakers at Planning Commission public hearing Subscribers of Council District 4 Notification of Development Proposals
	Hearing before PC	1 <sup>st</sup> and 2 <sup>nd</sup> tier adjoining property owners Speakers at Planning Commission public hearing Subscribers of Council District 4 Notification of Development Proposals
	Hearing before PC	Sign Posting on property
	Hearing before PC	Legal Advertisement in the Courier-Journal

**ATTACHMENTS**

1. Zoning Map
2. Aerial Photograph
3. Proposed Binding Elements

Attachment 1: Zoning Map



13ZONE1020



0 200  
\* Distance are in feet

**LOIC**  
Landscape Oriented Image Computer  
Copyright © 2013 LOIC and its affiliates.  
LOIC is a registered service mark of LOIC, INC.  
LOIC is a registered service mark of LOIC, INC.  
LOIC is a registered service mark of LOIC, INC.

Plot Date 10/16/2013

Attachment 2: Aerial Photograph



### Attachment 3: Proposed Binding Elements

1. The development shall be in accordance with the approved district development plan, all applicable sections of the Land Development Code (LDC) and agreed upon binding elements unless amended pursuant to the Land Development Code. Any changes/additions/alterations of any binding element(s) shall be submitted to the Planning Commission or the Planning Commission's designee for review and approval; any changes/additions/alterations not so referred shall not be valid.
2. The development shall not exceed 246,643 square feet of gross floor area.
3. No outdoor advertising signs, small freestanding signs, pennants, balloons, or banners shall be permitted on the site.
4. Construction fencing shall be erected when off-site trees or tree canopy exists within 3' of a common property line. Fencing shall be in place prior to any grading or construction to protect the existing root systems from compaction. The fencing shall enclose the entire area beneath the tree canopy and shall remain in place until all construction is completed. No parking, material storage or construction activities are permitted within the protected area.
5. Before any permit (including but not limited to building, parking lot, change of use, site disturbance, alteration permit or demolition permit) is requested:
  - a. The development plan must receive full construction approval from Louisville Metro Department of Inspections, Permits and Licenses, Louisville Metro Public Works and the Metropolitan Sewer District.
  - b. Encroachment permits must be obtained from the Kentucky Department of Transportation, Bureau of Highways.
  - c. The property owner/developer must obtain approval of a detailed plan for screening (buffering/landscaping) as described in Chapter 10 prior to receiving a building permit. Such plan shall be implemented prior to occupancy of the site and shall be maintained thereafter.
6. A certificate of occupancy must be received from the appropriate code enforcement department prior to occupancy of the structure or land for the proposed use. All binding elements requiring action and approval must be implemented prior to requesting issuance of the certificate of occupancy, unless specifically waived by the Planning Commission.
7. There shall be no outdoor music (live, piped, radio or amplified) or outdoor entertainment or outdoor PA system audible beyond the property line.
8. The applicant, developer, or property owner shall provide copies of these binding elements to tenants, purchasers, contractors, subcontractors and other parties engaged in development of this site and shall advise them of the content of these binding elements. These binding elements shall run with the land and the owner of the property and occupant of the property shall at all times be responsible for compliance with these binding elements. At all times during development of the site, the applicant and developer, their heirs, successors; and assignees, contractors, subcontractors, and other parties engaged in development of the site, shall be responsible for compliance with these binding elements.

# Pre-Application Staff Report

October 17, 2013



<b>Case No:</b>	13zone1020
<b>Project Name:</b>	<b>Germantown Mill Lofts</b>
<b>Location:</b>	<b>946 Goss Avenue</b>
<b>Owner(s):</b>	<b>Fincastle Investment Co.</b>
<b>Applicant:</b>	<b>Underhill Associates/ JTJ LLC.</b>
<b>Representative(s):</b>	<b>Underhill Associates/ JTJ LLC/Pimsler Hoss Architects</b>
<b>Project Area/Size:</b>	<b>7.68 acres</b>
<b>Existing Zoning District:</b>	<b>M-2</b>
<b>Existing Form District:</b>	<b>Traditional Workplace</b>
<b>Jurisdiction:</b>	Louisville Metro
<b>Council District:</b>	<b>4-David Tandy</b>
<b>Case Manager:</b>	Julia Williams, Planner II

## REQUEST

- Change in form district from Traditional Workplace to Traditional Neighborhood
- Change in zoning from M-2 to C-R
- District Development plan

## CASE SUMMARY/BACKGROUND/SITE CONTEXT

A combination of contractors' shops, retail or wholesale stores and offices have been in his location since 1971. The property was known originally as the Louisville Cotton Mills, but is now known as the Goss Avenue Antique Mall. The 7.68 acre site contains several buildings. Some structures are proposed to be demolished but most are to remain to be re-purposed as a mixed use development that includes commercial and residential. The property is bounded by Goss Avenue on the north, Ash Street to the south, McHenry Street to the east and a railroad line to the west.

## LAND USE/ZONING DISTRICT/FORM DISTRICT TABLE

	Land Use	Zoning	Form District
<b>Subject Property</b>			
<b>Existing</b>	Commercial	M-2	Traditional Workplace
<b>Proposed</b>	Commercial/Residential	C-R	Traditional Neighborhood
<b>Surrounding Properties</b>			
<b>North</b>	Residential/Industrial	R-6/M-2	Traditional Neighborhood/ Traditional Workplace
<b>South</b>	Residential	R-6	Traditional Neighborhood
<b>East</b>	Residential	R-6	Traditional Neighborhood
<b>West</b>	Commercial	C-1	Traditional Workplace



## PREVIOUS CASES ON SITE

14670- Appeal of a Refusal Letter. Non-conforming rights were being claimed for the daycare and the request was to change from one non-conforming use, (commercial/industrial use) to another non-conforming use, (day care facility).

## INTERESTED PARTY COMMENTS

None received.

## APPLICABLE PLANS AND POLICIES

- Cornerstone 2020
- Land Development Code

## STANDARD OF REVIEW FOR REZONING AND FORM DISTRICT CHANGES

Criteria for granting the proposed form district change/rezoning:

1. The proposed form district/rezoning change complies with the applicable guidelines and policies Cornerstone 2020; OR
2. The existing form district/zoning classification is inappropriate and the proposed classification is appropriate; OR
3. There have been major changes of an economic, physical, or social nature within the area involved which were not anticipated in Cornerstone 2020 which have substantially altered the basic character of the area.

## STAFF ANALYSIS FOR REZONING AND FORM DISTRICT CHANGES

Following is staff's analysis of the proposed rezoning against the Guidelines and Policies of Cornerstone 2020.

### The site is located in the Traditional Workplace Form District

A Traditional Workplace is a form characterized by predominantly small to medium scale industrial and employment uses. The streets are typically narrow, in a grid pattern and often have alleys. Buildings have little or no setback from the street. Traditional workplaces are often closely integrated with residential areas and allow a mixture of industrial, commercial and office uses. New housing opportunities should be allowed as well as civic and community uses.

Traditional workplaces should be served by public transportation. Because of the close proximity to residential areas, parking should be encouraged to be located mostly off street and behind buildings. There should be adequate buffering of nearby neighbors from noise, odors, lighting and similar conditions. In order to encourage reinvestment, rehabilitation and redevelopment in these areas, flexible and creative site design should be encouraged along with a respect for the traditional pattern of development in the surrounding area.

### The site is proposed to be located in the Traditional Neighborhood Form District

The Traditional Neighborhood Form District is characterized by predominantly residential uses, by a grid pattern of streets with sidewalks and often including alleys. Residential lots are predominantly narrow and often deep, but the neighborhood may contain sections of larger estate lots, and also sections of lots on which appropriately integrated higher density residential uses may be located. The higher density uses are encouraged to be located in centers or near

parks and open spaces having sufficient carrying capacity. There is usually a significant range of housing opportunities, including multi-family dwellings.

Traditional neighborhoods often have and are encouraged to have a significant proportion of public open space such as parks or greenways, and may contain civic uses as well as appropriately located and integrated neighborhood centers with a mixture of mostly neighborhood-serving land uses such as offices, shops, restaurants and services. Although many existing traditional neighborhoods are fifty to one hundred twenty years old, it is hoped that the Traditional Neighborhood Form will be revitalized under the new Comprehensive Plan. Revitalization and reinforcement of the Traditional Neighborhood Form will require particular emphasis on (a) preservation and renovation of existing buildings in stable neighborhoods (if the building design is consistent with the predominant building design in those neighborhoods), (b) the preservation of the existing grid pattern of streets and alleys, (c) preservation of public open spaces.

The proposal generally meets the guidelines of the Comprehensive Plan. More information is needed on parking and buffering before determining compliance.

All other agency comments should be addressed to demonstrate compliance with the remaining Guidelines and Policies of Cornerstone 2020.

A checklist is attached to the end of this staff report with a more detailed analysis. The Louisville Metro Planning Commission is charged with making a recommendation to the Louisville Metro Council regarding the appropriateness of this zoning map amendment. The Louisville Metro Council has zoning authority over the property in question.

### TECHNICAL REVIEW

Please refer to the agency review comments.

### STAFF CONCLUSIONS

A neighborhood meeting is ready to be set for the proposal.

### NOTIFICATION

Date	Purpose of Notice	Recipients
		1 <sup>st</sup> and 2 <sup>nd</sup> tier adjacent property owners and neighborhood notification recipients in council district 4.

### ATTACHMENTS

1. Zoning Map
2. Aerial Photograph
3. Cornerstone 2020 Staff Checklist

Attachment 1: Zoning Map

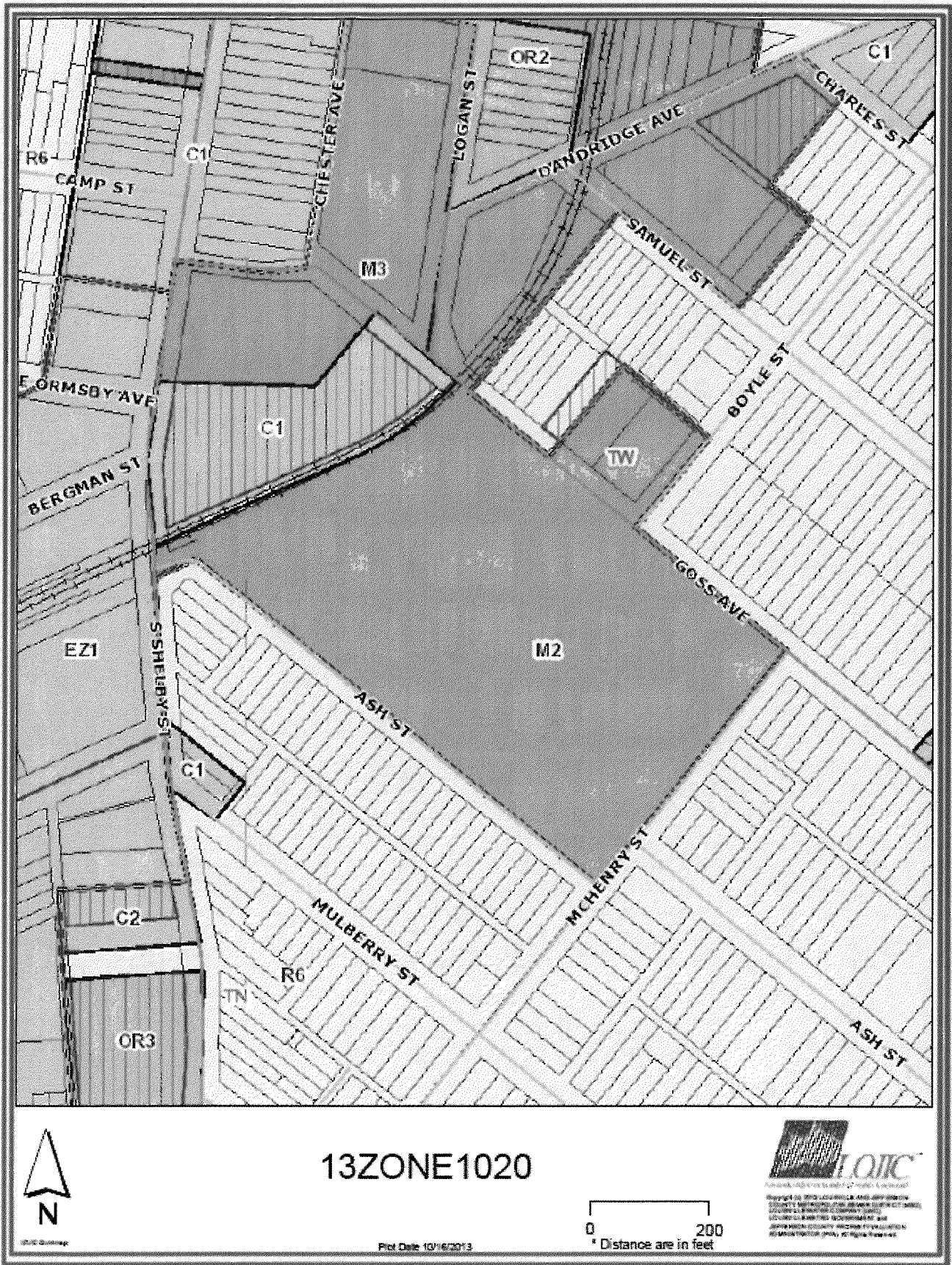

Attachment 2: Aerial Photograph



### Attachment 3: Cornerstone 2020 Staff Checklist

- + Exceeds Guideline
- √ Meets Guideline
- +/- More Information Needed
- NA Not Applicable

#	Cornerstone 2020 Guidelines & Policies	Cornerstone 2020 Plan Element	Plan Element or Portion of Plan Element	Pre-App Finding	Pre-App Comments
1	Form Districts Goals C1-C4, Objectives C1.1-1.2, C2.1-2.7, C3.1-3.7, C4.1.-4.7	Community Form/Land Use Guideline 1: Community Form	B.2: The proposal preserves the existing grid pattern of streets, sidewalks and alleys.	√	The proposal does not affect the existing street pattern. Sidewalks are provided within all rights of way.
2	Form Districts Goals C1-C4, Objectives C1.1-1.2, C2.1-2.7, C3.1-3.7, C4.1.-4.7	Community Form/Land Use Guideline 1: Community Form	B.2: The proposal introduces an appropriately-located neighborhood center including a mix of neighborhood-serving uses such as offices, shops and restaurants.	√	The proposal is for a zoning district that permits neighborhood serving uses.
3	Form Districts Goals C1-C4, Objectives C1.1-1.2, C2.1-2.7, C3.1-3.7, C4.1.-4.7	Community Form/Land Use Guideline 1: Community Form	B.2: The proposal preserves public open spaces, and if the proposal is a higher density use, is located in close proximity to such open space, a center or other public areas.	√	The proposal preserves public open spaces and the public realm of the right of way. New open spaces are created with the proposal.
4	Form Districts Goals C1-C4, Objectives C1.1-1.2, C2.1-2.7, C3.1-3.7, C4.1.-4.7	Community Form/Land Use Guideline 1: Community Form	B.2: The proposal preserves and renovates existing buildings if the building design of these structures is consistent with the predominate neighborhood building design.	√	The proposal is for the preservation and renovation of existing buildings for commercial or residential purposes. The existing structure is historic and represents the industrial past of the neighborhood.
5	Form Districts Goals C1-C4, Objectives C1.1-1.2, C2.1-2.7, C3.1-3.7, C4.1.-4.7	Community Form/Land Use Guideline 2: Centers	A.1/7: The proposal, which will create a new center, is located in the Traditional Neighborhood Form District, and includes new construction or the reuse of existing buildings to provide commercial, office and/or residential use.	√	The proposal will not create a new center but is considered a repurposing of an existing center. The proposal is located in the TWFD with a proposed change to TNFD to keep with the surrounding form district and to be more in keeping with the proposed residential and commercial uses.
6	Form Districts Goals C1-C4, Objectives C1.1-1.2, C2.1-2.7, C3.1-3.7, C4.1.-4.7	Community Form/Land Use Guideline 2: Centers	A.3: The proposed retail commercial development is located in an area that has a sufficient population to support it.	√	The proposal is located in a higher density single family residential neighborhood.
7	Form Districts Goals C1-C4, Objectives C1.1-1.2, C2.1-2.7, C3.1-3.7, C4.1.-4.7	Community Form/Land Use Guideline 2: Centers	A.4: The proposed development is compact and results in an efficient land use pattern and cost-effective infrastructure investment.	√	The proposal is compact and results in an effective land use pattern with its down zone from M_2 to C-R and change in form from TW to TN. The areas infrastructure is already set up to serve an industrial which indicates it will be able to serve residential as well, which is cost effective.
8	Form Districts Goals C1-C4, Objectives C1.1-1.2, C2.1-2.7, C3.1-3.7, C4.1.-4.7	Community Form/Land Use Guideline 2: Centers	A.5: The proposed center includes a mix of compatible land uses that will reduce trips, support the use of alternative forms of transportation and encourage vitality and sense of place.	√	The proposal is for mixed use which will reduce trips and will support alternate transportation with sidewalks around the site. Transit is located nearby along Shelby Street which will serve the site as well.
9	Form Districts Goals C1-C4, Objectives C1.1-1.2, C2.1-2.7, C3.1-3.7, C4.1.-4.7	Community Form/Land Use Guideline 2: Centers	A.6: The proposal incorporates residential and office uses above retail and/or includes other mixed-use, multi-story retail buildings.	√	The proposal is for mixed use, residential and commercial.

#	Cornerstone 2020 Guidelines & Policies	Cornerstone 2020 Plan Element	Plan Element or Portion of Plan Element	Pre-App Finding	Pre-App Comments
10	Form Districts Goals C1-C4, Objectives C1.1-1.2, C2.1-2.7, C3.1-3.7, C4.1.-4.7	Community Form/Land Use Guideline 2: Centers	A.12: If the proposal is a large development in a center, it is designed to be compact and multi-purpose, and is oriented around a central feature such as a public square or plaza or landscape element.	√	The proposal is an existing large development that is mixed use. The proposal is utilizing existing historic structures on the site as its central features.
11	Form Districts Goals C1-C4, Objectives C1.1-1.2, C2.1-2.7, C3.1-3.7, C4.1.-4.7	Community Form/Land Use Guideline 2: Centers	A.13/15: The proposal shares entrance and parking facilities with adjacent uses to reduce curb cuts and surface parking, and locates parking to balance safety, traffic, transit, pedestrian, environmental and aesthetic concerns.	√	The proposal is located on a city block with no opportunities for shared entrances. The proposal has 2 entrances/exits to the site and the site is for mixed use.
12	Form Districts Goals C1-C4, Objectives C1.1-1.2, C2.1-2.7, C3.1-3.7, C4.1.-4.7	Community Form/Land Use Guideline 2: Centers	A.14: The proposal is designed to share utility hookups and service entrances with adjacent developments, and utility lines are placed underground in common easements.	√	Utilities for the site are existing and will be shared with the other uses on the site.
13	Form Districts Goals C1-C4, Objectives C1.1-1.2, C2.1-2.7, C3.1-3.7, C4.1.-4.7	Community Form/Land Use Guideline 2: Centers	A.16: The proposal is designed to support easy access by bicycle, car and transit and by pedestrians and persons with disabilities.	√	The proposal has two entrances/exits, sidewalks, and transit located nearby along Shelby Street. Bicycles will use the same facilities as other vehicles. Access to the facilities exists throughout the site.
14	Form Districts Goals C1-C4, Objectives C1.1-1.2, C2.1-2.7, C3.1-3.7, C4.1.-4.7	Community Form/Land Use Guideline 3: Compatibility	A.2: The proposed building materials increase the new development's compatibility.	NA	No new construction is proposed.
15	Form Districts Goals C1-C4, Objectives C1.1-1.2, C2.1-2.7, C3.1-3.7, C4.1.-4.7	Community Form/Land Use Guideline 3: Compatibility	A.4/5/6/7: The proposal does not constitute a non-residential expansion into an existing residential area, or demonstrates that despite such an expansion, impacts on existing residences (including traffic, parking, signs, lighting, noise, odor and stormwater) are appropriately mitigated.	√	The proposal is not a non-residential expansion into a residential area because the site is already zoned non-residentially. The proposal for mixed use brings the site more into compliance with the surrounding residential as it proposes both residential and commercial.
16	Form Districts Goals C1-C4, Objectives C1.1-1.2, C2.1-2.7, C3.1-3.7, C4.1.-4.7	Community Form/Land Use Guideline 3: Compatibility	A.5: The proposal mitigates any potential odor or emissions associated with the development.	√	APCD has no issues with the proposal.
17	Form Districts Goals C1-C4, Objectives C1.1-1.2, C2.1-2.7, C3.1-3.7, C4.1.-4.7	Community Form/Land Use Guideline 3: Compatibility	A.6: The proposal mitigates any adverse impacts of its associated traffic on nearby existing communities.	+/-	Transportation Planning is reviewing the proposal.
18	Form Districts Goals C1-C4, Objectives C1.1-1.2, C2.1-2.7, C3.1-3.7, C4.1.-4.7	Community Form/Land Use Guideline 3: Compatibility	A.8: The proposal mitigates adverse impacts of its lighting on nearby properties, and on the night sky.	√	Lighting will meet LDC requirements.
19	Form Districts Goals C1-C4, Objectives C1.1-1.2, C2.1-2.7, C3.1-3.7, C4.1.-4.7	Community Form/Land Use Guideline 3: Compatibility	A.11: If the proposal is a higher density or intensity use, it is located along a transit corridor AND in or near an activity center.	√	The proposal is an existing activity center and is located near a transit route along Shelby Street.

#	Cornerstone 2020 Guidelines & Policies	Cornerstone 2020 Plan Element	Plan Element or Portion of Plan Element	Pre-App Finding	Pre-App Comments
20	Form Districts Goals C1-C4, Objectives C1.1-1.2, C2.1-2.7, C3.1-3.7, C4.1-4.7	Community Form/Land Use Guideline 3: Compatibility	A.21: The proposal provides appropriate transitions between uses that are substantially different in scale and intensity or density of development such as landscaped buffer yards, vegetative berms, compatible building design and materials, height restrictions, or setback requirements.	+/-	More information is necessary to determine compliance.
21	Form Districts Goals C1-C4, Objectives C1.1-1.2, C2.1-2.7, C3.1-3.7, C4.1-4.7	Community Form/Land Use Guideline 3: Compatibility	A.22: The proposal mitigates the impacts caused when incompatible developments unavoidably occur adjacent to one another by using buffers that are of varying designs such as landscaping, vegetative berms and/or walls, and that address those aspects of the development that have the potential to adversely impact existing area developments.	+/-	More information is necessary to determine compliance.
22	Form Districts Goals C1-C4, Objectives C1.1-1.2, C2.1-2.7, C3.1-3.7, C4.1-4.7	Community Form/Land Use Guideline 3: Compatibility	A.23: Setbacks, lot dimensions and building heights are compatible with those of nearby developments that meet form district standards.	√	The buildings are existing with no new construction proposed.
23	Form Districts Goals C1-C4, Objectives C1.1-1.2, C2.1-2.7, C3.1-3.7, C4.1-4.7	Community Form/Land Use Guideline 3: Compatibility	A.24: Parking, loading and delivery areas located adjacent to residential areas are designed to minimize adverse impacts of lighting; noise and other potential impacts, and that these areas are located to avoid negatively impacting motorists, residents and pedestrians.	+/-	More information is necessary to determine compliance.
24	Form Districts Goals C1-C4, Objectives C1.1-1.2, C2.1-2.7, C3.1-3.7, C4.1-4.7	Community Form/Land Use Guideline 3: Compatibility	A.24: The proposal includes screening and buffering of parking and circulation areas adjacent to the street, and uses design features or landscaping to fill gaps created by surface parking lots. Parking areas and garage doors are oriented to the side or back of buildings rather than to the street.	+/-	More information is necessary to determine compliance.
25	Form Districts Goals C1-C4, Objectives C1.1-1.2, C2.1-2.7, C3.1-3.7, C4.1-4.7	Community Form/Land Use Guideline 3: Compatibility	A.25: Parking garages are integrated into their surroundings and provide an active, inviting street-level appearance.	NA	A parking garage is not proposed.
26	Form Districts Goals C1-C4, Objectives C1.1-1.2, C2.1-2.7, C3.1-3.7, C4.1-4.7	Community Form/Land Use Guideline 3: Compatibility	A.28: Signs are compatible with the form district pattern and contribute to the visual quality of their surroundings.	+/-	More information is necessary to determine compliance.
27	Livability Goals H3 and H5, all related objectives	Community Form/Land Use Guideline 4: Open Space	A.2/3/7: The proposal provides open space that helps meet the needs of the community as a component of the development and provides for the continued maintenance of that open space.	+/-	More information is necessary to determine compliance.

#	Cornerstone 2020 Guidelines & Policies	Cornerstone 2020 Plan Element	Plan Element or Portion of Plan Element	Pre-App Finding	Pre-App Comments
28	Livability Goals H3 and H5, all related objectives	Community Form/Land Use Guideline 4: Open Space	A.4: Open space design is consistent with the pattern of development in the Neighborhood Form District.	+/-	More information is necessary to determine compliance.
29	Livability Goals H3 and H5, all related objectives	Community Form/Land Use Guideline 4: Open Space	A.5: The proposal integrates natural features into the pattern of development.	√	Some existing trees are being preserved but the site is otherwise deficient on natural features.
30	Livability Goals H3 and H5, all related objectives	Community Form/Land Use Guideline 5: Natural Areas and Scenic and Historic Resources	A.1: The proposal respects the natural features of the site through sensitive site design, avoids substantial changes to the topography and minimizes property damage and environmental degradation resulting from disturbance of natural systems.	√	Some existing trees are being preserved but the site is otherwise deficient on natural features.
31	Livability Goals H3 and H5, all related objectives	Community Form/Land Use Guideline 5: Natural Areas and Scenic and Historic Resources	A.2/4: The proposal includes the preservation, use or adaptive reuse of buildings, sites, districts and landscapes that are recognized as having historical or architectural value, and, if located within the impact area of these resources, is compatible in height, bulk, scale, architecture and placement.	√	The proposal is for the adaptive reuse of existing historic structures.
31	Livability Goals H3 and H5, all related objectives	Community Form/Land Use Guideline 5: Natural Areas and Scenic and Historic Resources	A.6: Encourage development to avoid wet or highly permeable soils, severe, steep or unstable slopes with the potential for severe erosion.	√	Soils are not an issue for the site.
32	Land Use and Transportation Connection Goal E1, Objectives E1.1 and E1.3	Marketplace Guideline 6: Economic Growth and Sustainability	A.2: Ensure adequate access between employment centers and population centers.	√	The proposal is both a population center and employment center because the proposal is for mixed use.
33	People, Jobs and Housing Goal K4, Objective K4.1	Marketplace Guideline 6: Economic Growth and Sustainability	A.3: Encourage redevelopment, reinvestment and rehabilitation in the downtown where it is consistent with the form district pattern.	NA	The proposal is not located in a downtown.
34	Marketplace Strategy Goal A1, Objectives A1.3, A1.4, A1.5	Marketplace Guideline 6: Economic Growth and Sustainability	A.4: Encourage industries to locate in industrial subdivisions or adjacent to existing industry to take advantage of special infrastructure needs.	NA	The proposal is not for industrial.
35	Land Use and Transportation Connection Goal E1, Objectives E1.1 and E1.3	Marketplace Guideline 6: Economic Growth and Sustainability	A.6: Locate retail commercial development in activity centers. Locate uses generating large amounts of traffic on a major arterial, at the intersection of two minor arterials or at locations with good access to a major arterial and where the proposed use will not adversely affect adjacent areas.	√	The proposal is for mixed use located in an existing activity center located along a minor arterial. C-R zoning will have less impact on the adjacent residential than the current M-2 which permits non-neighborhood serving uses.



#	Cornerstone 2020 Guidelines & Policies	Cornerstone 2020 Plan Element	Plan Element or Portion of Plan Element	Pre-App Finding	Pre-App Comments
36	Land Use and Transportation Connection Goal E1, Objectives E1.1 and E1.3	Marketplace Guideline 6: Economic Growth and Sustainability	A.8: Require industrial development with more than 100 employees to locate on or near an arterial street, preferably in close proximity to an expressway interchange. Require industrial development with less than 100 employees to locate on or near an arterial street.	NA	The proposal is not for industrial.
37	Mobility Goals A1-A6, B1, C1, D1, E1, E2, F1, G1, H1-H4, I1-I7, all related Objectives	Mobility/Transportation Guideline 7: Circulation	A.1/2: The proposal will contribute its proportional share of the cost of roadway improvements and other services and public facilities made necessary by the development through physical improvements to these facilities, contribution of money, or other means.	+/-	More information is necessary to determine compliance.
38	Mobility Goals A1-A6, B1, C1, D1, E1, E2, F1, G1, H1-H4, I1-I7, all related Objectives	Mobility/Transportation Guideline 7: Circulation	A.3/4: The proposal promotes mass transit, bicycle and pedestrian use and provides amenities to support these modes of transportation.	√	The proposal promotes all forms of transportation by providing sidewalks and parking around the uses.
39	Mobility Goals A1-A6, B1, C1, D1, E1, E2, F1, G1, H1-H4, I1-I7, all related Objectives	Mobility/Transportation Guideline 7: Circulation	A.6: The proposal's transportation facilities are compatible with and support access to surrounding land uses, and contribute to the appropriate development of adjacent lands. The proposal includes at least one continuous roadway through the development, adequate street stubs, and relies on cul-de-sacs only as short side streets or where natural features limit development of "through" roads.	√	The proposal does not have the ability to provide access to adjacent land uses because the lot takes up a city block and is constrained by a railroad as well.
40	Mobility Goals A1-A6, B1, C1, D1, E1, E2, F1, G1, H1-H4, I1-I7, all related Objectives	Mobility/Transportation Guideline 7: Circulation	A.9: The proposal includes the dedication of rights-of-way for street, transit corridors, bikeway and walkway facilities within or abutting the development.	+/-	More information is necessary to determine compliance.
41	Mobility Goals A1-A6, B1, C1, D1, E1, E2, F1, G1, H1-H4, I1-I7, all related Objectives	Mobility/Transportation Guideline 7: Circulation	A.10: The proposal includes adequate parking spaces to support the use.	+/-	More information is necessary to determine compliance.
42	Mobility Goals A1-A6, B1, C1, D1, E1, E2, F1, G1, H1-H4, I1-I7, all related Objectives	Mobility/Transportation Guideline 7: Circulation	A.13/16: The proposal provides for joint and cross access through the development and to connect to adjacent development sites.	√	Joint and cross access is not necessary because the site is constrained by roadways and a railroad.
43	Mobility Goals A1-A6, B1, C1, D1, E1, E2, F1, G1, H1-H4, I1-I7, all related Objectives	Mobility/Transportation Guideline 8: Transportation Facility Design	A.8: Adequate stub streets are provided for future roadway connections that support and contribute to appropriate development of adjacent land.	√	A stub street is not necessary because the site is constrained by roadways and a railroad.
44	Mobility Goals A1-A6, B1, C1, D1, E1, E2, F1, G1, H1-H4, I1-I7, all related Objectives	Mobility/Transportation Guideline 8: Transportation Facility Design	A.9: Avoid access to development through areas of significantly lower intensity or density if such access would create a significant nuisance.	√	Access to the development is through public rights of way.

#	Cornerstone 2020 Guidelines & Policies	Cornerstone 2020 Plan Element	Plan Element or Portion of Plan Element	Pre-App Finding	Pre-App Comments
45	Mobility Goals A1-A6, B1, C1, D1, E1, E2, F1, G1, H1-H4, I1-I7, all related Objectives	Mobility/Transportation Guideline 8: Transportation Facility Design	A.11: The development provides for an appropriate functional hierarchy of streets and appropriate linkages between activity areas in and adjacent to the development site.	√	The existing roadways provide the appropriate linkages to other development.
43	Mobility Goals A1-A6, B1, C1, D1, E1, E2, F1, G1, H1-H4, I1-I7, all related Objectives	Mobility/Transportation Guideline 9: Bicycle, Pedestrian and Transit	A.1/2: The proposal provides, where appropriate, for the movement of pedestrians, bicyclists and transit users around and through the development, provides bicycle and pedestrian connections to adjacent developments and to transit stops, and is appropriately located for its density and intensity.	√	Sidewalks are provided for transit users and pedestrians. Sidewalks are located throughout the site.
44	Livability, Goals B1, B2, B3, B4, Objectives B1.1-1.8, B2.1-2.7, B3.1-3.4, B4.1-4.3	Livability/Environment Guideline 10: Flooding and Stormwater	The proposal's drainage plans have been approved by MSD, and the proposal mitigates negative impacts to the floodplain and minimizes impervious area. Solid blue-line streams are protected through a vegetative buffer, and drainage designs are capable of accommodating upstream runoff assuming a fully-developed watershed. If streambank restoration or preservation is necessary, the proposal uses best management practices.	+/-	More information is necessary to determine compliance.
45	Livability Goals C1, C2, C3, C4, all related Objectives	Livability/Environment Guideline 12: Air Quality	The proposal has been reviewed by APCD and found to not have a negative impact on air quality.	√	APCD has no issues with the proposal.
44	Livability, Goals F1 and F2, all related objectives	Livability/Environment Guideline 13: Landscape Character	A.3: The proposal includes additions and connections to a system of natural corridors that can provide habitat areas and allow for migration.	√	Natural corridors are not evident in or around the proposal.
46	Quality of Life Goal J1, Objectives J1.1-1.2	Community Facilities Guideline 14: Infrastructure	A.2: The proposal is located in an area served by existing utilities or planned for utilities.	√	Existing utilities serve the site.
47	Quality of Life Goal J1, Objectives J1.1-1.2	Community Facilities Guideline 14: Infrastructure	A.3: The proposal has access to an adequate supply of potable water and water for fire-fighting purposes.	√	Water is available to the site.
48	Livability Goal B1, Objective B1.3	Community Facilities Guideline 14: Infrastructure	A.4: The proposal has adequate means of sewage treatment and disposal to protect public health and to protect water quality in lakes and streams.	+/-	More information is necessary to determine compliance.