

WALL LEGEND:

NEW WALL

EXISTING WALL TO REMAIN

GENERAL NOTES:

1. NEW PARTITION WALLS SHALL BE 3 5/8" METAL STUDS WITH 5/8" G.W.B. UNLESS NOTED OTHERWISE.
2. ALL TIMBERFRAME COLUMNS AND BEAMS TO BE LEFT EXPOSED.
3. PATCH AND PAINT G.W.B. WALLS AFTER INSTALLATION OF NEW ELEVATOR #1 DOORS AND FRAMES ON FIRST AND SECOND FLOORS.

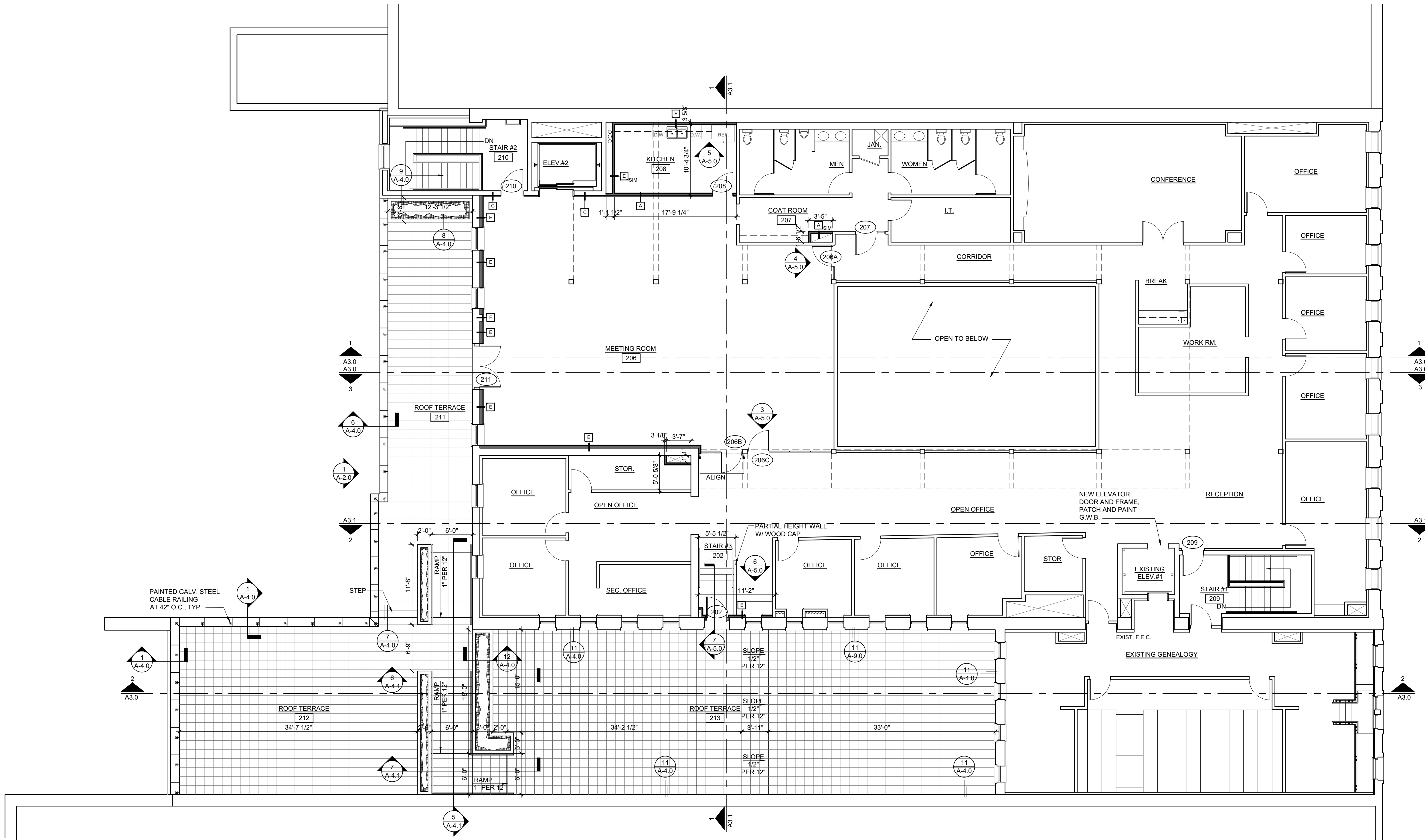

N
SECOND FLOOR PLAN
1/8" = 1'-0"



DATE:	01.15.2022
DATE REVISED:	
PROJECT NUMBER:	0819
DRAWN BY:	

Second Floor Meeting Room & Roof Build-out
Headquarters of the National Society
of the Sons of the American Revolution
805 West Main Street
Louisville, Kentucky