

Land Development and Transportation Staff Report

December 12, 2013



Case No:	13ZONE1003
Project Name:	Lagos Logos
Location:	448 Roberts Avenue
Owner(s):	Tommy and Donna Lago
Applicant:	Tommy and Donna Lago
Representative(s):	Tommy and Donna Lago
Project Area/Size:	0.99 Acres
Existing Zoning District:	R-4
Existing Form District:	Traditional Neighborhood
Jurisdiction:	Louisville Metro
Council District:	13-Vicki Aubrey Welch
Case Manager:	Julia Williams, Planner II

REQUEST

- Change in zoning from R-4 to C-2
- Landscape Waiver from 10.2.4 to permit the encroachment of an existing building into a required LBA along the north property line
- District Development plan

CASE SUMMARY/BACKGROUND/SITE CONTEXT

The proposal is for a screen printing/embroidery company currently operating within a residential zone. The applicant was cited for operating the business in a residential zone. The applicant previously operated the business as a home occupation. The proposal is located in a mixed use area while surrounded by residential zoning. Many of the properties in the area are vacant residentially zoned properties. At the terminus of Roberts Avenue to the east is a railroad and the entrance to Roberts Avenue is a heavy commercial area at Southside Drive and Strawberry Lane. To the north of the site are R-4 zoned single family residences and residentially zoned vacant property. To the south of the site is R-4 zoned property that was once the Kenwood Drive-In theatre. To the east of the site is single family R-4 zoned property. To the west of the site is vacant R-4 zoned property. To the rear of the site is the Kenwood Business Center owned property which is currently undergoing a change in zoning from R-4 to M-2 for a warehouse under case number 13zone1012.

LAND USE/ZONING DISTRICT/FORM DISTRICT TABLE

	Land Use	Zoning	Form District
Subject Property			
Existing	Residential/Screen Printing Shop	R-4	Traditional Neighborhood
Proposed	Residential/Screen Printing Shop	C-2	Traditional Neighborhood
Surrounding Properties			
North	Residential/Vacant	R-4	Traditional Neighborhood
South	Vacant Drive-In Theatre	R-4	Traditional Neighborhood
East	Residential	R-4	Traditional Neighborhood
West	Vacant	R-4	Traditional Neighborhood



PREVIOUS CASES ON SITE

454284-Code enforcement issued a notice of violation to the site on May 7, 2013. The violations include an accessory structure being used for business storage; non-permitted sign on the property, a non-permitted use is existing on the property, and operating a non-permitted business in a residential zone.

INTERESTED PARTY COMMENTS

Staff received a phone call from an interested party inquiring about the zoning change.

APPLICABLE PLANS AND POLICIES

- Cornerstone 2020
- Land Development Code

Criteria for granting the proposed form district change/rezoning: KRS Chapter 100.213

1. The proposed form district/rezoning change complies with the applicable guidelines and policies Cornerstone 2020; OR
2. The existing form district/zoning classification is inappropriate and the proposed classification is appropriate; OR
3. There have been major changes of an economic, physical, or social nature within the area involved which were not anticipated in Cornerstone 2020 which have substantially altered the basic character of the area.

STAFF ANALYSIS FOR REZONING AND FORM DISTRICT CHANGES

Following is staff's analysis of the proposed rezoning against the Guidelines and Policies of Cornerstone 2020.

The site is located in the Traditional Neighborhood Form District

The Traditional Neighborhood Form District is characterized by predominantly residential uses, by a grid pattern of streets with sidewalks and often including alleys. Residential lots are predominantly narrow and often deep, but the neighborhood may contain sections of larger estate lots, and also sections of lots on which appropriately integrated higher density residential uses may be located. The higher density uses are encouraged to be located in centers or near parks and open spaces having sufficient carrying capacity. There is usually a significant range of housing opportunities, including multi-family dwellings.

Traditional neighborhoods often have and are encouraged to have a significant proportion of public open space such as parks or greenways, and may contain civic uses as well as appropriately located and integrated neighborhood centers with a mixture of mostly neighborhood-serving land uses such as offices, shops, restaurants and services. Although many existing traditional neighborhoods are fifty to one hundred twenty years old, it is hoped that the Traditional Neighborhood Form will be revitalized under the new Comprehensive Plan. Revitalization and reinforcement of the Traditional Neighborhood Form will require particular emphasis on (a) preservation and renovation of existing buildings in stable neighborhoods (if the building design is consistent with the predominant building design in those neighborhoods), (b) the preservation of the existing grid pattern of streets and alleys, (c) preservation of public open spaces.



TECHNICAL REVIEW

All technical review comments have been addressed.

STAFF CONCLUSIONS

A public hearing date is ready to be set for the proposal.

NOTIFICATION

Date	Purpose of Notice	Recipients
11/26/13	Hearing before LD&T on 12/12/13	1 st and 2 nd tier adjoining property owners Speakers at Planning Commission public hearing Subscribers of Council District 13 Notification of Development Proposals
	Hearing before PC	1 st and 2 nd tier adjoining property owners Speakers at Planning Commission public hearing Subscribers of Council District 13 Notification of Development Proposals
	Hearing before PC	Sign Posting on property
	Hearing before PC	Legal Advertisement in the Courier-Journal

ATTACHMENTS

1. Zoning Map
2. Aerial Photograph
3. Proposed Binding Elements



Attachment 1: Zoning Map

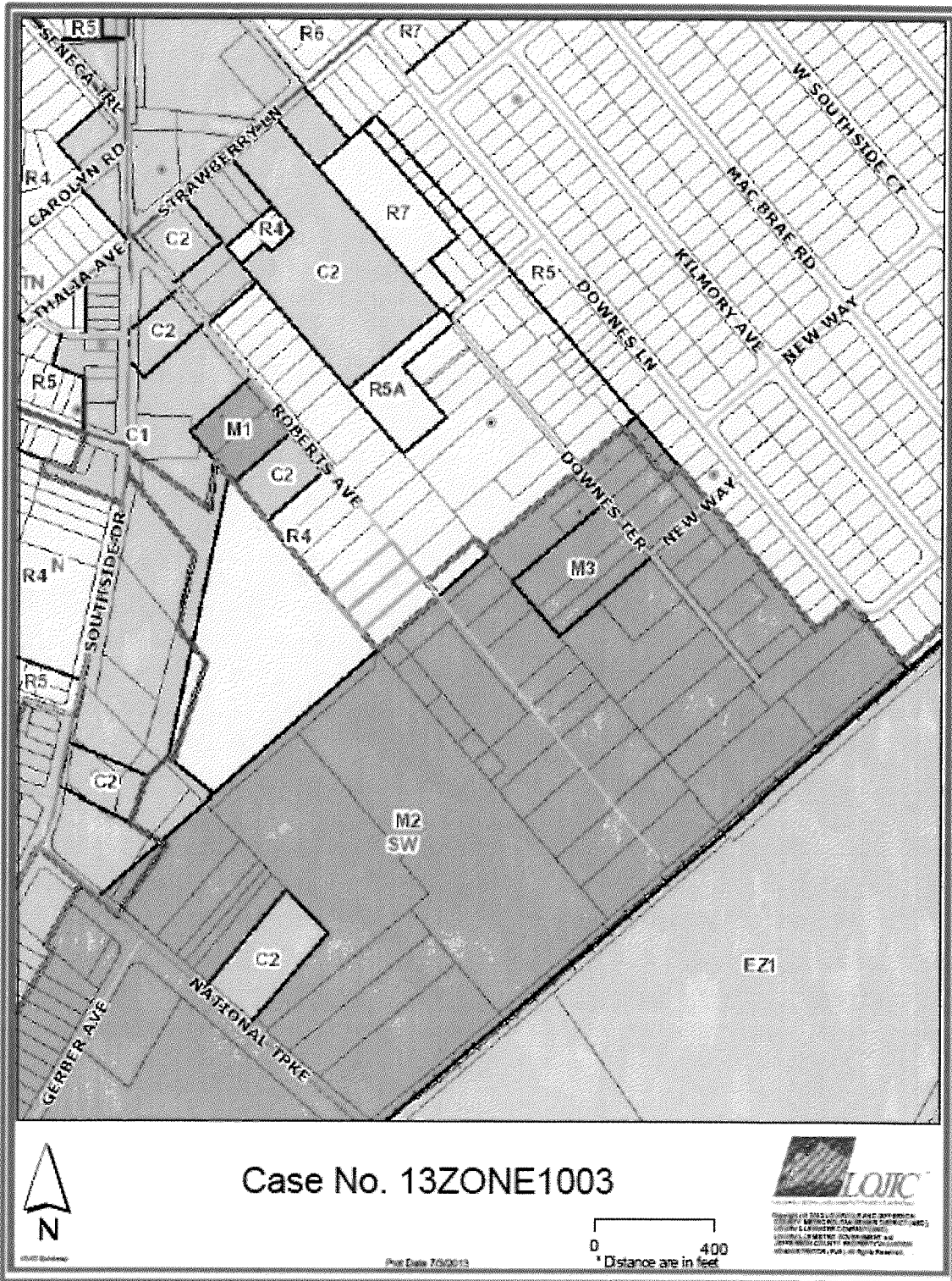



Attachment 2: Aerial Photograph





Attachment 3: Proposed Binding Elements

1. The development shall be in accordance with the approved district development plan, all applicable sections of the Land Development Code (LDC) and agreed upon binding elements unless amended pursuant to the Land Development Code. Any changes/additions/alterations of any binding element(s) shall be submitted to the Planning Commission or the Planning Commission's designee for review and approval; any changes/additions/alterations not so referred shall not be valid.
2. The development shall not exceed 4,781 square feet of gross floor area.
3. No pennants, balloons, or banners shall be permitted on the site.
4. Construction fencing shall be erected when off-site trees or tree canopy exists within 3' of a common property line. Fencing shall be in place prior to any grading or construction to protect the existing root systems from compaction. The fencing shall enclose the entire area beneath the tree canopy and shall remain in place until all construction is completed. No parking, material storage or construction activities are permitted within the protected area.
5. Before any permit (including but not limited to building, parking lot, change of use, site disturbance, alteration permit or demolition permit) is requested:
 - a. The development plan must receive full construction approval from Louisville Metro Department of Inspections, Permits and Licenses, Louisville Metro Public Works and the Metropolitan Sewer District.
 - b. The property owner/developer must obtain approval of a detailed plan for screening (buffering/landscaping) as described in Chapter 10 prior to requesting a building permit. Such plan shall be implemented within 6 months after the development plan approval.
 - c. A legal instrument shall be recorded consolidating the property into one lot. A copy of the recorded instrument shall be submitted to the Division of Planning and Design Services; transmittal of the approved plans to the office responsible for permit issuance will occur only after receipt of said instrument.
6. There shall be no outdoor music (live, piped, radio or amplified) or outdoor entertainment or outdoor PA system audible beyond the property line.
7. The applicant, developer, or property owner shall provide copies of these binding elements to tenants, purchasers, contractors, subcontractors and other parties engaged in development of this site and shall advise them of the content of these binding elements. These binding elements shall run with the land and the owner of the property and occupant of the property shall at all times be responsible for compliance with these binding elements. At all times during development of the site, the applicant and developer, their heirs, successors; and assignees, contractors, subcontractors, and other parties engaged in development of the site, shall be responsible for compliance with these binding elements.
8. No idling of trucks shall take place within 200 feet of single-family residences. No overnight idling of trucks shall be permitted on-site.



Pre-Application Staff Report

July 9, 2013



Case No:	13ZONE1003
Project Name:	Lagos Logos
Location:	448 Roberts Avenue
Owner(s):	Tommy and Donna Lago
Applicant:	Tommy and Donna Lago
Representative(s):	Tommy and Donna Lago
Project Area/Size:	0.49 Acres
Existing Zoning District:	R-4
Existing Form District:	Traditional Neighborhood
Jurisdiction:	Louisville Metro
Council District:	13-Vicki Aubrey Welch
Case Manager:	Julia Williams, Planner II

REQUEST

- Change in zoning from R-4 to C-2
- District Development plan

CASE SUMMARY/BACKGROUND/SITE CONTEXT

The proposal is for a screen printing/embroidery company currently operating within a residential zone. The applicant was cited for operating the business in a residential zone. The applicant previously operated the business as a home occupation. The proposal is located in a mixed use area while surrounded by residential zoning. Many of the properties in the area are vacant residentially zoned properties. At the terminus of Roberts Avenue to the east is a railroad and the entrance to Roberts Avenue is a heavy commercial area at Southside Drive and Strawberry Lane. To the north of the site are R-4 zoned single family residences and residentially zoned vacant property. To the south of the site is R-4 zoned property that was once the Kenwood Drive-In theatre. To the east of the site is single family R-4 zoned property. To the west of the site is vacant R-4 zoned property.

LAND USE/ZONING DISTRICT/FORM DISTRICT TABLE

	Land Use	Zoning	Form District
Subject Property			
Existing	Residential/Screen Printing Shop	R-4	Traditional Neighborhood
Proposed	Residential/Screen Printing Shop	C-2	Traditional Neighborhood
Surrounding Properties			
North	Residential/Vacant	R-4	Traditional Neighborhood
South	Vacant Drive-In Theatre	R-4	Traditional Neighborhood
East	Residential	R-4	Traditional Neighborhood
West	Vacant	R-4	Traditional Neighborhood

PREVIOUS CASES ON SITE

454284-Code enforcement issued a notice of violation to the site on May 7, 2013. The violations include an accessory structure being used for business storage; non-permitted sign on the property, a non-permitted use is existing on the property, and operating a non-permitted business in a residential zone.

INTERESTED PARTY COMMENTS

None received.

APPLICABLE PLANS AND POLICIES

- Cornerstone 2020
- Land Development Code

STANDARD OF REVIEW FOR REZONING

Criteria for granting the proposed form district change/rezoning:

1. The proposed form district/rezoning change complies with the applicable guidelines and policies Cornerstone 2020; OR
2. The existing form district/zoning classification is inappropriate and the proposed classification is appropriate; OR
3. There have been major changes of an economic, physical, or social nature within the area involved which were not anticipated in Cornerstone 2020 which have substantially altered the basic character of the area.

STAFF ANALYSIS FOR REZONING

Following is staff's analysis of the proposed rezoning against the Guidelines and Policies of Cornerstone 2020.

The site is located in the Traditional Neighborhood Form District

The Traditional Neighborhood Form District is characterized by predominantly residential uses, by a grid pattern of streets with sidewalks and often including alleys. Residential lots are predominantly narrow and often deep, but the neighborhood may contain sections of larger estate lots, and also sections of lots on which appropriately integrated higher density residential uses may be located. The higher density uses are encouraged to be located in centers or near parks and open spaces having sufficient carrying capacity. There is usually a significant range of housing opportunities, including multi-family dwellings.

Traditional neighborhoods often have and are encouraged to have a significant proportion of public open space such as parks or greenways, and may contain civic uses as well as appropriately located and integrated neighborhood centers with a mixture of mostly neighborhood-serving land uses such as offices, shops, restaurants and services. Although many existing traditional neighborhoods are fifty to one hundred twenty years old, it is hoped that the Traditional Neighborhood Form will be revitalized under the new Comprehensive Plan. Revitalization and reinforcement of the Traditional Neighborhood Form will require particular emphasis on (a) preservation and renovation of existing buildings in stable neighborhoods (if the building design is consistent with the predominant building design in those neighborhoods), (b) the preservation of the existing grid pattern of streets and alleys, (c) preservation of public open spaces.

The proposal requires more information on the existing right of way and pedestrian access to determine compliance with the transportation and circulation guidelines of the Comprehensive Plan.

All other agency comments should be addressed to demonstrate compliance with the remaining Guidelines and Policies of Cornerstone 2020.

A checklist is attached to the end of this staff report with a more detailed analysis. The Louisville Metro Planning Commission is charged with making a recommendation to the Louisville Metro Council regarding the appropriateness of this zoning map amendment. The Louisville Metro Council has zoning authority over the property in question.

TECHNICAL REVIEW

Please see attached agency review comment sheet.

STAFF CONCLUSIONS

The proposal is ready for a neighborhood meeting.

NOTIFICATION

Date	Purpose of Notice	Recipients
	LD&T on	1 st and 2 nd tier adjacent property owners and neighborhood notification recipients in council district 13.
	PC on	1 st and 2 nd tier adjacent property owners and neighborhood notification recipients in council district 13.

ATTACHMENTS

1. Zoning Map
2. Aerial Photograph
3. Cornerstone 2020 Staff Checklist

Attachment 1: Zoning Map



Attachment 2: Aerial Photograph



Attachment 3: Cornerstone 2020 Staff Checklist

- + Exceeds Guideline
- √ Meets Guideline
- +/- More Information Needed
- NA Not Applicable

#	Cornerstone 2020 Guidelines & Policies	Cornerstone 2020 Plan Element	Plan Element or Portion of Plan Element	Pre-App Finding	Pre-App Comments
1	Form Districts Goals C1-C4, Objectives C1.1-1.2, C2.1-2.7, C3.1-3.7, C4.1.-4.7	Community Form/Land Use Guideline 1: Community Form	B.2: The proposal preserves the existing grid pattern of streets, sidewalks and alleys.	√	The proposal will not change the existing pattern of streets.
2	Form Districts Goals C1-C4, Objectives C1.1-1.2, C2.1-2.7, C3.1-3.7, C4.1.-4.7	Community Form/Land Use Guideline 1: Community Form	B.2: The proposal introduces an appropriately-located neighborhood center including a mix of neighborhood-serving uses such as offices, shops and restaurants.	√	The proposal is located in an area between moderate industrial and high intensity commercial with some residential throughout. Some of the residential is vacant. C-2 permits the C-1 neighborhood serving uses as well as the more regional oriented C-2 uses.
3	Form Districts Goals C1-C4, Objectives C1.1-1.2, C2.1-2.7, C3.1-3.7, C4.1.-4.7	Community Form/Land Use Guideline 1: Community Form	B.2: The proposal preserves public open spaces, and if the proposal is a higher density use, is located in close proximity to such open space, a center or other public areas.	√	The proposal does not change the public open space. The proposal is not for high density.
4	Form Districts Goals C1-C4, Objectives C1.1-1.2, C2.1-2.7, C3.1-3.7, C4.1.-4.7	Community Form/Land Use Guideline 1: Community Form	B.2: The proposal preserves and renovates existing buildings if the building design of these structures is consistent with the predominate neighborhood building design.	√	The proposal preserves the existing buildings on the site. There is a mix of building design in the area.
5	Form Districts Goals C1-C4, Objectives C1.1-1.2, C2.1-2.7, C3.1-3.7, C4.1.-4.7	Community Form/Land Use Guideline 2: Centers	A.1/7: The proposal, which will create a new center, is located in the Traditional Neighborhood Form District, and includes new construction or the reuse of existing buildings to provide commercial, office and/or residential use.	√	The proposal will not create a new center but will be a part of an existing mixed use corridor. The proposal is for the re-use of existing buildings for commercial and residential uses.
6	Form Districts Goals C1-C4, Objectives C1.1-1.2, C2.1-2.7, C3.1-3.7, C4.1.-4.7	Community Form/Land Use Guideline 2: Centers	A.3: The proposed retail commercial development is located in an area that has a sufficient population to support it.	+/-	The proposal is expanding an existing home occupation. More information is needed on the area to determine if there is sufficient population to support the expansion of business.
7	Form Districts Goals C1-C4, Objectives C1.1-1.2, C2.1-2.7, C3.1-3.7, C4.1.-4.7	Community Form/Land Use Guideline 2: Centers	A.4: The proposed development is compact and results in an efficient land use pattern and cost-effective infrastructure investment.	+/-	The proposal is located in an area between moderate industrial and high intensity commercial with some residential throughout. Some of the residential is vacant. Due to the location between an industrial center and commercial center the infrastructure is available to support the use. More information is needed on the ROW for Roberts Avenue since LOJIC has indicated that it is private.
8	Form Districts Goals C1-C4, Objectives C1.1-1.2, C2.1-2.7, C3.1-3.7, C4.1.-4.7	Community Form/Land Use Guideline 2: Centers	A.5: The proposed center includes a mix of compatible land uses that will reduce trips, support the use of alternative forms of transportation and encourage vitality and sense of place.	+/-	More information is needed to determine compliance.

#	Cornerstone 2020 Guidelines & Policies	Cornerstone 2020 Plan Element	Plan Element or Portion of Plan Element	Pre-App Finding	Pre-App Comments
9	Form Districts Goals C1-C4, Objectives C1.1-1.2, C2.1-2.7, C3.1-3.7, C4.1-4.7	Community Form/Land Use Guideline 2: Centers	A.6: The proposal incorporates residential and office uses above retail and/or includes other mixed-use, multi-story retail buildings.	√	The proposal includes residential with the commercial business in a separate structure.
10	Form Districts Goals C1-C4, Objectives C1.1-1.2, C2.1-2.7, C3.1-3.7, C4.1-4.7	Community Form/Land Use Guideline 2: Centers	A.12: If the proposal is a large development in a center, it is designed to be compact and multi-purpose, and is oriented around a central feature such as a public square or plaza or landscape element.	NA	The proposal is not a large development.
11	Form Districts Goals C1-C4, Objectives C1.1-1.2, C2.1-2.7, C3.1-3.7, C4.1-4.7	Community Form/Land Use Guideline 2: Centers	A.13/15: The proposal shares entrance and parking facilities with adjacent uses to reduce curb cuts and surface parking, and locates parking to balance safety, traffic, transit, pedestrian, environmental and aesthetic concerns.	+/-	The proposal does not share facilities with the adjacent uses as they are residentially zoned. More information on parking and pedestrian activity is needed.
12	Form Districts Goals C1-C4, Objectives C1.1-1.2, C2.1-2.7, C3.1-3.7, C4.1-4.7	Community Form/Land Use Guideline 2: Centers	A.14: The proposal is designed to share utility hookups and service entrances with adjacent developments, and utility lines are placed underground in common easements.	√	No new development is proposed that would indicate shared utilities at this time.
13	Form Districts Goals C1-C4, Objectives C1.1-1.2, C2.1-2.7, C3.1-3.7, C4.1-4.7	Community Form/Land Use Guideline 2: Centers	A.16: The proposal is designed to support easy access by bicycle, car and transit and by pedestrians and persons with disabilities.	-	The proposal supports access by car and bicycle.
14	Form Districts Goals C1-C4, Objectives C1.1-1.2, C2.1-2.7, C3.1-3.7, C4.1-4.7	Community Form/Land Use Guideline 3: Compatibility	A.2: The proposed building materials increase the new development's compatibility.	NA	No new building is proposed.
15	Form Districts Goals C1-C4, Objectives C1.1-1.2, C2.1-2.7, C3.1-3.7, C4.1-4.7	Community Form/Land Use Guideline 3: Compatibility	A.4/5/6/7: The proposal does not constitute a non-residential expansion into an existing residential area, or demonstrates that despite such an expansion, impacts on existing residences (including traffic, parking, signs, lighting, noise, odor and stormwater) are appropriately mitigated.	+/-	The proposal is a nonresidential expansion into an existing residential area. More information is needed on mitigating the impacts of the development on the adjacent property.
16	Form Districts Goals C1-C4, Objectives C1.1-1.2, C2.1-2.7, C3.1-3.7, C4.1-4.7	Community Form/Land Use Guideline 3: Compatibility	A.5: The proposal mitigates any potential odor or emissions associated with the development.	√	APCD has approved the proposal.
17	Form Districts Goals C1-C4, Objectives C1.1-1.2, C2.1-2.7, C3.1-3.7, C4.1-4.7	Community Form/Land Use Guideline 3: Compatibility	A.6: The proposal mitigates any adverse impacts of its associated traffic on nearby existing communities.	+/-	Transportation Planning is reviewing the proposal.
18	Form Districts Goals C1-C4, Objectives C1.1-1.2, C2.1-2.7, C3.1-3.7, C4.1-4.7	Community Form/Land Use Guideline 3: Compatibility	A.8: The proposal mitigates adverse impacts of its lighting on nearby properties, and on the night sky.	√	Lighting will meet LDC requirements.
19	Form Districts Goals C1-C4, Objectives C1.1-1.2, C2.1-2.7, C3.1-3.7, C4.1-4.7	Community Form/Land Use Guideline 3: Compatibility	A.11: If the proposal is a higher density or intensity use, it is located along a transit corridor AND in or near an activity center.	-	The proposal is for high intensity zoning not located along a transit corridor but located in between an industrial center and a commercial center.

#	Cornerstone 2020 Guidelines & Policies	Cornerstone 2020 Plan Element	Plan Element or Portion of Plan Element	Pre-App Finding	Pre-App Comments
20	Form Districts Goals C1-C4, Objectives C1.1-1.2, C2.1-2.7, C3.1-3.7, C4.1-4.7	Community Form/Land Use Guideline 3: Compatibility	A.21: The proposal provides appropriate transitions between uses that are substantially different in scale and intensity or density of development such as landscaped buffer yards, vegetative berms, compatible building design and materials, height restrictions, or setback requirements.	+/-	More information is needed to determine compliance.
21	Form Districts Goals C1-C4, Objectives C1.1-1.2, C2.1-2.7, C3.1-3.7, C4.1-4.7	Community Form/Land Use Guideline 3: Compatibility	A.22: The proposal mitigates the impacts caused when incompatible developments unavoidably occur adjacent to one another by using buffers that are of varying designs such as landscaping, vegetative berms and/or walls, and that address those aspects of the development that have the potential to adversely impact existing area developments.	+/-	More information is needed to determine compliance.
22	Form Districts Goals C1-C4, Objectives C1.1-1.2, C2.1-2.7, C3.1-3.7, C4.1-4.7	Community Form/Land Use Guideline 3: Compatibility	A.23: Setbacks, lot dimensions and building heights are compatible with those of nearby developments that meet form district standards.	√	No new construction is proposed that would affect the existing lot layout.
23	Form Districts Goals C1-C4, Objectives C1.1-1.2, C2.1-2.7, C3.1-3.7, C4.1-4.7	Community Form/Land Use Guideline 3: Compatibility	A.24: Parking, loading and delivery areas located adjacent to residential areas are designed to minimize adverse impacts of lighting, noise and other potential impacts, and that these areas are located to avoid negatively impacting motorists, residents and pedestrians.	+/-	More information is needed to determine compliance.
24	Form Districts Goals C1-C4, Objectives C1.1-1.2, C2.1-2.7, C3.1-3.7, C4.1-4.7	Community Form/Land Use Guideline 3: Compatibility	A.24: The proposal includes screening and buffering of parking and circulation areas adjacent to the street, and uses design features or landscaping to fill gaps created by surface parking lots. Parking areas and garage doors are oriented to the side or back of buildings rather than to the street.	+/-	More information is needed to determine compliance.
25	Form Districts Goals C1-C4, Objectives C1.1-1.2, C2.1-2.7, C3.1-3.7, C4.1-4.7	Community Form/Land Use Guideline 3: Compatibility	A.25: Parking garages are integrated into their surroundings and provide an active, inviting street-level appearance.	NA	A parking garage is not proposed.
26	Form Districts Goals C1-C4, Objectives C1.1-1.2, C2.1-2.7, C3.1-3.7, C4.1-4.7	Community Form/Land Use Guideline 3: Compatibility	A.28: Signs are compatible with the form district pattern and contribute to the visual quality of their surroundings.	+/-	More information is needed to determine compliance.
27	Livability Goals H3 and H5, all related objectives	Community Form/Land Use Guideline 4: Open Space	A.2/3/7: The proposal provides open space that helps meet the needs of the community as a component of the development and provides for the continued maintenance of that open space.	√	Much of the site is open space. The open space left on the site is more in character to the surrounding residential zoning.

#	Cornerstone 2020 Guidelines & Policies	Cornerstone 2020 Plan Element	Plan Element or Portion of Plan Element	Pre-App Finding	Pre-App Comments
28	Livability Goals H3 and H5, all related objectives	Community Form/Land Use Guideline 4: Open Space	A.4: Open space design is consistent with the pattern of development in the Neighborhood Form District.	√	Much of the site is open space. The open space left on the site is more in character to the surrounding residential zoning.
29	Livability Goals H3 and H5, all related objectives	Community Form/Land Use Guideline 4: Open Space	A.5: The proposal integrates natural features into the pattern of development.	√	No new construction is proposed.
30	Livability Goals H3 and H5, all related objectives	Community Form/Land Use Guideline 5: Natural Areas and Scenic and Historic Resources	A.1: The proposal respects the natural features of the site through sensitive site design, avoids substantial changes to the topography and minimizes property damage and environmental degradation resulting from disturbance of natural systems.	√	No new construction is proposed that would affect any natural features.
31	Livability Goals H3 and H5, all related objectives	Community Form/Land Use Guideline 5: Natural Areas and Scenic and Historic Resources	A.2/4: The proposal includes the preservation, use or adaptive reuse of buildings, sites, districts and landscapes that are recognized as having historical or architectural value, and, if located within the impact area of these resources, is compatible in height, bulk, scale, architecture and placement.	√	The proposal is not located on a site that has historical or cultural value.
31	Livability Goals H3 and H5, all related objectives	Community Form/Land Use Guideline 5: Natural Areas and Scenic and Historic Resources	A.6: Encourage development to avoid wet or highly permeable soils, severe, steep or unstable slopes with the potential for severe erosion.	√	Soils are not an issue with the site.
32	Land Use and Transportation Connection Goal E1, Objectives E1.1 and E1.3	Marketplace Guideline 6: Economic Growth and Sustainability	A.2: Ensure adequate access between employment centers and population centers.	+/-	More information is needed to determine compliance.
33	People, Jobs and Housing Goal K4, Objective K4.1	Marketplace Guideline 6: Economic Growth and Sustainability	A.3: Encourage redevelopment, reinvestment and rehabilitation in the downtown where it is consistent with the form district pattern.	NA	The proposal is not located in a downtown.
34	Marketplace Strategy Goal A1, Objectives A1.3, A1.4, A1.5	Marketplace Guideline 6: Economic Growth and Sustainability	A.4: Encourage industries to locate in industrial subdivisions or adjacent to existing industry to take advantage of special infrastructure needs.	NA	The proposal is not for industrial.
35	Land Use and Transportation Connection Goal E1, Objectives E1.1 and E1.3	Marketplace Guideline 6: Economic Growth and Sustainability	A.6: Locate retail commercial development in activity centers. Locate uses generating large amounts of traffic on a major arterial, at the intersection of two minor arterials or at locations with good access to a major arterial and where the proposed use will not adversely affect adjacent areas.	√	The proposal is not located in an activity center but is located between an existing industrial center and commercial center. Roberts Avenue is a local level road with access to a minor arterial at Southside Drive and a collector at Strawberry Lane.

#	Cornerstone 2020 Guidelines & Policies	Cornerstone 2020 Plan Element	Plan Element or Portion of Plan Element	Pre-App Finding	Pre-App Comments
36	Land Use and Transportation Connection Goal E1, Objectives E1.1 and E1.3	Marketplace Guideline 6: Economic Growth and Sustainability	A.8: Require industrial development with more than 100 employees to locate on or near an arterial street, preferably in close proximity to an expressway interchange. Require industrial development with less than 100 employees to locate on or near an arterial street.	NA	The proposal is not for industrial.
37	Mobility Goals A1-A6, B1, C1, D1, E1, E2, F1, G1, H1-H4, I1-I7, all related Objectives	Mobility/Transportation Guideline 7: Circulation	A.1/2: The proposal will contribute its proportional share of the cost of roadway improvements and other services and public facilities made necessary by the development through physical improvements to these facilities, contribution of money, or other means.	+/-	More information is needed to determine compliance.
38	Mobility Goals A1-A6, B1, C1, D1, E1, E2, F1, G1, H1-H4, I1-I7, all related Objectives	Mobility/Transportation Guideline 7: Circulation	A.3/4: The proposal promotes mass transit, bicycle and pedestrian use and provides amenities to support these modes of transportation.	+/-	More information is needed to determine compliance.
39	Mobility Goals A1-A6, B1, C1, D1, E1, E2, F1, G1, H1-H4, I1-I7, all related Objectives	Mobility/Transportation Guideline 7: Circulation	A.6: The proposal's transportation facilities are compatible with and support access to surrounding land uses, and contribute to the appropriate development of adjacent lands. The proposal includes at least one continuous roadway through the development, adequate street stubs, and relies on cul-de-sacs only as short side streets or where natural features limit development of "through" roads.	+/-	More information is needed to determine compliance.
40	Mobility Goals A1-A6, B1, C1, D1, E1, E2, F1, G1, H1-H4, I1-I7, all related Objectives	Mobility/Transportation Guideline 7: Circulation	A.9: The proposal includes the dedication of rights-of-way for street, transit corridors, bikeway and walkway facilities within or abutting the development.	+/-	More information is needed to determine compliance.
41	Mobility Goals A1-A6, B1, C1, D1, E1, E2, F1, G1, H1-H4, I1-I7, all related Objectives	Mobility/Transportation Guideline 7: Circulation	A.10: The proposal includes adequate parking spaces to support the use.	+/-	More information is needed to determine compliance.
42	Mobility Goals A1-A6, B1, C1, D1, E1, E2, F1, G1, H1-H4, I1-I7, all related Objectives	Mobility/Transportation Guideline 7: Circulation	A.13/16: The proposal provides for joint and cross access through the development and to connect to adjacent development sites.	+/-	More information is needed to determine compliance.
43	Mobility Goals A1-A6, B1, C1, D1, E1, E2, F1, G1, H1-H4, I1-I7, all related Objectives	Mobility/Transportation Guideline 8: Transportation Facility Design	A.8: Adequate stub streets are provided for future roadway connections that support and contribute to appropriate development of adjacent land.	NA	A new roadway is not proposed.
44	Mobility Goals A1-A6, B1, C1, D1, E1, E2, F1, G1, H1-H4, I1-I7, all related Objectives	Mobility/Transportation Guideline 8: Transportation Facility Design	A.9: Avoid access to development through areas of significantly lower intensity or density if such access would create a significant nuisance.	+/-	Access to the development is through an existing commercial activity center and then through an area that is single family residential. At the dead end of the road is moderate industrial zoning. More information on the existing uses and any nuisances they may create within

#	Cornerstone 2020 Guidelines & Policies	Cornerstone 2020 Plan Element	Plan Element or Portion of Plan Element	Pre-App Finding	Pre-App Comments
					the neighborhood is needed.
45	Mobility Goals A1-A6, B1, C1, D1, E1, E2, F1, G1, H1-H4, I1-I7, all related Objectives	Mobility/Transportation Guideline 8: Transportation Facility Design	A.11: The development provides for an appropriate functional hierarchy of streets and appropriate linkages between activity areas in and adjacent to the development site.	+/-	More information is needed to determine compliance.
43	Mobility Goals A1-A6, B1, C1, D1, E1, E2, F1, G1, H1-H4, I1-I7, all related Objectives	Mobility/Transportation Guideline 9: Bicycle, Pedestrian and Transit	A.1/2: The proposal provides, where appropriate, for the movement of pedestrians, bicyclists and transit users around and through the development, provides bicycle and pedestrian connections to adjacent developments and to transit stops, and is appropriately located for its density and intensity.	+/-	More information is needed to determine compliance.
44	Livability, Goals B1, B2, B3, B4, Objectives B1.1-1.8, B2.1-2.7, B3.1-3.4, B4.1-4.3	Livability/Environment Guideline 10: Flooding and Stormwater	The proposal's drainage plans have been approved by MSD, and the proposal mitigates negative impacts to the floodplain and minimizes impervious area. Solid blue-line streams are protected through a vegetative buffer, and drainage designs are capable of accommodating upstream runoff assuming a fully-developed watershed. If streambank restoration or preservation is necessary, the proposal uses best management practices.	+/-	MSD is reviewing the proposal.
45	Livability Goals C1, C2, C3, C4, all related Objectives	Livability/Environment Guideline 12: Air Quality	The proposal has been reviewed by APCD and found to not have a negative impact on air quality.	√	APCD has approved the proposal.
44	Livability, Goals F1 and F2, all related objectives	Livability/Environment Guideline 13: Landscape Character	A.3: The proposal includes additions and connections to a system of natural corridors that can provide habitat areas and allow for migration.	√	No new construction is proposed that would affect any natural features.
46	Quality of Life Goal J1, Objectives J1.1-1.2	Community Facilities Guideline 14: Infrastructure	A.2: The proposal is located in an area served by existing utilities or planned for utilities.	√	Existing utilities serve the site.
47	Quality of Life Goal J1, Objectives J1.1-1.2	Community Facilities Guideline 14: Infrastructure	A.3: The proposal has access to an adequate supply of potable water and water for fire-fighting purposes.	√	An adequate water supply exists for the site.
48	Livability Goal B1, Objective B1.3	Community Facilities Guideline 14: Infrastructure	A.4: The proposal has adequate means of sewage treatment and disposal to protect public health and to protect water quality in lakes and streams.	+/-	MSD is reviewing the proposal.

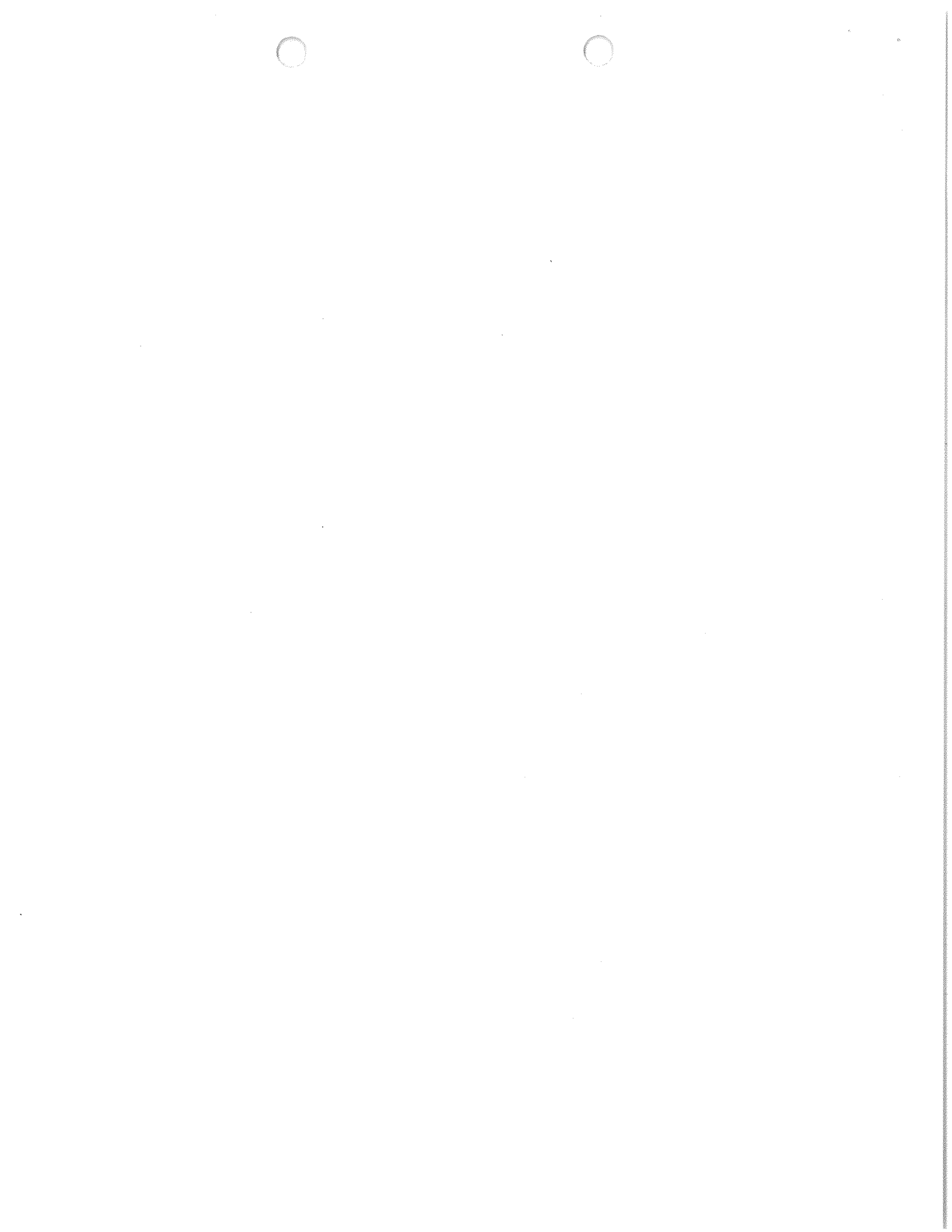



Louisville-Jefferson County Metro Government
Department of Codes & Regulations

Planning and Design Services
 444 S. 5th Street, Suite 300 - Louisville, KY 40202
 Phone: 502.574.6230 Web Site: louisvilleky.gov/ipl/planningdesign/

A g e n c y R e v i e w C o m m e n t s

Project Number: 13ZONE1003 **Submittal Date:** 06/11/2013
Address: 448 ROBERTS AVE
Contact Name: TOMMY A & DONNA L LAGO
Contact Phone: (502)367-1322x **Contact Email:**
Project Name: No Project Name Given.
Type of Work: ZONE

Project Description: Zoning change to allow continuation of home based business for screen printing

The following report represents a comprehensive set of agency comments for the above mentioned development proposal. Please review and address the comments provided in order to respond appropriately and move this case forward in this review process. Questions may be directed to your case manager:

Case Manager	Phone	EMAIL
JULIA WILLIAMS	(502)574-6942x	Julia.Williams@louisvilleky.gov

Review Type: Metro DPW (Pre-Application)		
Review By: TAMMY MARKERT	Reviewer Email:	tammy.markert@louisvilleky.gov
Review Result: COMPLETED	Result Date:	07/03/2013

- Please provide the dimension from the centerline of the roadway to the right of way. I can't pull up referenced DB 1036 PG 44 to verify that Roberts Ave is public right-of-way. LOJIC shows the frontage as a private road. Please provide this information by e-mail to tammy.markert@louisvilleky.gov
- Please provide typical dimensions for the parking stalls, aisles, and modules.
- Please provide parking calculations minimums and maximums according to Chapter 9 on the plan.
- Additional comments may be made once revised plan is submitted to case manager for review.
- Please show and label the edge of pavement and pavement width of Roberts Ave. (6.2.5)

Review Type: PDS (Pre-Application)		
Review By: JULIA WILLIAMS	Reviewer Email:	Julia.Williams@louisvilleky.gov
Review Result: COMPLETED	Result Date:	07/09/2013

- Code Violation Text: Please indicate the form district for all adjacent property owners.
- Code Violation Text: Please provide typical dimensions for the parking stalls, aisles, and modules.
- Code Violation-Text: Please show and label any existing or proposed easements on the plan.
- Code Violation Text: Please provide the sites floor area ratio on the plan.
- Code Violation Text: Please show and label any existing or proposed fences or walls on the plan.
- Code Violation Text: Please provide flow arrows on the plan.
- Code Violation Text: Please provide a legend for all the symbols and line types used on the plan.
- Louisville Metro EMA/MetroSafe GIS Addressing Division has no concerns with the Zoning Change requested by Docket No.

13ZONE1003, for the Lago's Log located at 448 & 450 Roberts Avenue. Ron Reynolds GIS Supervisor Emergency Management Agency / MetroSafe 10 S 5th Street, Suite 349 Louisville, KY 40202 Ph.: (502) 572-3492 Fax: (502) 572-3544 e-mail: ron.reynolds@louisvilleky.gov

- The nearest transit stop is located on the corner of Southside Driver and Strawberry Lane/Roberts Avenue. No boarding area is required for this application. Nicholas Seivers, AICP Transit Authority of River City 1000 West Broadway Louisville, KY 40203 (502) 561-5146

-
- Code Violation Text: Please provide parking calculations minimums and maximums according to Chapter 9 on the plan.
- Please provide more information on the Roberts Avenue ROW.

-
- Code Violation Text: Add this note: Compatible utilities shall be placed in a common trench unless otherwise required by appropriate agencies.

-
- Code Violation Text: Please indicate the sites zoning district on the plan.

-
- Code Violation Text: Utility easements may not overlap LBAs by more than 50%. Please revise.
- A 25'/35' LBA is required where the site is adjacent to residential zoning. Structures and pavement may not encroach into the LBAs.
- Please indicate the sites vehicle use area (VUA) square footage on the plan.

- A minimum 5' VUA LBA will be required along Roberts Ave.

- Depending on the parking and VUA square footage interior landscape areas (ILAs) may be required.