

TOTAL DISTURBANCE AREA: 1720.98 SF  
 TOTAL EXISTING IMPERVIOUS AREA: 1720.98 SF  
 TOTAL PROPOSED IMPERVIOUS AREA: 606.94 SF  
 TOTAL NET IMPERVIOUS AREA: -1114.04 SF

PRELIMINARY APPROVAL

Condition of Approval: \_\_\_\_\_

*Tony Kell* 06/8/16  
 Development Review Date

LOUISVILLE & JEFFERSON COUNTY  
 METROPOLITAN SEWER DISTRICT

Rev.	Date	Description	By	App.

**BHC RHODES**  
 Civil Engineering • Surveying • Utilities  
 7101 College Blvd., Suite 400  
 Overland Park, Kansas 66210  
 P. (913) 663-1900 F. (913) 663-1633  
 BHC Rhodes is a member of Berglund Rhoads & Company, P.A.

**RECEIVED**  
 MAY 09 2016  
 PLANNING & DESIGN SERVICES

LOUISVILLE HUT 115  
 SITE IMPROVEMENT PLANS  
 8346 DIXIE HWY  
 PRELIMINARY SITE PLAN  
 Design: PJJ Drawn: JER  
 Checked: PJJ  
 Issue Date: 04/14/2016  
 Project Number: 022320.02  
 2 of 3  
**C1.2**

May 09, 2016 - 8:37am Plotted By: notham.bertrand T:\022320.01.02-1st Site-Louisville\DWG\Eng\Sheet\SPF 115\Exhibit\_11517\022320.02-115-SITE-LAY-11x17.dwg Layout: Layout1

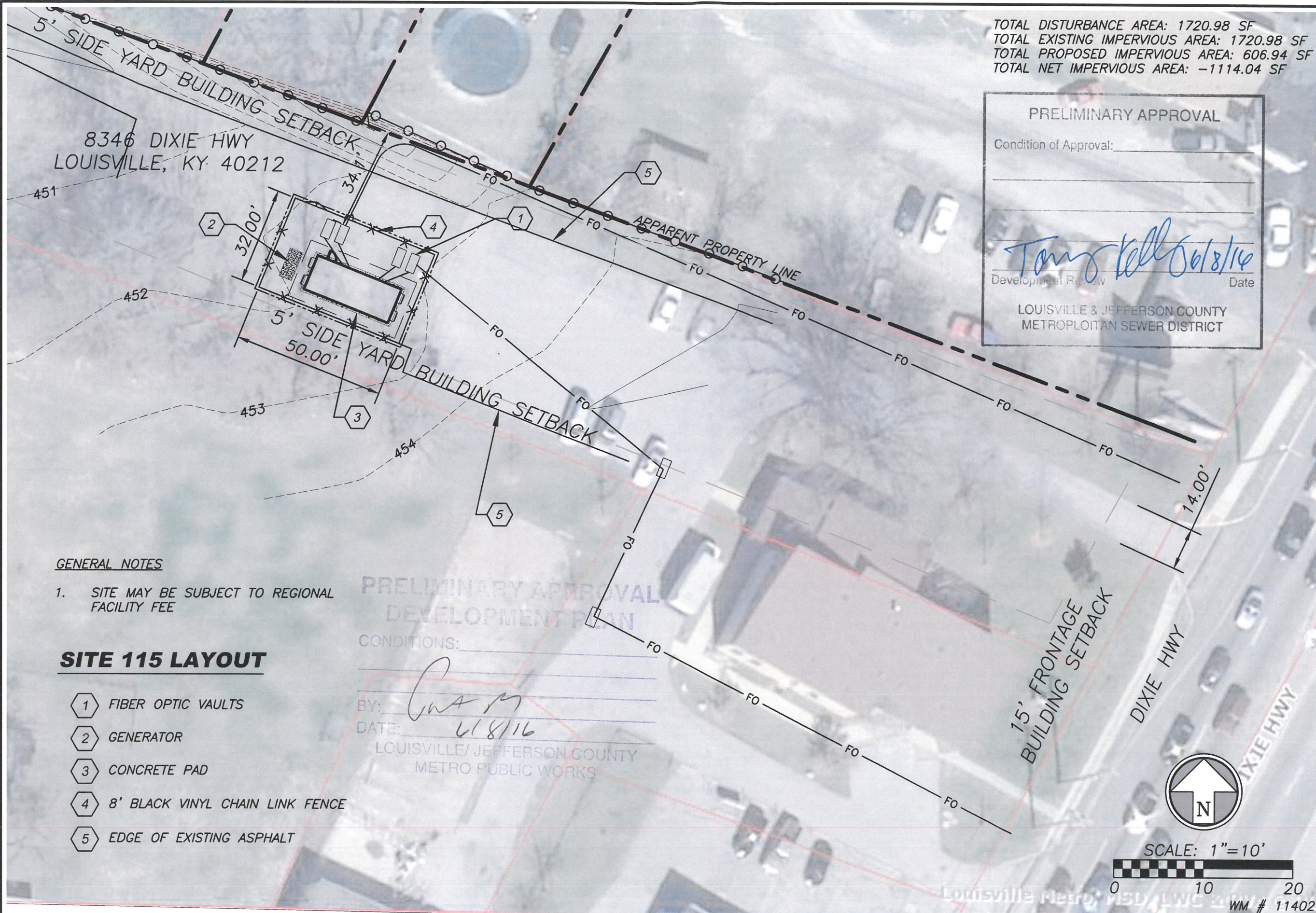

GENERAL NOTES

1. SITE MAY BE SUBJECT TO REGIONAL FACILITY FEE

**SITE 115 LAYOUT**

- 1 FIBER OPTIC VAULTS
- 2 GENERATOR
- 3 CONCRETE PAD
- 4 8' BLACK VINYL CHAIN LINK FENCE
- 5 EDGE OF EXISTING ASPHALT

PRELIMINARY APPROVAL  
 DEVELOPMENT PLAN

CONDITIONS: \_\_\_\_\_

BY: *G.A.M.*

DATE: 6/8/16

LOUISVILLE/JEFFERSON COUNTY  
 METRO PUBLIC WORKS

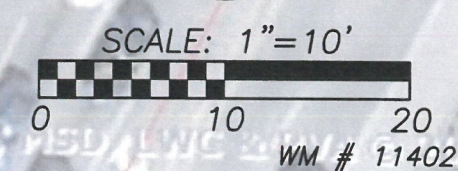

Louisville Metro MSD/LWC WM # 11402