

LINE TABLE

LINE	BEARING	DISTANCE
L1	N 64°59'26" E	20.85'
L2	N 25°00'34" W	39.50'
L3	S 65°00'10" W	11.38'
L4	S 42°32'31" W	60.89'
L5	N 87°49'26" W	40.00'

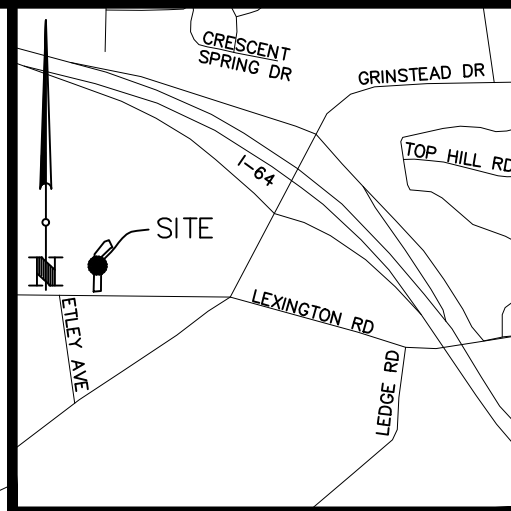

LOCATION MAP

NO SCALE

LOUISVILLE & JEFFERSON
COUNTY MSD
2301 LEXINGTON RD
T.B. 70J, LOT 18
D.B. 11379, PG. 918

10779 S.F.±
0.25 AC.±

JDG TRIANGLE
PARTNERS LEX
2313 LEXINGTON RD
T.B. 70H, LOT 01
D.B. 10330, PG. 399

LOUISVILLE & JEFFERSON
COUNTY MSD
2345 LEXINGTON RD
T.B. 70H, LOT 06
D.B. 11789, PG. 168

JDG TRIANGLE
PARTNERS LEX
2297 LEXINGTON RD
T.B. 70J, LOT 11
D.B. 11905, PG. 292



NORTH & ALL BEARINGS SHOWN HEREON
ARE BASED ON KY STATE PLANE COORDINATES
SYSTEM, NORTH ZONE (NAD 83).

N 01°50'48" E 189.03'

BEARGRASS AVENUE 40' R/W

S 01°53'03" W 174.52'

POINT OF BEGINNING

LEXINGTON ROAD R/W VARIES

LEGEND

—○— DIMENSION POINT

GRAPHIC SCALE 1"=40'



**ROAD CLOSURE
EXHIBIT**

PROPERTY OF:
COMMONWEALTH OF KENTUCKY
200 MERO ST
FRANKFORT, KY 40601

PROPERTY ADDRESS:
BEARGRASS AVE.
LOUISVILLE, KY 40206

DATE: 07/13/22

SCALE: 1"=40'



MINDEL SCOTT

ENGINEERING ► SURVEYING ►
PLANNING ► LANDSCAPE ARCHITECTURE
5151 Jefferson Blvd. Louisville, KY 40219
502-485-1508 ► MindelScott.com