

RECEIVED

APR 15 2019

PLANNING & DESIGN SERVICES

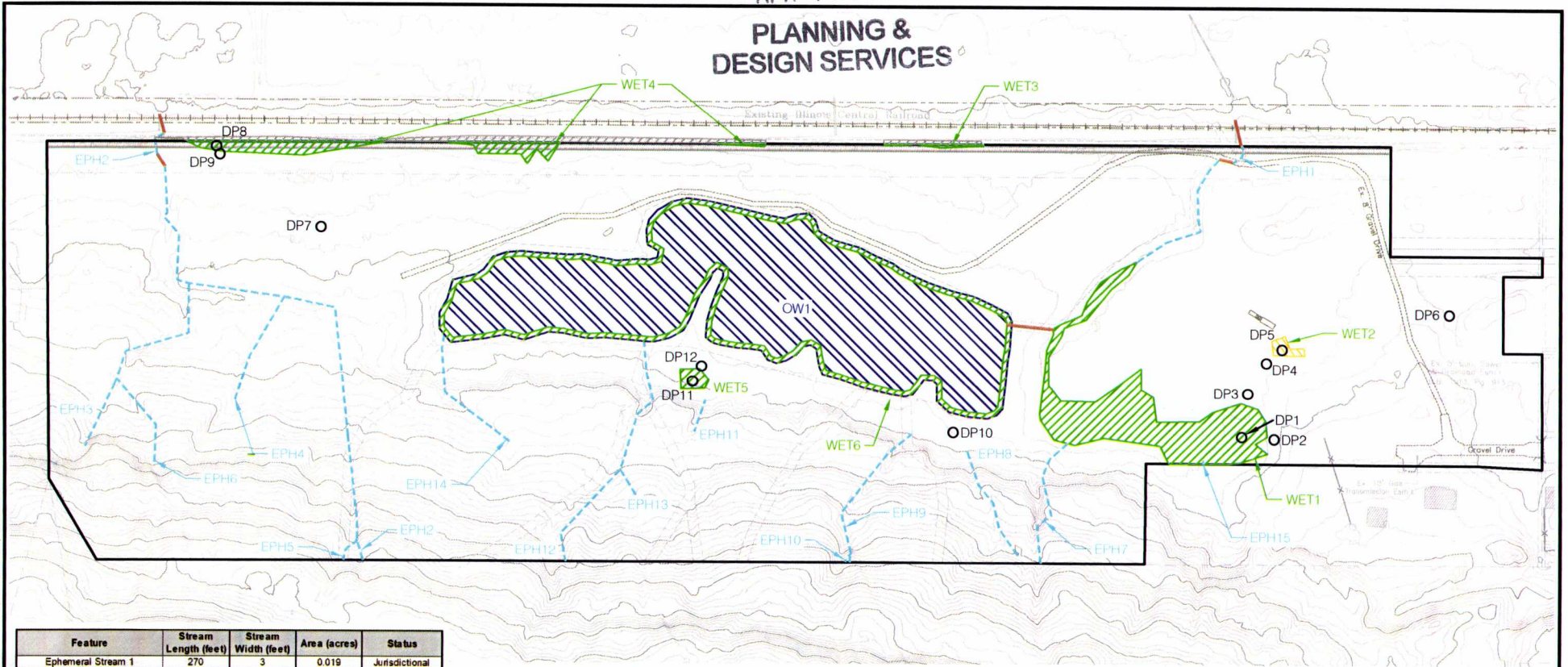

Feature	Stream Length (feet)	Stream Width (feet)	Area (acres)	Status
Ephemeral Stream 1	270	3	0.019	Jurisdictional
Ephemeral Stream 2	870	2.5	0.050	Jurisdictional
Ephemeral Stream 3	340	2	0.016	Jurisdictional
Ephemeral Stream 4	180	1.5	0.006	Jurisdictional
Ephemeral Stream 5	40	2.5	0.002	Jurisdictional
Ephemeral Stream 6	150	1.25	0.004	Jurisdictional
Ephemeral Stream 7	215	2	0.010	Jurisdictional
Ephemeral Stream 8	180	2	0.008	Jurisdictional
Ephemeral Stream 9	245	2.5	0.014	Jurisdictional
Ephemeral Stream 10	15	2	0.001	Jurisdictional
Ephemeral Stream 11	50	2	0.002	Jurisdictional
Ephemeral Stream 12	395	3	0.027	Jurisdictional
Ephemeral Stream 13	45	1.5	0.002	Jurisdictional
Ephemeral Stream 14	215	2	0.010	Jurisdictional
Ephemeral Stream 15	5	1.25	<0.001	Jurisdictional
Ephemeral Stream Total	3,215		0.171	
Wetland 1	--	--	0.643	Jurisdictional
Wetland 2	--	--	0.021	Isolated
Wetland 3	--	--	0.007	Jurisdictional
Wetland 4	--	--	0.153	Jurisdictional
Wetland 5	--	--	0.026	Jurisdictional
Wetland 6	--	--	0.414	Jurisdictional
Wetland Total *			1.243	
Pond 1	--	--	2.940	Jurisdictional
Wetland Total			2.940	
Jurisdictional Features Total*	3,215		4.354	

- LEGEND
- PROJECT BOUNDARY
 - - - - EPHEMERAL STREAM
 - ▨ OPEN WATER POND
 - ▨ WETLAND
 - ▨ OFFSITE WETLAND
 - ▨ ISOLATED WETLAND
 - CULVERT
 - DP1 WETLAND DETERMINATION DATA POINT

NOTE: JURISDICTIONAL WATER/WETLAND BOUNDARIES WERE DELINEATED AND SURVEYED USING GLOBAL POSITIONING SYSTEM EQUIPMENT BY REDWING WETLAND SCIENTISTS ON SEPTEMBER 27 AND 28, 2018. THESE BOUNDARIES HAVE NOT BEEN VERIFIED BY THE U.S. ARMY CORPS OF ENGINEERS. USE OF THIS MAP IS FOR PRELIMINARY PLANNING PURPOSES ONLY.

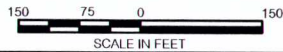

MCDEANE ROAD PROPERTY
JEFFERSON COUNTY, KENTUCKY

REVISED DATE: 10-10-18 DRAWN BY: EDB



WATER/WETLAND
LOCATION MAP

FIGURE 3

P:\2018 Projects\18-102-McDeane Road Property\Figures\DW\18-102-SitePlan_Water\Wetland_Eric Bowman_10/10/2018 8:22 AM

19ADEVPLAN1059