



Street & Alley Closure Application

Louisville Metro Planning & Design Services

Case No.: 15 STREETS/006 Intake Staff: RM

Date: 3/19/15 Fee: \$160 Waived

Applications are due on Mondays at 2:00 p.m. in order to be processed that week. Once complete, please bring the application and supporting documentation to: Planning and Design Services, located at 444 South 5th Street, Suite 300. For more information, call (502) 574-6230 or visit <http://www.louisvilleky.gov/PlanningDesign>.

Street/Alley Name: Unnamed Alleys

Location (e.g. nearest intersecting streets): Between Muhammad Ali Blvd., Liberty, Second and Third

Number of Adjoining Property Owners: 1

RECEIVED

MAR 19 2015

PLANNING & DESIGN SERVICES

Please submit the following items:

- Notarized signatures of:
 - Property owners representing at least 51% of all property owners whose property is affected street or alley, OR
 - Property owners representing more than 51% of the linear street frontage.

Note: Sample consent form can be found on last page
- A written justification statement detailing why the proposed closure is in compliance with the Comprehensive Plan and addressing provisions for adequate public facilities
- One set of mailing label sheets for: all property owners adjacent to the affected street or alley extending to the nearest intersecting street, and all governmental units having jurisdiction.
Property ownership information can be found at the Property Valuation Administrator (PVA) office at 531 Court Place, Suite 504. Instructions to obtain APO information: <http://www.louisvilleky.gov/PlanningDesign/APO>
- One copy of the mailing label sheets
- Four copies of a metes and bounds legal description of the area proposed for closure signed and sealed by a registered land surveyor in the Commonwealth of Kentucky
- Four copies of a plat (drawn to engineer's scale) that describes the area proposed for permanent closure, including the following elements:

<input type="checkbox"/> Title of the plat	<input type="checkbox"/> Vicinity Map	<input type="checkbox"/> Area proposed for permanent closure outlined in a heavy, solid line and cross-hatched to clearly identify the area
<input type="checkbox"/> Surveyor's name and address	<input type="checkbox"/> Legend	<input type="checkbox"/> Property lines with bearings and distances
<input type="checkbox"/> Source of title, if applicable	<input type="checkbox"/> Plat Scale	<input type="checkbox"/> Location, ownership, mailing address, deed book & page of all adjacent property owners
<input type="checkbox"/> Plan date	<input type="checkbox"/> Street/alley names	<input type="checkbox"/> Existing MSD Easements
<input type="checkbox"/> Revision date	<input type="checkbox"/> Right of way, with widths shown	<input type="checkbox"/> Proposed MSD Easements
<input type="checkbox"/> North Arrow	<input type="checkbox"/> Net and gross acreage of site	<input type="checkbox"/> Land Surveyor's Certificate
- If the closing or abandonment is requested in connection with a proposed project, one copy of the proposed site plan
- \$ 160 Application Fee (*Cash, charge or check made payable to the Department of Codes & Regulations*)

Contact Information:

Owner: Check if primary contact

Applicant: Check if primary contact

Name: E. Jeffrey Mosley

Name: David B. Wagner

Company: Louisville/Jefferson County Metro

Company: Planning Commission

Address: 444 S. Fifth Street, Suite 600

Address: 444 S. Fifth St., Suite 300

City: Louisville State: KY Zip: 40202

City: Louisville State: KY Zip: 40202

Primary Phone: 502-574-1375

Primary Phone: 502-574-6230

Alternate Phone: _____

Alternate Phone: _____

Email: Jeff.mosley@louisvilleky.gov

Email: David.wagner@louisvilleky.gov

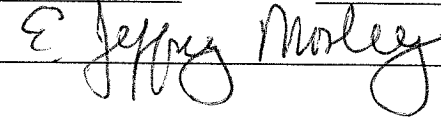
Owner Signature (required): 



Attorney: Check if primary contact

Plan prepared by: Check if primary contact

Name: John Wilmes

Name: Bruce Snook

Company: Office of Jefferson County Attorney

Company: HDR

Address: 531 Court Place, 9th Floor

Address: 401 W. Market Street, Suite 500

City: Louisville State: KY Zip: 40202

City: Louisville State: KY Zip: 40202

Primary Phone: 502-574-3348

Primary Phone: 502-584-4118

Alternate Phone: _____

Alternate Phone: _____

Email: John.wilmes@louisvilleky.gov

Email: Bruce.snook@hdrinc.com

Certification Statement: A certification statement **must be submitted** with any application in which the owner(s) of the subject property is (are) a limited liability company, corporation, partnership, association, trustee, etc., or if someone other than the owner(s) of record sign(s) the application.

I, E. Jeffrey Mosley, in my capacity as representative, hereby representative/authorized agent/other

certify that Louisville/Jefferson County Metro Government is (are) the owner(s) of the property which name of LLC / corporation / partnership / association / etc.

is the subject of this application and that I am authorized to sign this application on behalf of the owner(s).

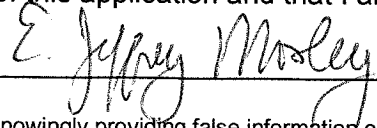
Signature:  Date: 3/19/15

I understand that knowingly providing false information on this application may result in any action taken hereon being declared null and void. I further understand that pursuant to KRS 523.010, et seq. knowingly making a material false statement, or otherwise providing false information with the intent to mislead a public servant in the performance of his/her duty is punishable as a Class B misdemeanor.

15 STREETS 1006

CONSENT TO STREET OR ALLEY CLOSURE

I have been notified that an application to close unnamed alleys (street/alley) will be filed with the Louisville Metro Planning Commission. The Planning Commission will make a recommendation concerning the closure to the legislative body having jurisdiction over the street / alley described above.

I, as an abutting property owner to the street / alley being closed, do hereby consent and agree to the closure.

Property Owner Signature: E. Jeffrey Mosley

Name: E. Jeffrey Mosley

Owner Address: 444 S. Fifth Street, Suite 600

Subscribed and sworn to, before me, by E. Jeffrey Mosley,
this 19 day of March, 2015. My Commission expires: January 8, 2018

Notary Public: Amanda Patterson

RECEIVED

MAR 19 2015

PLANNING &
DESIGN SERVICES

15 STREETS/006

JUSTIFICATION STATEMENT

The two alleys proposed to be closed are internal to the property owned by Louisville Metro and are not open to use by the general public. All abutting properties are owned by Louisville Metro. The alleys are required to be closed to enable the construction of a \$289 million mixed use project, consisting of a convention hotel, residential apartments, a public parking garage, a full service grocery and other retail, to be constructed on a majority of the block bounded by Muhammad Ali Boulevard, Liberty, Second and Third Streets by Omni Louisville, LLC.

RECEIVED

MAR 19 2015

PLANNING &
DESIGN SERVICES

15 STREET 1006

PROPOSED SITE PLAN

[On following page]

RECEIVED

MAR 19 2015

PLANNING &
DESIGN SERVICES

155 STREETS 10246

15 STRUTS/1000

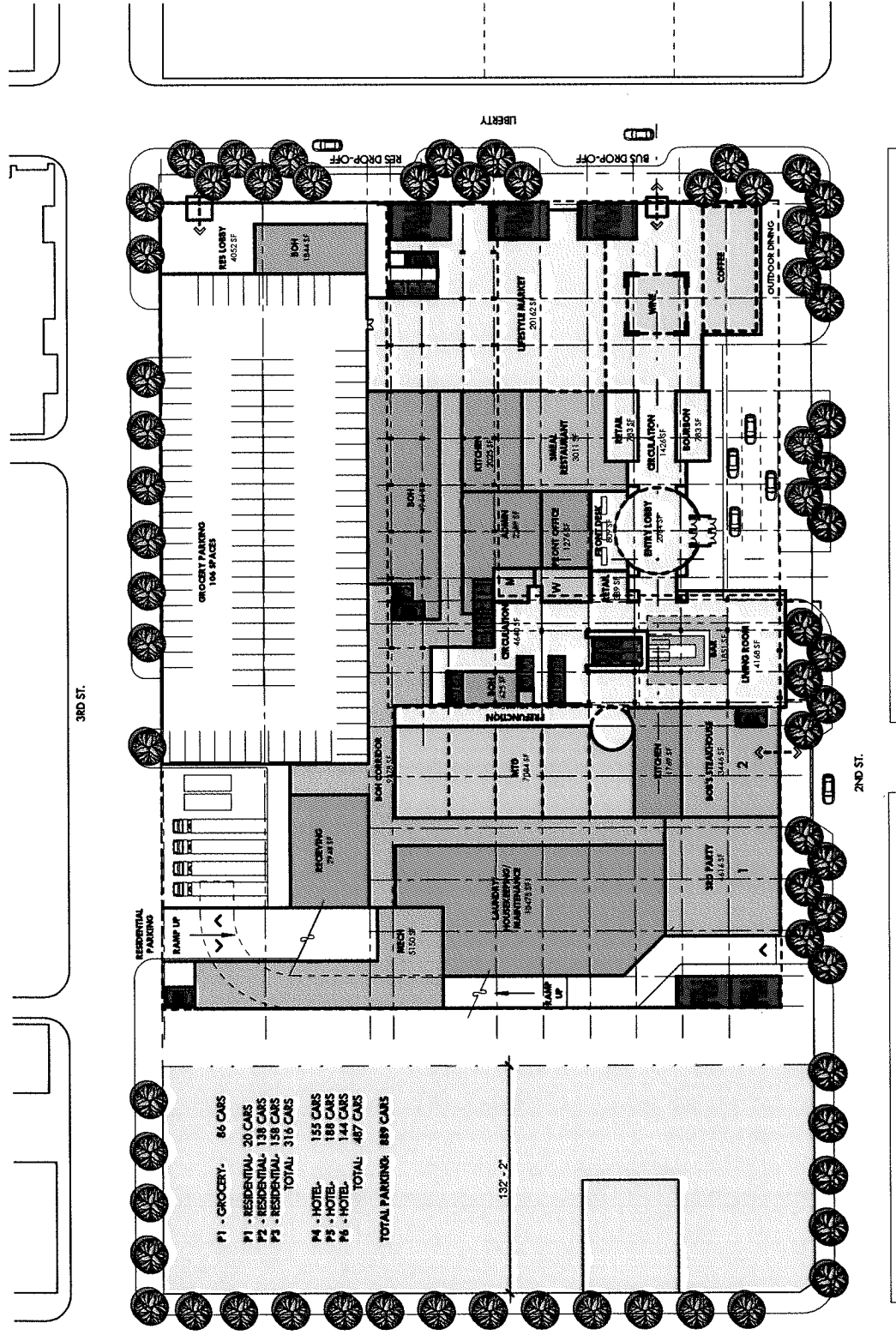

P1 - GROCERY	86 CARS
P1 - RESIDENTIAL	20 CARS
P2 - RESIDENTIAL	138 CARS
P3 - RESIDENTIAL	158 CARS
TOTAL	316 CARS
P4 - HOTEL	155 CARS
P5 - HOTEL	188 CARS
P6 - HOTEL	144 CARS
TOTAL	487 CARS
TOTAL PARKING	899 CARS

DESIGN SERVICES
& TRAINING

MAR 19 2015

RECEIVED

LEVEL 1
GROUND FLOOR PLAN
0 10 20 30 40 FT

OMNI LOUISVILLE, KENTUCKY

2.16.2015

HKS
ARCHITECTS

PRELIMINARY