

# Louisville Metro Council City Agency Request

- Neighborhood Development Fund (NDF)
- Capital Infrastructure Fund (CIF)
- Municipal Aid Program (MAP)
- Paving Fund (PAV)

**Primary Sponsor:** Councilwoman Jessica Green Metro District 1

**Amount:** \$4,293.56

**Date:** 8/21/2015

**Description of program/project including public purpose, additional funding sources, location of project/program and any external grantee(s):**

Rockford Lane & Graston Ave sidewalk improvements , which include sidewalk extension from Rockford Lane to Graston Ave and adding a standard curb and gutter along the new sidewalk . Transit Authority of River City ( TARC) will be installing a bench pad ( bus stop) on Rockford Lane as well as a new steel bench at the TARC stop @ 2300 Rockford Lane

2300 Rockford Lane ( SR3 4398114 ) \$4,293.56

Funding Source  
D1 CIF

**City Agency:** Metro Public Works & Assets

**Contact Person:** Taghizadeh Mojgan

**Agency Phone:** 502 574 3873

**I have reviewed this request for an expenditure of city tax dollars, and have determined the funds will be used for a public purpose.**

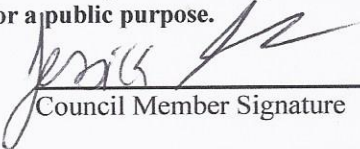
<u>1</u>		<u>\$4,293.56</u>	<u>8/21/2015</u>
District #	Council Member Signature	Amount	Date

**Approved by:** \_\_\_\_\_ \_\_\_\_\_  
Appropriations Committee Chairman Date

**Clerk's Office & OMB Use Only:**

Request Amount: \_\_\_\_\_ Amended Amount: \_\_\_\_\_  
 Reference #: \_\_\_\_\_ To OMB: \_\_\_\_\_  
 Budget Revision #: \_\_\_\_\_  
 Account #: \_\_\_\_\_  
 To Project Manager: \_\_\_\_\_ Completion Date: \_\_\_\_\_  
 Actual Cost: \_\_\_\_\_ Funds Returned: \_\_\_\_\_

## CIF, NDF, MAP OR PAV INTERAGENCY CHECKLIST

**Interagency Name:** Metro Public Works & Assets

**Program/Project Name:** Rockford Lane & Graston Ave Sidewalk Improvements

	Yes/No/NA
<b>Request Form:</b> Is the Request Signed by all Council Member(s) Appropriating Funding?	Yes
<b>Request Form:</b> If matching funds are to be used, are they disclosed with account numbers in the request form description?	NA
<b>Request Form:</b> If matching funds are to be used, does the amount of the request exclude the matching fund amount?	NA
<b>Request Form:</b> If other funds are to be used for this project, are they disclosed with account numbers in the request form description?	Yes
<b>Funding Source:</b> If CIF is being requested, does Metro Louisville own/will own the real estate, building or equipment? If not, the funding source is probably NDF.	Yes
<b>Funding Source:</b> If CIF is being requested, does the project have a useful life of more than one year? If not, the funding source is probably NDF.	Yes
<b>Ordinance Required:</b> Is the NDF request to a Metro Agency greater than \$5,000? If so, an ordinance is required.	No
<b>Ordinance Required:</b> Is the request a transfer from NDF to cost center? If so, is the amount given for the fiscal year \$25,000 or less?	No
<b>Supporting Documentation:</b> Does the attachment include a valid estimate and description of cost?	Yes

**Prepared by:**

Charles Weathes



**Date:** 8/21/2015

# TRANSIT AUTHORITY OF RIVER CITY

## ROCKFORD LANE & GRASTON AVENUE

### SIDEWALK IMPROVEMENTS

CONTRACT NO. 98688

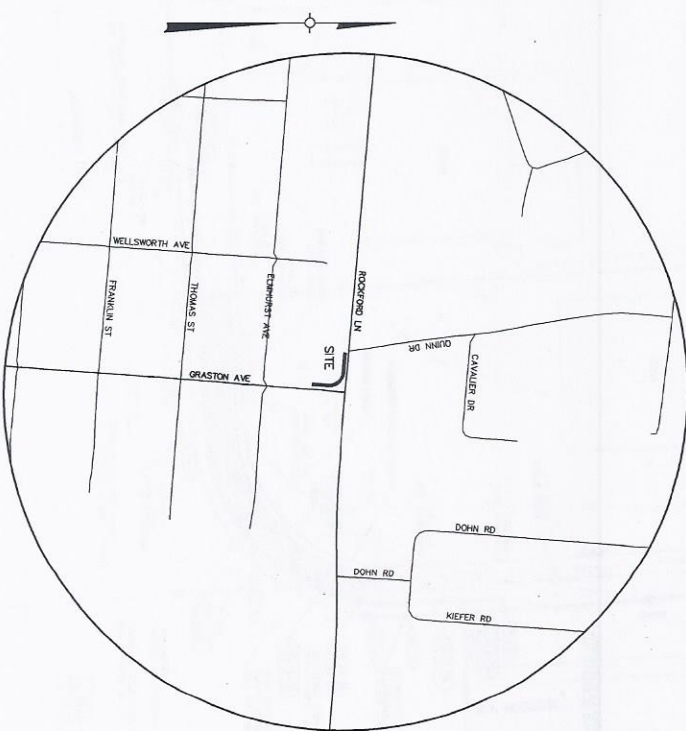

LOCATION MAP  
NO SCALE

**UTILITY PROTECTION NOTE**  
ALL UTILITIES ON THESE PLANS ARE APPROXIMATE. INDIVIDUAL SERVICE LINES ARE NOT SHOWN. THE CONNECTION OF DISCONTINUOUS SIGNAL, POWER AND TELEPHONE LINES TO THE MAIN LINES IS NOT SHOWN. THE USER SHALL BE RESPONSIBLE FOR VERIFYING THE LOCATION AND DEPTH OF ALL UTILITIES PRIOR TO ANY CONSTRUCTION. THE USER SHALL BE RESPONSIBLE FOR OBTAINING ALL NECESSARY PERMITS FROM THE APPROPRIATE AGENCIES. THE USER SHALL BE RESPONSIBLE FOR PROTECTING ALL UTILITIES FROM DAMAGE DURING CONSTRUCTION. THE USER SHALL BE RESPONSIBLE FOR REPAIRING ANY DAMAGE TO UTILITIES CAUSED BY THE USER'S WORK. THE UTILITY COMPANIES INCLUDE: IBERDROLA AND

INDEX TO DRAWINGS	
SHEET NO.	DESCRIPTION
1	TITLE SHEET
2	SITE LAYOUT, GRADING & DRAINAGE PLAN
3	GROSS SECTIONS
4	CONSTRUCTION DETAILS

DATE: 06-12-15



DRAWING: 1 of 4

 [Print](#) | [Close](#)

**Service Request Number:**

**4398114**

**Service Request Date:**

Tuesday, February 03, 2015

**Problem:**

2300 ROCKFORD LN LOUISVILLE KY 40216-0000

**Location:**

2300 Rockford LN, KY This problem extends on to Graston Ave . The intersection of Rockford Ln & Graston Ave  
2300 Rockford Ln , Cars turning right at this intersection

**Comments:**

drive in the yard at 2300 . There are no curbs at this location and this is a State owed road Ky  
-2051 and its causing water to pond in the complainants yard  
have created a hole at this location causing automobiles to

**Inspector Assigned:**

Yes

**Inspected:**

No

**Work Required:**

Yes

**Request Completed:**

Wednesday, February 11, 2015

**Resolution Description:**

WORK COMPLETED

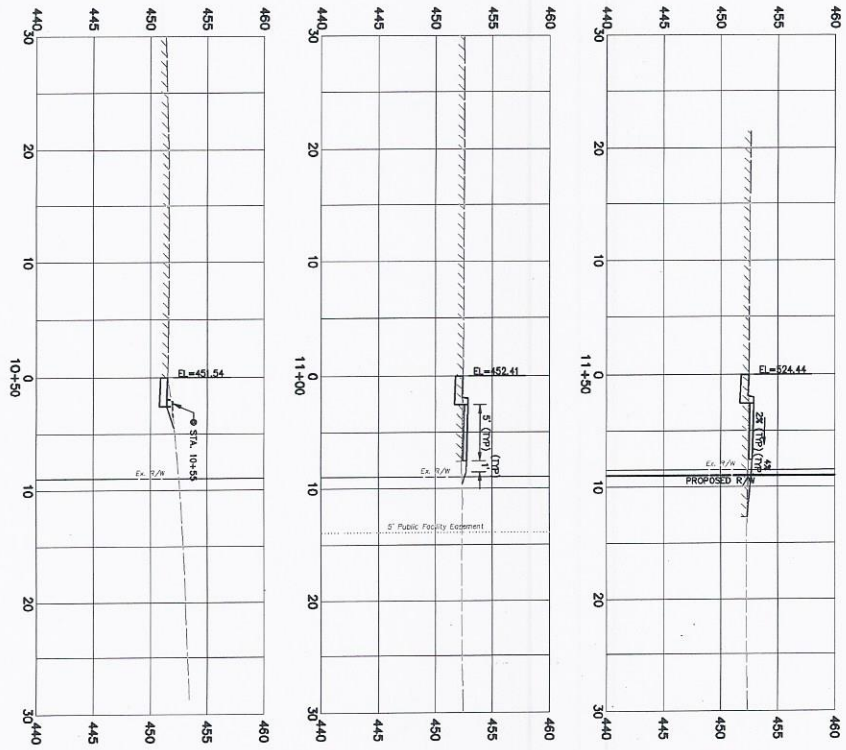

3  
OF 4

**TARC**  
 ROCKFORD LN. & GRASTON AVE  
 SIDEWALK IMPROVEMENTS

CROSS SECTIONS



ONE RIVERFRONT PLAZA  
 401 W. MAIN STREET, SUITE 600  
 LOUISVILLE, KENTUCKY 40202  
 PHONE: 502.260.3224  
 FAX: 502.909.3225

SCALE: 1" = 5'  
 CONTRACT NO.: 04-18000  
 PROJECT NO.: 256032  
 DESIGNED BY: NMM  
 DRAWN BY: WML  
 CHECKED BY: J/K

REVISIONS:		
NO.	DATE	DESCRIPTION

# TARC (LA2) - 90% ESTIMATE

6/25/2015

## Rockford Lane & Graston Avenue

Bid Item	QTY	Unit	Unit Price	Cost	Comments
Sidewalk (5")	40	SY	\$50	\$2,000	
Detectable Paver	14	SF	\$35	\$490	
Std. Curb and Gutter	114	LF	\$20	\$2,280	
Remove Ex. Asphalt Pavement	85	SY	\$20	\$1,700	
Sod	33	SY	\$8	\$264	
Silt Fence	125	LF	\$5	\$625	
Stand. Concrete Pass Boarding Pad	4	SY	\$85	\$340	
MOT	1	LS	\$8,000	\$8,000	Would Require a Lane Closure
Mob & Demob	1	LS	\$471	\$471	
<b>Sub Total</b>				<b>\$16,170</b>	
<b>10% Contingency</b>				<b>1,617</b>	
<b>Total</b>				<b>\$17,787</b>	

## District 1 - Bus Stop Improvement Rockford @ Graston

<u>BUS STOPS</u>	<u>DESCRIPTIONS</u>	<u>LENGTH</u>	<u>Width/Depth</u>	<u>UNIT PRICE</u>	<u>COST</u>
<u>Stop #1</u>	<u>2300 Rockford Ave. (Ms. Leora Harris / 447-4335)</u>				
	Bench Pad	12	3	85	\$ 340.00
	Sidewalk Extension	80	5	50	\$ 2,222.22
	Steel Bench	1		2400	\$ 2,400.00
	Detectable Pavers	14		35	\$ 490.00
	Std. Curb and Gutter	114		35	\$ 3,990.00
	Remove ex. Asphalt Pavement	85		20	\$ 1,700.00
	Seed and protection	33		4	\$ 132.00
	Maintenance of Traffic (arrow board)	5		60	\$ 300.00
	Easement Acquisition	1		725	\$ -
	Engineering and Surveying	1		5600	\$ 5,600.00
				Subtotal=	\$ 17,174.22
	Contingencies				\$ 4,293.56
	Total =				\$ 21,467.78
8/14/2015	TARC (80%)				\$ 17,174.22
MWA	District 1 (20%)				\$ 4,293.56







