

Location Map
No Scale

NOTES

1. This document does not constitute a boundary survey and is subject to the inaccuracies that a boundary survey may disclose, no corners were set.
2. This plat is subject to all legal easements, right of ways, defects, liens, adverse claims, encumbrances, covenants and restrictions, which a title search may reveal, whether shown on this plat or not.
3. The linear and angular values shown are based on plat of Blue Grass Addition P.B. 1, P.145 as recorded in the office of the clerk of Jefferson County, KY.
4. Information shown on this site plan shall not be used to establish the future placement of any fence, structures & other improvements.

Total Lot area = 6,269 Sq. Ft.
Req. Private Yard Area (30% x 6,269) = 1880.7 Sq. Ft.
Proposed Private Yard Area 633.6 Sq. Ft. = 10%
Private Yard Variance Required 1,247 Sq. Ft = 20%

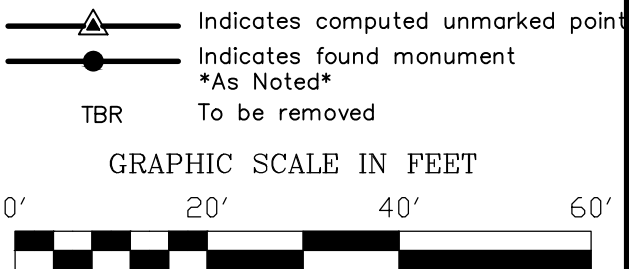

SITE PLAN FOR GARAGE
Owner: Andrew & Whitney Meredith
Address: 156 Pennsylvania Ave., Louisville, KY 40206
D.B. 10817, Pg. 428 Parcel ID 072H00990000
R-5 Zoning TN Form District
This is not a boundary survey and is not intended for land transfer.

NO STAMP REQUIRED

CARDINAL SURVEYING
9009 PRESTON HWY.
LOUISVILLE, KY 40219
Phone (502) 966-3446
www.cardinalsurveyingservices.com

DRN BY:SMS/RSM
SCALE: 1"= 20'
DATE: 04/21/2016
REV: 05/11/2016
REV: 05/23/2022
FIELD SURVEY
DATE: 11/02/2016
BY: CC