

TYPICAL PARKING DETAIL  
NO SCALE

NOTES

- Division of Water Permit will be required prior to construction approval.
- An MSD Floodplain Permit will be required at construction approval.
- No River Road frontage area is subject to conservation easements.
- Perimeter fence constructed of steel rail car sides. Height is from 6' to 8'.
- Right-of-way dedication by deed or minor plat must be recorded prior to construction approval by Public Works.
- **River Road frontage areas not within a conservation easement will be required to be dedicated to right-of-way to accommodate the Metro Works River Road Improvement project. Owner shall dedicate these areas to public use.**

*MOD CUP APPROVED BY LOUISVILLE METRO BOARD OF ZONING ADJUSTMENT*  
DATE: 9-8-11 BY: *[Signature]*

PRELIMINARY APPROVAL  
Condition of Approval:  
*[Signature]* 9/20/11  
Development Review Date  
LOUISVILLE & JEFFERSON COUNTY METROPOLITAN SEWER DISTRICT

American Commercial Marine Service Company  
D.B. 5723, Pg. 939  
Zone W3 / Form Dist SW

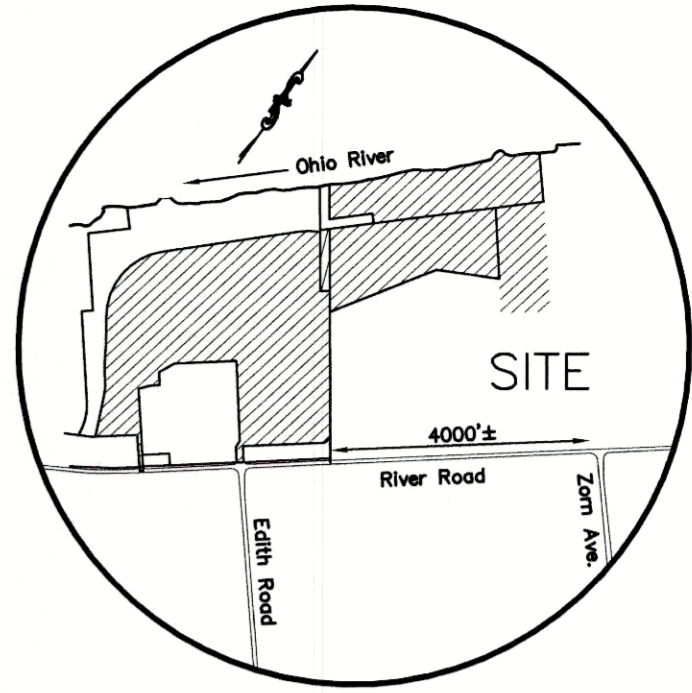

LOCATION MAP  
No Scale

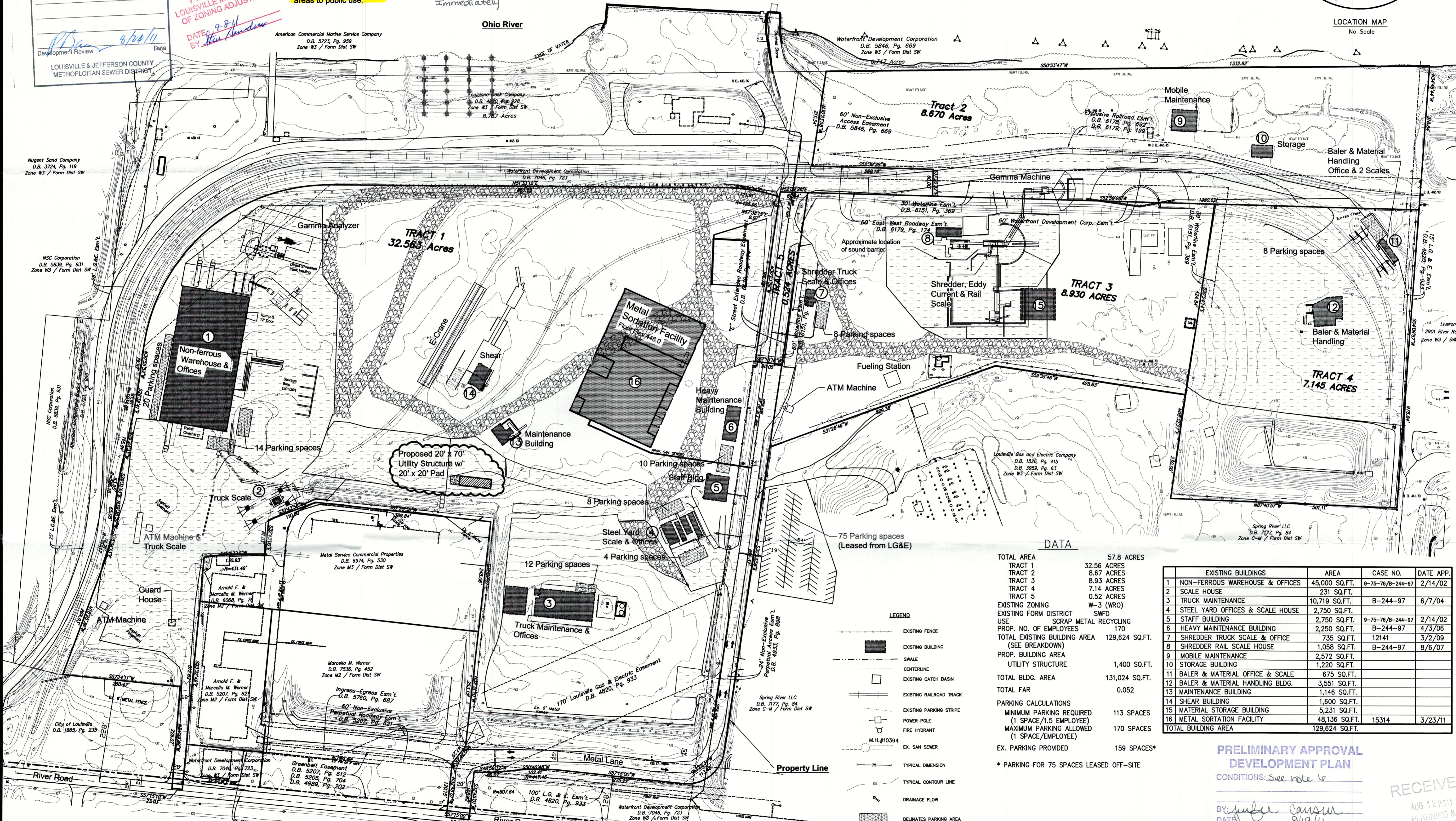

**DATA**

TOTAL AREA	57.8 ACRES
TRACT 1	32.56 ACRES
TRACT 2	8.67 ACRES
TRACT 3	8.93 ACRES
TRACT 4	7.14 ACRES
TRACT 5	0.52 ACRES
EXISTING ZONING	W-3 (WRO)
EXISTING FORM DISTRICT USE	SWFD SCRAP METAL RECYCLING
PROP. NO. OF EMPLOYEES	170
TOTAL EXISTING BUILDING AREA (SEE BREAKDOWN)	129,624 SQ.FT.
PROP. BUILDING AREA UTILITY STRUCTURE	1,400 SQ.FT.
TOTAL BLDG. AREA	131,024 SQ.FT.
TOTAL FAR	0.052
PARKING CALCULATIONS REQUIRED (1 SPACE / 1.5 EMPLOYEE)	113 SPACES
MAXIMUM PARKING ALLOWED (1 SPACE / EMPLOYEE)	170 SPACES
EX. PARKING PROVIDED	159 SPACES*
* PARKING FOR 75 SPACES LEASED OFF-SITE	

**LEGEND**

[Symbol]	EXISTING FENCE
[Symbol]	EXISTING BUILDING
[Symbol]	SWALE
[Symbol]	CENTELINE
[Symbol]	EXISTING CATCH BASIN
[Symbol]	EXISTING RAILROAD TRACK
[Symbol]	EXISTING PARKING STRIPE
[Symbol]	POWER POLE
[Symbol]	FIRE HYDRANT
[Symbol]	EX. SAN SEWER
[Symbol]	TYPICAL DIMENSION
[Symbol]	TYPICAL CONTOUR LINE
[Symbol]	DRAINAGE FLOW
[Symbol]	DELINATES PARKING AREA
[Symbol]	DELINATES PAVED AREA
[Symbol]	DELINATES GRAVEL AREA

EXISTING BUILDINGS	AREA	CASE NO.	DATE APP.
1 NON-FERROUS WAREHOUSE & OFFICES	45,000 SQ.FT.	9-75-76/B-244-97	2/14/02
2 SCALE HOUSE	231 SQ.FT.		
3 TRUCK MAINTENANCE	10,719 SQ.FT.	B-244-97	6/7/04
4 STEEL YARD OFFICES & SCALE HOUSE	2,750 SQ.FT.		
5 STAFF BUILDING	2,750 SQ.FT.	9-75-76/B-244-97	2/14/02
6 HEAVY MAINTENANCE BUILDING	2,250 SQ.FT.	B-244-97	4/3/06
7 SHREDDER TRUCK SCALE & OFFICE	735 SQ.FT.	12141	3/2/09
8 SHREDDER RAIL SCALE HOUSE	1,058 SQ.FT.	B-244-97	8/6/07
9 MOBILE MAINTENANCE	2,572 SQ.FT.		
10 STORAGE BUILDING	1,220 SQ.FT.		
11 BALER & MATERIAL OFFICE & SCALE	675 SQ.FT.		
12 BALER & MATERIAL HANDLING BLDG.	3,551 SQ.FT.		
13 MAINTENANCE BUILDING	1,146 SQ.FT.		
14 SHEAR BUILDING	1,600 SQ.FT.		
15 MATERIAL STORAGE BUILDING	5,231 SQ.FT.		
16 METAL SORTATION FACILITY	48,136 SQ.FT.	15314	3/23/11
TOTAL BUILDING AREA	129,624 SQ.FT.		

PRELIMINARY APPROVAL DEVELOPMENT PLAN  
CONDITIONS: See note 6

BY: *[Signature]*  
DATE: 8/19/11  
LOUISVILLE/JEFFERSON COUNTY METRO PUBLIC WORKS

RECEIVED  
AUG 12 2011  
PLANNING & DESIGN SERVICES

CASE NO. 15314  
Docket No. B-244-97  
MSD WM #5716

River Metals Recycling  
2114 Metal Lane  
Louisville, KY 40206

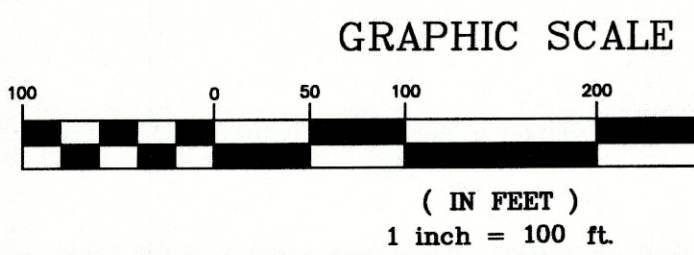

REVISIONS

CHK	DATE	DESCRIPTION
PCB	7/17/2011	ADDITION OF UTILITY STRUCTURE
PCB	9/2/2011	ADD NOTE PER AGENCY COMMENTS

DATE: \_\_\_\_\_  
SIGNATURE: \_\_\_\_\_  
DATE: \_\_\_\_\_  
SIGNATURE: \_\_\_\_\_

BTM PROJECT NO.: 010295  
SITE INFORMATION:  
OWNER: RIVER METALS RECYCLING LLC  
2114 METAL LANE  
LOUISVILLE, KENTUCKY 40206  
DEVELOPER: RIVER METALS RECYCLING LLC  
2114 METAL LANE  
LOUISVILLE, KENTUCKY 40206  
TITLE: REVISED CONDITIONAL USE PERMIT PLAN  
RIVER METALS RECYCLING LLC  
2114 METAL LANE, LOUISVILLE, KY  
DRAWN BY: DHS  
CHECKED BY: PCB  
DATE: FEBRUARY 2011  
DRAWING: 010295-RCUP-2011  
SCALE: 1" = 100'  
SHEET

B-16174-11 #385 15314