

15 DEV PLAN 1029

7/24/2015 1:39:21 PM

SHEET
A201

JOSEPH & JOSEPH
ARCHITECTS SINCE 1904
LOUISVILLE, KY 40202
P: 502.583.8444
F: 502.583.8444
www.josephandjoseph.com

EAST ELEVATIONS
AREA "A"

ANGEL'S ENVY DISTILLERY
101 S JACKSON ST
PAPILLON PROPERTY
GROUP LLC

DATE	6/25/15
BY	RM
CHK	CM
DESIGN	E.W.
PROJECT	A6531
COMP	

REVISIONS

RECEIVED
JUL 27 2015
PLANNING &
DESIGN SERVICES

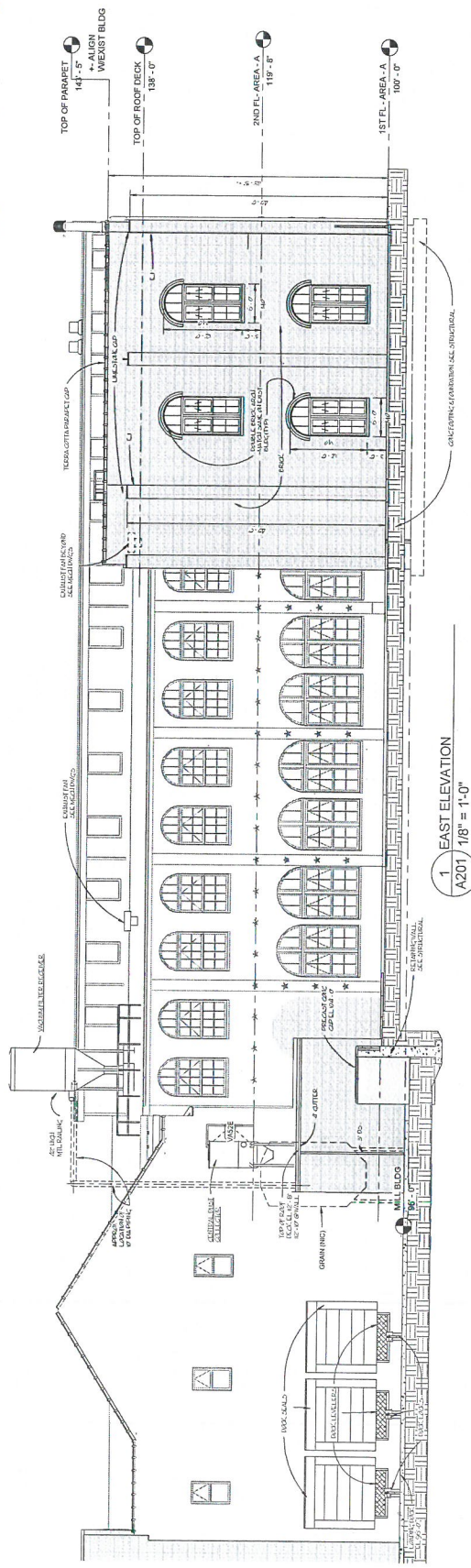

1 EAST ELEVATION
A201 1/8" = 1'-0"

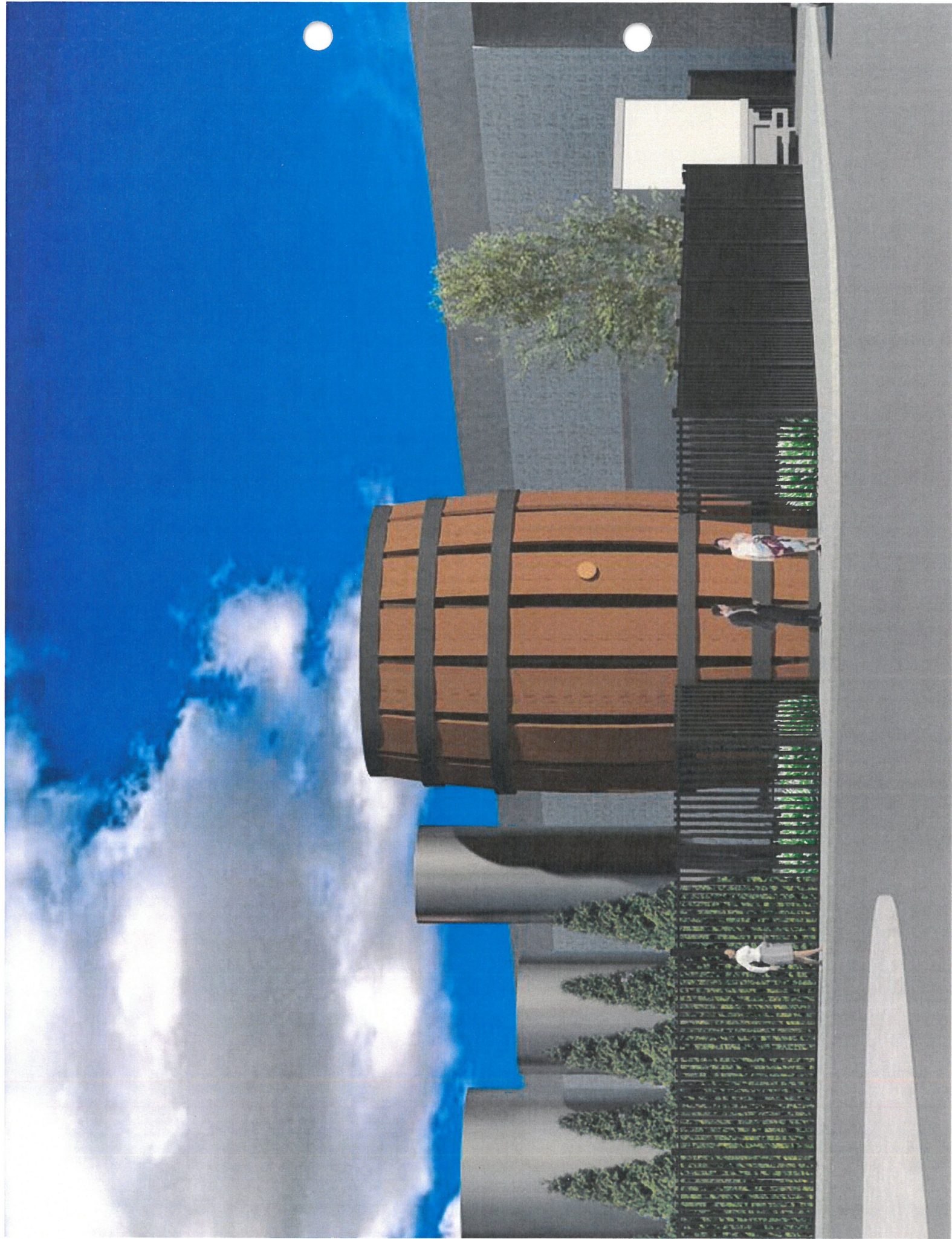

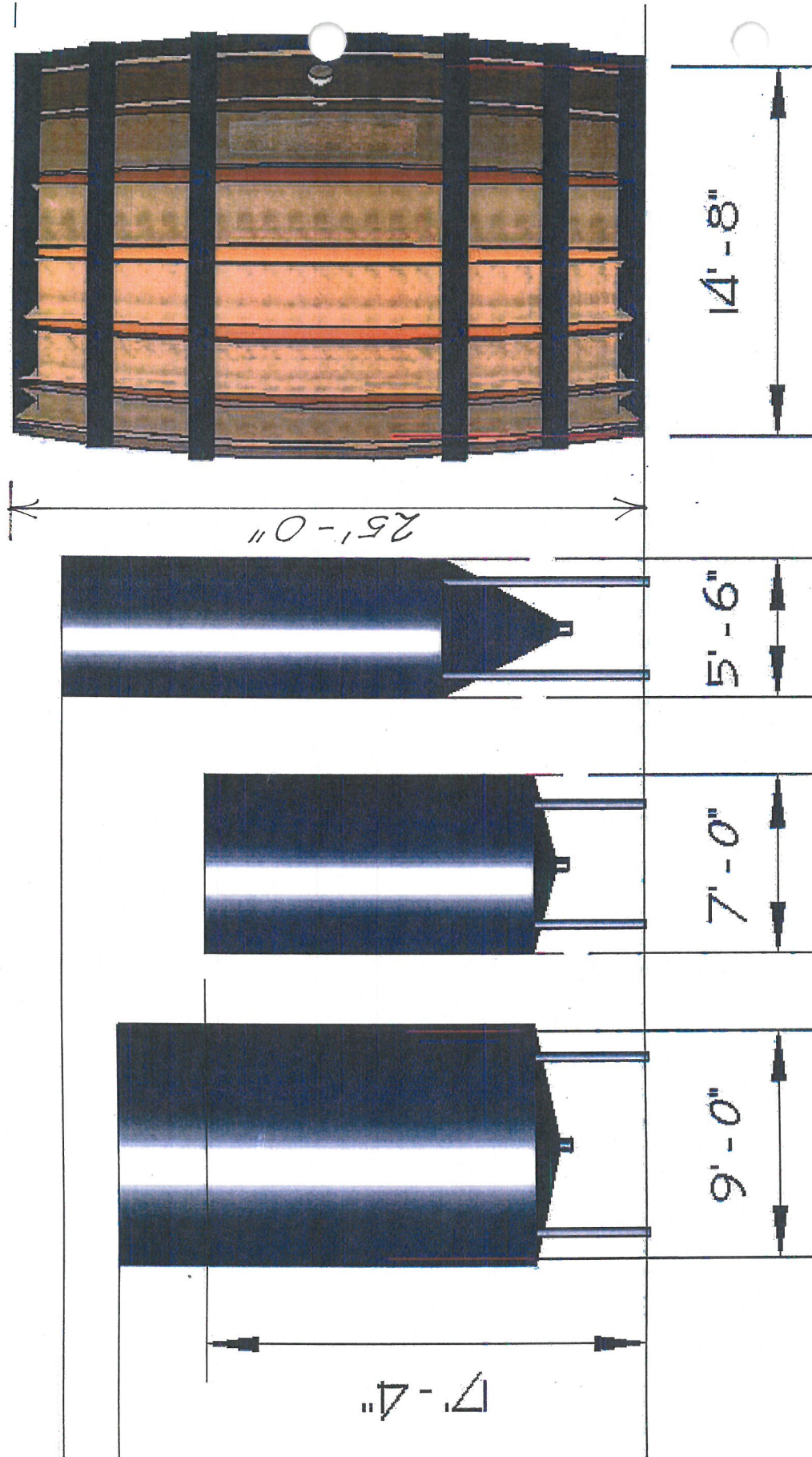

RECEIVED

.III 27 2015

PLANNING &
DESIGN SERVICES

15DEVPLAN1029

LS121LED Cassia

Wallmount



The LS121LED is a compact, fixed position, direct/indirect accent used for grazing walls or other accent illumination tasks. The luminaire is constructed from either copper or powder coated aluminum, providing a variety of aesthetic options. This luminaire is ideal for use in modern architectural designs, and now features new Lumascape d5 driver technology for advanced dimming and control options.

Specifications

Lamp Source	2 x 6 W LED <input type="checkbox"/> White (4 300 K typical) <input type="checkbox"/> Warm white (3 000 K typical) <input type="checkbox"/> Blue (470 nm)
Approved Use	Suitable for wet locations
Control Options	0-10 V (current sourcing) PWM On-site or factory-programmable brightness
IP Rating	IP65
Construction	Powder coated aluminum <input type="checkbox"/> Black <input type="checkbox"/> Silver Polished copper
Installation Type	Wall mount
Remote Transformers / Power Supplies	Refer to Technical Data section for application specific options Order separately
Ambient Operating Temperature	-4 °F to 104 (-20 °C to 40 °C)
Photometrics	Refer to www.lumascape.com

Any luminaire can become hot - take care with appropriate use and placement



LS121LED Cassia

RECEIVED
JUL 27 2015
PLANNING &
DESIGN SERVICES

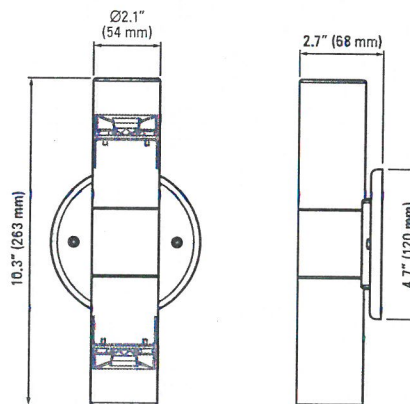

LAMP				OPTICAL SYSTEM		INPUT VOLTAGE		FINISH		
Description	Wattage	Color	Code	Beam	Code	Description	Code	Description	Material	Code
LED	2 x 6 W	White (4 300 K typical)	12W4	Narrow	14°	0-10 V or PWM Dimmable Driver, 12-15 V, 60 Hz or 12-24 V DC (1) Requires appropriate transformer.	13-DIM ⁽¹⁾	Black, powder coated	Aluminum	CB
		Warm white (3 000 K typical)	12H6	Narrow Medium	25°			Silver, powder coated	Aluminum	CS
		Blue (470 nm)	12B4	Medium	30°			Polished	Copper	CU
				Wide	40°					

Dimmable Wiring Diagram Reference

Input Voltage	LED Color	Control Type	Wiring Diagram
13-DIM	Single Color	PWM	2,3,4

Photometrics

Photometric data is based on test results from a NIST traceable testing lab. IES data is available at www.lumascap.com.

Note: No depreciation factor is applied to the data shown.

Polar Candela Distribution

LS121LED
4 300 K
14° Beam Angle

Power Input	7.1
Lumens	403
Efficacy	57 lm/W

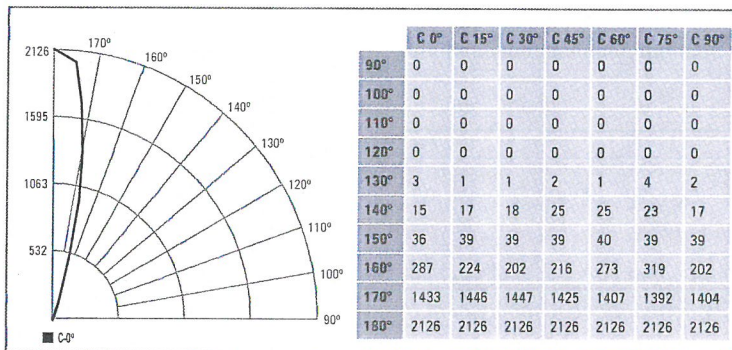

Illuminance at a Distance

ft	Center Beam fc	Beam Ø
5	85	2 ft
10	21.3	4 ft
15	9.4	7 ft
25	3.4	11 ft
30	2.4	13 ft
40	1.3	18 ft
50	0.9	22 ft

Polar Candela Distribution

LS121LED
4 300 K
30° Beam Angle

Power Input	6.9
Lumens	365
Efficacy	53 lm/W

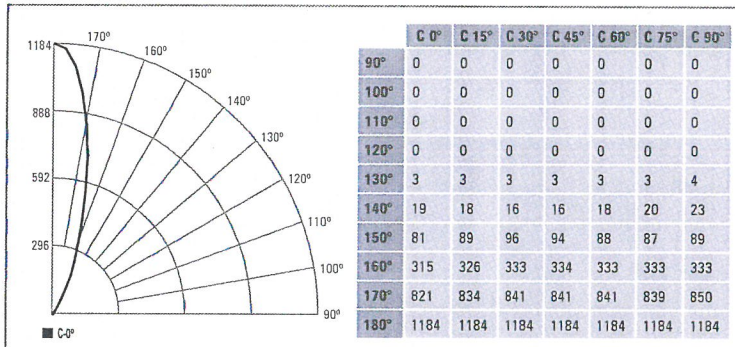

Illuminance at a Distance

ft	Center Beam fc	Beam Ø
5	47.4	3 ft
10	11.8	5 ft
15	5.3	8 ft
25	1.9	13 ft
30	1.3	16 ft
40	0.7	21 ft
50	0.5	27 ft

Polar Candela Distribution

LS121LED
4 300 K
40° Beam Angle

Power Input	7.5
Lumens	359
Efficacy	48 lm/W

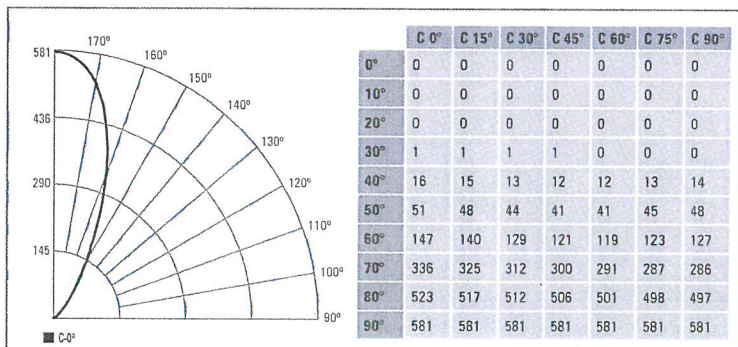

Illuminance at a Distance

ft	Center Beam fc	Beam Ø
5	23.2	4 ft
10	5.8	7 ft
15	2.6	11 ft
25	0.9	18 ft
30	0.6	22 ft
40	0.4	29 ft
50	0.2	36 ft

RECEIVED
JUL 27 2015
PLANNING &
DESIGN SERVICES



FEATURES & SPECIFICATIONS

INTENDED USE – Ideal for parking areas, street lighting, walkways and car lots.

CONSTRUCTION – Rugged, die-cast, soft corner aluminum housing with 0.12" nominal wall thickness. Die-cast door frame has impact-resistant, tempered, glass lens that is fully gasketed with one-piece tubular silicone.

Finish: Standard finish is dark bronze (DDB) polyester powder finish, with other architectural colors available.

OPTICS – Anodized, aluminum reflectors: IES full cutoff distributions R2 (asymmetric), R3 (asymmetric), R4 (forward throw) and RSS (square) are interchangeable. High-performance anodized, segmented aluminum reflectors IES full cutoff distributions SR2 (asymmetric), SR3 (asymmetric) and SR4SC (forward throw, sharp cutoff). High-performance reflectors attach with tool-less fasteners and are rotatable and interchangeable.

ELECTRICAL – Ballast: High pressure sodium: 70-150W is high reactance, high power factor. Constant wattage autotransformer for 200-400W. Metal halide: 70-150W is high reactance, high power factor and is standard with pulse-start ignitor technology. "SCWA" not required. Constant wattage autotransformer for 175-400W. Super CWA (pulse start ballast), 88% efficient and EISA legislation compliant, is required for metal halide 151-400W (SCWA option) for US shipments only. CSA, NOM or INTL required for probe start shipments outside of the US. Pulse-start ballast (SCWA) required for 200W, 320W, or 350W. Ballast is 100% factory-tested.

Socket: Porcelain, horizontally oriented medium base socket for 70-150M. Mogul base socket for 175M and above, and 70-400S, with copper alloy, nickel-plated screw shell and center contact. UL listed 1500W, 600V.

LISTINGS – UL Listed (standard). CSA Certified (see Options). UL listed for 25°C ambient and wet locations. IP65 rated in accordance with standard IEC 529.

WARRANTY – 1-year limited warranty. Complete warranty terms located at

www.acuitybrands.com/CustomerResources/Terms_and_conditions.aspx

Note: Specifications subject to change without notice.



Catalog Number	RECEIVED
Notes	III 27 2015 PLANNING & DESIGN SERVICES
Type	



Specifications

EPA: 1.2 ft.³

*Weight: 35.9 lbs (16.28 kg)

Length: 17-1/2" (44.5)

Width: 17-1/2" (44.5)

Depth: 7-1/8" (18.1)

All dimensions are inches (centimeters) unless otherwise specified.

*Weight as configured in example below.

CONTOUR
SERIES

Soft Square Lighting

KAD

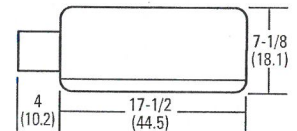

METAL HALIDE: 70-400W
HIGH PRESSURE SODIUM: 70-400W
20' TO 35' MOUNTING



ORDERING INFORMATION

For shortest lead times, configure product using **bolded options**.

Example: KAD 400M R3 TB SCWA SPD04 LPI

KAD									
Series	Wattage			Distribution		Voltage	Ballast	Mounting ¹²	
KAD	Metal halide	High pressure sodium ¹	Ceramic metal halide	Standard reflectors	High performance reflectors ⁸	120	(blank) Magnetic ballast	Ships in fixture carton	
	70M ^{1,2}	250M ³		R2 IES type II asymmetric ⁷	SR2 IES type II asymmetric ⁷	208 ⁹		SPD__ Square pole	Arm length
	100M ¹	320M ⁴	70S			240 ⁹	CWI	RPD__ Round pole	04 4" arm
	150M	350M ^{3,4}	70MHC ^{1,2}	R3 IES type III asymmetric ⁷	SR3 IES type III asymmetric ⁷	277	Contant wattage isolated ¹¹	WBD__ Wall bracket	06 6" arm
	175M ³	400M ^{5,6}	100S	R4 IES type IV forward throw ⁷	SR4SC IES type IV forward throw	347	 	WWD__ Wood or pole wall	09 9" arm
	200M ⁴		150S	RSS IES type V square		480 ⁹	 Super CWA pulse-start ballast	Ships separately ^{13,14}	12 12" arm
		250S				TB ¹⁰		DAD12P Degree arm (pole)	
		400S				23050HZ ¹¹		DAD12WB Degree arm (wall)	
							NOTE: For shipments to U.S. territories, SCWA must be specified to comply with EISA.	WBA Decorative wall bracket ¹⁵	
								KMA Mast arm external fitter	
							KTMB Twin mounting bar		

Options	Finish ²⁰	Lamp ²¹
Shipped installed in fixture	(blank) Dark bronze	DNAXD Natural aluminum
SF Single fuse (120, 277, 347V) ¹⁶	DWH White	DWHXD White
DF Double fuse (208, 240, 480V) ¹⁶	DBL Black	DBTXD Textured dark bronze
PD Power tray ¹⁷	DDB Medium bronze	DBLXD Textured black
PER NEMA twist-lock receptacle only (no photocontrol)	DNA Natural aluminum	DNATXD Textured natural aluminum
QRS Quartz restrike system ¹⁸	Super Durable Finishes	DWHGXD Textured white
QRSTD QRS time delay ¹⁸	DBBXD Dark bronze	
WTB Terminal wiring block ¹⁷	DBLXD Black	

Accessories: Tenon Mounting Slipfitter (RPxx required.) Order as separate catalog number. Must be used with pole mounting.							
Number of fixtures							
Tenon O.D.	One	Two@180°	Two@90°	Three@120°	Three@90°	Four@90°	
2-3/8"	T20-190	T20-280	T20-290 ²²	T20-320 ²²	T20-390 ²²	T20-490 ²²	
2-7/8"	T25-190	T25-280	T25-290 ²²	T25-320	T25-390 ²²	T25-490 ²²	
4	T35-190	T35-280	T35-290 ²²	T35-320	T35-390 ²²	T35-490 ²²	

Notes

1 Not available with SCWA.

2 Not available with 480V.

3 These wattages do not comply with California Title 20 regulations.

4 Must be ordered with SCWA.

5 These wattages require the REGC1 option to be chosen for shipments into California for Title 20 compliance. 250M REGC1 is not available in 347 or 480V.

6 Reduced jacket ED28 required for SR2, SR3 and SR4SC optics.

7 House-side shield available.

8 High performance reflectors not available with QRSTD.

9 Must specify CWI for use in Canada.

10 Optional multi-tap ballast (120, 208, 240, 277V; in Canada: 120, 277, 347V).

11 Consult factory for available wattages.

12 9" arm is required when two or more luminaires are oriented on a 90° drilling pattern.

13 May be ordered as an accessory.

14 Must specify finish when ordered as an accessory.

15 Available with SPD04 and SPD09.

16 Must specify voltage. N/A with TB.

17 Only available with SR2, SR3 and SR4SC optics.

18 Max allowable wattage lamp included.

19 Prefix with KAD when ordered as an accessory.

20 See www.lithonia.com/archcolors for additional color options.

21 Must be specified. L/P not available with MHC.

22 Must use RPD09.

KAD Metal Halide, Arm-mounted Soft Square Cutoff

Coefficient of Utilization
Initial Footcandles

KAD 400M R2 Test no. 1193083101P
ISOILLUMINANCE PLOT (Footcandle)

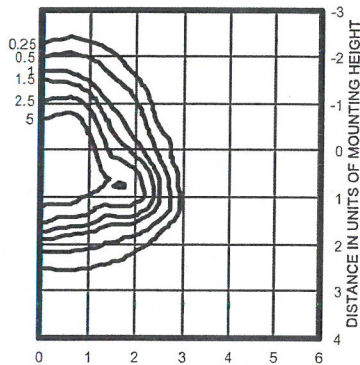

400W pulse start metal halide lamp, rated 38,000 lumens. Footcandle values based on 20' mounting height.
Classification: Type II, Short, Full Cutoff

KAD 400M R3 Test no. 1192040902P
ISOILLUMINANCE PLOT (Footcandle)

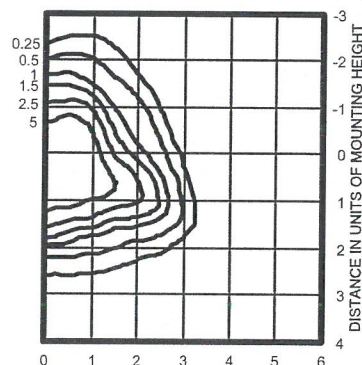

400W pulse start metal halide lamp, rated 38,000 lumens. Footcandle values based on 20' mounting height.
Classification: Type II, Short, Full Cutoff

RECEIVED

MAR 27 2015
PLANNING &
DESIGN SERVICES

KAD 400M R4 Test no. 1191110101P
ISOILLUMINANCE PLOT (Footcandle)

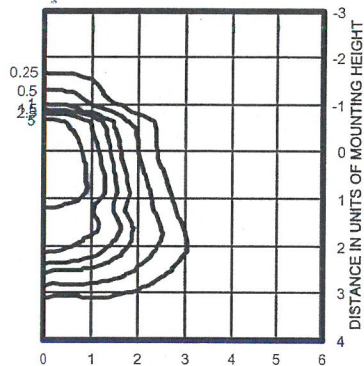

400W pulse start metal halide lamp, rated 38,000 lumens. Footcandle values based on 20' mounting height.
Classification: Unclassified (Type III, Very Short), Full Cutoff

KAD 400M R4HS Test no. 1192061101P
ISOILLUMINANCE PLOT (Footcandle)

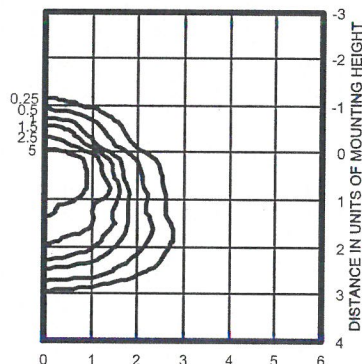

400W pulse start metal halide lamp, rated 38,000 lumens. Footcandle values based on 20' mounting height.
Classification: Unclassified (Type III, Very Short), Full

KAD 400M R5S Test no. 1194040801P
ISOILLUMINANCE PLOT (Footcandle)

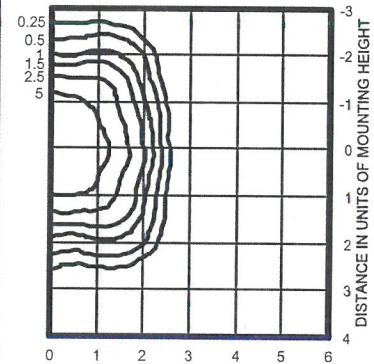

400W pulse start metal halide lamp, rated 38,000 lumens. Footcandle values based on 20' mounting height.
Classification: Unclassified (Type NC, Very Short), Full Cutoff

Notes

- 1 Photometric data for other distributions can be accessed at www.lithonia.com.
- 2 Tested to current IES and NEMA standards under stabilized laboratory conditions. Various operating factors can cause differences between laboratory data and actual field measurements. Dimensions and specifications on this sheet are based on the most current available data and are subject to change without notice.
- 3 For electrical characteristics, consult outdoor technical data specification sheets on www.lithonia.com.

Mounting Height Correction Factor

(Multiply the fc level by the correction factor)

25 ft. = 0.64

35 ft. = 0.32

40 ft. = 0.25

$$\left(\frac{\text{Existing Mounting Height}}{\text{New Mounting Height}} \right)^2 = \text{Correction Factor}$$



An Acuity Brands Company

KAD-M-S

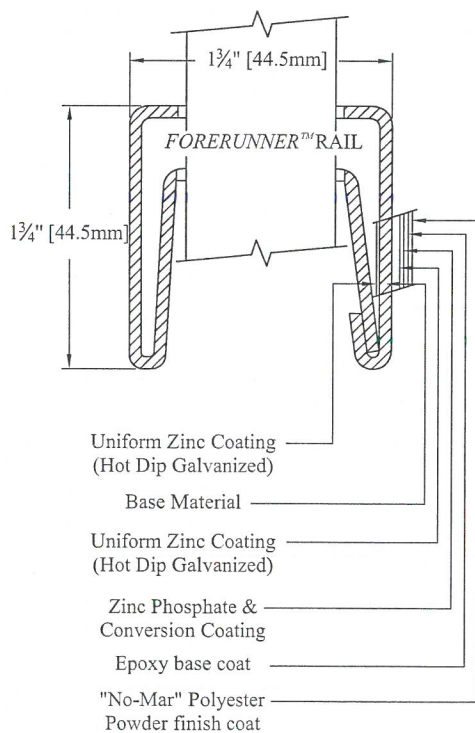
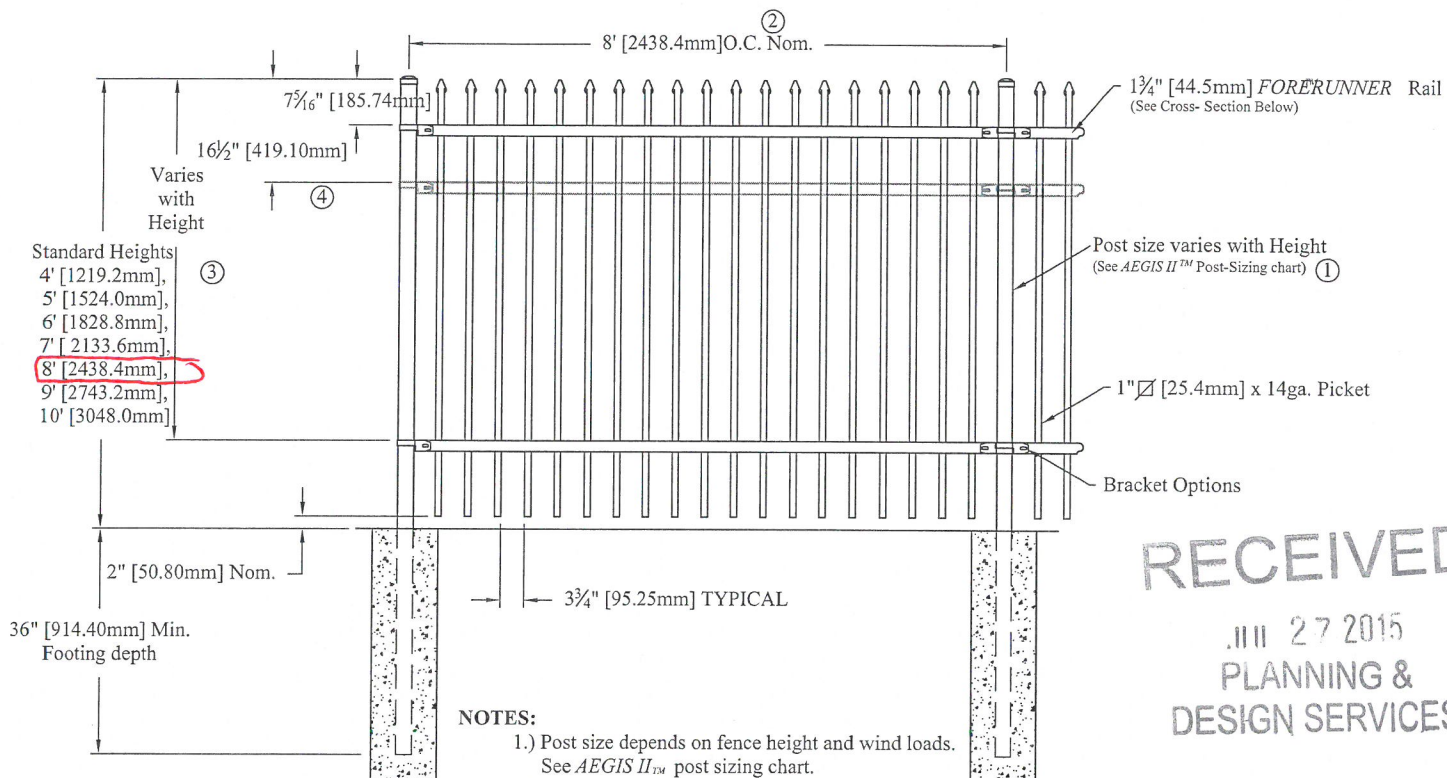

INTERNAL RETAINING ROD
 Variable pitch connection system for ease of installation, high angle bias ability and elimination of unsightly external fasteners.

PANEL BRACKET
 Specially designed two-point connection ensures fixity of rail ends for increased strength.

FORERUNNER™ RAIL
 Double-walled "U"-Channel
 Specially formed high strength architectural shape.

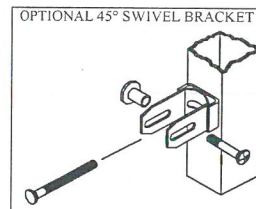

Values shown are nominal and not to be used for installation purposes. See product specification for installation requirements.

INDUSTRIAL STRENGTH STEEL

Title: **AEGIS II CLASSIC 2/3-RAIL**

DR: KMc	SH. 1 of 1	SCALE: DO NOT SCALE
CK:	Date 04/14/2015	REV: d



AMERISTAR®

1555 N. Mingo
 Tulsa, OK 74116
 1-888-333-3422
 www.ameristarfence.com

2CISO

15DEVPLAN1029