



Landmarks Certificate of Appropriateness & Overlay District Permit

Louisville Metro Planning & Design Services

Case No.: 16 COA 1104 Intake Staff: A

Date: 5/11/16 Fee: 01A

Instructions:

For detailed definitions of *Certificate of Appropriateness* and *Overlay District Permit*, please see page 4 of this application. Applications for *Signage* are no longer submitted to Planning & Design Services. Applications for Signage are to be made directly to the Construction Review Division.

Project Information:

Certificate of Appropriateness: ☐ Butchertown ☒ Clifton ☐ Cherokee Triangle ☐ Individual Landmark
☐ Limerick ☒ Old Louisville ☐ Parkland Business ☐ West Main Street

Overlay Permit: ☐ Bardstown/Baxter Ave Overlay (BRO) ☐ Downtown Development Review Overlay (DDRO)
☐ Nulu Review Overlay District (NROD)

Project Name: _____

Project Address / Parcel ID: 1452 S. 6th St. Louisville Ky 40208

Deed Book(s) / Page Numbers²: 10311-0892

Total Acres: _____

Project Cost: \$5000.00 PVA Assessed Value: \$253,560.00

Existing Square Feet: _____ New Construction Square Feet: _____ Height (ft.): _____ Stories: _____

Project Description (use additional sheets if needed):

REPLACE WINDOWS WITH VINYL WINDOWS

RECEIVED
MAY 11 2016
PLANNING &
DESIGN SERVICES

Contact Information:

Owner: ☐ Check if primary contact

Applicant: ☒ Check if primary contact

Name: Edward Reiss ~~Patrick Payne~~ Name: Edward Reiss

Company: _____ Company: _____

Address: 201 CORALBERRY RD Address: 3408 STONYBROOK DR.

City: LOUISVILLE State: KY Zip: 40207 City: LOUISVILLE State: KY Zip: 40299

Primary Phone: 502-899-9246 Primary Phone: 502-640-1254

Alternate Phone: 502-583-5556 Alternate Phone: _____

Email: _____ Email: EDWARDR121453@AOL.COM

Owner Signature (required): Patrick Payne

Attorney: ☐ Check if primary contact

Plan prepared by: ☐ Check if primary contact

Name: _____

Name: _____

Company: _____

Company: _____

Address: _____

Address: _____

City: _____ State: _____ Zip: _____

City: _____ State: _____ Zip: _____

Primary Phone: _____

Primary Phone: _____

Alternate Phone: _____

Alternate Phone: _____

Email: _____

Email: _____

Certification Statement: A certification statement must be submitted with any application in which the owner(s) of the subject property is (are) a limited liability company, corporation, partnership, association, trustee, etc., or if someone other than the owner(s) of record sign(s) the application.

I, Edward Reiss, in my capacity as POA, hereby
representative/authorized agent/other

certify that PATRICK M PAYNE LR is (are) the owner(s) of the property which
name of LLC / corporation / partnership / association / etc.

is the subject of this application and that I am authorized to sign this application on behalf of the owner(s).

Signature: Edward Reiss Date: 4-26-16

I understand that knowingly providing false information on this application may result in any action taken hereon being declared null and void. I further understand that pursuant to KRS 523.010, et seq. knowingly making a material false statement, or otherwise providing false information with the intent to mislead a public servant in the performance of his/her duty is punishable as a Class B misdemeanor.

Please submit the completed application along with the following items:

Project information

- ☐ Land Development Report¹
- ☐ Current photographs showing building front, specific project area, and surrounding buildings
- ☐ Pictures, samples, brochures, or other technical data describing materials, such as windows, doors, roofing, fencing, etc. to be used in the renovation or replacement
- ☐ One map of the project area and surrounding properties (may be obtained from <http://www.lojic.org/> using the *LOJIC Online Map*)

Site plan (see site plan example on next page)

- ☐ Two sets of site plans *drawn to scale* with dimensions, as applies to the project, indicating property lines, structures, landscaping, fencing, and parking
- ☐ Two copies of floor plans *drawn to scale* with dimensions and each room labeled
- ☐ Two copies of elevation drawings (a drawing showing exterior walls) *drawn to scale* with dimensions. For fencing, only photos/drawings of the proposed fence are required.

Committee Review Only

Committee reviews may be required due to the complexity of the case. The necessity of these items will be determined by staff upon review. Projects requiring committee level review include construction of new buildings, demolition, and projects that vary widely from design guidelines.

- ☐ Two sets of 11"x17" format site plans drawn to scale with dimensions
- ☐ Two sets of 11"x17" elevation drawings to scale with dimensions
- ☐ Two sets of 11"x17" landscaping drawings to scale with dimensions
- ☐ One set of mailing label sheets for: 1st tier Adjoining Property Owners (APOs)³, owners, applicants, contacts, and Case Manager. Applicant is responsible for mailing.
- ☐ One copy of the mailing label sheets

RECEIVED
MAY 11 2016
PLANNING &
DESIGN SERVICES

Resources:

1. Detailed instructions to obtain a Land Development Report are available online at: <http://ags2.lojic.org/lojiconline/>
2. Deeds and plats can be found at the Jefferson County Clerk's Office, located at the 2nd floor of Metro Hall (527 West Jefferson Street, telephone: 502-574-6220). Many deeds, plats and other records are available online at: <http://www.landrecords.jcc.ky.gov/records/S0Search.html>
3. Adjoining property ownership information can be found at the Property Valuation Administrator (PVA) office at 531 Court Place, Suite 504 or via their website: <https://jeffersonpva.ky.gov/>
4. View agency comments at: <http://portal.louisvilleky.gov/codesandregs/mainsearch>. Enter your case number in the 'Permit/Case/Docket Number' search bar and then select your case under the 'Application Number' tab.

Submittal Instructions:

Applications are due on Fridays at 5:00 p.m. Once complete, please bring the application and supporting documentation to: Planning and Design Services, located at 444 South 5th Street, Suite 300. For more information, call (502) 574-6230 or visit <http://www.louisvilleky.gov/PlanningDesign>.

Definitions:

Certificate of Appropriateness: A project involving physical changes to the exterior of a building, structure, or property designated as a local landmark or located within a local preservation district shall require prior approval in the form of a Certificate of Appropriateness. An approval requires substantial conformance to design guidelines established for each landmark and district. The design guidelines, along with other information regarding local preservation districts, may be found at the website of the Landmarks and Preservation Districts Commission:

<http://www.louisvilleky.gov/PlanningDesign/Historic+Landmarks+and+Preservation+Districts+Commission.htm>

Overlay District Permit: A project involving physical changes to the exterior of a building, structure, or property within an overlay district shall require prior approval in the form of an Overlay Permit. An approval requires substantial conformance to design guidelines established for each overlay district. The design guidelines, along with other information regarding overlay districts, may be found at the following website:

<http://www.louisvilleky.gov/PlanningDesign/Overlay+Districts.htm>

Sample Site Plan

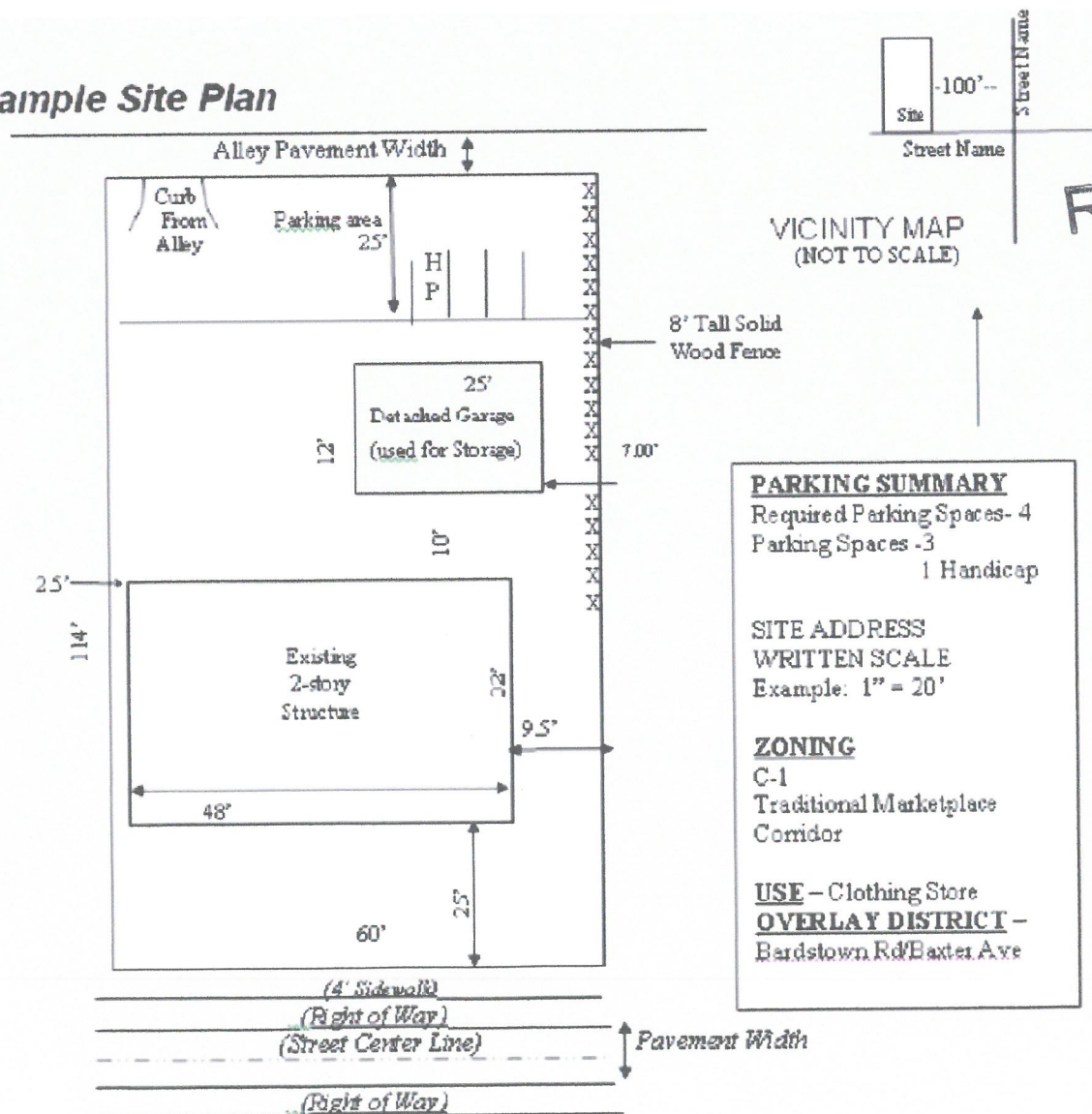

RECEIVED
MAY 11 2016
PLANNING &
DESIGN SERVICES



Rear



North side



North side



Front

RECEIVED
MAY 13 2016
PLANNING &
DESIGN SERVICES

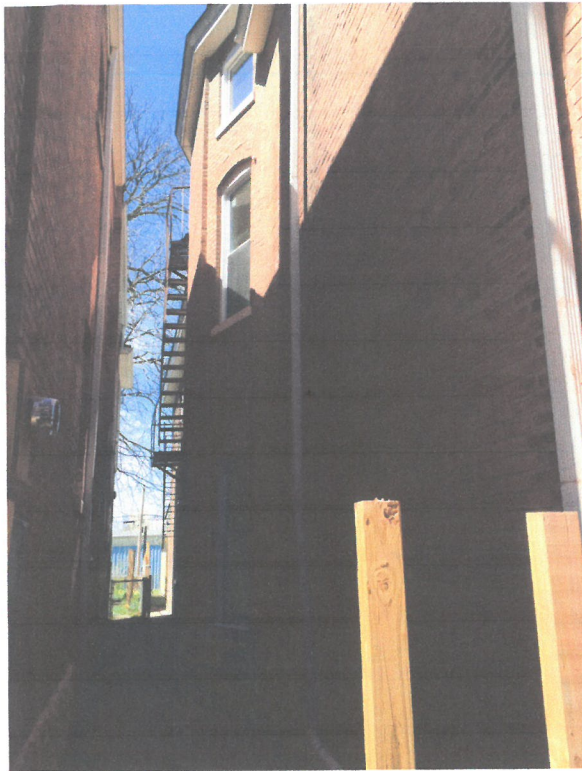

South side



South side

RECEIVED
MAY 10 2015
PLANNING &
DESIGN SERVICES