

Southeastern Architectural Metals  
256 766 2032  
<http://www.coblemetalworks.com>

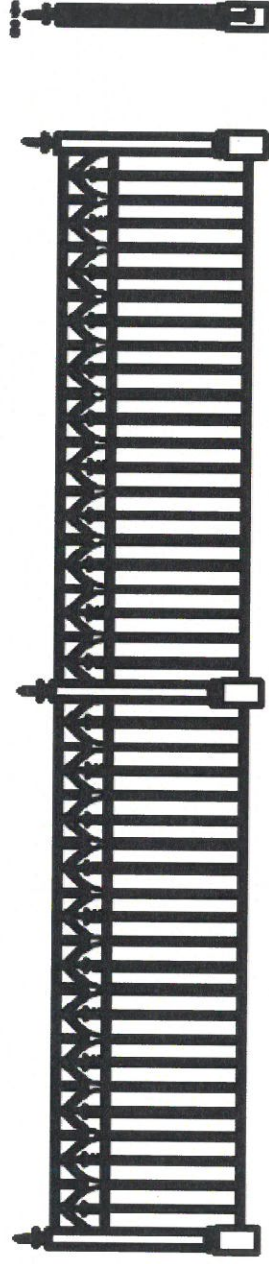

gothic railing drawn using aluminum castings and aluminum extrusions  
can be made from any difference with appearance would be thickness of channels reduced to 1/2"

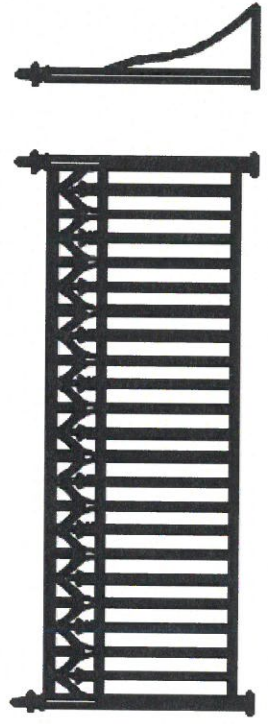

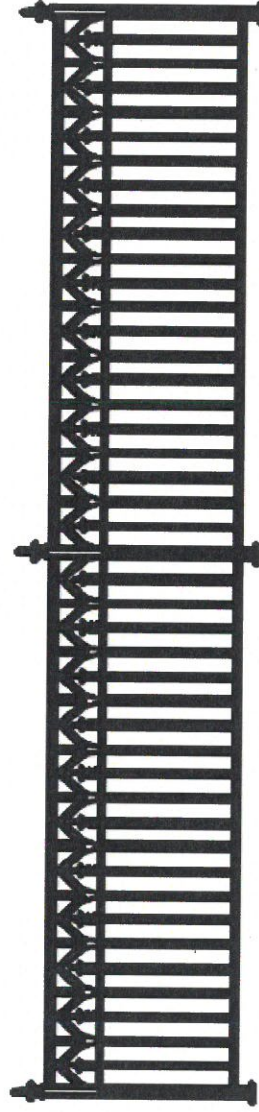

Metals Distribution, Finishing and Fabrication



[ABOUT US](#) [GALLERY](#) [DOWNLOADS](#) [FAQS](#) [LINKS](#) [STORE](#) [HOW TO SPECIFY](#) [CONTACT](#) [PRESS ROOM](#) [SITE MAP](#)

[ALUMINUM SHEET](#) [ALUMINUM EXTRUSIONS](#) [METAL FABRICATION](#) [COLUMN COVERS](#) [PANELS](#) [ANODIZING](#) [PAINTING](#) [ALUMINUM COIL](#) [SAF PERIMETER SYSTEMS](#)

## PERIMETER SYSTEMS

[SAF Perimeter Systems Quote Request](#)

[Cornice & Gutter Products](#)

[Designer Series Cornices](#)

[Arch & Radius Cornices](#)

[Commercial Gutter Systems & Downspouts](#)

[Pediments & Entablatures](#)

[Coping Systems](#)

[Gravel Stops & Fascia Systems](#)

[Fabricating for Architectural Applications](#)

[SAF Perimeter Systems News](#)

[Gallery](#)

[Contact Us](#)

[Download Center](#)

[Design Guide](#)

[Color Chart](#)

[FAQ](#)

[Optin](#)



## DESIGNER SERIES CORNICES

Since 1990, Perimeter Systems has provided Designer Series Cornices for churches, universities, financial institutions, municipalities, and stately homes throughout the United States. Whether new construction or a historic renovation, Perimeter Systems' innovative "interchangeable" cornice trims allow you to design beautifully sculptured cornices limited only by your imagination.

## PREDESIGNED CORNICES

We offer 15 predesigned cornices with all the details worked out for you. These cornices may be modified to suit your building's eave condition and have been detailed with traditional wood support framing as well as more contemporary steel framing.

## INTERCHANGEABLE CORNICE PROFILES

SAF Cornice Trims and Mouldings are available in various sizes of concave, convex, quarter round, half round, and box shapes. Many of these trims are designed to interchange with one another where you can mix and match to taste.

## DESIGN TO SIMULATE STONE CORNICES

In addition to our cornice trims being interchangeable they are designed to simulate stonework. This is achieved through the use of "expansion reveals" at the vertical cornice joints. This expansion reveal consists of a concealed splice "back-up" plate which allows a space between the adjoining cornice members. This small (3/8") space creates a light shadow line at the vertical cornice joints and when properly aligned simulates stonework.

## MORE DESIGNER SERIES CORNICE SYSTEM FEATURES

**Choose fabricated sheet aluminum profiles or heavy extruded aluminum profiles.**

- **Fabricated (Formed) Cornice Profiles:** Offer the advantage of "unlimited customization" particularly useful for historic replications. Historic cornices fabricated from terne tin, galvanized steel, and copper are easily replicated with aluminum profiles. Select from a large selection of classical profiles that may be easily modified to suit your design requirements.

- **Extruded Aluminum Cornice Profiles:** Offer a highly refined cornice with precise joints, exceptionally crisp lines, and much greater detail. Extruded profiles are so refined that interior wood crown mouldings may be easily substituted. We offer a large selection of classical profiles that are "inter-changeable" so you may easily combine different profiles to create most any cornice imaginable. Predesigned Extruded Cornices are identified by the suffix "EX".

- **Quality finishing choices:** Powder Coated Kynar 500® & Hylar 5000®, 56 Standard Colors, Custom Matching Colors, may be field painted

- **Custom, compatible Vertical & Horizontal Radius Arch Cornice options**

[FORMED ALUMINUM CORNICES](#)  
[EXTRUDED ALUMINUM CORNICES](#)  
[HISTORIC CORNICE REPLICATIONS](#)  
[CUSTOM CORNICE SYSTEMS](#)  
[GUSSETS](#)  
[FORMED MOULDINGS](#)  
[SOFFIT PANELS, VENTING TRIMS & ACCESSORIES](#)  
[DENTILS, BRACKETS, FLUTES & ENGRAVINGS](#)



- **Virtually Maintenance Free**
- **Does Not Burn or Add to Combustion.**
- **Excellent Weathering Characteristics.**
- **Will Not Rot, Crack, or Crumble**
- **Excellent Material For LEED Buildings**
- **Earth Friendly, 85% Recycled Aluminum**
- **Insect Proof**
- **Available with Steel Mounting Gussets, Eliminating Expensive Wood or Steel Framing**

CONTACT AN SAF DESIGNER SERIES CORNICE PRO NOW

1581 Huber Street Northwest, Atlanta, GA | toll free: +1-800-241-7429 | +1-404-355-1560

©2015 SAF Southern Aluminum Finishing Company, Inc. | [www.saf.com](http://www.saf.com)



Metals Distribution, Finishing and Fabrication

[ABOUT US](#) [GALLERY](#) [DOWNLOADS](#) [FAQS](#) [LINKS](#) [STORE](#) [HOW TO SPECIFY](#) [CONTACT](#) [PRESS ROOM](#) [SITE MAP](#)

[ALUMINUM SHEET](#) [ALUMINUM EXTRUSIONS](#) [METAL FABRICATION](#) [COLUMN COVERS](#) [PANELS](#) [ANODIZING](#) [PAINTING](#) [ALUMINUM COIL](#) [SAF PERIMETER SYSTEMS](#)

## PERIMETER SYSTEMS

[SAF Perimeter Systems Quote Request](#)

[Cornice & Gutter Products](#)

[Designer Series Cornices](#)

[Arch & Radius Cornices](#)

[Commercial Gutter Systems & Downspouts](#)

[Pediments & Entablatures](#)

[Coping Systems](#)

[Gravel Stops & Fascia Systems](#)

[Fabricating for Architectural Applications](#)

[SAF Perimeter Systems News](#)

[Gallery](#)

[Contact Us](#)

[Download Center](#)

[Design Guide](#)

[Color Chart](#)

[FAQ](#)

[Optin](#)



## FORMED ALUMINUM CORNICES

### DESIGNER SERIES FORMED ALUMINUM CORNICES

Formed from aluminum sheet, our beautiful Formed Cornice trims, soffit, and mouldings are available in a variety of interchangeable Cornice profiles – allowing you to custom design your cornice. Most Formed Cornices are compatible with our concealed gutter & internal drains to eliminate exposed downspouts. Select one of our fifteen pre-designed cornices that have all the details worked out for you.

### Historical Cornice Replications

Often, we receive a request to match existing cornices built many years ago — we take exceptional pride with such historical replications. We have replicated cornices for churches, schools, and court houses to mention a few.

### [FORMED ALUMINUM CORNICES](#)

[EXTRUDED ALUMINUM CORNICES](#)

[HISTORIC CORNICE REPLICATIONS](#)

[CUSTOM CORNICE SYSTEMS](#)

[GUSSETS](#)

[FORMED MOULDINGS](#)

[SOFFIT PANELS, VENTING TRIMS & ACCESSORIES](#)

[DENTILS, BRACKETS, FLUTES & ENGRAVINGS](#)



### CORNICE DESIGN 1

**CLASSIC Nominal Sizes: 32" Entablature, 16" Depth**

**CONTEMPORARY Nominal Sizes: 18" Entablature, 16" Depth**

Large entablature, small depth, extends our Designer Series Roman Gutter System stepped with an additional Roman Moulding. A frieze and architrave finish its lower portion.

[CAD](#) | [SKETCHUP](#) | [SPECIFICATION](#) | [SUBMITTAL](#) | [INSTALLATION](#)



### CORNICE DESIGN 2

**CLASSIC Nominal Sizes: 34" Entablature, 15" Depth CONTEMPORARY Nominal Sizes: 15" Entablature, 15" Depth**

Large entablature, small depth. Generally, does not incorporate a gutter system but can accommodate a built in gutter. Includes a crown moulding, large frieze moulding, and J-Trim moulding.

[CAD](#) | [SKETCHUP](#) | [SPECIFICATION](#) | [SUBMITTAL](#) | [INSTALLATION](#)



### CORNICE DESIGN 3

**CLASSIC Nominal Sizes: 44" Entablature, 21" Depth CONTEMPORARY Nominal Sizes: 24" Entablature, 21" Depth**

Features our Designer Series "Roman Profile" commercial gutter, 2 simple convex/concave mouldings, and a frieze.

[CAD](#) | [SKETCHUP](#) | [SPECIFICATION](#) | [SUBMITTAL](#) | [INSTALLATION](#)



### CORNICE DESIGN 4

**CLASSIC Nominal Sizes: 48" Entablature, 24" Depth CONTEMPORARY Nominal Sizes: 20" Entablature, 24" Depth**

Beautifully sculptured cornice consisting of: 2 mouldings to create a Convex / Concave Reverse pattern, a frieze, optional vented or non-vented soffit, and features our Designer Series 6" Colonial Gutter System.

[CAD](#) | [SKETCHUP](#) | [SPECIFICATION](#) | [SUBMITTAL](#) | [INSTALLATION](#)

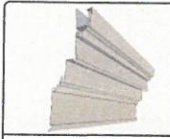

#### CORNICE DESIGN 5

**CLASSIC Nominal Sizes: 42" Entablature, 20" Depth** **CONTEMPORARY Nominal Sizes: 28" Entablature, 20" Depth**

Large entablature with a small depth and features our Designer Series Roman Gutter System stepped with an additional Roman Moulding. Profiles are separated with 2 Frieze trims along with a continuous vented soffit.

[CAD](#) | [SKETCHUP](#) | [SPECIFICATION](#) | [SUBMITTAL](#) | [INSTALLATION](#)



#### CORNICE DESIGN 6

**CLASSIC Nominal Sizes: 31" Entablature, 33" Depth** **CONTEMPORARY Nominal Sizes: 24" Entablature, 33" Depth**

Beautifully sculptured cornice contains 3 cavetto shape mouldings, a frieze, optional vented or non-vented soffit and features our Designer Series commercial gutter.

[CAD](#) | [SKETCHUP](#) | [SPECIFICATION](#) | [SUBMITTAL](#) | [INSTALLATION](#)

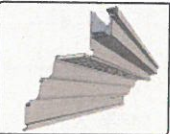

#### CORNICE DESIGN 7

**CLASSIC Nominal Sizes: 25" Entablature, 26" Depth** **CONTEMPORARY Nominal Sizes: 18" Entablature, 26" Depth**

Provides a small entablature with a large depth — features a frieze, a double set of convex mouldings, optional vented or non-vented soffit and features our Designer Series Batten commercial gutter.

[CAD](#) | [SKETCHUP](#) | [SPECIFICATION](#) | [SUBMITTAL](#) | [INSTALLATION](#)



#### CORNICE DESIGN 8

**CLASSIC Nominal Sizes: 18+" Entablature, 12" Depth** **CONTEMPORARY Nominal Sizes: 10" Entablature, 12" Depth**

This is a very popular profile using dual crown mouldings. These crown mouldings feature a small radius for their convex and concave profiles. These small radius mouldings simulate wood trim more so than stone work. Cornice Design 8 also lends itself well to parapets and roofs where gutters are not required. Dentils, flutes, and engravings may be added.

[CAD](#) | [SKETCHUP](#) | [SPECIFICATION](#) | [SUBMITTAL](#) | [INSTALLATION](#)



#### CORNICE DESIGN 9

**CLASSIC Nominal Sizes: 32" Entablature, 26" Depth** **CONTEMPORARY Nominal Sizes: 24" Entablature, 16" Depth**

This striking cornice features our Designer Series "Roman Profile" commercial gutter, 2 simple convex/concave mouldings, a frieze, and architrave.

[CAD](#) | [SKETCHUP](#) | [SPECIFICATION](#) | [SUBMITTAL](#) | [INSTALLATION](#)



#### CORNICE DESIGN 10

**CLASSIC Nominal Sizes: 24" Entablature, 15" Depth** **CONTEMPORARY Nominal Sizes: 15" Entablature, 15" Depth**

Popular profile for use with parapets as well roof eaves. This cornice design uses a large 3" convex moulding with a scrolled 1-1/2" moulding along with a frieze moulding. This cornice design also lends itself well to parapets and roofs where gutters are not required. With some creativity, additional mouldings dentils, flutes, and engravings may be added.

[CAD](#) | [SKETCHUP](#) | [SPECIFICATION](#) | [SUBMITTAL](#) | [INSTALLATION](#)



### CORNICE DESIGN 11

**CLASSIC Nominal Sizes: 36" Entablature, 20" Depth CONTEMPORARY Nominal Sizes: 18" Entablature, 20" Depth**

This cornice – with a large entablature with a small depth – features our Designer Series Roman Gutter System stepped with an additional Roman Moulding. Profiles are separated with 2 Frieze trims along with a continuous vented soffit. Optional components include dentils, flutes, and engravings.

[CAD](#) | [SKETCHUP](#) | [SPECIFICATION](#) | [SUBMITTAL](#) | [INSTALLATION](#)



### CORNICE DESIGN 12

**CLASSIC Nominal Sizes: 36" Entablature, 20" Depth CONTEMPORARY Nominal Sizes: 18" Entablature, 20" Depth**

This simple cornice offers mouldings for creating a large entablature with a small depth — featuring our Designer Series Roman Gutter System stepped with a compound curved LZ trim and finished with a large frieze trim. Optional components such as dentils, flutes, and engravings may be added.

[CAD](#) | [SKETCHUP](#) | [SPECIFICATION](#) | [SUBMITTAL](#) | [INSTALLATION](#)



### CORNICE DESIGN 14

**CLASSIC Nominal Sizes: 45" Entablature, 24" Depth CONTEMPORARY Nominal Sizes: Not offered**

This simple 4 piece cornice design offers a large entablature by exposing a portion of the wall surface as well as a large depth. Moulding profiles include our crown moulding and dual convex concave mouldings. An LZ Trim is placed on the wall surface below the cornice giving it a striking effect. With a little creativity this cornice could include dentils.

[CAD](#) | [SKETCHUP](#) | [SPECIFICATION](#) | [SUBMITTAL](#) | [INSTALLATION](#)



### CORNICE DESIGN 15

**CLASSIC Nominal Sizes: 40" Entablature, 18" Depth CONTEMPORARY Nominal Sizes: 18" Entablature, 18" Depth**

This cornice uses large scrolled dentils custom designed for the project. Cornice 15 also boasts a large entablature with a small depth and features our Designer Series Colonial gutter (customized). We are often called upon to modify the fascia of our Designer Series commercial gutters, and Cornice Design 15 is an excellent example of such modifications.

[CAD](#) | [SKETCHUP](#) | [SPECIFICATION](#) | [SUBMITTAL](#) | [INSTALLATION](#)



### CORNICE DESIGN 16

**CLASSIC Nominal Sizes: 32" Entablature, 18" Minimum Variable Depth CONTEMPORARY Nominal Sizes: Not offered**

Large entablature with a variable depth to accommodate your soffit requirements. This simple design may be used without gutters. Or, by increasing the fascia permits the use of our Designer Series. Profiles include large 3" convex and concave mouldings. Soffits may be solid, half vented, or full vented. Optional components include flutes and engravings.

[CAD](#) | [SKETCHUP](#) | [SPECIFICATION](#) | [SUBMITTAL](#) | [INSTALLATION](#)

### VERSA CORNICE Profiles

Using profiles from SAF Cornice Mouldings, Versa Cornice is a product developed to convert a dull parapet coping into a visually exciting sculptured roof edge. Designed for both retrofit and new construction, Versa-Cornice attachment brackets fit all SAF Perimeter Systems coping caps and most other parapet caps or applications.



**Model VS-LZ1**

- CAD
- SUBMITTAL
- SPECIFICATIONS



**Model VS-LZ2**

- CAD
- SUBMITTAL
- SPECIFICATIONS



**Model VS-ICB/OCT**

- CAD
- SUBMITTAL
- SPECIFICATIONS



**Model VS-OCB/CT**

- CAD
- SUBMITTAL
- SPECIFICATIONS

CONTACT AN SAF DESIGNER SERIES CORNICE PRO NOW

1581 Huber Street Northwest, Atlanta, GA | toll free: +1-800-241-7429 | +1-404-355-1560

©2015 SAF Southern Aluminum Finishing Company, Inc. | [www.saf.com](http://www.saf.com)



Metals Distribution, Finishing and Fabrication

[ABOUT US](#) [GALLERY](#) [DOWNLOADS](#) [FAQS](#) [LINKS](#) [STORE](#) [HOW TO SPECIFY](#) [CONTACT](#) [PRESS ROOM](#) [SITE MAP](#)

[ALUMINUM SHEET](#) [ALUMINUM EXTRUSIONS](#) [METAL FABRICATION](#) [COLUMN COVERS](#) [PANELS](#) [ANODIZING](#) [PAINTING](#) [ALUMINUM COIL](#) [SAF PERIMETER SYSTEMS](#)

## PERIMETER SYSTEMS

[SAF Perimeter Systems Quote Request](#)

[Cornice & Gutter Products](#)

[Designer Series Cornices](#)

[Arch & Radius Cornices](#)

[Commercial Gutter Systems & Downspouts](#)

[Pediments & Entablatures](#)

[Coping Systems](#)

[Gravel Stops & Fascia Systems](#)

[Fabricating for Architectural Applications](#)

[SAF Perimeter Systems News](#)

[Gallery](#)

[Contact Us](#)

[Download Center](#)

[Design Guide](#)

[Color Chart](#)

[FAQ](#)

[Optin](#)



## EXTRUDED ALUMINUM CORNICES

**Benefits of Extruded Aluminum Architectural Cornices & Gutters** include precise joints, crisp lines, with much greater detail. Since 1990, Perimeter Systems has provided Designer Series Cornice for churches, universities, financial institutions, municipalities, and stately homes throughout the United States. Now, SAF cornice mouldings by Perimeter Systems are available in aluminum extrusions.

### Featuring Interlocking Cornice Profiles

Designer Series Extruded Cornice Mouldings are uniquely designed to interlock with a water resistant and securely locked seam. In addition, we designed our mouldings with an overlapped "shingle effect" seam to deflect wind driven rain.

### Interchangeable Profiles

These extruded mouldings are available in several classical profiles along with sills, offsets, & closure trims. Interchangeable mouldings easily combine to create most any cornice imaginable. And with a special head trim, these refined mouldings can be installed as interior crown mouldings.

[FORMED ALUMINUM CORNICES](#)

[EXTRUDED ALUMINUM CORNICES](#)

[HISTORIC CORNICE REPLICATIONS](#)

[CUSTOM CORNICE SYSTEMS](#)

[GUSSETS](#)

[FORMED MOULDINGS](#)

[SOFFIT PANELS, VENTING TRIMS & ACCESSORIES](#)

[DENTILS, BRACKETS, FLUTES & ENGRAVINGS](#)

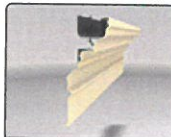
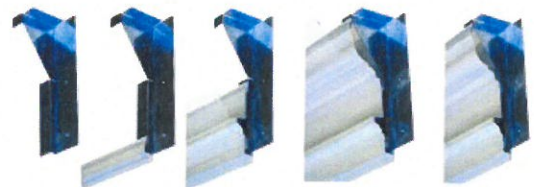

### CORNICE DESIGN 1 EX

**CLASSIC Nominal Sizes:** 32" Entablature, 13" Depth

**CONTEMPORARY Nominal Sizes:** 19" Entablature, 13" Depth

Extruded aluminum cornice boasts a large entablature, small depth, and features an Internal Concealed Gutter System. A frieze and architrave finish its lower portion. Easily adapts to our popular concealed internal drains, eliminating exposed downspouts.

[CAD](#) | [SKETCHUP](#) | [IMAGE GALLERY](#) | [SPECIFICATION](#) | [SUBMITTAL](#)

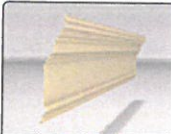

### CORNICE DESIGN 2 EX

**CLASSIC Nominal Sizes:** 29" Entablature, 6-1/2" Depth

**CONTEMPORARY Nominal Sizes:** 16" Entablature, 6-1/2" Depth

Cornice with a large entablature and a narrow depth. Does not incorporate a gutter system but can accommodate a concealed gutter built into a roof structure. Narrow cornices, such as Cornice Design 2EX, are good choices for roof eaves with small soffits, gazebos, or colonnades.

[CAD](#) | [SKETCHUP](#) | [IMAGE GALLERY](#) | [SPECIFICATION](#) | [SUBMITTAL](#)

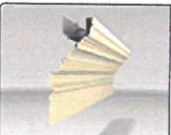

### CORNICE DESIGN 3 EX

**CLASSIC Nominal Sizes:** 31" Entablature, 13" Depth

**CONTEMPORARY Nominal Sizes:** 18" Entablature, 13" Depth

Features a large entablature, small depth, and an Internal Concealed Gutter System. A

frieze and architrave finish its lower portion. Easily adapts to our popular concealed internal drains, eliminating exposed downspouts.

[CAD](#) | [SKETCHUP](#) | [IMAGE GALLERY](#) | [SPECIFICATION](#) | [SUBMITTAL](#)

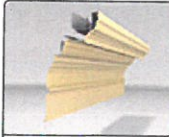

#### CORNICE DESIGN 4 EX

**CLASSIC Nominal Sizes: 35" Entablature, 19" Depth**

**CONTEMPORARY Nominal Sizes: 20" Entablature, 19" Depth**

Beautifully sculptured cornice features a large entablature, concealed internal gutter, and a variable width soffit. The variable width soffit allows to change cornice depth. The soffit can be solid or vented.

[CAD](#) | [SKETCHUP](#) | [IMAGE GALLERY](#) | [SPECIFICATION](#) | [SUBMITTAL](#)

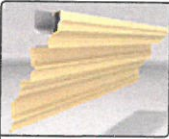

#### CORNICE DESIGN 5 EX

**CLASSIC Nominal Sizes: 32" Entablature, 18" Depth**

**CONTEMPORARY Nominal Sizes: 25" Entablature, 18" Depth**

Large entablature features an Internal Concealed Gutter System. "Stepped" crown mouldings produce a bold & enhanced sculptured cornice. Easily adapts to our popular concealed internal drains, eliminating exposed downspouts.

[CAD](#) | [SKETCHUP](#) | [IMAGE GALLERY](#) | [SPECIFICATION](#) | [SUBMITTAL](#)

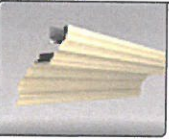

#### CORNICE DESIGN 6 EX

**CLASSIC Nominal Sizes: 30" Entablature, 20" Depth**

**CONTEMPORARY Nominal Sizes: 24" Entablature, 20" Depth**

Beautifully sculptured cornice features a large entablature, concealed internal gutter, and a variable width soffit. The variable width soffit allows to change cornice depth. The soffit can be solid or vented.

[CAD](#) | [SKETCHUP](#) | [IMAGE GALLERY](#) | [SPECIFICATION](#) | [SUBMITTAL](#)

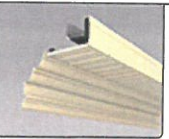

#### CORNICE DESIGN 7 EX

**CLASSIC Nominal Sizes: 25" Entablature, 26" Depth**

**CONTEMPORARY Nominal Sizes: 18" Entablature, 26" Depth**

Extruded aluminum cornice boasts a medium size entablature, variable depth, and features an Internal Concealed Gutter System. A frieze finishes its lower portion. Easily adapts to our popular concealed internal drains, eliminating exposed downspouts.

[CAD](#) | [SKETCHUP](#) | [IMAGE GALLERY](#) | [SPECIFICATION](#) | [SUBMITTAL](#)

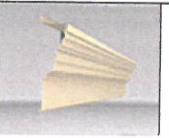

#### CORNICE DESIGN 8 EX

**CLASSIC Nominal Sizes: 22" Entablature, 8" Depth**

**CONTEMPORARY Nominal Sizes: 16" Entablature, 6-1/2" Depth**

Cornice Design 8 EX features a medium size entablature with a narrow depth. Does not incorporate a gutter system but can accommodate a concealed gutter built into a roof structure. A narrow cornice and a good choice for roof eaves that have small soffits, gazebos, or colonnades.

[CAD](#) | [SKETCHUP](#) | [IMAGE GALLERY](#) | [SPECIFICATION](#) | [SUBMITTAL](#)

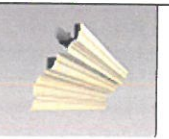

#### CORNICE DESIGN 9 EX

**CLASSIC Nominal Sizes: 26" Entablature, 20" Depth**

**CONTEMPORARY Nominal Sizes: 20" Entablature, 20" Depth**

This extruded aluminum cornice boasts a medium size entablature, variable depth, and features an Internal Concealed Gutter System. An architrave finish its lower portion. Easily adapts to our popular concealed internal drains, eliminating exposed downspouts.

[CAD](#) | [SKETCHUP](#) | [IMAGE GALLERY](#) | [SPECIFICATION](#) | [SUBMITTAL](#)



### CORNICE DESIGN 10 EX

**CLASSIC Nominal Sizes:** 21" Entablature, 10" Depth

**CONTEMPORARY Nominal Sizes:** 15" Entablature, 10" Depth

Features a medium size entablature with a narrow depth. Does not incorporate a gutter system but can accommodate a concealed gutter built into a roof structure. A narrow cornice and a good choice for roof eaves that have small soffits, gazebos, or colonnades.

[CAD](#) | [SKETCHUP](#) | [IMAGE GALLERY](#) | [SPECIFICATION](#) | [SUBMITTAL](#)



### CORNICE DESIGN 11 EX

**CLASSIC Nominal Sizes:** 32" Entablature, 12" Depth

**CONTEMPORARY Nominal Sizes:** 19" Entablature, 12" Depth

This cornice features a large entablature, a small depth and dentils. A frieze and architrave finish its lower portion. Easily adapts to our popular concealed internal drains, eliminating exposed downspouts.

[CAD](#) | [SKETCHUP](#) | [IMAGE GALLERY](#) | [SPECIFICATION](#) | [SUBMITTAL](#)



### CORNICE DESIGN 12 EX

**CLASSIC Nominal Sizes:** 26" Entablature, 19" Depth

**CONTEMPORARY Nominal Sizes:** 20" Entablature, 19" Depth

Extruded aluminum cornice boasts a large entablature, small depth, and features an Internal Concealed Gutter System. A frieze and architrave finish its lower portion. Easily adapts to our popular concealed internal drains, eliminating exposed downspouts.

[CAD](#) | [SKETCHUP](#) | [IMAGE GALLERY](#) | [SPECIFICATION](#) | [SUBMITTAL](#)

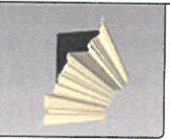

### CORNICE DESIGN 14 EX

**CLASSIC Nominal Sizes:** 28" Entablature, 20" Depth

**CONTEMPORARY Nominal Sizes:** 14" Entablature, 20" Depth

Cornice Design 14 EX features a medium size entablature, a variable depth and a Internal Concealed Gutter System. A frieze and architrave finish its lower portion. Easily adapts to our popular concealed internal drains, eliminating exposed downspouts.

[CAD](#) | [SKETCHUP](#) | [IMAGE GALLERY](#) | [SPECIFICATION](#) | [SUBMITTAL](#)



### CORNICE DESIGN 15 EX

**CLASSIC Nominal Sizes:** 31" Entablature, 12" Depth

**CONTEMPORARY Nominal Sizes:** 18" Entablature, 12" Depth

This extruded aluminum cornice boasts a large entablature, small depth, and features dentils. A frieze and architrave finish its lower portion. Easily adapts to our popular concealed internal drains, eliminating exposed downspouts.

[CAD](#) | [SKETCHUP](#) | [IMAGE GALLERY](#) | [SPECIFICATION](#) | [SUBMITTAL](#)

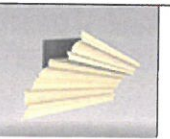

### CORNICE DESIGN 16 EX

**CLASSIC Nominal Sizes:** 27" Entablature, 19" Minimum Variable Depth

**CONTEMPORARY Nominal Sizes:** 20" Entablature, 19" Depth

Features a medium size entablature and depth. While this cornice design does not incorporate a gutter system it can accommodate a concealed gutter built into a roof structure.

[CAD](#) | [SKETCHUP](#) | [IMAGE GALLERY](#) | [SPECIFICATION](#) | [SUBMITTAL](#)



### CORNICE MOULDINGS

**Designer Series Extruded Cornice Trims**, including Radius Sculptured Shapes, Extensions, Friezes, and Sills are extruded to standard wood lengths of 8', 10' & 12'

lengths. Joints receive concealed extruded aluminum splices. Designer Series Extruded Aluminum Cornices are designed to be installed very much the same way wood cornices are installed. Like wood, mitered corners can be saw cut in the field using a common miter saw. Factory Miters are available.

[CAD](#) | [SKETCHUP](#) | [SPECIFICATION](#) | [SUBMITTAL](#) | [INSTALLATION](#)

CONTACT AN SAF DESIGNER SERIES CORNICE PRO NOW

1581 Huber Street Northwest, Atlanta, GA | toll free: +1-800-241-7429 | +1-404-355-1560

©2015 SAF Southern Aluminum Finishing Company, Inc. | [www.saf.com](http://www.saf.com)

# SUBMITTAL / DATA SHEET

Perimeter  
Systems

*Innovative Aluminum Architecture*

A division of



8370 East Hwy 78  
Villa Rica, GA 30180  
800-334-9823 770-942-1207 Fax 942-4173

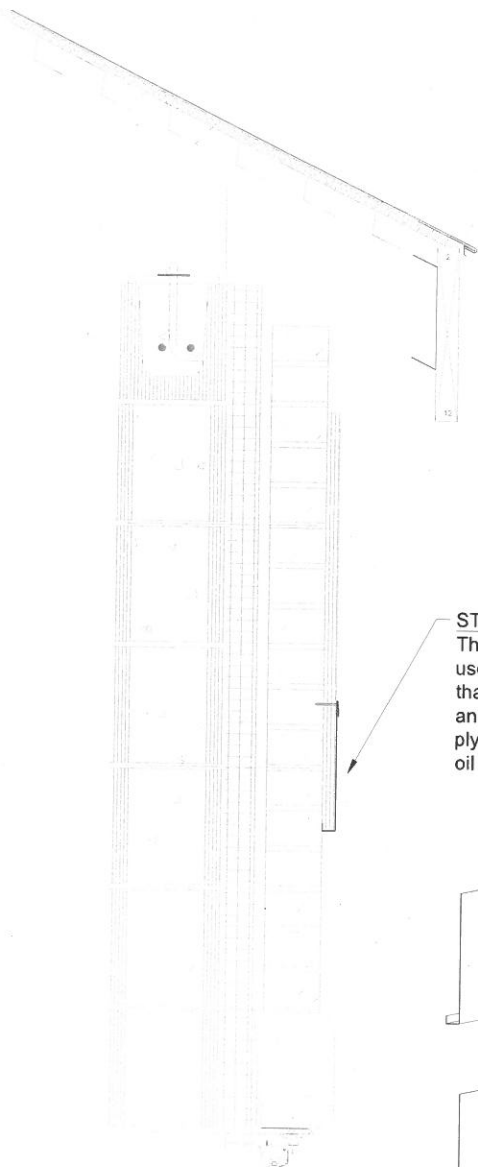

## STEP 1 - INSTALL D

This piece has to be "lanced" before installation. You must use tongs to fold down the top of piece between the slots that has no holes, then put this snug against the plywood and use #10x1" stainless screws to fasten this piece to the plywood. Do not overdrive the screws as this will cause oil canning.

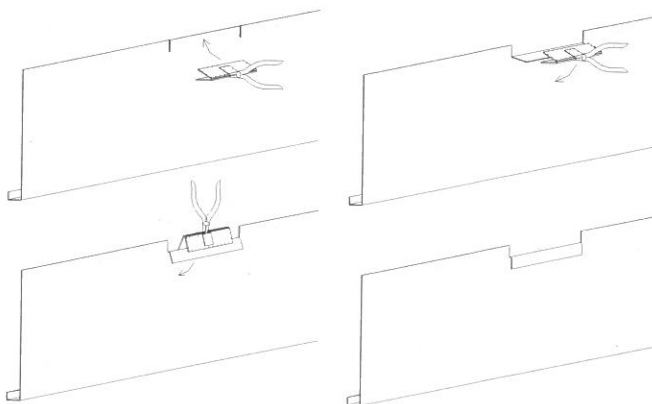

Drawing No. 33a

# SUBMITTAL / DATA SHEET

Perimeter  
Systems

*Innovative Aluminum Architecture*

A division of



8370 East Hwy 78  
Villa Rica, GA 30180  
800-334-9823 770-942-1207 Fax 942-4173

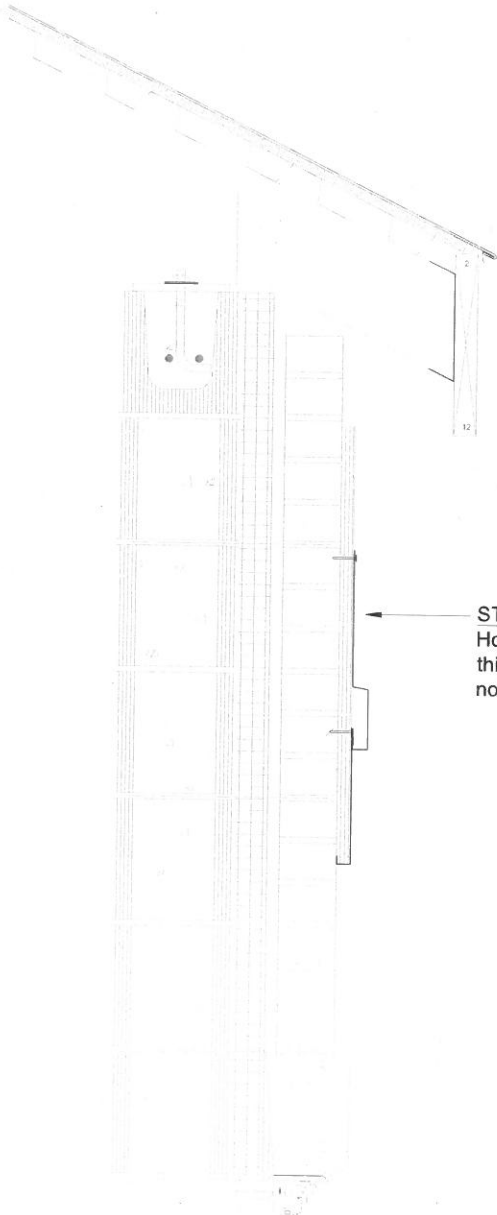

## STEP 2 - INSTALL C

Hook this into the lower piece, pull it tight and fasten this to the plywood with #10x1" stainless screws. Do not overdrive screws as this will cause oil canning.

Drawing No. 33b

# SUBMITTAL / DATA SHEET

Perimeter  
Systems

Innovative Aluminum Architecture

A division of **SAF**

8370 East Hwy 78  
Villa Rica, GA 30180  
800-334-9823 770-942-1207 Fax 942-4173

*example*

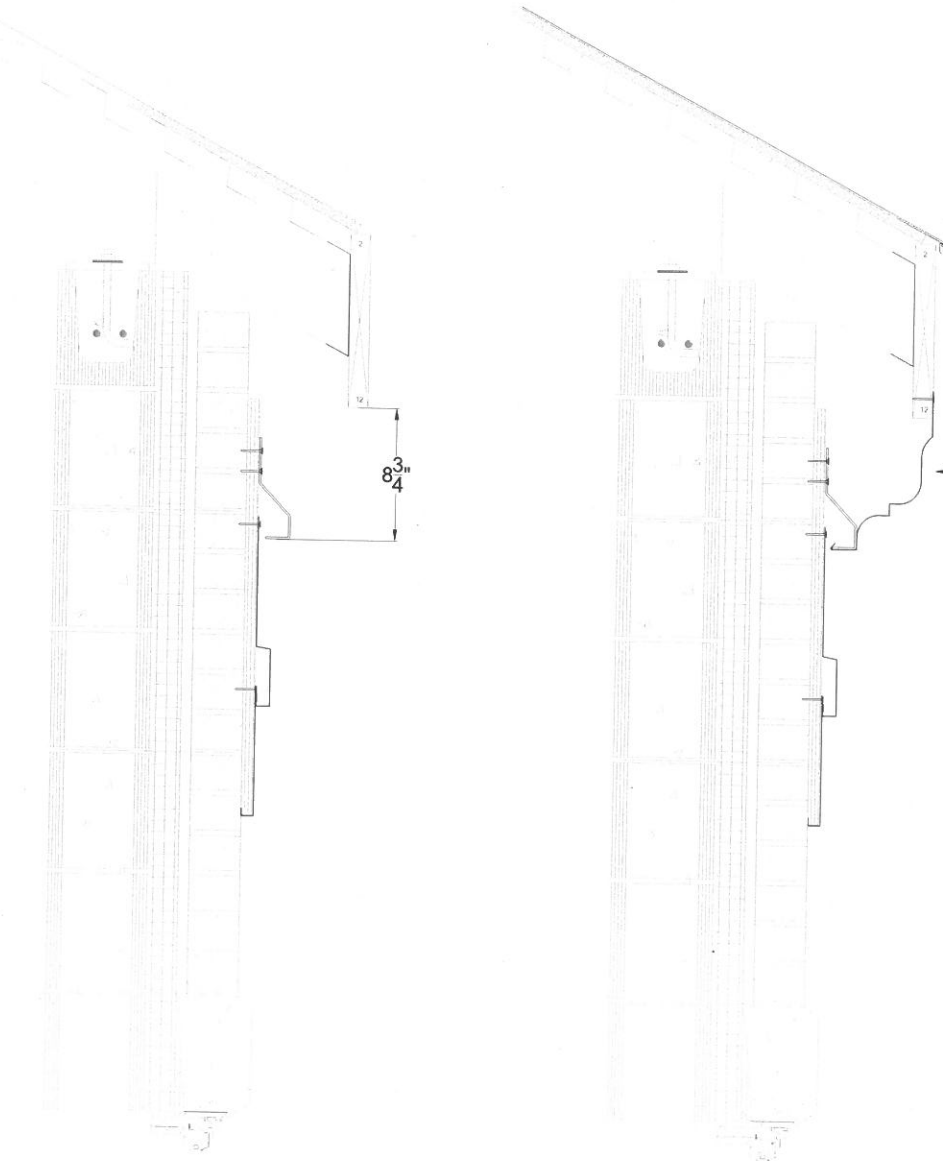

## STEP 3 - INSTALL BRACKET AND B

Fasten mounting bracket to plywood with 2 - #10x1 1/2" stainless screws, then put the roman moulding around the bottom of the bracket and fasten the top in place to 2x with #10x1" stainless screws.

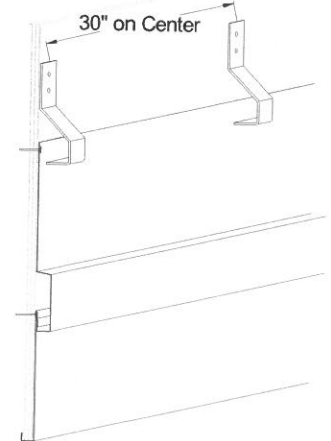

Drawing No. 33c

# SUBMITTAL / DATA SHEET

Perimeter  
Systems

*Innovative Aluminum Architecture*

A division of **SAF**

8370 East Hwy 78  
Villa Rica, GA 30180  
800-334-9823 770-942-1207 Fax 942-4173

*example*

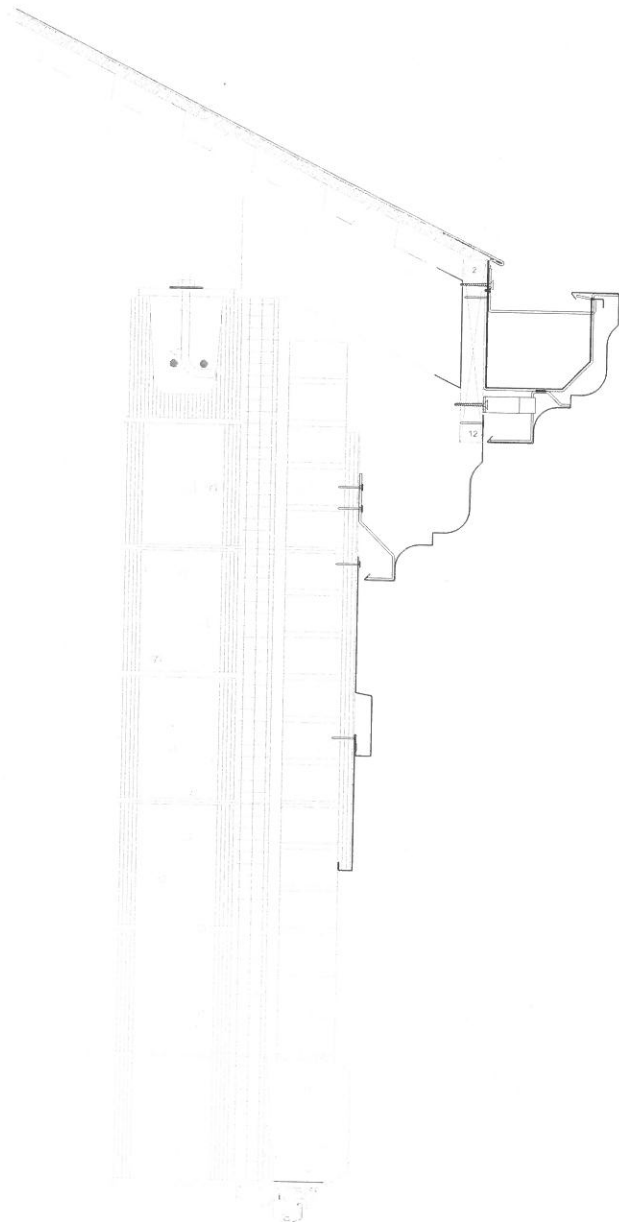

STEP 4 - INSTALL A  
Install Roman gutter system - see  
installation instructions.

Drawing No. 33d

# SUBMITTAL / DATA SHEET

Perimeter  
Systems

*Innovative Aluminum Architecture*

A division of **SAF**

8370 East Hwy 78  
Villa Rica, GA 30180  
800-334-9823 770-942-1207 Fax 942-4173

*example*

## STEP 1 - INSTALL C

This piece has to be "lanced" before installation. You must use tongs to fold down the top of piece between the slots that has no holes, then put this snug against the plywood and use #10x1" stainless screws to fasten this piece to the plywood. Do not overdrive the screws as this will cause oil canning.

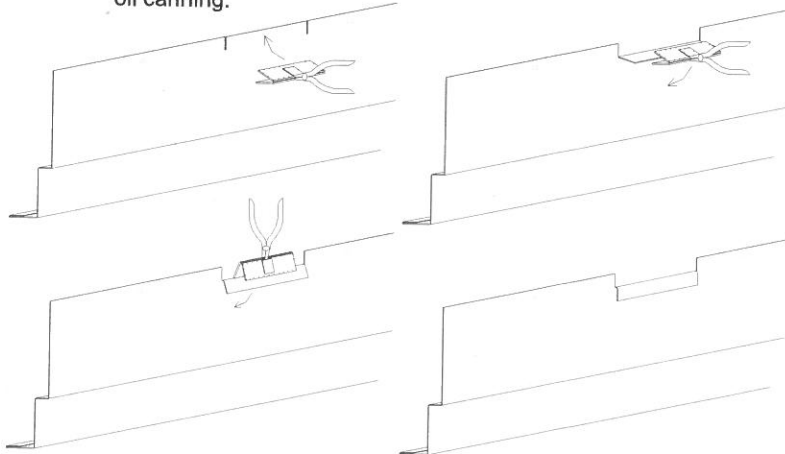

Drawing No. 34a

# SUBMITTAL / DATA SHEET

Perimeter  
Systems

*Innovative Aluminum Architecture*

A division of



8370 East Hwy 78  
Villa Rica, GA 30180  
800-334-9823 770-942-1207 Fax 942-4173

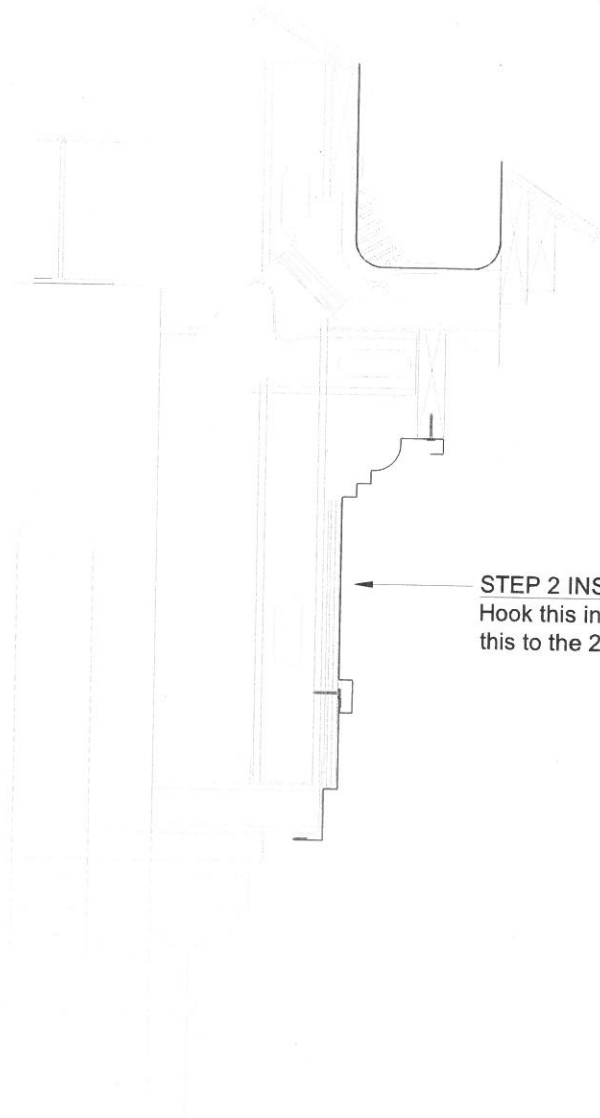

*example*

## STEP 2 INSTALL B

Hook this into the lower piece, pull it tight and fasten this to the 2x with #10x1" stainless screws.

Drawing No. 34b

# SUBMITTAL / DATA SHEET

Perimeter  
Systems

*Innovative Aluminum Architecture*

A division of **SAF**

8370 East Hwy 78  
Villa Rica, GA 30180  
800-334-9823 770-942-1207 Fax 942-4173

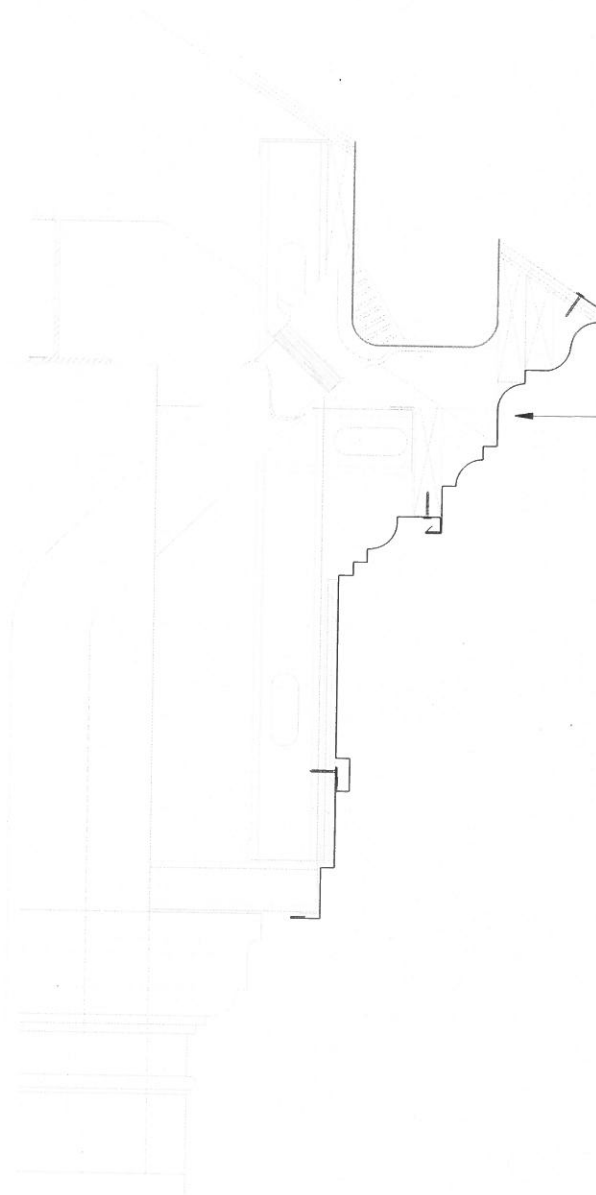

## STEP 3 INSTALL A

Hook this into the lower piece, pull it tight and fasten this to the plywood with #10x1" stainless screws.

Drawing No. 34c

**SECTION 07 62 00**  
**Sheet Metal Flashing and Trim**  
**ALUMINUM CORNICE & DECORATIVE TRIMS**

*example*

**PART 1 - GENERAL**

**1.01 RELATED DOCUMENTS**

- A. The provisions included under Division 1, General Requirements, are included as part of this section as though bound herein.

**1.02 SUMMARY**

- A. Provide labor, material, and equipment necessary for furnishing a complete installation of pre-designed aluminum cornice & decorative trims.
- B. Related Work Specified Elsewhere
  - 1. Section 06100 "Rough Carpentry" for wood nailers, curbs, and blocking.
  - 2. Section 07620 "Sheet Metal Flashing and Trim" for custom and site fabricated sheet metal flashing and trim.
  - 3. Section 07720 "Roof Accessories" for set-on-type curbs, equipment supports, roof hatches, vents, and other manufactured roof accessory units.

**1.03 SUBMITTALS**

- A. Product Data: Each type of product specified. Submit manufacturer's detailed technical product data, installation instructions and recommendations, dimensions of individual components, profiles, and finishes
- B. Shop Drawings: Show fabrication and installation of commercial gutter system including fully dimensioned roof plans, expansion joint locations, sections and details of components and other related trims.
- C. Finish & Color Selection: Furnish manufacturer's technical data for specified finish and color chart showing full range of colors available.

**1.04 QUALITY ASSURANCE**

- A. Where pre-engineered manufactured products are specified, other field fabricated or shop/field fabricated substitutions will not be accepted. However, where shop/field fabrications are indicated pre-engineered systems will be considered with Architect approval.
- B. Obtain all components and related accessories from one single source manufacturer.
- C. Follow manufacturer's guidelines & shop drawings for installing pre-designed cornice & decorative trims. If cornice or trims join a roof system then follow primary roofing

*example*

manufacturer's printed instructions for installing associated roof material for flashing decorative trims to roof.

#### 1.05 DELIVERY, STORAGE & HANDLING

- A. All products delivered shall be stored in a clean dry location prior to installation.
- B. Products furnished with strippable protective masking shall not be exposed to direct sunlight for more than 30 minutes without removing masking.
- C. Do not install finished materials with scars or abrasions.

#### 1.06 PROJECT CONDITIONS

- A. Coordinate work of this Section with adjoining work for proper sequencing to ensure protection from inclement weather and to protect materials and their finish against damage.
- B. Do not install commercial gutter system during inclement weather. When installing in cold climates, warm adhesives, caulks, and primers to at least 50 degrees Fahrenheit prior to application.

### PART 2 PRODUCTS

#### 2.01 MANUFACTURERS

- A. Provide pre-design aluminum cornice, decorative trims, and accessories as manufactured by Perimeter Systems, a division of Southern Aluminum Finishing Company, Inc. 8370 East Hwy 78, Villa Rica, GA 30180, (800) 334-9823, Online at <http://www.saf.com/persys>

#### 2.02 TYPE

- A. Provide Perimeter Systems' Designer Series Extruded Cornice System "Cornice Design #8EX" and decorative trims as indicated on plans. If shown on plans, see section 07 71 23 for concealed internal gutters and drain ware.

#### 2.03 MATERIALS & FABRICATION

- A. Decorative cornice profiles shall be 0.085 6063-T5 aluminum extrusions with interlocking seam design, 10'-0" lengths, profiles to be stock as indicated on plans and printed literature.
- B. Decorative cornice splices shall be aluminum extrusions or where required, manufactured from 0.040" aluminum, 4" lengths, designed to mate the inside of the cornice profiles.
- C. Support Brackets, attachments brackets and retainer brackets shall be manufactured from 0.125" x 1.00" aluminum, heliarc welded construction (where necessary), factory punched for fasteners.

*example*

- D. Mounting Gussets (if shown) shall be manufactured from 20 gauge galvanized steel, G90 coating.

## 2.04 ACCESSORIES

- A. Mitered Corners: Provide factory mitered corners for all cornice profiles (excluding soffits). Cornice profiles shall be precision saw cut, heliarc tack welded to produce a picture frame joint.
- B. Sculptured End Caps: Provide factory mitered end caps for cornice. Cornice profiles shall be precision saw cut, heliarc tack welded to produce a picture frame joint.
- C. Cornice Returns: If shown on drawings, provide cornice returns at eaves & rake terminations in lengths as indicated on plans.
- D. Rake & Gable Trims: As shown on drawings, provide rake and gable trims in profiles as indicated complete with concealed splices, attachment brackets (if required).
  - 1. Provide factory mitered corners, precision saw cut, heliarc tack welded to produce a picture frame joint.
- E. VHB Assist / Isolator Tape shall be 45 mill, 1" width, synthetic composition, double sided and high adhesion.
- F. Hardware for fastening cornice members shall be stainless steel, type 304, #10-24 x 0.75" machine screws with nylon core hex lock nuts.
- G. Hardware for mounting gussets shall be selected based on minimum pull strength of 100 lbs / fastener. Fastener material and type must be compatible with building substrates and in conformance with local building codes.

## 2.05 FINISHES

- A. General: Apply coatings to exposed aluminum components after fabrication for maximum coating performance and to prevent crazing, abrasion, and damage to finished surfaces.
- B. Pretreatment: Aluminum components shall be pretreated with solutions to remove organic and inorganic surface soils, remove residual oxides, followed by a chrome phosphate conversion coating to which organic coatings will firmly adhere.
- C. Coating Type: High Performance Coating, two-coat, shop applied, 70% Polyvinylidene Fluoride (PVDF) coating based on Elf Arkema Chemicals, Inc. Kynar 500 or Ausimont U.S.A., Inc. Hylar 5000 resin, meeting AAMA 2605 specification.
- D. Color: Select from manufacturer's full range of 56 EZ Mix Colors.

## PART 3 EXECUTION

### 3.01 EXAMINATION

- A. The installer must examine substrates and conditions under which cornice & decorative profiles will be installed. All wood plates and/or fascia boards shall be installed true, straight, and free of splits, cracks, or other irregularities. Do not proceed with installation until unsatisfactory conditions are corrected.
- B. The installer must field verify that framing has been built in accordance with the dimensions furnished by the cornice manufacturer either by shop drawings or published literature. Do not proceed with installation until unsatisfactory conditions are corrected.

*example*

### 3.02 INSTALLATION

- A. General: The pre-designed cornice and decorative trims shall be installed in strict accordance with manufacturer's printed instructions and shop drawings.
- B. Fastening:
  - 1. Wood Substrates: Cornice trims shall be fastened through factory punched elongated holes (if supplied) or in .1875" field drilled holes with #10 x 1-1/2" stainless steel wood screws. Support brackets, retaining brackets and attachment brackets shall be installed with #10 x 2" stainless steel wood screws at locations and spacing as shown on shop drawings.
  - 2. Steel Gussets: VHB Assist / Isolator tapes shall be adhered at all fastening locations to separate dissimilar metals. Field drill cornice trims w/ .1875" diameter drill bit at all fastening locations. Fasten cornice members with stainless steel, type 304, #10-24 x .75" machine screws with nylon core hex lock nuts.
  - 3. Aluminum miter connections: Field drill cornice trims w/ .1875" diameter drill bit at all fastening locations. Fasten cornice members with stainless steel, type 304, #10-24 x 0.75" machine screws with nylon core hex lock nuts.
- C. Install cornice profiles and decorative trims with concealed splice plates over brackets and/or framing substrates as shown on shop drawings. In accordance with shop drawings;
  - 1. Coordinate and align spacing of expansion reveal joints with associated trims (stack joints).
  - 2. Plan spacing of joints so there is no sections of fascia shorter than 48" in length.
  - 3. Check horizontal alignment of fascia during installation and adjust as required.
  - 4. Remove Cornice moulding fastening and locking flanges to accommodate splice plates where required.

END OF SECTION 07 62 00

## Perimeter Systems

*Innovative Aluminum Architecture*

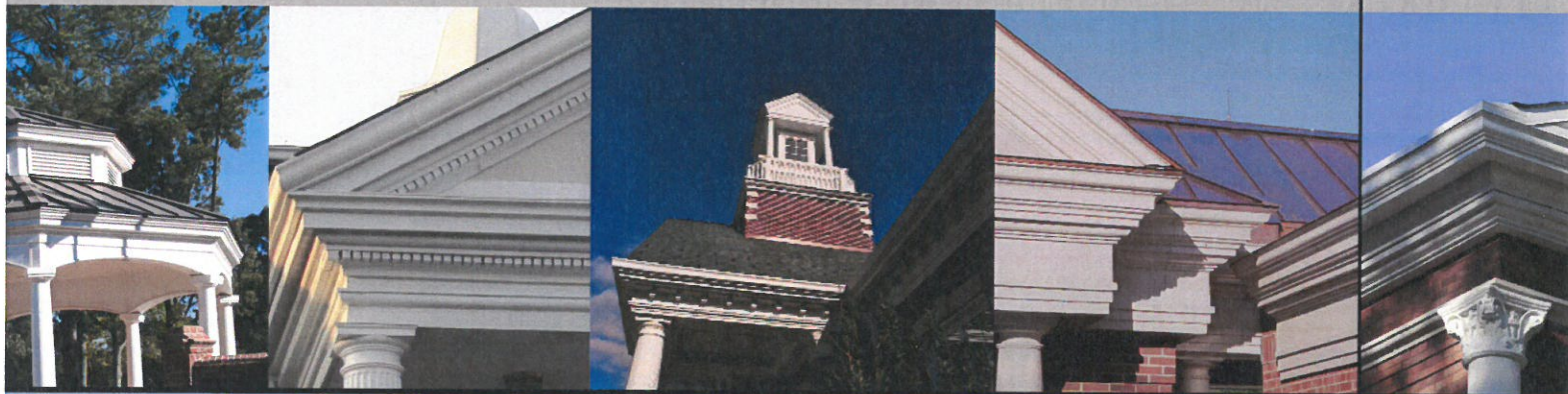

## Pediments & Entablatures

*Extruded Aluminum Cornices*

## Designer Series Pediments & Entablatures

*Beautiful Pediments and Entablatures are available in a variety of styles from Perimeter Systems. These prominent building elements are manufactured from extruded aluminum mouldings offering a more refined and elegant presence.*

*These Pediments and Entablatures may be finished in rich bronze anodized tones or powder coated in one of 56 EZ Mix High Performance Polyvinylidene Fluoride Fluoropon Coatings.*



### *PEDIMENT & ENTABLATURE FEATURE;*

- *Powder Coated Kynar 500® & Hylar 5000®*
- *Custom Matching Colors or Bronze Anodized Finishes*
- *Factory Assembled Units for Easy Field Installation*
- *Will Not Burn or Add to Combustion*
- *Excellent Weathering Characteristics*
- *Will Not Rot, Crack or Crumble*
- *Excellent Material for LEED Buildings*
- *Earth Friendly - 85% Recycled Aluminum*
- *Insect Proof*



Perimeter Systems

# Modular Construction

*Pediments, Entablatures, and Columns are manufactured as “stand alone” components. With several Pediments, Entablatures, and Columns available, these components are easily interchanged allowing you to accent any opening, creating an element that compliments your building’s design.*

*In addition, entablatures are available with different frieze mouldings creating more design options for you.*

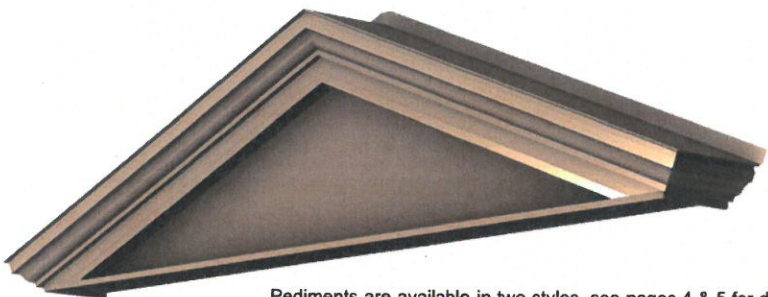

Pediments are available in two styles, see pages 4 & 5 for details.

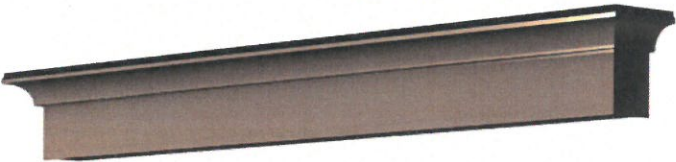

Entablatures are available in 3 styles, see page 4 & 5 for details.

# Easy Installation

*Perimeter Systems’ Pediments and Entablatures feature unique concealed gussets and wall plates that allow the installer to simply hang and bolt the unit in place. No special trades or heavy framing required for these light weight assemblies.*

Mounting gussets are formed to slip fit onto a wall plate.

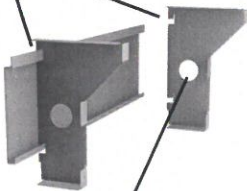

Electrical conduit openings and lifting points.

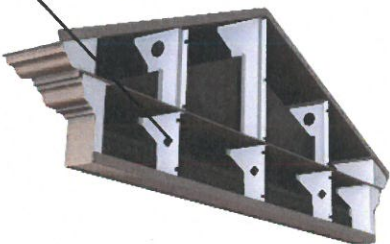

Several column styles are available, see page 7.



Pediment Design A  
Model 100 Entablature



Pediment Design A  
Model 200 Entablature



Pediment Design A  
Model 400 Entablature

## Designer Series Pediment Design A

*Pediment Design A features model 200 extruded cornice moulding on its roof's rake & eave edges. This cornice moulding contains 3 classical radius profiles giving the pediment a proud and prominent presence.*

*Pediment Design A may be mounted to one of three entablatures. Each entablature features a different horizontal cornice moulding over a simple and elegant frieze.*

*Both pediment and entablature may be ordered with dentils and columns. Please see page 6 & 7 for additional features and options.*

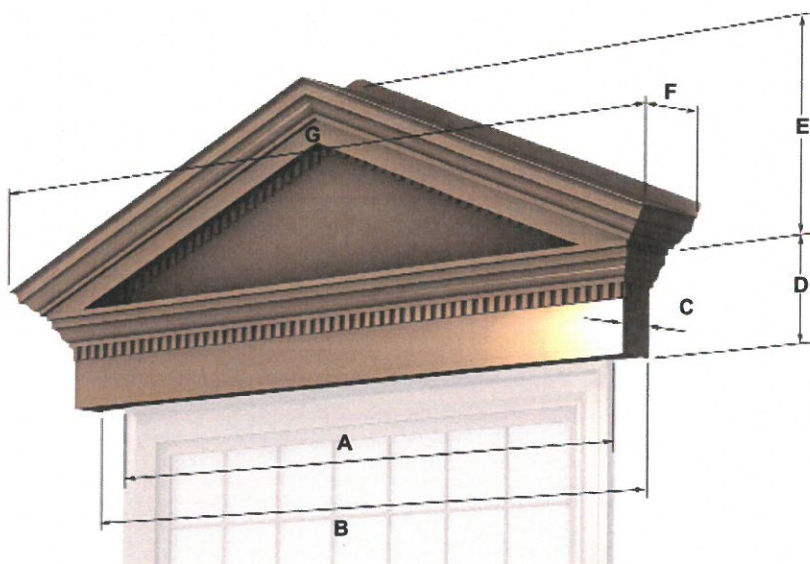

Pediment Nominal Dimensions - Designs A & B

Entablature	Dim A	Dim B	Dim C	Dim D	Dim E	Dim F	Dim G
Model 100	36-1/2"	48"	8"	15"	17"	14-3/4"	85-1/2"
	48-1/2"	80"	8"	15"	19-5/8"	14-3/4"	77-1/2"
	72"	84-1/2"	8"	15"	24-3/4"	14-3/4"	102"
	96"	108-1/2"	6"	15"	29-5/8"	14-3/4"	126"
Model 200	36-1/2"	48"	6"	15"	17-1/4"	15-1/4"	66-1/2"
	48-1/2"	60"	6"	15"	20"	15-1/4"	78-1/2"
	72"	84-1/2"	6"	15"	25"	15-1/4"	103"
	96"	108-1/2"	6"	15"	30"	15-1/4"	127"
Model 400	36-1/2"	48"	6"	12-3/4"	17-1/4"	15-3/4"	67-1/2"
	48-1/2"	60"	6"	12-3/4"	20-1/4"	15-3/4"	79-1/2"
	72"	84-1/2"	6"	12-3/4"	25-1/4"	15-3/4"	104"
	96"	108-1/2"	6"	12-3/4"	30-1/4"	15-3/4"	128"

## Designer Series Pediment Design B

*Pediment Design B features model 100 extruded cornice moulding on its roof's rake & eave edges. This cornice moulding contains 2 classical radius profiles giving the pediment a refined presence.*

*Pediment Design B may be mounted to one of three entablatures. Each entablature features a different horizontal cornice moulding over a simple and elegant frieze.*

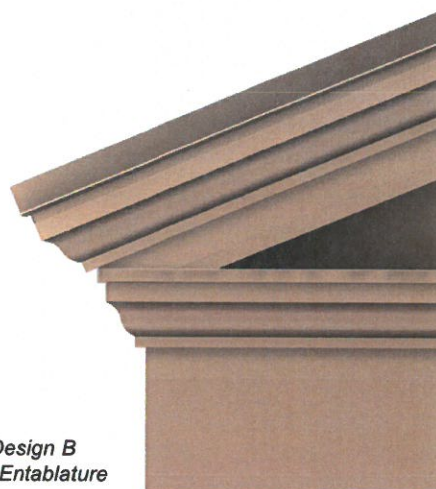

Pediment Design B  
Model 100 Entablature

## Components & Assembly

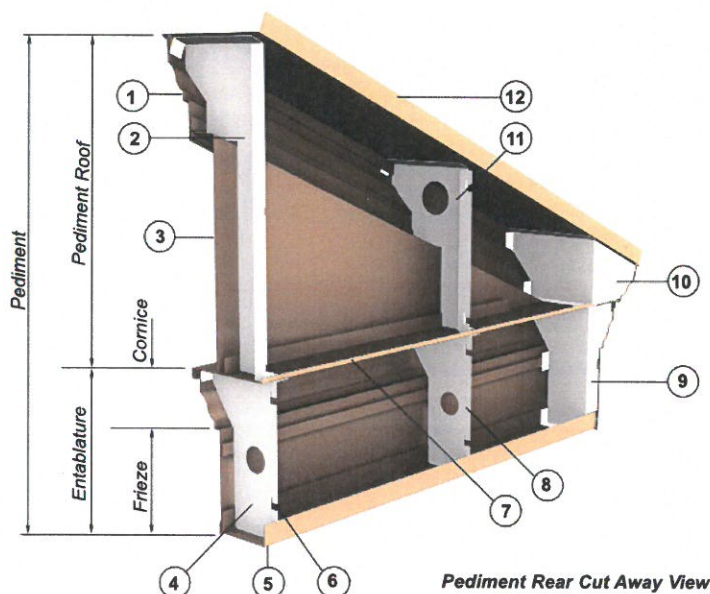

- |                              |                           |
|------------------------------|---------------------------|
| 1. Rake Cornice              | 7. Shelf (self-draining)  |
| 2. Center Gusset             | 8. Entablature Mid Gusset |
| 3. Infill                    | 9. Entablature End Gusset |
| 4. Entablature Center Gusset | 10. End Gusset            |
| 5. Soffit                    | 11. Mid Gusset            |
| 6. Mounting Notch (typical)  | 12. Roof                  |

Holes are provided in gussets to allow for lifting and passage of electrical wiring.



Pediment Design B  
Model 200 Entablature

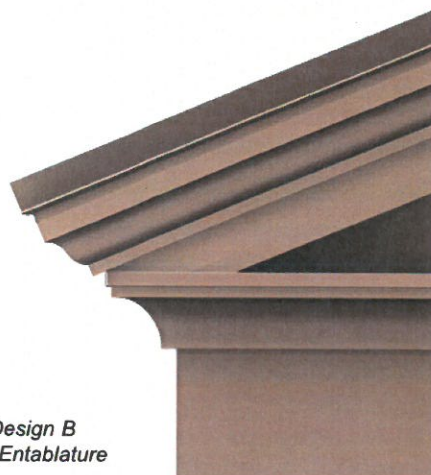

Pediment Design B  
Model 400 Entablature

## Designer Series Entablatures

*In addition to entablatures shown on pages 4 & 5, we offer many variations. Our extruded mouldings are universal and uniquely inter-changeable allowing you to create designs specific to your project.*

*Two additional entablature designs are presented here to show different configurations of our extruded mouldings. These entablatures may be mated with any of the pediments shown on pages 4 & 5.*

*Both pediments and entablatures may be ordered with dentils.*

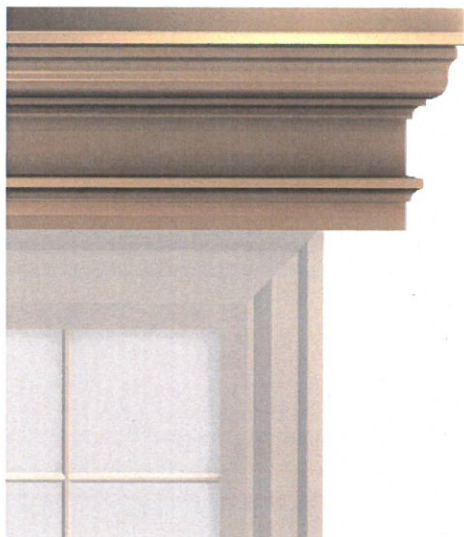

Model 200-800 Entablature

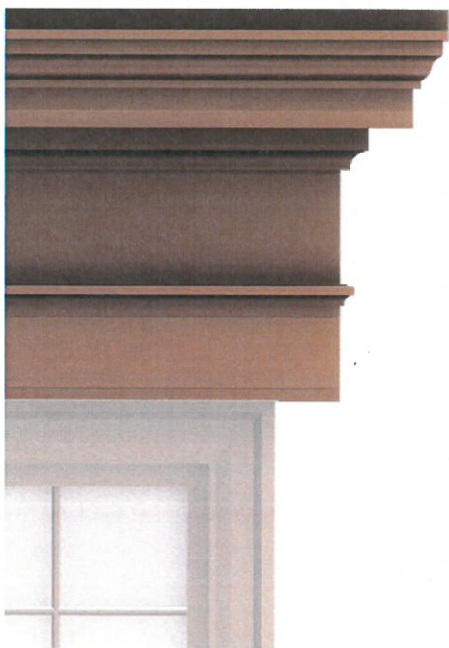

Model 100-400-900 Entablature

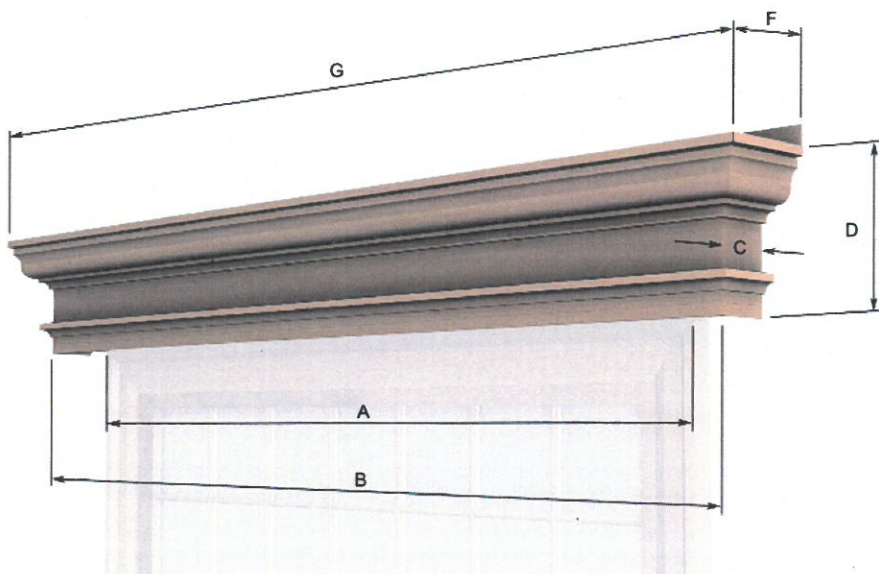

Entablature Dimensions						
Entablature	Dim A	Dim B	Dim C	Dim D	Dim F	Dim G
Model 200-800	36-1/2"	48"	6"	15"	10-1/2"	57"
	48-1/2"	60"	6"	15"	10-1/2"	69"
	72"	84-1/2"	6"	15"	10-1/2"	93-1/2"
	96"	108-1/2"	6"	15"	10-1/2"	117-1/2"
Model 100-400-900	36-1/2"	48"	6"	33-3/4"	15-3/4"	67-1/2"
	48-1/2"	60"	6"	33-3/4"	15-3/4"	79-1/2"
	72"	84-1/2"	6"	33-3/4"	15-3/4"	101"
	96"	108-1/2"	6"	33-3/4"	15-3/4"	128"

## Designer Series Columns & Pilasters

*Columns and Pilasters offer striking and classical effects for our Pediments and Entablatures.*

*We offer 3 styles of decorative columns. While these columns are not structural, they are designed with heavy elements for commercial applications including retail, municipal, and educational facilities.*

*Exceptionally easy to install, these units are fastened to your building's structure with concealed anchors and clips prior to the pediment installation.*

*And of course... should you have need for custom columns, our design staff is here to help.*

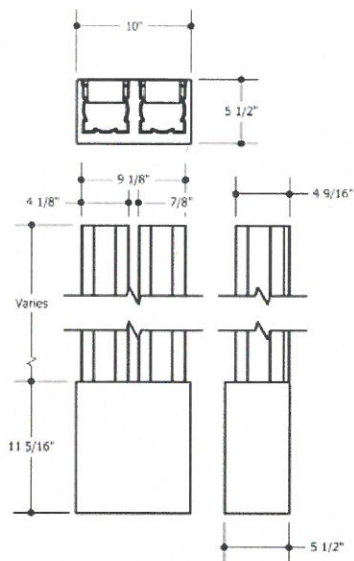
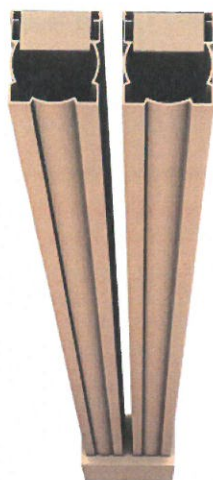

Greek Column Design

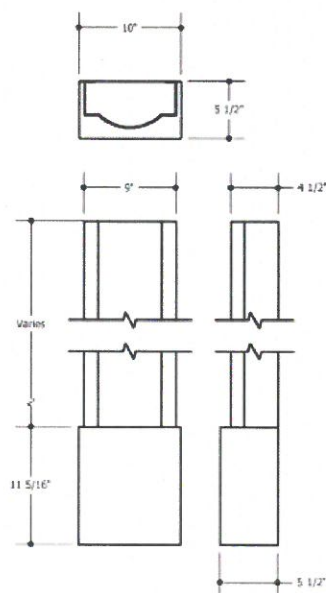
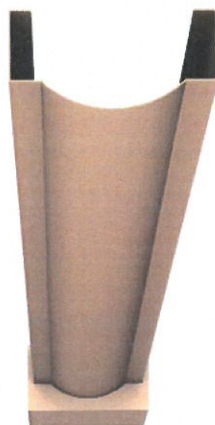

Convex Column Design

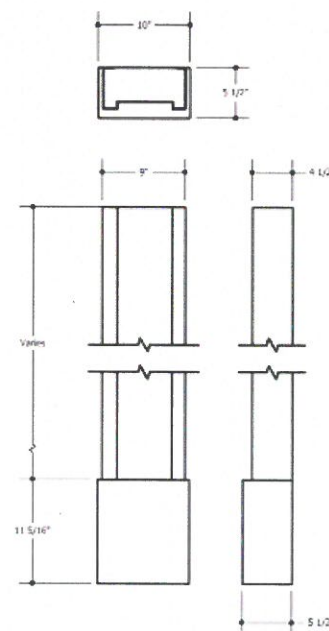
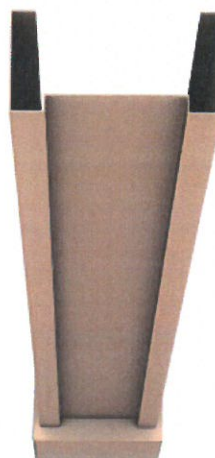

Recessed Column Design

# Perimeter Systems

*Innovative Aluminum Architecture*



## **SAF Perimeter Systems Division**

139 Chatham Street  
Sanford, NC 27330  
Telephone 919-775-7353  
Fax 919-775-5652  
Toll-free 1-800-334-9823  
[www.saf.com/persys](http://www.saf.com/persys)

## **Southern Aluminum Finishing Company, Inc. Architectural Aluminum Finishes and Flat Sheet Anodized Coatings, PVDF Paint Coatings**

1581 Huber Street, NW  
Atlanta, GA 30318  
Telephone 404-355-1560  
Fax 404-350-0581  
Toll-free 1-800-241-7429  
[www.saf.com](http://www.saf.com)

## **SAF Metal Fabrication Division Innovative Metal Architecture**

8370 E. Highway 78  
Villa Rica, GA 30180  
Telephone 770-942-1207  
Fax 877-949-4759  
Toll-free 1-800-241-7429

## **SAF Coil Anodizing Division Architectural and Industrial / Clear & Dyed Finishes**

1417 Poplar Lane  
Nashville, TN 37210  
Telephone 615-259-2800  
Fax 615-259-4211  
Toll-free 1-800-241-7429

## **SAF West**

4356 Caterpillar Rd  
Redding, CA 96003  
Telephone 530-244-7518  
Fax 530-244-7830  
Toll-free 866-660-6627