

X:\A-Projects-2015\15074 - Southeast Christian Church Chapel in the Woods\Development Plan.dwg - PLOT DATE: April 25, 2016 - 11:03am

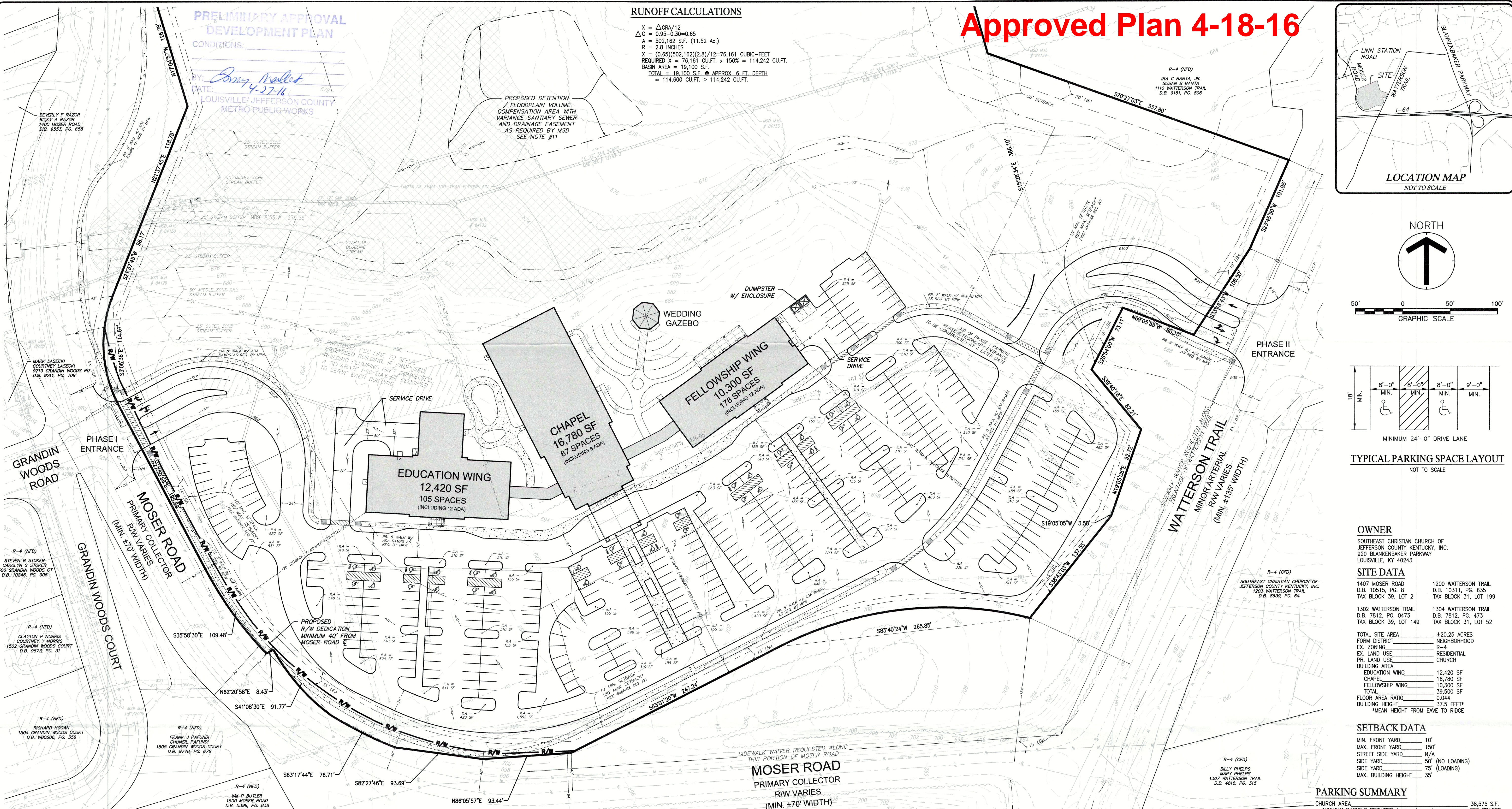

RUNOFF CALCULATIONS

$X = \Delta C / 12$
 $\Delta C = 0.95 - 0.30 = 0.65$
 $A = 502,162 \text{ S.F. (11.52 Ac.)}$
 $R = 2.8 \text{ INCHES}$
 $X = (0.65)(502,162)(2.8) / 12 = 76,161 \text{ CUBIC-FEET}$
 $\text{REQUIRED } X = 76,161 \text{ CU.FT.} \times 150\% = 114,242 \text{ CU.FT.}$
 $\text{BASIN AREA} = 19,100 \text{ S.F. @ APPROX. 6 FT. DEPTH}$
 $\text{TOTAL} = 114,600 \text{ CU.FT.} > 114,242 \text{ CU.FT.}$

Approved Plan 4-18-16

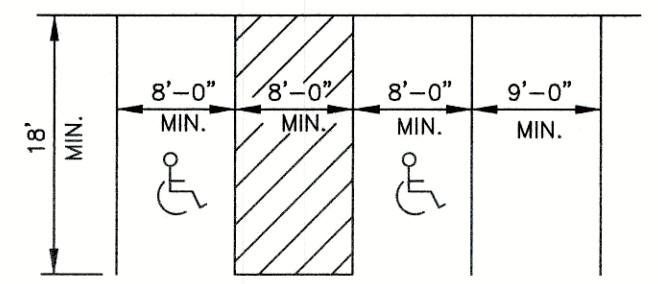
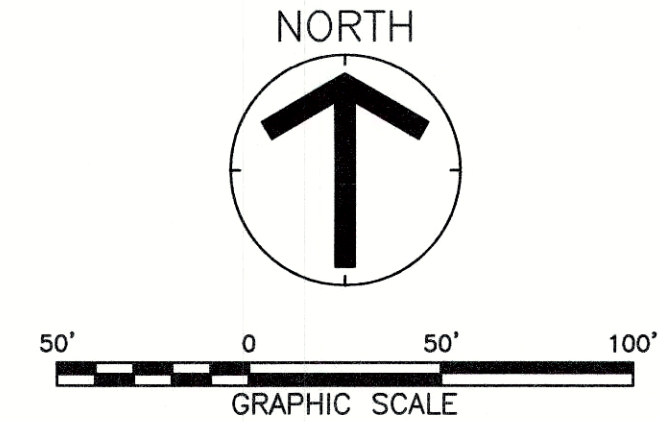
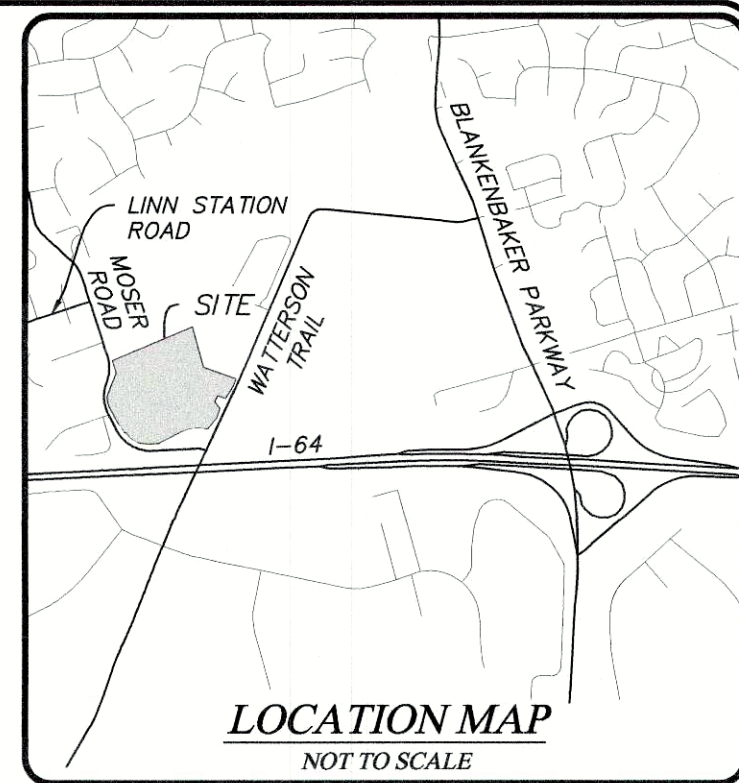

TYPICAL PARKING SPACE LAYOUT
NOT TO SCALE

OWNER
SOUTHEAST CHRISTIAN CHURCH OF
JEFFERSON COUNTY KENTUCKY, INC.
920 BLANKENBAKER PARKWAY
LOUISVILLE, KY 40243

SITE DATA

1407 MOSER ROAD D.B. 10615, PG. 8 TAX BLOCK 39, LOT 2	1200 WATTERSON TRAIL D.B. 10311, PG. 635 TAX BLOCK 31, LOT 199
1302 WATTERSON TRAIL D.B. 7812, PG. 0473 TAX BLOCK 39, LOT 149	1304 WATTERSON TRAIL D.B. 7812, PG. 473 TAX BLOCK 31, LOT 52

TOTAL SITE AREA ±20.25 ACRES
FORM DISTRICT NEIGHBORHOOD
EX. ZONING R-4
EX. LAND USE RESIDENTIAL
PR. LAND USE CHURCH
BUILDING AREA 12,420 SF
EDUCATION WING 16,780 SF
FELLOWSHIP WING 10,300 SF
TOTAL 39,500 SF
FLOOR AREA RATIO 0.044
BUILDING HEIGHT 37.5 FEET*
*MEAN HEIGHT FROM EAVE TO RIDGE

SETBACK DATA

MIN. FRONT YARD	10'
MAX. FRONT YARD	150'
STREET SIDE YARD	N/A
SIDE YARD	50' (NO LOADING)
SIDE YARD	75' (LOADING)
MAX. BUILDING HEIGHT	35'

PARKING SUMMARY

CHURCH AREA	38,575 S.F.
MINIMUM PARKING REQUIRED (1 SPACE/3 SEATS)	300 SPACES
MAXIMUM PARKING PERMITTED (125% MINIMUM REQUIRED)	375 SPACES
TOTAL PARKING PROVIDED	350 SPACES (INCLUDING 32 ADA SPACES)

LANDSCAPE DATA

PROPOSED V.I.A.	192,964 S.F.
I.L.A. REQUIRED (7.5%)	14,472 S.F.
I.L.A. PROVIDED	15,969 S.F.

TREE CANOPY CALCULATIONS

GROSS SITE AREA	882,196 S.F.
CANOPY COVERAGE CLASS	CLASS C
AREA OF SITE WITH EX. TREE CANOPY	487,372 S.F. (55%)
TREE CANOPY REQUIRED	220,549 S.F. (25%)
TREE CANOPY PRESERVED	T.B.D.*
TREE CANOPY PLANTED	220,549 S.F.
TOTAL TREE CANOPY PROVIDED	220,549 S.F.

* TREE CANOPY REQUIRED WILL BE DETERMINE AT CONSTRUCTION STAGE BASED ON FINAL SITE DISTURBANCE AND TREE PRESERVATION.

WAIVER REQUEST

1) WAIVER REQUESTED TO NOT PROVIDE A WALK ALONG A PORTION OF MOSER ROAD AND THE ENTIRE FRONTAGE OF WATTERSON TRAIL.

VARIANCE REQUEST

1) VARIANCE REQUESTED FROM CHAPTER 5, PART 3, SECTION 5.3.1.C.5 - TABLE 5.3.2 OF THE LAND DEVELOPMENT CODE TO EXCEED THE MAXIMUM PERMITTED HEIGHT.

2) VARIANCE REQUESTED FROM CHAPTER 5, PART 3, SECTION 5.3.1.C.5 - TABLE 5.3.2 OF THE LAND DEVELOPMENT CODE TO EXCEED THE MAXIMUM ALLOWED SETBACK.

CASE# 16DEVPLAN1012 & 16VARIANCE1005 RELATED CASE# 15VAR1029 WM# 6657



UTILITY NOTE:

ALL UTILITIES SHOWN ON THESE PLANS ARE APPROXIMATE. INDIVIDUAL SERVICE LINES ARE NOT SHOWN. THE CONTRACTOR OR SUBCONTRACTOR SHALL NOTIFY KENTUCKY 811 (PHONE NO. 811) FORTY EIGHT HOURS IN ADVANCE OF ANY CONSTRUCTION ON THIS PROJECT. THIS NUMBER WAS ESTABLISHED TO PROVIDE ACCURATE LOCATIONS OF EXISTING BELOW GROUND UTILITIES (I.E. CABLES, ELECTRIC WIRES, GAS, AND WATERLINES). THE CONTRACTOR SHALL BE RESPONSIBLE FOR BECOMING FAMILIAR WITH ALL UTILITY REQUIREMENTS SET FORTH ON THE PLANS IN THE TECHNICAL SPECIFICATIONS AND SPECIAL PROVISIONS.

Revision	Date	Description	Detailed by
4	4/25/16	SIDEWALK CONNECTION NOTE 18	JDC
3	3/29/16	AGENCY COMMENTS/MAX. SETBACK VARIANCE REQUEST	JDC
2	3/18/16	AGENCY COMMENTS/CLIENT CHANGES	JDC
1	2/15/16	AGENCY COMMENTS	JDC

PRELIMINARY APPROVAL

Condition of Approval:

Development Review

LOUISVILLE & JEFFERSON COUNTY METROPOLITAN SEWER DISTRICT

EROSION CONTROL NOTES

THE APPROVED EROSION PREVENTION AND SEDIMENT CONTROL (EPSC) PLAN SHALL BE IMPLEMENTED PRIOR TO ANY LAND DISTURBING ACTIVITY ON THE CONSTRUCTION SITE. ANY MODIFICATIONS TO THE APPROVED SWPP PLAN MUST BE REVIEWED AND APPROVED BY MSD'S PRIVATE DEVELOPMENT REVIEW OFFICE. SWPPP BMP'S SHALL BE INSTALLED PER THE PLAN AND MSD STANDARDS.

ACTIONS MUST BE TAKEN TO MINIMIZE THE TRACKING OF MUD AND SOIL FROM CONSTRUCTION AREAS ONTO PUBLIC ROADWAYS. SOIL TRACKED ONTO THE ROADWAY SHALL BE REMOVED DAILY.

SOIL STOCKPILES SHALL BE LOCATED AWAY FROM STREAMS, PONDS, SWALES, AND CATCH BASINS. SOIL STOCKPILES SHALL BE SEED, MULCHED, AND ADEQUATELY CONTAINED THROUGH USE OF SILT FENCE.

WHERE CONSTRUCTION OR LAND DISTURBANCE ACTIVITY WILL OR HAS TEMPORARILY CEASED ON ANY PORTION OF A SITE, TEMPORARY SITE STABILIZATION MEASURES SHALL BE REQUIRED AS SOON AS PRACTICABLE, BUT NO LATER THAN 14 CALENDAR DAYS AFTER THE ACTIVITY HAS CEASED.

SEDIMENT LADEN GROUND WATER ENCOUNTERED DURING THE TRENCHING, BORING, OR OTHER EXCAVATION ACTIVITIES SHALL BE PUMPED TO A SEDIMENT TRAPPING DEVICE PRIOR TO BEING DISCHARGED INTO A STREAM, POND, SWALE, AND/OR CATCH BASIN.

BENCHMARK

TOPOGRAPHICAL INFORMATION SHOWN HEREON WAS DERIVED FROM GIS DATA AND DOES NOT CONSTITUTE A SURVEY. A DETAILED SURVEY WILL BE PERFORMED AT TIME OF CONSTRUCTION PLAN PREPARATION.

LEGEND

EX. TREE	SS	PR. STORM SEWER
EX. FIRE HYDRANT	PSC	PR. SANITARY SEWER
EX. LIGHT POLE	E	PR. PROPERTY SERVICE CONNECTION
EX. UTILITY POLE	W	PR. ELECTRIC W/ TRANSFORMER
EX. SIGN	G	PR. WATER LINE
EX. PROPERTY LINE		PR. GAS LINE
EX. FENCE		PR. SWALE
EX. WATER LINE		PR. CONCRETE
EX. GAS LINE		PR. EDGE OF PAVEMENT
EX. OVERHEAD ELECTRIC		PR. FENCE
EX. UNDERGROUND ELECTRIC		PR. SILT FENCE
EX. SWALE		PR. FIRE HYDRANT
EX. STORM SEWER		PR. LIGHT POLE
EX. SANITARY SEWER		PR. SIGN
EX. CONCRETE		
EX. EDGE OF PAVEMENT		LIMITS OF PROPOSED BUILDING

NOTES

- 1) WASTEWATER: SANITARY SEWER SERVICE WILL BE PROVIDED BY NEW PSC CONNECTION AND IS SUBJECT TO APPLICABLE FEES. SANITARY SEWER FLOW WILL BE TREATED AT THE JEFFERSONTOWN WATER QUALITY TREATMENT CENTER.
- 2) DOMESTIC WATER SUPPLY: SUBJECT SITE TO BE SERVED BY THE LOUISVILLE WATER COMPANY. THE NECESSARY WATER SYSTEM IMPROVEMENTS REQUIRED TO SERVICE THE DEVELOPMENT SHALL BE AT THE OWNER / DEVELOPER'S EXPENSE.
- 3) DRAINAGE: DRAINAGE PATTERN DEPICTED BY ARROWS (—) IS FOR CONCEPT PURPOSES ONLY. FINAL CONFIGURATION AND SIZE OF DRAINAGE PIPES, CHANNELS AND WATER QUALITY METHODS SHALL BE DETERMINED DURING THE CONSTRUCTION PLAN DESIGN PROCESS. DRAINAGE FACILITIES SHALL CONFORM TO MSD REQUIREMENTS. USE OF EX. DRAINAGE CONNECTIONS & STORM WATER REQUIREMENTS SHALL BE COORDINATED WITH MSD.
- 4) THE DEVELOPMENT LIES IN THE MIDDLETOWN FIRE DISTRICT.
- 5) A PORTION OF THE SUBJECT PROPERTY LIES WITHIN A FLOOD HAZARD AREA PER FEMA'S FIRM MAPPING, (21111C0048E REV. DECEMBER 5, 2006).
- 6) ALL SITE LIGHTING SHALL BE SHIELDED AND DIRECTED DOWNWARD AND AWAY FROM ALL ADJUTING RESIDENTIAL AREAS.
- 7) ALL DUMPSTER PADS, TRANSFORMERS, AC UNITS TO BE SCREENED IN COMPLIANCE WITH CHAPTER 10.
- 8) MITIGATION MEASURES FOR DUST CONTROL SHALL BE IN PLACE DURING CONSTRUCTION TO PREVENT PARTICULATE MATTER FROM REACHING EXISTING ROADS AND NEIGHBORING PROPERTIES.
- 9) ENCROACHMENT PERMIT AND BOND ARE REQUIRED BY MPW FOR ANY WORK WITHIN RIGHT-OF-WAY.
- 10) AN EPSC PLAN WILL BE SUBMITTED TO MSD FOR APPROVAL PRIOR TO ANY CONSTRUCTION ACTIVITY.
- 11) ONSITE COMPENSATION WILL BE REQUIRED FOR POST DEVELOPED INCREASE IN FLOWS. COMPENSATION OF 150% OF INCREASE WILL BE REQUIRED. ALL COMPENSATION SHALL TAKE PLACE BELOW THE 100-YEAR FLOOD PLAIN ELEVATION.
- 12) THE FINAL DESIGN OF THIS PROJECT MUST MEET ALL MS4 WATER QUALITY REGULATIONS ESTABLISHED BY MSD. SITE LAYOUT MAY CHANGE AT THE CONSTRUCTION DESIGN PHASE DUE TO PROPERLY SIZING OF GREEN BEST MANAGEMENT PRACTICES.
- 13) CONSTRUCTION PLANS WILL REQUIRE KNOV AND USACE APPROVAL.
- 14) ANY FILL IN THE FLOODPLAIN SHALL BE COMPENSATED ONSITE AT A RATIO OF 1.5:1.
- 15) MSD DRAINAGE BOND REQUIRED PRIOR TO CONSTRUCTION APPROVAL.
- 16) VEGETATION REMOVAL IS REQUIRED ALONG MOSER ROAD AND WATTERSON TRAIL TO PROVIDE CLEAR SIGHT LINES AND MEET ASHTO STANDARDS. CLEARING SHALL BE INCLUDED IN THE BOND FOR ANY OTHER WORK BONDED IN RIGHT-OF-WAY.
- 17) RIGHT-OF-WAY DEDICATION BY DEED OR MINOR PLAT REQUIRED PRIOR TO CONSTRUCTION APPROVAL.
- 18) SOUTHEAST CHRISTIAN CHURCH OF JEFFERSON COUNTY KENTUCKY, INC. WILL, IF AND WHEN KYTC PROCEEDS WITH KYTC PROJECT 5-373-00, MAKE CONNECTIONS OF SIDEWALKS CONSTRUCTED AS PART OF THIS PROJECT TO WALKS BEING CONSTRUCTED AS PART OF THE KYTC PROJECT ALONG MOSER ROAD AND WATTERSON TRAIL.

HERITAGE ENGINEERING, LLC
642 South 4th Street
Louisville, KY 40202
(502) 562-1412
(502) 562-1413 Fax

SOUTHEAST CHRISTIAN CHURCH OF JEFFERSON COUNTY KENTUCKY, INC.
920 BLANKENBAKER PARKWAY
LOUISVILLE, KY 40243

CATEGORY 3 DEVELOPMENT PLAN FOR SOUTHEAST CHRISTIAN CHURCH CHAPEL IN THE WOODS
1407 MOSER ROAD
LOUISVILLE, KY 40299

RECEIVED
APR 23 2016
PLANNING & DESIGN SERVICES

JOB NO: 15074
HORIZ. SCALE: 1"=50'
VERT SCALE: N/A
DESIGNED BY: JDC
DETAILED BY: JDC
CHECKED BY: SWH
DATE: JANUARY 22, 2016

SHEET
C12