

Map of Parcel for Nomination (highlighted in blue).



RECEIVED
NOV 03 2017
LANDSCAPING &
DESIGN SERVICES



The stained-glass windows at Anshei Sfard are true masterpieces. The stained glass menorah is a symbol of Jewish perseverance in the face of persecution and a celebration of the religious freedoms in the US that allow Jewish people to practice our religion without fear or governmental interference.

17designation 1002

Map of Parcel for Nomination (highlighted in blue).

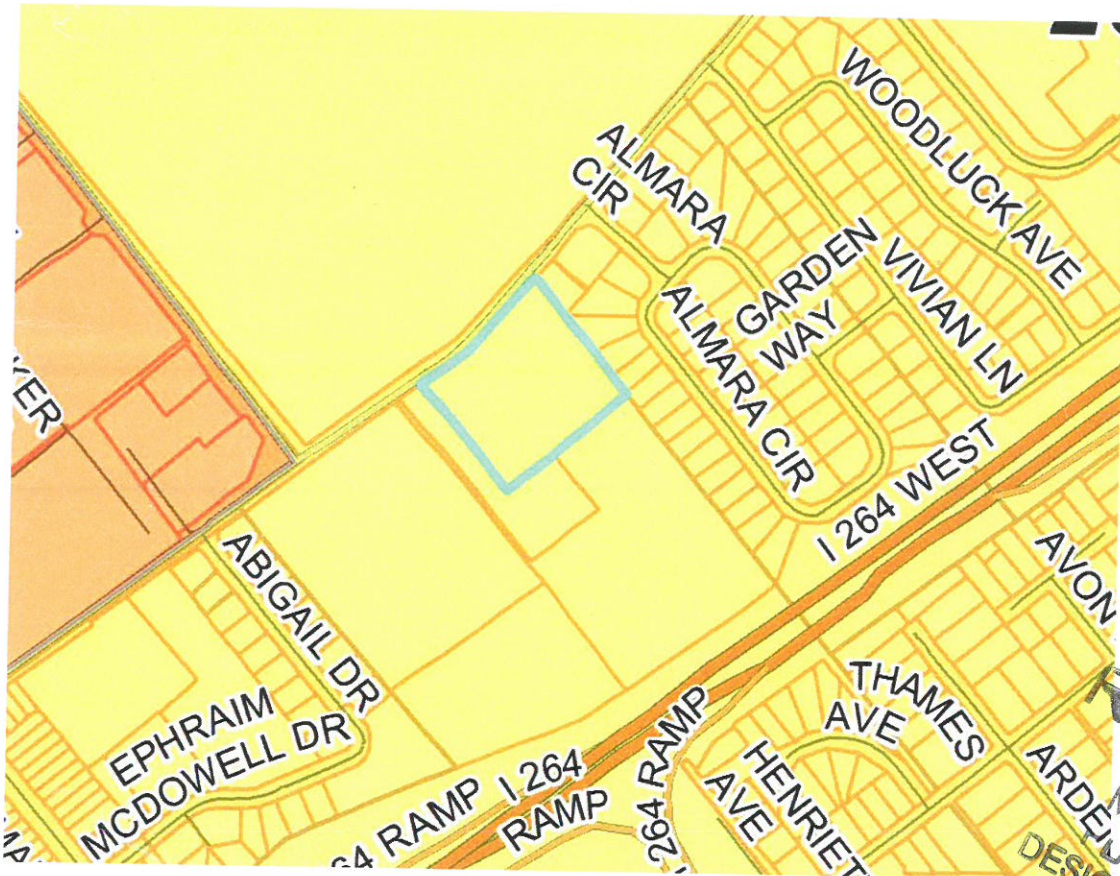

RECEIVED
NOV 03 2017
LANDMARKS &
DESIGN SERVICES



The stained-glass windows at Anshei Sfard are true masterpieces. The stained glass menorah is a symbol of Jewish perseverance in the face of persecution and a celebration of the religious freedoms in the US that allow Jewish people to practice our religion without fear or governmental interference.

17 designation 100a

RECEIVED
NOV 03 2017
PLANNING &
DESIGN SERVICES

Copyright © 2017, LORIC LLC. ALL RIGHTS RESERVED. LORIC LLC is a registered professional engineering firm in the State of North Carolina. LORIC LLC is not responsible for the accuracy or completeness of the information provided on this map. The information is provided for informational purposes only and should not be used for any other purpose. The information is provided as is, without warranty of any kind, express or implied, including but not limited to the accuracy, completeness, or suitability for any purpose. The information is provided for informational purposes only and should not be used for any other purpose. The information is provided as is, without warranty of any kind, express or implied, including but not limited to the accuracy, completeness, or suitability for any purpose.

One Mile Buffer around 3700 Dutchmans Lane

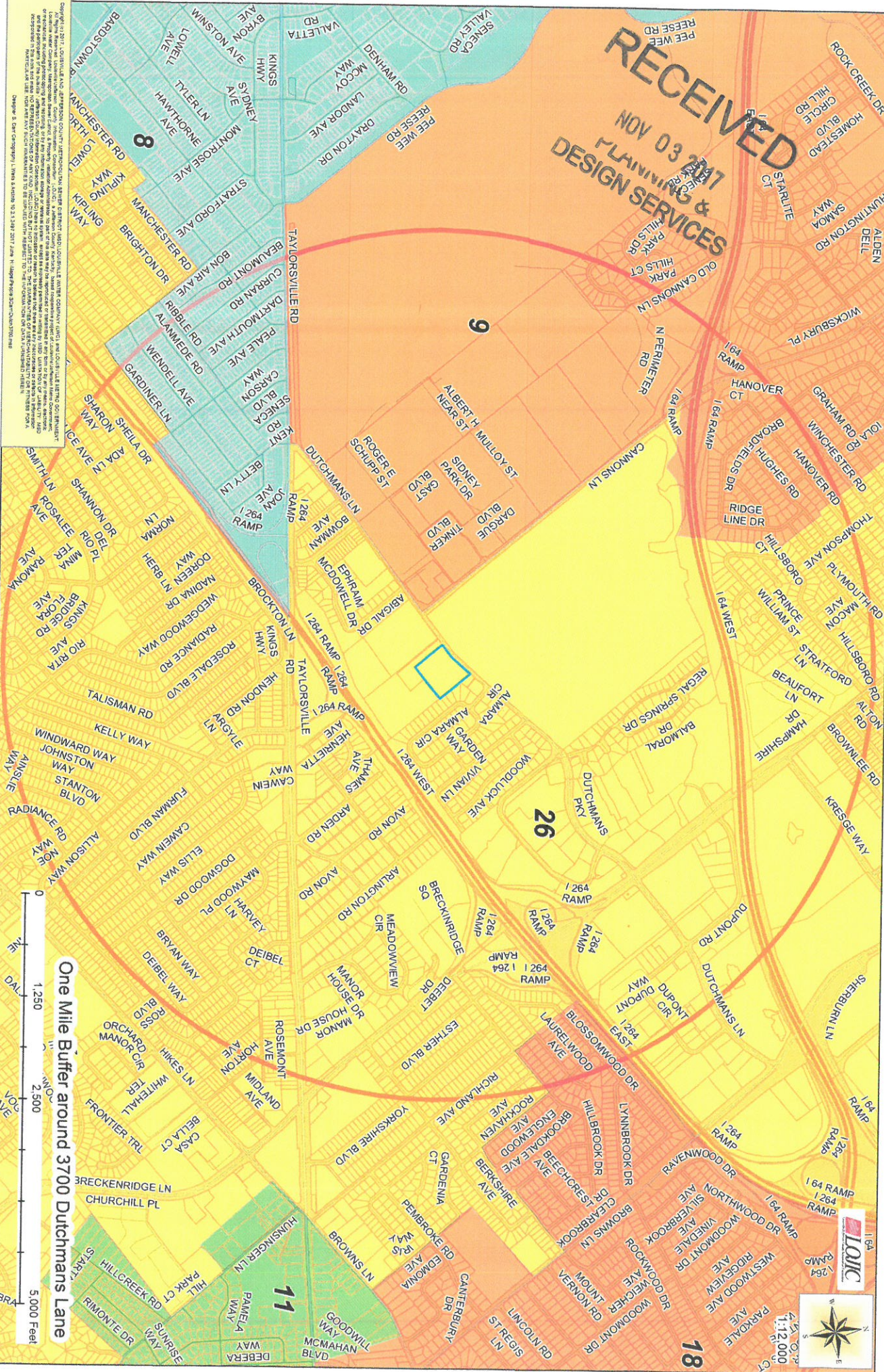

17 designation 1002

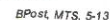

Checklist for Local Landmark Designation

RECEIVED
NOV 03 2017
PLANNING &
DESIGN SERVICES

	<p>I. Form of Petition for Local Landmark Designation (MCO 32.260 (C) as amended on August 9, 2012 and By-laws Article 4.24.514 <i>petition requesting to designate a structure or property as a local landmark shall contain:</i></p> <p>A written request of the owner or owners of the structure or property or a petition requesting designation containing the verified signatures and addresses of no fewer than 200 residents of the metro government. <u>Per the Ordinance, 101 of the 200 signatures shall be within a 1-mile radius of the structure or within the Council District where the structure is located, or a combination of both.</u></p>
	<p>Petition Submittal needs to include:</p>
	<p>-a description of the boundaries of the proposed Local Landmark site using a Lojic or Sanborn map showing the property lines or other proposed boundary for the landmark, and all the structures, properties, and public rights-of-way for a distance of 200 feet outside the proposed local landmark site boundary (bylaws)</p>
	<p>-a narrative describing the category or categories under which designation is requested (see Appendix A) (bylaws)</p>
	<p>-a summary history of the structure or property (bylaws)</p>
	<p>-photographs of all the facades of the structure or views of the property, with locations from which each photograph was taken to be noted on the map (bylaws)</p>
	<p>Each circulating petition needs to include:</p>
	<p>-a summary description by address and historic or other name (bylaws)</p>
	<p>-the statement describing the category or categories under which designation is requested (bylaws)</p>
	<p>-information about who to contact for more information (bylaws)</p>
	<p>To cover costs of the required legal notices sponsors of the petition need to submit a cashier's check payable to the Metro Louisville in the amount of \$500 (bylaws)</p>

170lesnation1002

Checklist for Local Landmark Designation

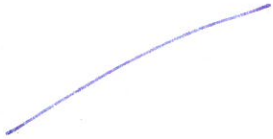
(h) Its relationship to other distinctive areas, which are eligible for preservation according to a plan based on an historic, cultural, or architectural motif.			
(i) Its unique location or physical characteristics representing an established and familiar visual feature or which reinforce the physical continuity of a neighborhood, area, or a place within Louisville Metro.	The Louisville Jewish community's Sam Cohen purchased the tract of land, in 1957, that became the site for Anshei Sfard and		

Appendix A

The Jewish Community Center. Anshei Sfard and the JCC thus became the central hub for Jewish life in Louisville. The Jewish Family & Career Services center forms the third part of the triangle constituting Louisville's campus for Jewish life.

RECEIVED

NOV 03 2017

PLANNING &
DESIGN SERVICES

17designation1002

RECEIVED

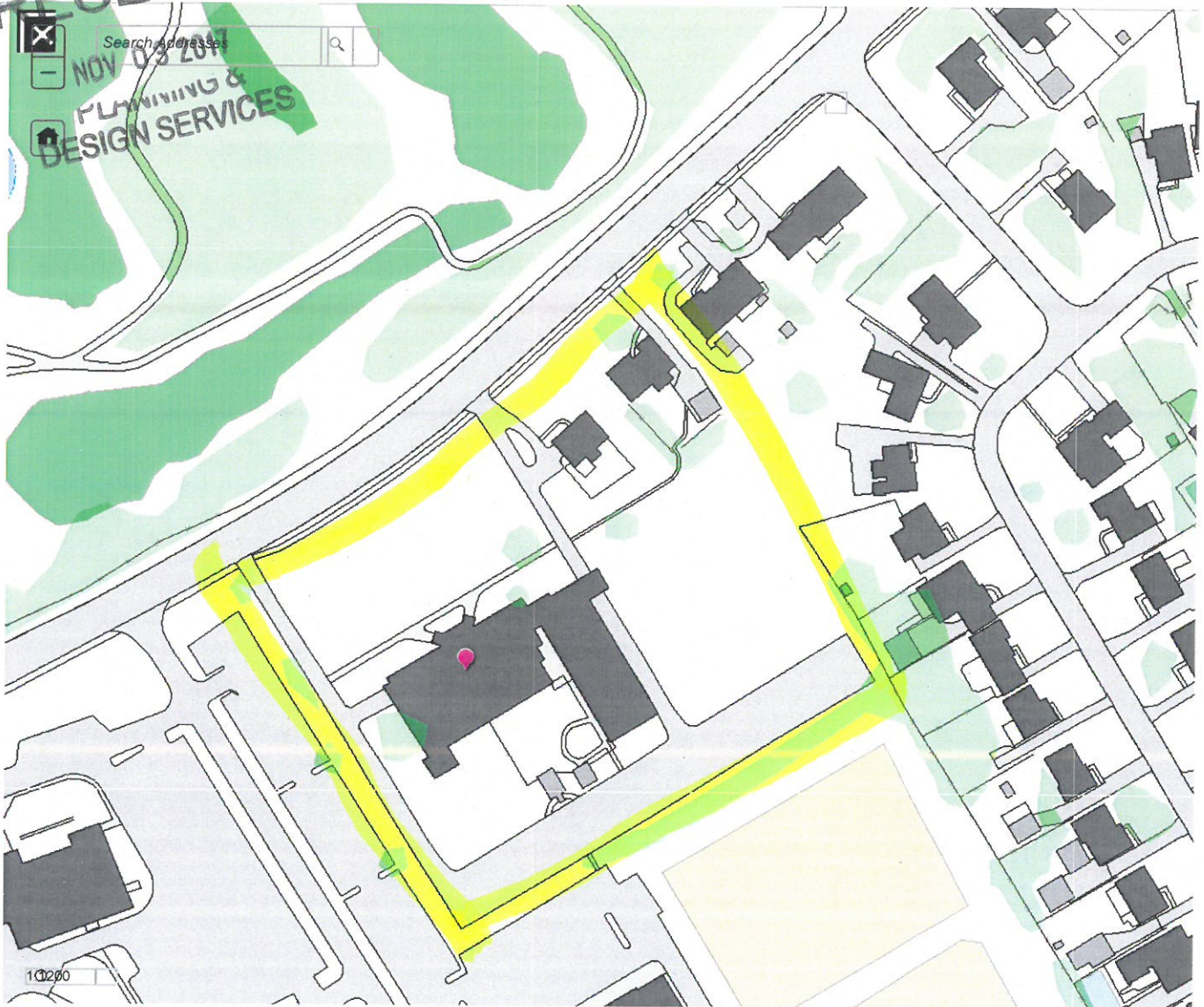

3700 Potemans Lane

- * Parcel associated with address including
- * Main synagogue building
 - * Educational wing
 - * Levitch Chapel
 - * Ritual Bath (Mikveh)

RECEIVED
NOV 03 2017
PLANNING &
DESIGN SERVICES

History of Congregation Anshei Sfard

How we were formed

It all started about 125 years ago. It was 1892 when a small group of ardent champions of Torah-true Judaism met in a dimly-lit upstairs meeting hall located in downtown Louisville at 7th and Market Streets to hold a High Holiday Service. What was lacking in physical décor was readily overshadowed by the ebullient spirit manifested by those enthusiastic participants. In June of 1893 a committee of six met with the Clerk of the County Court of Jefferson County of the State of Kentucky to draw up the Articles of Incorporation. Receiving the Clerk's approval, each member of the committee affixed his signature on the aforesaid document and thus Congregation Anshei Sfard was launched.

Our First Building

With time, the membership grew and soon it became evident that larger quarters were needed to house the congregation. Finding that the building housing the old B'rith Sholem Temple at 511 South First Street was up for sale, the Board of Directors voted to purchase the building. After many repairs and added improvements, the building became the home of Congregation Anshei Sfard, and services were conducted every day and on Shabbat and Yom Tov. In time, a downstairs ladies section and a large upstairs social hall were added, and in 1928 the new addition was formally dedicated. Soon a Sisterhood, a Men's Club and a Sunday School were organized. Classes in Jewish studies were introduced to serve both younger and older members of the congregation.

Meeting the Challenges of Relocation and Reinvention

In early 1950, the Officers and Board of Directors received a letter from the City Planning Commission stating that the proposed North-South Expressway would mean that a section of the synagogue building would be needed and the congregation should plan to relocate. Though somewhat discouraged, we did not despair. We actually gained new strength by uniting together and planning a new fund-raising drive so that we could purchase a new location for our educational center and chapel that could accommodate our rapidly growing 150 member congregation. In 1955 our building-fund drive enabled the congregation to secure a seventeen and one-half acre parcel of land adjoining the Jewish Community Center.

17designation1002

Preserving our Heritage, Changing with the Times

Soon after purchasing land, the Congregation sold several acres to the Jewish Community Center since it needed additional playing fields. In return, the Jewish Community Center provided us with some funds with which we could begin building our new synagogue. The Jewish Community Center also allowed us to conduct High Holiday Services in its spacious auditorium. The Officers and Board of Directors proceeded to launch a capital fund-raising drive. The plans ambitiously called for the construction of a new building, a sanctuary, a social hall, a library, a Rabbi's study, a business office, a meat and dairy kitchen, a bride's room, a lobby and a connecting hallway to the Education Center. We carefully selected architects and began a new chapter in our history. A grand groundbreaking ceremony was held in April 1957.

Today and Tomorrow

Through the years, we have continued to improve and update our facility, which has played such an important role in the community over the decades – We are proud to have served, not only as home to the Anshei Sfard Sunday School, but also as home to Eliahu Academy, the Louisville Jewish Day School, the Louisville Hebrew School, and the Jewish Community Center Summer Camp.

We continue to maintain our very beautiful and spacious building as the center of our many religious and social activities. As a lifetime member of the national Orthodox Union of Synagogues, Congregation Anshei Sfard continues to serve the community as the only Orthodox Synagogue in the Commonwealth of Kentucky.

RECEIVED

NOV 03 2017

**PLANNING &
DESIGN SERVICES**

17designation1002

RECEIVED

NOV 03 2017

PLANNING &
DESIGN SERVICES



Front Elevation
North -

P.1

17 designation 1002



STAINED GLASS WINDOW

& DETAILING

RECEIVED

NOV 03 2017
PLANNING &
DESIGN SERVICES

ENTRY WAYS

P.2

17 designation 1002



SANCTUARY

RECEIVED
NOV 03 2017
PLANNING &
DESIGN SERVICES



RECEIVED
NOV 03 2017
PLANNING &
DESIGN SERVICES

EDUCATION WING
SOUTH EAST ELEVATION

17designation1002



Janice Jones <janicejonesparalegal@gmail.com>

Fw: Photos II

1 message

Jeffrey Levy <levyjeffrey@rocketmail.com>

Fri, Nov 3, 2017 at 12:28 PM

To: "janicejonesparalegal@gmail.com" <janicejonesparalegal@gmail.com>

----- Forwarded Message -----

From: Jeffrey Levy <levyjeffrey@rocketmail.com>

To: Avram Kahn <opmconcerts@aol.com>

Sent: Wednesday, November 01, 2017 04:54:34 PM

Subject: Photos II

RECEIVED

NOV 03 2017

PLANNING &
DESIGN SERVICESRitual Bath
(Mikveh)South Elevation

17designation1002



Sent from Yahoo Mail on Android

WEST ELEVATION

RECEIVED
NOV 03 2017
PLANNING &
DESIGN SERVICES

17designation1002

RECEIVED

NOV 03 2017
PLANNING &
DESIGN SERVICES

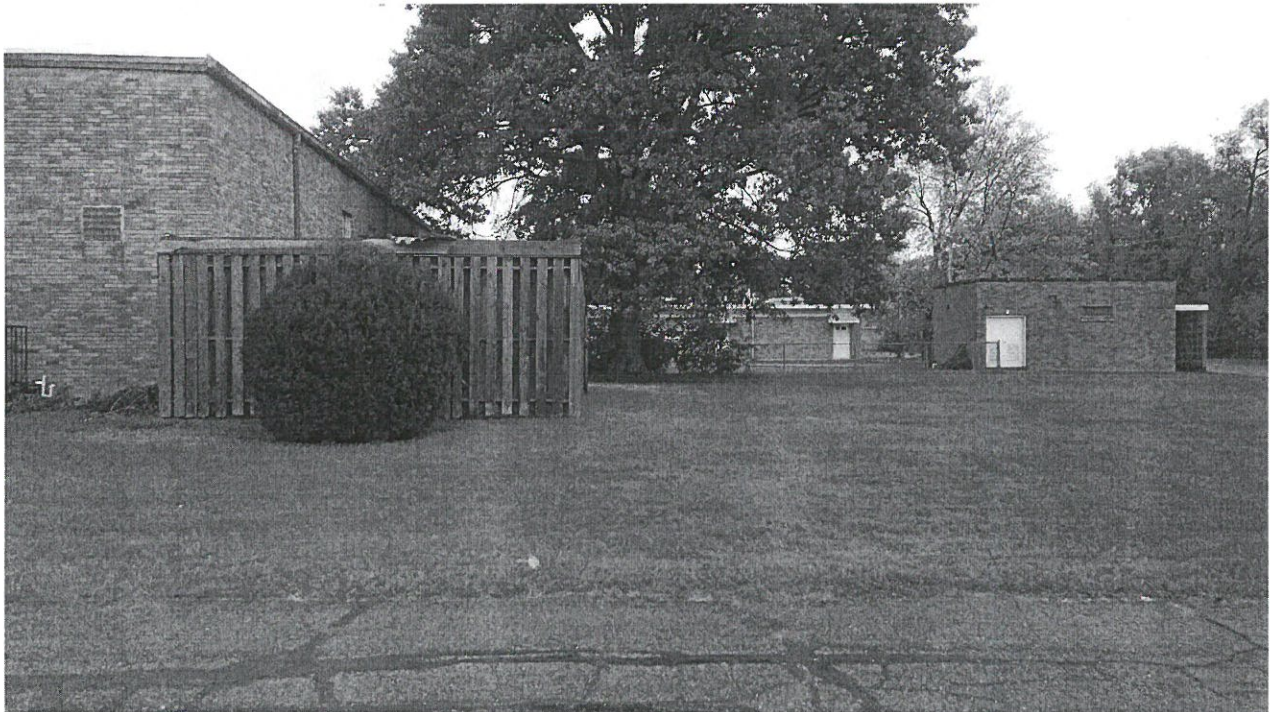

WEST ELEVATION

17design1002