

Flood Note:

According to F.I.R.M. for Louisville - Jefferson County, Kentucky - being Map No. 20120, Panel No. 01110, Suffix "E" - the property shown hereon is located in Zone "X", outside of the 0.2% annual chance floodplain.
Information from FEMA Map 2111CO101E dated April 5, 2016.

BEARING DATUM

The bearing datum is based on information provided on the recorded plat for Wood Creek Subdivision (Sect 1-A) as recorded in Plat Book 28, Page 23, in the Jefferson County Clerk's Office. The reference bearing is the west right - of - way of Maplecreek Drive, having a bearing of S 23° 05' 20" E.

This survey subject to all road right of ways and easements of record.

Beechcreek Drive

Pinch Pipe

60.00'

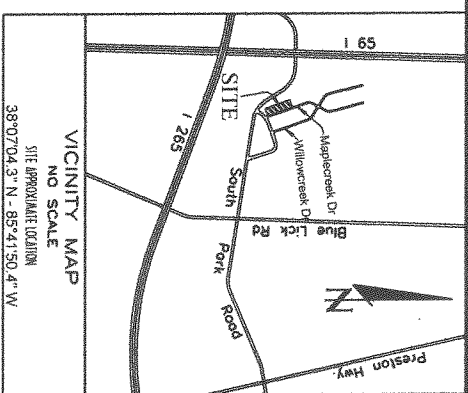
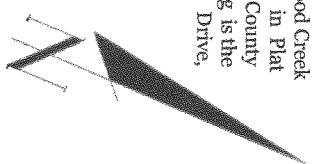

Legend

- - Set 1/2" rebar with cap "PLS 2161"
- - Corner not set
- ⦿ - Utility Pole

CERTIFICATE OF APPROVAL

Approval this _____ day of _____, 2018

Invalid if not recorded by this date: _____

By: _____

Approval subject to attached certificates.

Special Requirement(s): _____

Docket Number: _____

Surveyor's Certification:

I hereby certify that this plat depicts made by me and/or under my direct supervision by the method of random traverse with sideshots. This survey is a classified as a "Urban" survey and meets all of the accuracy and precision specifications of this class. The unadjusted precision ratio of closure is 1:22,000.
The angular and linear measurements have not been adjusted for closure and all monuments indicated herein actually exist and their location, size, and materials are correct to the best of my knowledge and belief.

Date 12/14/2018
Land Surveyor No. 2161



Purpose:

This survey and plat were prepared to create 3 tracts, from the parent tract. Created tracts identified as Tract I, Tract II, and Tract III.

MINOR SUBDIVISION PLAT

for

Shawn Asher

1422 John Parker Road London, Kentucky 40744

This plat amends Plat Book 28, Page 23 which is the Wood Creek (Sc 1-A) Subdivision

Owner: Shawn Asher
D.B. 8362 Pg. 199
Parcel No. 204601190000

Location: 8909 Old South Park Road
Louisville, KY

Zoning: R4 Form District: Neighborhood

NORMAN L. HOUGLAN LAND SURVEYOR
240 Sunvalley Ct. Shepherdsville, KY 40165

Plat Date: June 14, 2018 Revised Date: July 13, 2018

SCALE: 1" = 50'



This survey and plat comply with 201 KAR 18:50.

Commonwealth of Kentucky

N 23°26'20" W 291.70'

111.18'

84.00'

96.52'

57.48'

70.00'

James L. & Jean L. Webb
D.B. 8749 Pg. 785
Lot 91, Wood Creek (Sect. 1-A)
D.B. 28 Pg. 23

S 66°54'40" W 109.22'

Joe Asher, Inc.
D.B. 8362 Pg. 195
P.B. 28 Pg. 23
6267.8 s.f.

S 66°54'40" W 108.87'

Tract I
10479.5 s.f.

S 66°54'40" W 108.28'

Tract II
9073.8 s.f.

25' Bldg. Line

107.77'

Tract III
11805.7 s.f.

25' Bldg. Line

N 66°00'10" E 92.34'

ARC = 23.32°
R = 15.00'

Tele. Box

AS-1

Asphalt Drive

Old South Park Rd.

South Park Rd.
R/W Varies

R/W Varies

Elec. Cable Service for