

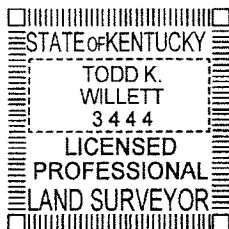

Legal Description for Alley Closure at 2070 Eastern Parkway, Louisville, KY. 40204

P.O.B. Beginning at a 1/2" rebar with a cap #3444 Willett at the Southerly corner of the property conveyed to Eagle Glen, LLC of record in Deed Book 11160, Page 328 at the Northeasterly line of the property conveyed to Lawrence E. Wallace of record in Deed Book 5601, Page 609: Thence along the Southeasterly line of Eagle Glen, LLC aforesaid North 41°50'56" East 50.38 feet to a 1/2" rebar with a cap #3444 Willett at the Easterly corner of Eagle Glen, LLC aforesaid and the Southwesterly line of the property conveyed to John M. & Sally B. Humphreys of record in Deed Book 8879, Page 40; Thence along the Southwesterly line of John M. & Sally B. Humphreys aforesaid South 48°09'04" East passing a 1/2" rebar with a cap #3444 Witness at 14.00 feet with a total distance of 15.00 feet to the Southwesterly line of the property conveyed to John M. & Sally B. Humphreys aforesaid and the Northerly corner of the property conveyed to Hamid Shafiei & Azar Gohari of record in Deed Book 10099, Page 907; Thence along the Northwesterly line of Hamid Shafiei & Azar Gohari aforesaid and the Northwesterly line of the property conveyed to Stephen & Laurie Grimes of record in Deed Book 8301, Page 269 South 41°50'56" West 50.38 feet to a 5/8" rebar with a cap #2542 at the Westerly corner of Stephen & Laurie Grimes aforesaid and the Northeasterly line of Lawrence E. Wallace aforesaid; Thence along the Northeasterly line of Lawrence E. Wallace aforesaid North 48°09'04' West 15.00 feet to the point of beginning containing 755.73 Square Feet per the Right of Way Closure Plat performed by Todd K. Willett PLS #3444 on November 01st, 2018 .



 1-03-19

Todd K. Willett PLS 3444 Date

RECEIVED

APR 01 2019

DESIGN SERVICES