

SITE DATA	
Existing Zoning District	R5
Form District	Neighborhood
Site Acreage	2 Acres
Proposed and Current Use	Buddhist Meditation Center
Tree Canopy Coverage	25,800 sq. ft., 29% *required 35% coverage

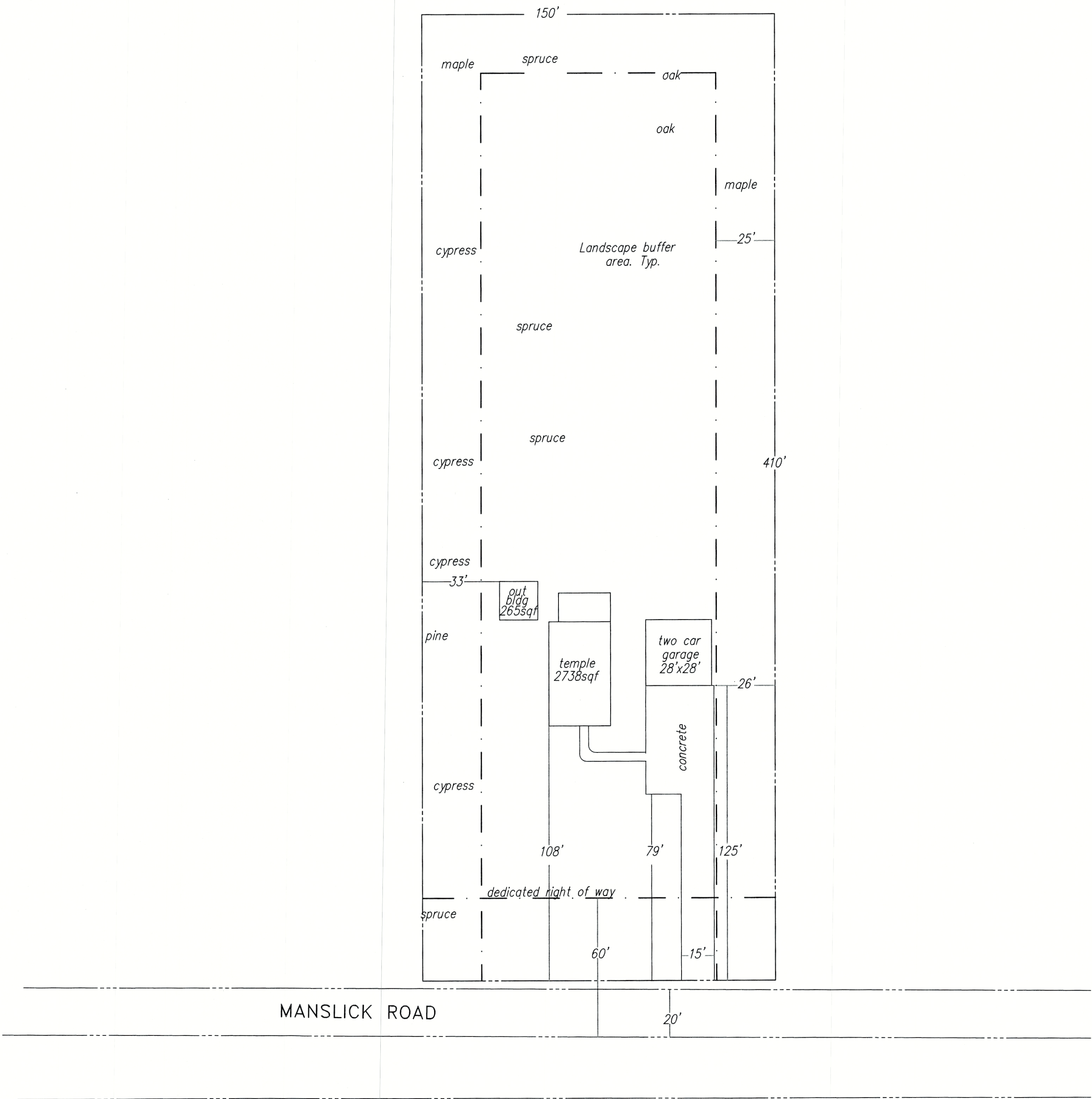

EXISTING CONDITION SITE PLAN  
SCALE: AS SHOWN

GENERAL NOTES:

- A. Owner shall dedicate to public use the area shown as reserved r/w for manslick road within 60 days of request by Metro Public Works Director
- B. Upon development or redevelopment of adjacent properties, a unified access and circulation system shall be developed to eliminate preexisting curb cuts and provide for vehicular movement throughout adjacent sites as determined appropriate by the Department of public works. A cross access agreement to run with the land and in a form acceptable to planning commission legal counsel shall be recorded prior to the time of construction approval for the adjacent property to developed.
- C. Construction plans , bond and KTC permits will be required prior to construction approval by MPW.
- D. Compatible utilities shall be placed in a common trench unless otherwise required by the appropriate agencies.
- E. No site disturbance or site work proposed with this conditional use permit.

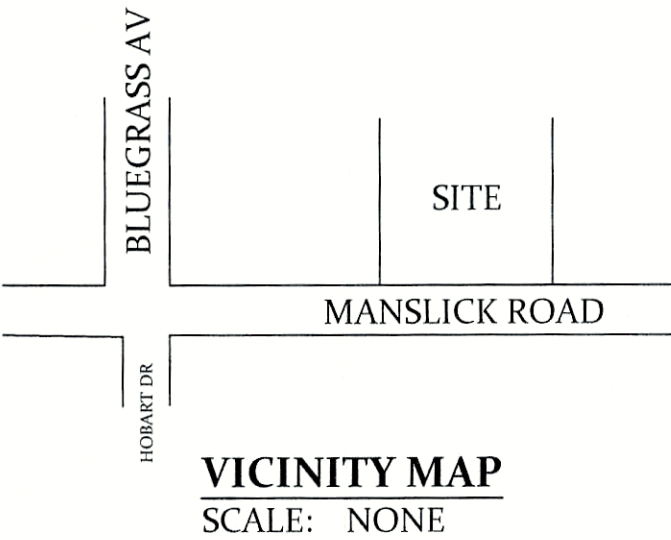
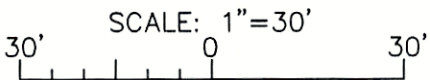

RECEIVED  
APR 27 2021  
PLANNING &  
DESIGN SERVICES

Kentucky Meditation  
Compassionate Peace Center  
& Buddhist Vihara

485 Manslick Road  
Louisville KY 40216

revisions:

# DATE DESCRIPTION

issued for:  
EXISTING CONDITION  
SITE PLAN

project no:1  
scale: 1" = 30'-0"  
date: 04-07-2021

EXISTING  
CONDITION SITE  
PLAN

sheet:

ST1.0

18 CUP 1106