

21-COA-0204
1215 S. 28th St.



Parkland Architectural Review Committee
Public Hearing

Kat Groskreutz, Historic Preservation Specialist
September 29, 2021

Request

- **Certificate of Appropriateness:** seeking approval to paint a neighborhood mural on previously unpainted masonry
 - Painted section over south side of building that is neighborhood and children focused
 - Mural will not cover the entire brick surface
 - Three large rectangles with Muhammad Ali, Eleanor Jordan, and George W. Stovall Sr. and short bios on bottom interspersed with scenes of children and historic images of the neighborhood
 - Four sections of wording across the top saying “CREATE. SHARE. INSPIRE,” “PARKLAND PRIDE,” “CREATE YOUR OWN SUNSHINE,” and “PARKLAND LOVE.”

Case Summary / Background

- The subject site is located in the C2 Zoning district and Traditional Neighborhood Form district.
- Primary structure is a circa 1925, masonry commercial storefront
- The south side of the building has more modern brick and has been patched and altered over time
- A separate COA (21-COA-0203) was approved by staff for a mural for the previously painted stucco on the front façade

Site Location

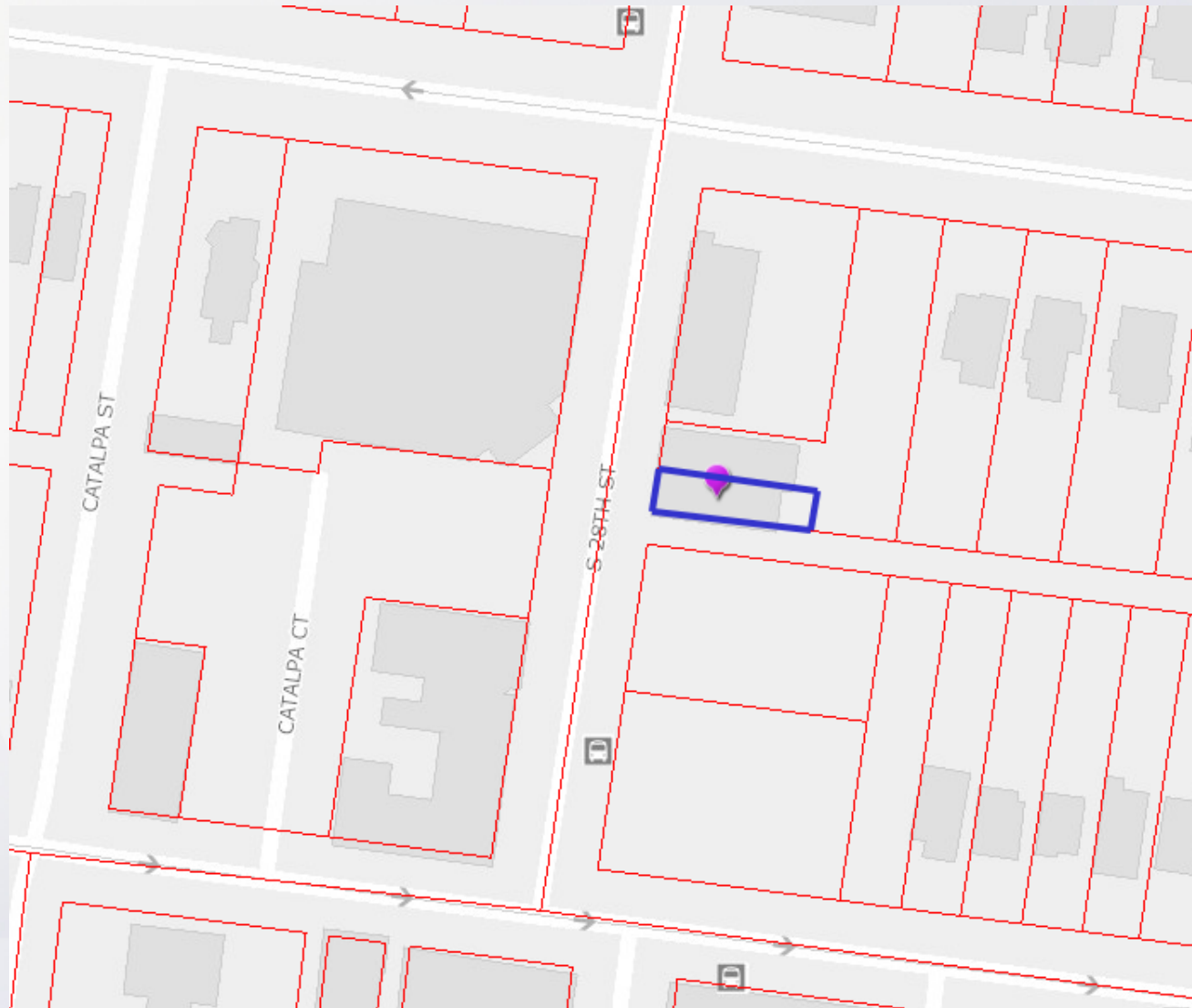

Site Location



Site Photos



Site Photos



Site Photos



Site Photos



Site Photos



South Side – Staff Photo

Site Photos



Site Photos



Images with short bio.



Muhammad Ali- Three time world heavy weight boxing champion, activist and philanthropist.



Eleanor Jordan- The first African American Executive Director of the KY Commission on Women. Former KY House of Representative

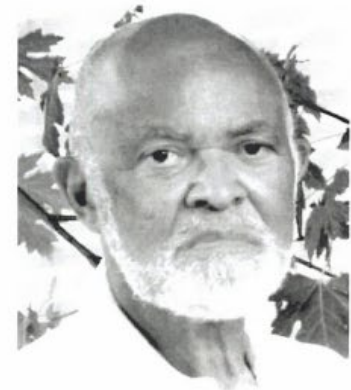

George W. Stovall Sr.- ,Parkland community advocate, prominent social and business figure.

Conclusion

- Generally meets the applicable design guidelines for **Paint** and **Masonry**:
 - Will be painted in sections on the south side brick wall and is more modern brick than the front façade; won't cover entire wall
 - Side façade has been altered over time with addition of windows, doors, and brick patching
 - A faded ghost sign is present, and portions of wall have been painted to cover graffiti
 - Staff does not feel the brick will be significantly damaged or compromised by the painting of the mural

Conclusion

- Generally meets the applicable design guidelines for **Paint and Masonry**:
 - Mural design is dynamic with themes that tie well to the building use and Parkland neighborhood
 - A new park area planned for the space directly across the alley; the mural will help mirror the community aspect of these plans
 - The proposed text is simple and easy to read
 - Staff finds the mural to be appropriate for the site, district, and neighborhood

Recommendation

- On the basis of the information furnished by the applicant, staff recommends that the request be approved with the following conditions:
 1. If the design or materials change, the applicant shall contact staff for review and approval prior to any work taking place.