

LANDSCAPE PLAN

Louisville Memorial Gardens & Funeral Home East

Louisville Memorial Gardens
& Funeral Home East

11601 Ballardsville
Rd, Louisville, KY
40241

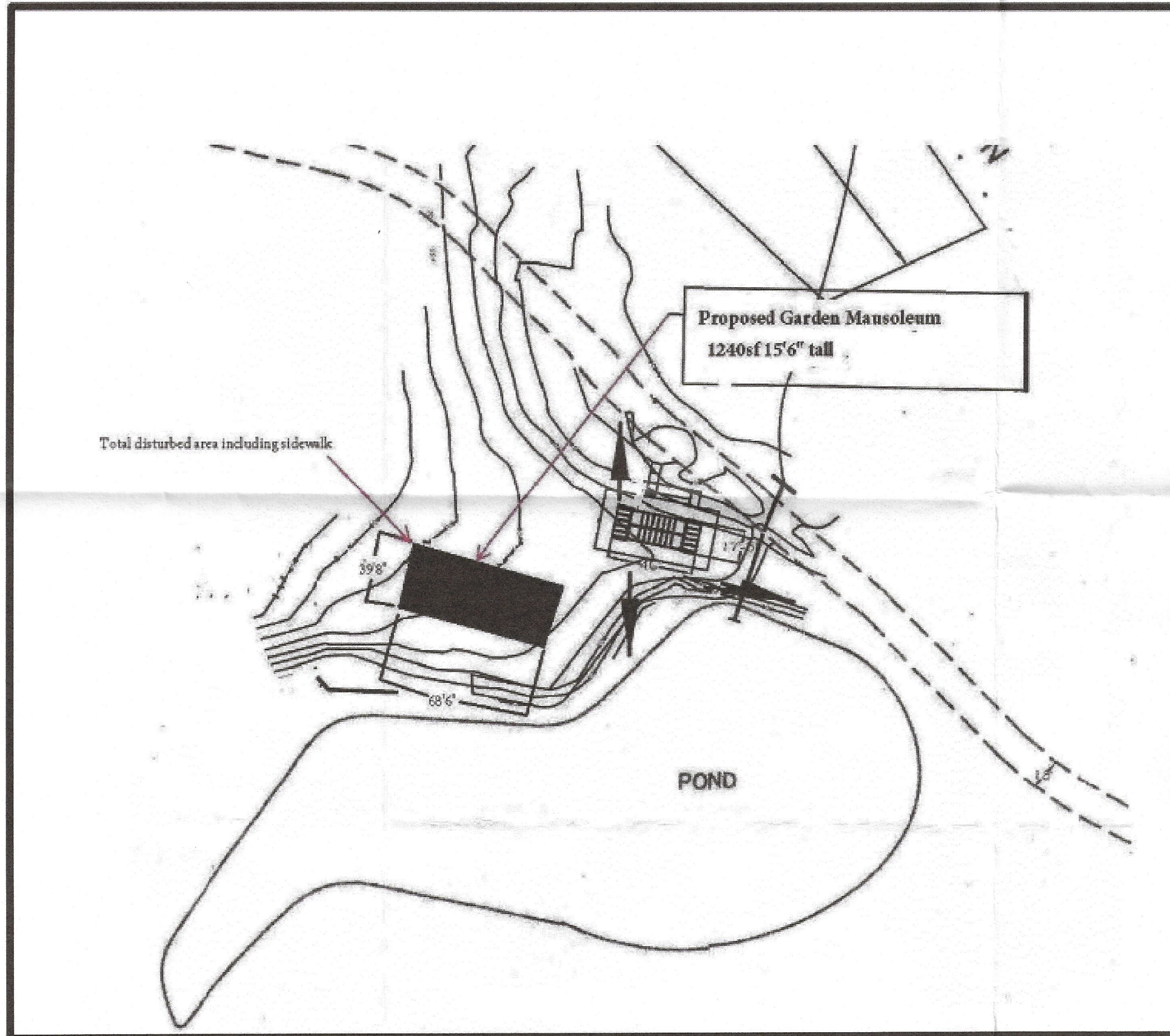

1 SITE DEVELOPMENT PLAN

SCALE: 0 10' 20'

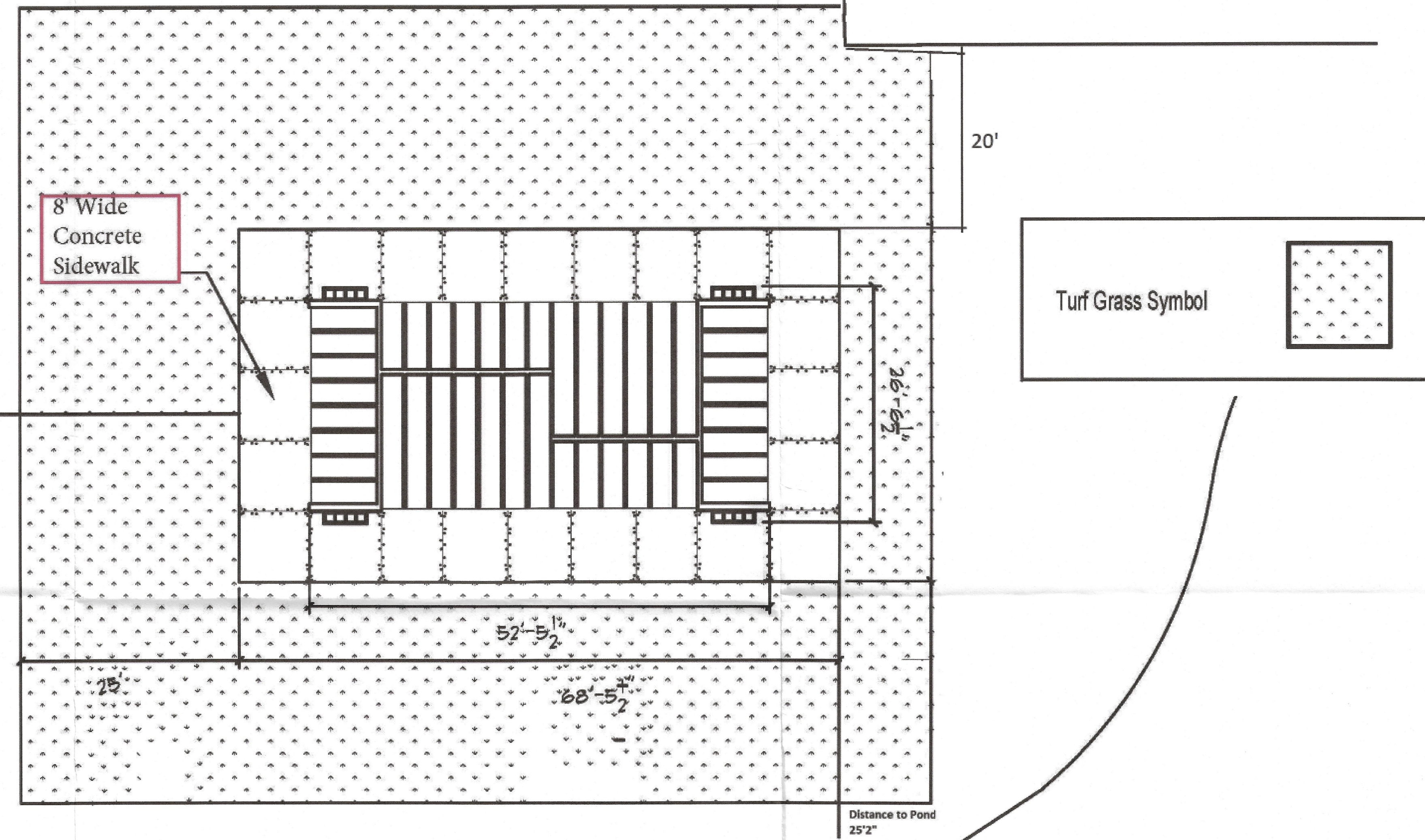

Dust Mitigation Plan
-Reduce excavation during windy conditions
-Cover areas as needed that do not receive vehicle traffic
-Very low vehicle speeds in construction areas.

Data:	
Total Site Area	22.57 Acres
Existing CUP	1.78 Acres
Existing Zoning CUP	or-1-1.78 Acres
Existing Zoning Remaining	R4-N-20.79 Acres
Existing Form District	NFD
Existing Use	Cemetery
Existing Building Area	10144 SF
Existing Mausoleum	2606 SF
Existing Mausoleum 2	805 SF
Existing Maintenance Building	1318 SF
Existing Office	1350 SF
Existing Funeral Home	2615 SF
Existing Garage	1450 SF
Proposed Building Area	1240 SF
Percent of Increase	12.2%
Total Site Disturbance	2723 SF

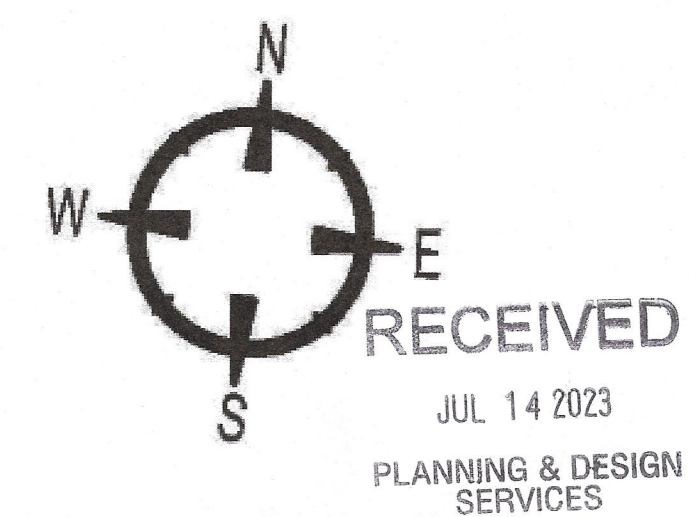

Handwritten signature or initials in the bottom right corner.

Vicinity Map

Louisville Memorial Gardens & Funeral Home East

Louisville Memorial Gardens & Funeral Home East

11601 Ballardsville Rd, Louisville, KY 40241

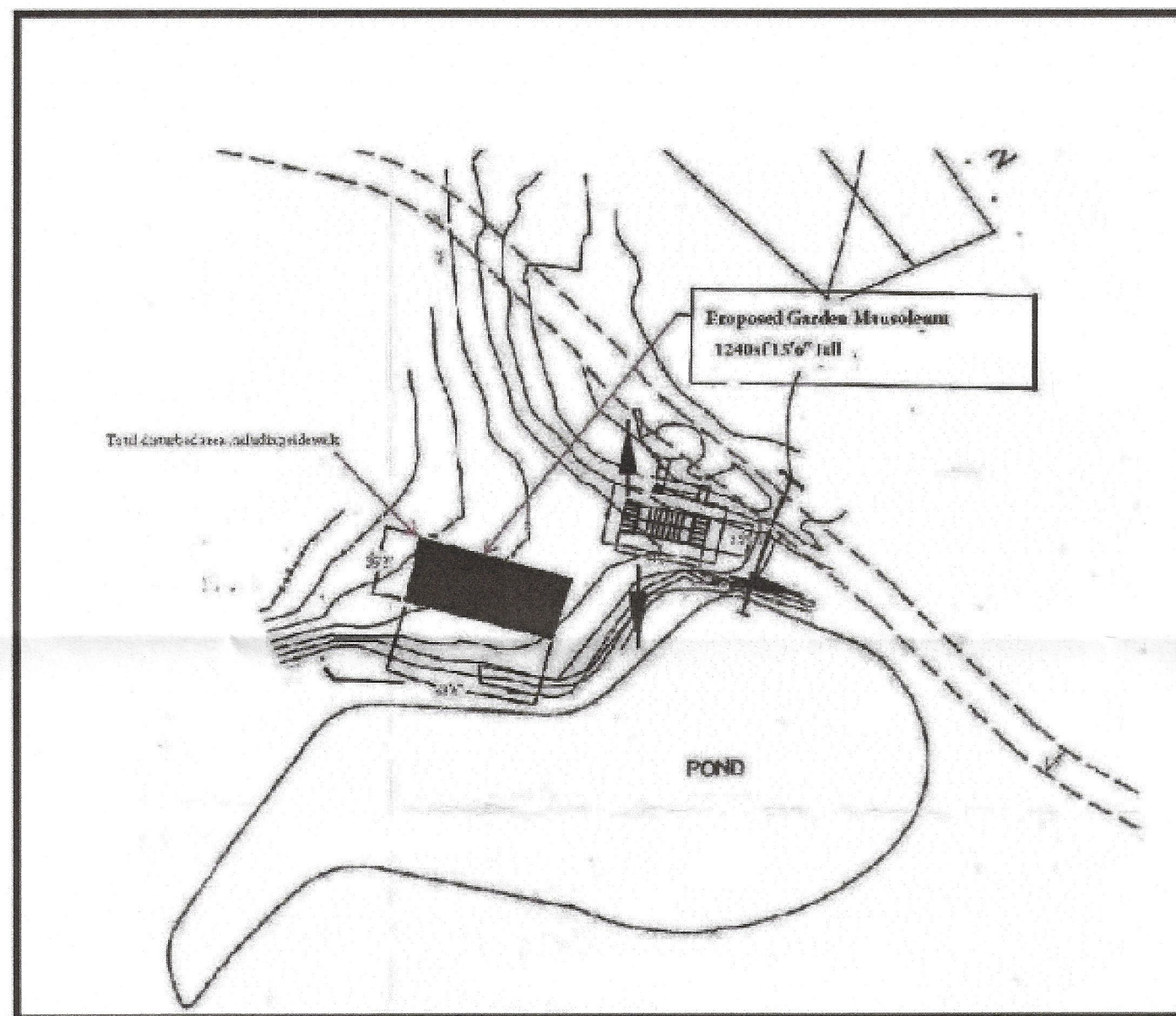

Data:

Total Site Area	22.57 Acres
Existing CUP	1.78 Acres
Existing Zoning CUP	or-1-1.78 Acres
Existing Zoning Remaining	R4-N-20.79 Acres
Existing Form District	NFD
Existing Use	Cemetery
Existing Building Area	10144 SF
Existing Mausoleum	2606 SF
Existing Mausoleum 2	805 SF
Existing Maintenance Building	1318 SF
Existing Office	1350 SF
Existing Funeral Home	2615 SF
Existing Garage	1450 SF
Proposed Building Area	1240 SF
Percent of Increase	12.2%
Total Site Disturbance	2723 SF

Dust Mitigation Plan

- Reduce excavation during windy conditions
- Cover areas as needed that do not receive vehicle traffic
- Very low vehicle speeds in construction areas.



11601 EXISTIN

- Construction plans and documents shall comply with Louisville and Jefferson County Metropolitan Sewer District's Design Manual and Standard Specifications and other local, state and federal ordinances.
- Total Site disturbance 2723sf (includes sidewalks)
- Existing impervious 1.78 Acres
- proposed impervious .063 acres
- 3.4 % increased impervious surface
- This project is subject to MS4 Water Quality Regulations once the incremental area of disturbance sums equal to or greater than 1 acre of disturbance. Per this preliminary development plan, the area of disturbance is 2723 sf.
- An EPSC plan shall be developed and approved in accordance with MSD Design Manual and Standard Specifications prior to construction plan approval.
- Site is subject to regional facility fee's, any further development of this site may require storm water mitigation or evaluation.
- MSD site disturbance permit required prior to issue of permits.

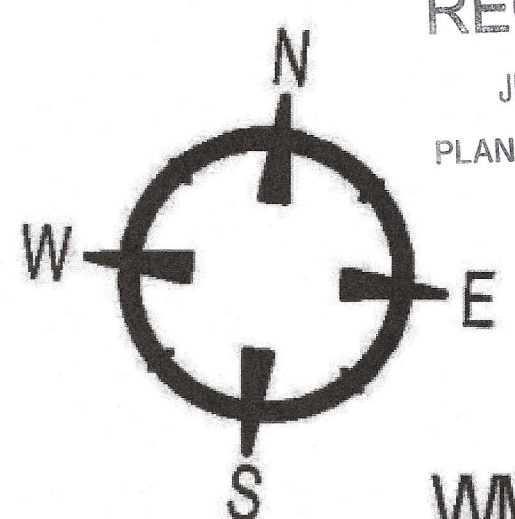

RECEIVED
JUL 14 2023
PLANNING & DESIGN SERVICES

WM#10547

23-MCMP-0006